

**GOVERNMENT CORNER RESTORATION FORM  
DOUGLAS COUNTY SURVEYOR**

TOWNSHIP 24 SOUTH RANGE 8 WEST PLSS/GCDB No. 24-08-700600  
CORNER DESIGNATION: Section Corner for S1 & S12 only

**CORNER HISTORY, PREVIOUS RENEWALS OR SURVEYS:**

- SEE DCSO SURVEY & CORNER RECORDS FOR PLSS 24-08-700600

**MONUMENT (CONDITION AND SOURCE):**

- Found a 3/4" aluminum rod by A. B. Skeesick, Cadastral Surveyor in 2005, firmly set buried 2" below the surface with a 3 1/4" diam. aluminum cap marked as noted:

**ACCESSORIES (CONDITION, SOURCE & RECORD):**

An original bearing tree by H. L. Chandler 1893:

- A 20" diam. x 2' tall mostly rotted fir stump bears N.39° W., 49.8 feet with scribe marks "2" and "8" visible.

and bearing trees by H. Johnstone in 1963 per C.S. File 51/163:

- A 29" diam. grand fir bears S.6 1/4° W., 48.2 feet with a fully healed blaze.
- A 31" diam. grand fir bears N.60 1/2° W., 40.9 feet with a fully healed blaze.

and new bearing trees:

- A 9" diam. D. fir bears S.52° W., 22.4 feet, scribed "T24S R8W S12 CS" & "BT" on a double blaze.
- A 14" diam. D. fir bears N.34 1/2° W., 44.5 feet, scribed "T24S R8W S1" & "CS BT" on a double blaze.

**LOCATION & COMMENTS:**

The corner falls 2 feet west of the ditch of a 12 foot wide gravel access road with mixed fir forest to the West of the monument.

All bearing trees have BT Tags attached. All new bearing trees have double blazed faces with bearing measured to the center of the tress at the root crown and distances measured to a 4" Mag Hub in the side and center of the root crown.

FILED

Date: 1-28-2021

By: JC

Corner Form and Field Notes:  
C.S. 67 | 48-17  
3PGS  
DOUGLAS COUNTY SURVEYOR

DATE: March 13 2019

Condition Report Only  
 Not Found  
 Renewed  
 Unrecorded  
 Surveyed In  
 Referenced Out

**MONUMENT DETAIL**

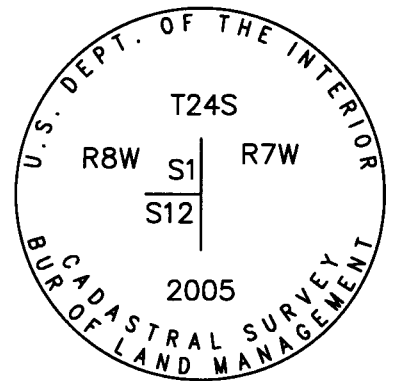

GEODETIC COORDINATES  
LATITUDE: 43°30'16.77" N.  
LONGITUDE: 123°35'06.90" W.  
DATUM: NAD 83  
SOURCE: GeoXT6000  
FILE PATH: \\dncnas\TraversePC\Corner Renewal DCSO\2019

COMPASS DECLINATION: 14 3/4° E.  
AGENCY: DCSO  
PARTY CHIEF: S. J. Flaue  
WITNESSES: J. Lorsung  
NOTES: ATTACHED

REGISTERED  
PROFESSIONAL  
LAND SURVEYOR

*Kristian O. Degroot*

OREGON  
JULY 17, 1981  
KRISTIAN O. DEGROOT  
1941

RENEWAL DATE: 12-31-2021

CS 67 | 48-17 (v)

Filed 1-28-2024

PLSS: 700600

T 245 R 08 W S 1

DATE: MARCH 13, 2019

$\frac{S1}{S12}$  ONLY

CREW:

CREW CHIEF: S. J. FLAUSE

TECH: JEFF LORSUNG

MONUMENT:

3 1/4" ALUMINUM  
CAP ON 3/4"  
~~IRON~~ ROD  
GLUMA

" T 245 "  
R 8 W | R 7 W  
 $\frac{S1}{S12}$  | S 7  
2005

PROJ: 2" BELOW SURFACE

FOUND:

ONE O.B.T. - MOSTLY ROTTED AWAY FIR STUMP  $\approx 20"$

DIA., 2 FT. TALL WITH CLEAR "2" AND "8" SCRIBES

BEARS N 39° W, 49<sup>8</sup> FT. DISTANCE = BLM MEAS.

JOHNSTONE 1963 - NEW B.T.'S: 29" DIA. GRAND FIR

WITH FHSB; BEARS S 6 1/4° W, 48<sup>2</sup> FT (AGREES BLM)

31" GRAND FIR WITH FHSB; BEARS N 60 1/2° W,

40<sup>9</sup> FT. DISTANT (AGREES BLM)

NEW:

A 9" DIA. D. FIR SCRIBED "T 245 R 8 W S 12 CS"

"BT" ON A DOUBLE BLZ.; BEARS S 52° W, 22<sup>4</sup> FT.

A 14" DIA. D. FIR SCRIBED "T 245 R 8 W S 1"

"CS BT" ON A DOUBLE BLZ.; BEARS N 34 1/2° W,

44<sup>5</sup> FT. DISTANT.

CS 67/48-17

700600 MARCH 13, 2019

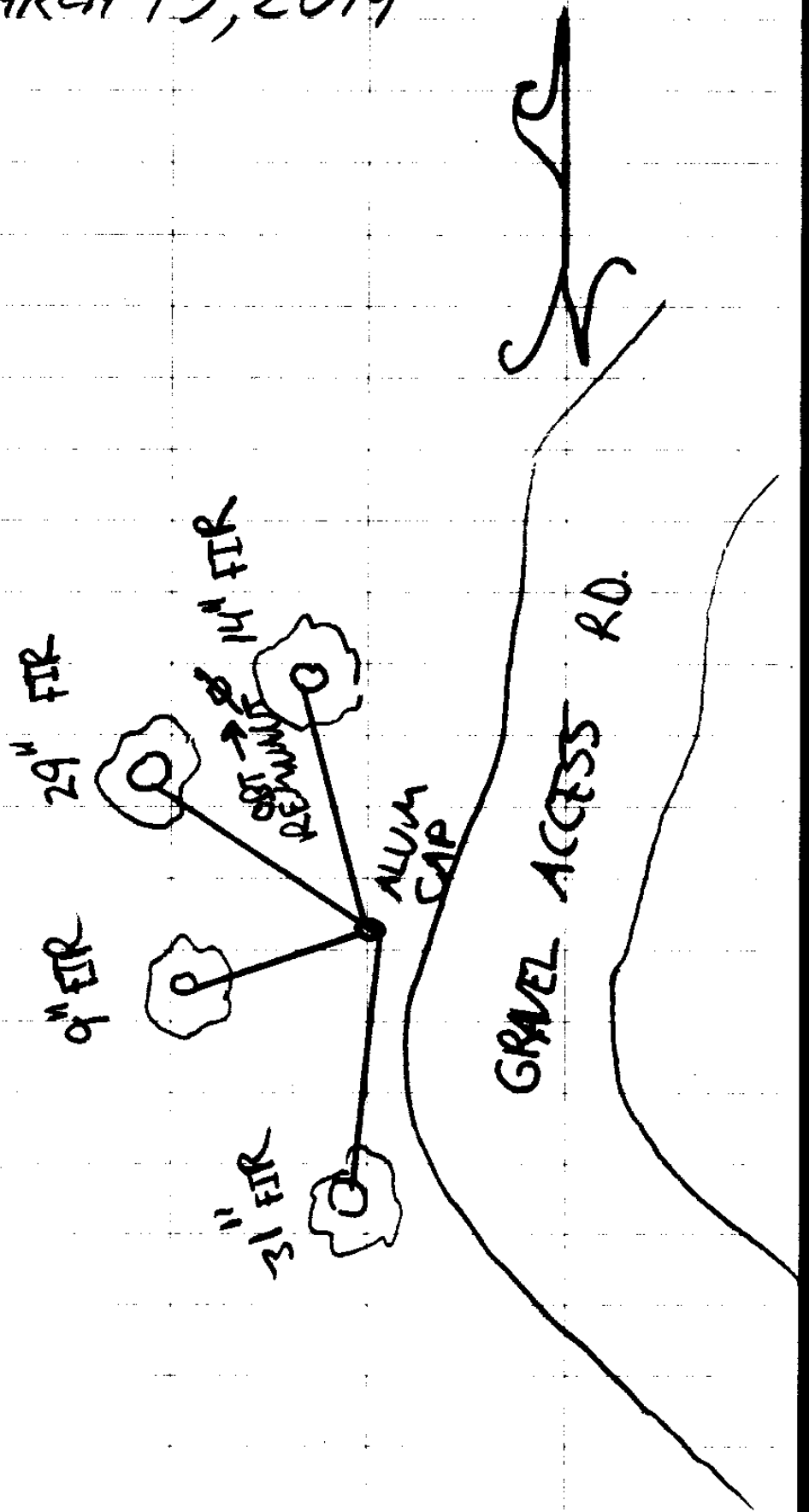

CS 67 / 48-17