

**GOVERNMENT CORNER RESTORATION FORM
DOUGLAS COUNTY SURVEYOR**

TOWNSHIP 24 SOUTH RANGE 7 WEST SECTION 31 PLSS/GCDB No. 24-07-200100
(25-07-200700)
CORNER DESIGNATION: Witness Corner to Sections 31 & 32 T24S R7W &
Sections 5 & 6 of T25S R7W

CORNER HISTORY, PREVIOUS RENEWALS OR SURVEYS:

- SEE DCSO SURVEY & CORNER RECORDS FOR PLSS 24-07-200100

MONUMENT (CONDITION AND SOURCE):

- Found a 1" i.d. iron pipe by L. Bishop per M 33-68 & C.S. 55/140, firmly set, projecting 4" above a collar of stone with a 2 1/2" diam. brass cap marked as noted:

FILED
Date: 1-28-2021
By: JL
Corner Form: CS 67/48-16
Field Notes: le pgs
DOUGLAS COUNTY SURVEYOR

DATE: March 5, 2019

 Condition Report Only
 Not Found
 Renewed
 Unrecorded
 Surveyed In
 Referenced Out

MONUMENT DETAIL

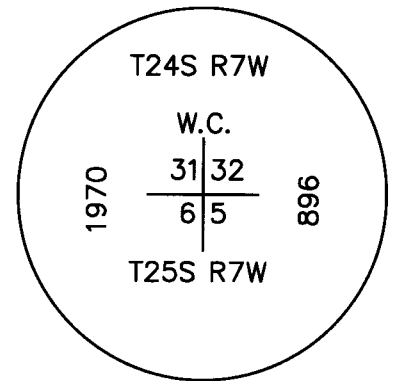

ACCESSORIES (CONDITION, SOURCE & RECORD):

Bearing Trees by L. Bishop per M 33-68 & C.S. 55/140 in 1970:

- A 19" diam. w. oak bears S. 61 1/4° W., 32.4 feet with a healed blaze. (1997 USBLM Rec. S.61 1/4°W. 49 lks.)

and a bearing tree by Geisler in 1988 per M 93-79:

- A 21" diam. ash bears N.8 1/2° W., 18.8 feet with a healed blaze.
(Top of tree was broken out in a snow storm)
- A 21" diam. W. oak bears N.87 1/2°W., 33.0 feet with a healed double blaze.
(1997 USBLM Rec. N.88 1/2°W. 50 lks.)

and a new bearing tree:

- A 22" diam. ash bears N. 72 1/2° E., 3.3 feet scribed "X" , "CSBT" on a double blaze.

LOCATION & COMMENTS:

The corner falls on a fill slope on the West side of County Road 33 in mixed alder and ash timber.

All bearing trees have BT Tags attached. All new bearing trees have double blazed faces with bearing measured to the center of the tress at the root crown and distances measured to a 4" Mag Hub in the side and center of the root crown.

GEODETIC COORDINATES
LATITUDE: 43°25'57.44" N.
LONGITUDE: 123°33'53.52"W.
DATUM: NAD 83
SOURCE: GeoXT6000
FILE PATH:

COMPASS DECLINATION: 14 3/4° E.
AGENCY:DCSO
PARTY CHIEF: S. J. Flause
WITNESSES: J. Lorsung
NOTES: ATTACHED

REGISTERED
PROFESSIONAL
LAND SURVEYOR

Kristian O. Degroot

OREGON
JULY 17, 1981
KRISTIAN O. DEGROOT
1941

RENEWAL DATE: 12-31-2021

CS 67/48-16 11

Filed 1/28/2021

PLSS: 200100

T24SR 7W S 31

DATE: 3/5/19

W.C. TO 531/532

CREW: 55/56

PARTY CHIEF - STEVE FLAUSE
SURVEY TECH - JEFF LORSUNG

MONUMENT:

2 1/2" DIA. BRASS CAP
ON A 1" I.D. I.P.

"T. 24S, R. 7W."

1970 W. C. 896
31/32
6/5

PROJ:

FOUND:

T25SR 7W

4" FROM ROUGH
MND. OF STONE

FROM 1970 BISHOP SURVEY

A 19" DIA. W. OAK WITH FHSB BEARS S 61 1/4° W, 32 1/2 FT.

NO EVIDENCE OTHER B.T.'s

FROM 1983 GEISLER SURVEY - A 21" DIA. W. OAK
WITH FULLY HEALED HIGH-LOW BLZ, BEARS N 87 1/2° W, 33 FT.

A 21" DIA. ASH (BLAZED AS ABOVE) TOP BROKEN OUT;
NEW: BEARS N 81 1/2° W, 18 8 FT (BLM RECORD)
1997 BLM ALDER GONE

A 22" DIA. ASH SCRIBED "X" "CS BT" ON A
HIGH-LOW BLZ, BEARS N 72 1/2° E, 3 3 FT. DIST,

CS 67/48-16

T25SR7W PLS 200700 MARCH 5, 2019



J L DARLING CORP TACOMA, WA 98424 1617
www.RiteintheRain.com

Rite in the Rain
4000 1st Ave SE, Everett, WA 98203

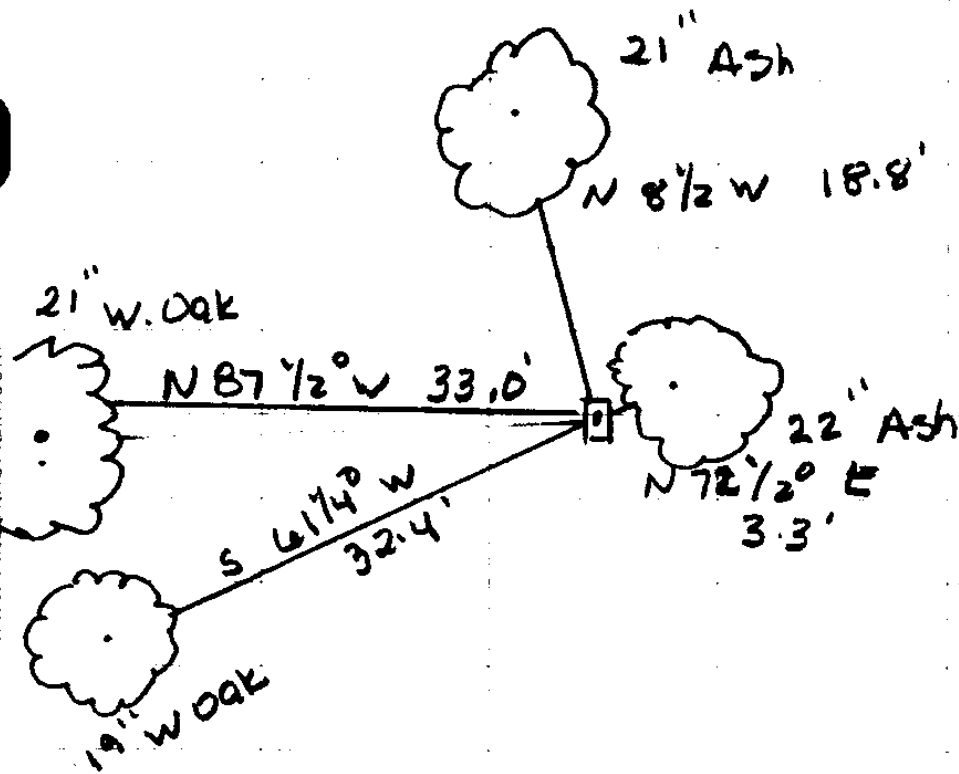

CS 67/48-16
(3)

DEC 14 2019

TOWNSHIP 25 RANGE 07 POINT IDENTIFIER # 200700

PRIMARY CORNER DESCRIPTION Sec. cor. for 5 & 6; 31 & 32, T24-7

Alias 861490 Description M.C. Right bank, Umpq. River

Alias _____ Description _____

Alias _____ Description _____

Alias 202700 Description W.C. ID # for Sec. Corner

Original - Dennis Hathorn, Deputy, Contract #73 dated June 8, 1857 (DCSO records, Vol. 8 Page 3193)

Intersect right bank of Umpqua River and set post, cor. secs. 31 and 32, 5 and 6, from which

An Oak 12" dia., bears S.80°E., 27 lks. dist.

An Oak 12" dia., bears N.35°E., 79 lks. dist.

An Oak 9" dia., bears N.12°W., 105 lks. dist.

No tree convenient on sec. 6.

COPIED

Larry D. Bishop, For B.N. Glanville, March 9, 1970
C.S. File 55/140 - M 33-68

2 1/2" Set Brass cap for witness corner 142.49 ft. East of true corner. Cap mkd. 1970 T24S R7W 898

KROJ 4" W.C. 31|32
FROM KROJ H MARK/STONE 6 1 5

*T24S, R.7W.
W.C.
1970 31|32 896
6 1 5*

BTs - *gone* 24" Cedar N.47°W., 11.0 ft. scribed W.C. S32 T24S
R7W BT. *6 1 1/4"*

19" 12" W.Oak S.60°W., 32.4 ft. scribed W.C. S5 BT.

gone 12" Cedar N.3°E., 5.3 ft. scribed W.C.X BT.

Ronald Geisler, LS #1988, for: Champion International
Feb thru March 1983 - M 93-79

Found - *2 1/2"* brass cap on a *1 1/2"* I.P. set in 1970 by Bishop.
17" Cedar stump bears N.3°E., 5.0 ft. (Rec. 5.3 ft.)
scribed X BT. (1970)

SEE ABV. ← 27" Cedar stump bears N.47°W., 11.5 ft. (Rec. 11.0 ft.) (1970) *N 87 1/2° W*

18" Oak bears S.63°W., ~~32.9~~ ft. (Rec. S.60°W., 32.4 ft.) (1970) closed face, chopped X in face.

New BTs - *21"* 18" Oak bears N.87°W., 33.0 ft. scribed: X BT 1983 *FHHL*

ASA 21 8" Oak bears N.87°W., 18.8 ft. scribed X BT. *FHHL*

gone 11" Willow bears S.39°E., 28.2 ft. scribed X BT.

QMBRG.

Doug. County Surveyors Office - Stephen Flauser; Terrie Franssen - July 30, 1990 - C.S. File 64/10

CONDITION REPORT ONLY (Cont. Next Page)

TOWNSHIP 25 RANGE 07 POINT IDENTIFIER # 200700

PRIMARY CORNER DESCRIPTION Sec. Cor. for 5 & 6; 31 & 32 of T24-7

Alias 861490 Description M.C. Right Bank, Umpqua River
Alias _____ Description _____
Alias _____ Description _____
Alias 202700 Description (W.C. ID # for Sec. Cor.)

Found - 2½" dia. brass cap on a 1¼" O.D. Iron pipe is firmly set and protrudes approx. 10" from a rough low mound of stone.

All accessories found as noted by Geisler EXCEPT 11" Willow BT which is now dead.

Monument is at bottom of fill slope on West side of County Road #33 and is approx. 650 ft. North from the Tye Access Bridge (USFS Rd. #25-7-5.1)

BLM dependent resurvey by Bryan S. Seibold & Wayne Rogers, Cadastral Surveyors, under Group #1862, surveyed Sept.-Dec. 1997 - (DCSO records Vol. 53 Page(s) 20301-2)

A witness cor. to the cor. of secs. 5, 6, 31 and 32, established by Bishop, in 1970, perpetuated by Geisler, in 1983, monumented with an iron post, 1½" diam., firmly set, projecting 10" above ground, and in a collar of stone, with brass cap mkd. 1970 T 24 S R 7 W 896

W C

31 32

6 5

T 25 S R 7 W

from which the remains of bearing trees mkd. by Bishop
An oak, 17" diam., bears S.61¼°W., 49 lks., with healed blaze.

A sawed cedar stump, 27" diam., bears N.48°W., 17½ lks., with healed double blazes.

and bearing trees mkd. by Geisler

An oak, 17" diam., bears N.88½°W., 50 lks., with healed double blazes.

An ash, 12" diam., bears N.8½°W., 28½ lks., with healed double blazes.

and a new bearing tree

~~GONE~~ The center trunk of a triple trunk alder, 11" diam., bears S. 29 3/4° E., 87 lks. dist., mkd. X BT.

From this point, the Douglas County Surveyor's Office horizontal control station "U14," at latitude 43°25'51.077" N., longitude 123°33'52.296"W. (NAD 1927), bears S.18°28'12"W, 11.178 chs. (mean bearing and sea level distance); monumented with a bronze disk, set flush in the bridge abutment of the Tye Access bridge, with top mkd. DOUGLAS CO. SURVEYORS OFFICE U14 1972.

N. 89° 55' 36" W., 2.159 chs. 142 49

continued next page

737.75 NEW BT 22" ASH "X" "CSBT" ON HIGH-LOW BLZ N 72° 2' E, 33.2

CS 67/48-16

(5)

TOWNSHIP 25 RANGE 07 POINT IDENTIFIER # 200700

PRIMARY CORNER DESCRIPTION Sec. Cor. for 5 & 6; 31 & 32 of T24-7

Alias 861490 Description M.C. Right bank, Umpq. River

Alias _____ Description _____

Alias _____ Description _____

Alias 202700 Description W.C. ID # for Sec. Corner

True point for the cor. of secs. 5, 6, 31 & 32, identical with the meander cor. of secs. 5 & 6, on the right bank of the Umpqua River, at projected bearing and Bishop's distance from the witness cor. to the cor. of secs. 5, 6, 31, and 32 (Shown on plat recorded in the Douglas County Surveyors Office map file, M33-68). Point falls in the Umpqua River and is not monumented; there is no remaining evidence of the original cor.