

GOVERNMENT CORNER RESTORATION FORM
DOUGLAS COUNTY SURVEYOR

FILED
Date: 1/27/2021
By: JC
Corner Form and Field Notes:
C.S. 67/48-10
3 Pgs
DOUGLAS COUNTY SURVEYOR

TOWNSHIP 25S RANGE 04W DLC No. 39 PLSS/GCDB No. 25-04-039050

CORNER DESIGNATION: S. SW CORNER N. MARKHAM DLC No. 39

CORNER HISTORY, PREVIOUS RENEWALS OR SURVEYS:

- SEE DCSO SURVEY & CORNER RECORDS FOR PLSS 039050
- THE CORNER WAS RESTORED FROM ORIGINAL EVIDENCE BY F.J. COLE IN 1913 PER FIELD BOOK 39, PG. 30-33.
- CORNER RENEWED BY K. HOFFINE IN 2000 PER M 134-31.

DATE: JAN. 12, 2016

Condition Report Only
Not Found
 Renewed
Unrecorded
Surveyed In
Referenced Out

MONUMENT DETAIL

MONUMENT FOUND (CONDITION AND SOURCE):

A 5/8" IRON ROD BY K. HOFFINE IN 2000 PER M 134-31, FIRMLY SET, PROJECTING 6" ABOVE THE GROUND WITH A 2 1/2" ALUMINUM CAP MARKED:

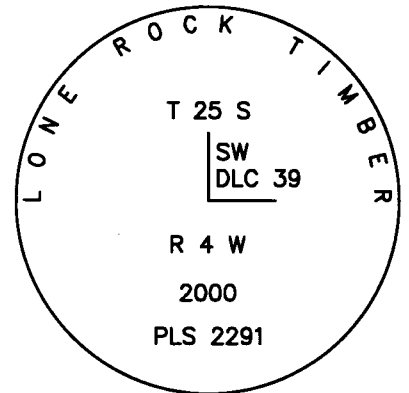

ACCESSORIES FOUND (CONDITION, SOURCE & RECORD):

BEARING TREES BY K. HOFFINE IN 2000 PER M 134-31:

- A 18" DIAM. x 48" HIGH SAWED D. FIR STUMP BEARS S.37 3/4°W., 27.4 FT. WITH SCRIBE MARKS "SW DLC 39 BT" VIS. ON AN UNHEALED SINGLE BLAZE. (REC. S. 37 3/4°E., 26.9 FT.)
- A 14" DIAM. x 30" HIGH SAWED D. FIR STUMP BEARS N. 2 3/4°W., 20.5 FT. WITH SCRIBE MARKS "SW DLC 39 BT" VIS. ON AN UNHEALED SINGLE BLAZE.

MONUMENT SET (PROCEDURES AND DESCRIPTION):

NEW ACCESSORIES:

- A 7" D. FIR BEARS S.36 1/2°E., 52.9 FT. SCRIBED "SSW DLC 39 CS" "BT".
- A 6" D. FIR BEARS N.63 1/4°W., 28.5 FT. SCRIBED "X" "CSBT"

COMPASS DECLINATION: 15 1/4° E.

AGENCY:DCSO

PARTY CHIEF: S. J. FLAUSE

WITNESSES: M.KOCH

NOTES: ATTACHED

LOCATION & COMMENTS:

ALL BEARING TREES HAVE BT TAGS ATTACHED. ALL NEW BEARING TREES HAVE DOUBLE BLAZED FACES WITH BEARINGS MEASURED TO THE CENTER OF THE TREE AT THE ROOT CROWN AND DISTANCES MEASURED TO THE SIDE AND CENTER OF THE ROOT CROWN.

CORNER FALLS ON A SMALL BENCH ON A MODERATE NE SLOPE. NEWER REPROD. FIR WEST & SOUTH, NE QUADRANT IS PASTURE RECENTLY PLANTED IN FIR & PINE.

SURVEYOR'S SEAL

REGISTERED
PROFESSIONAL
LAND SURVEYOR

Kristian O. Degroot
OREGON
JULY 17, 1981
KRISTIAN O. DEGROOT
1941

CS 67/48-10

GEODETTIC COORDINATES

LATITUDE:

LONGITUDE:

DATUM: NAD 83(2011)

EPOCH 2010.00

ELLIPSOID: GRS 1980

SOURCE: GeoXT6000

FILE PATH: \\dcnas\Surveyor\Surshared\TraversePC\Corner Renewal DCSO\2016

RENEWAL DATE: 12-31-2021

T25S, R04W, 039050

JAN. 12, 2016

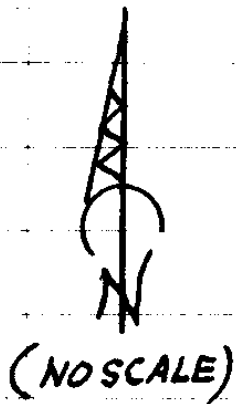

2000 B.T.
14" x 2 1/2'
D. FIR STUMP

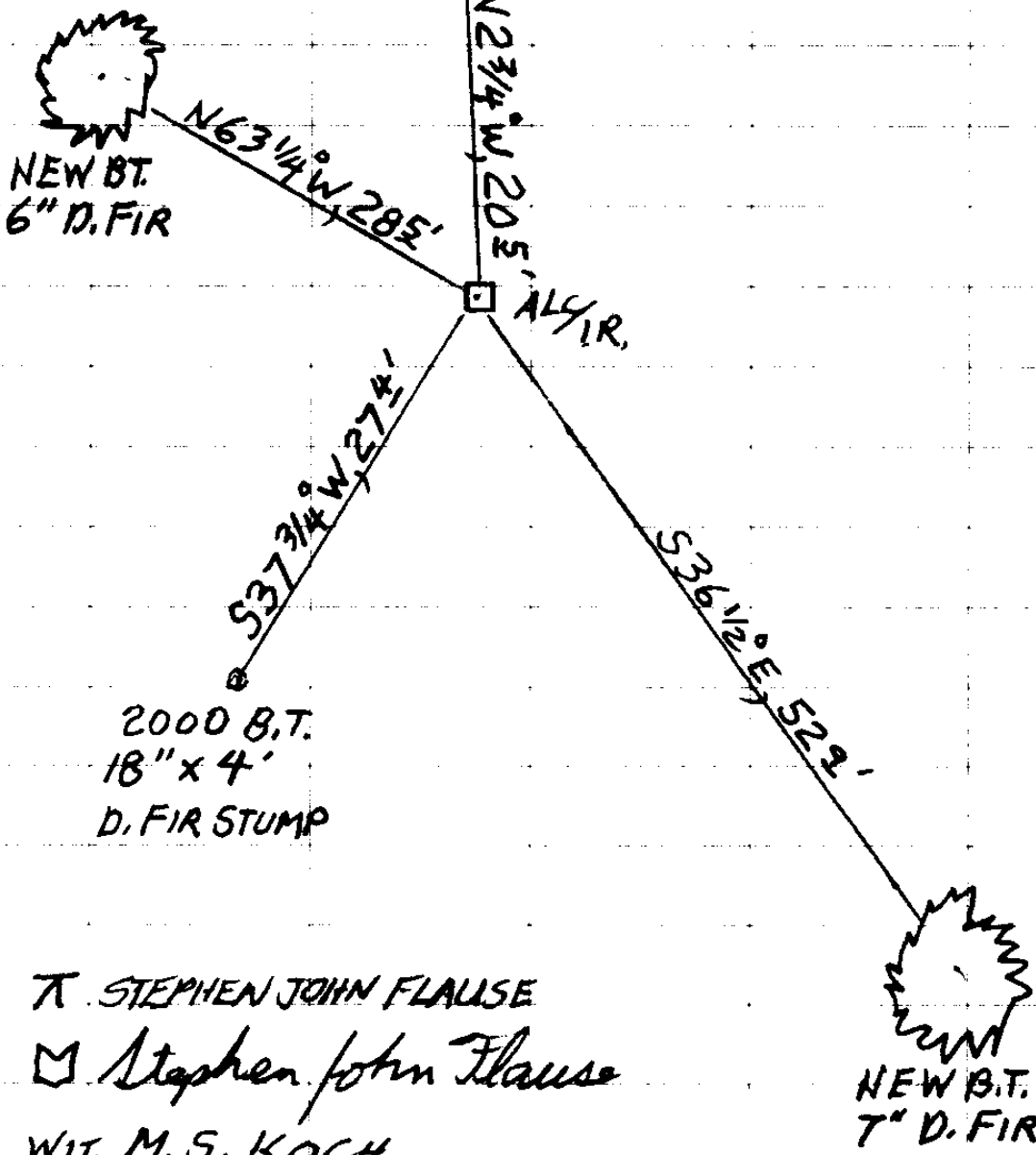

TR STEPHEN JOHN FLAUSE
 M Stephen John Flause
 WIT. M. S. KOCH

1/21/2021

CS 67/48-10

(2)

TOWNSHIP 25 RANGE 04 POINT IDENTIFIER # 039050

PRIMARY CORNER DESCRIPTION S SW Cor N Markham DLC #39

V12/16

Alias _____	Description _____
Alias _____	Description _____
Alias _____	Description _____
Alias _____	Description _____

Original - Dennis Hathorn, Contract dated Sept. 1865

 Set post SW Cor Claim 39, from which
 LNF An Oak 12" dia. bears N.33°W., 70 lks. 46 1/2
 LNF A Fir 24" dia. bears S.32°W., 120 lks. 79 1/2

F.J. Cole, Deputy Co. Surveyor - Wit. Robt. Hall; J.L. Mohr;
 A.V. Abeene - April 24, 1913 - Field Book 39 Pages 30-33

 Renew corner from remains of original trees. Set from which:
 A Fir 30" dia. bears S.14°E., 194 lks. 128 1/2
 LNF A Fir 24" dia. bears N.65 1/4°W., 282 lks. 186 L

Douglas Co. Surveyors Office - V.R. Tracy - Jan. 1964 - C.S.
 File 53/47

 Not found.

Ken Hoffine - Lone Rock Timber - Feb. 2000 - M 134-31

 Set - 5/8" x 40" iron rod with 2 1/2" alum. cap mkd: LONE ROCK
 TIMBER T25S R4W 2000 PLS 2291 PROT 6"
 OBT NF 38" D.Fir High stump with old axe marks on bark bears
 N.65 1/4°W., 186.1 ft. (rec. N.65 1/4°W., 186.1 ft.)
 OBT NF 30" D.Fir heavily decayed low stump bears S.13 1/4°E., 127.6
 ft. (rec. S.14°E., 128.0 ft.)
 18" D.Fir bears S.37 1/4°W., 26.5 ft. we scribe SW DLC 39 BT"
 4' TALL SAWED STUMP & tag tree. 27 1/2 UNHEALED SB "SW DLC 39 BT"
 14" D.Fir bears N.2 1/4°W., 20 1/5 ft. we scribe "SW DLC 39 BT"
 2 1/2 TALL & tag tree. UNHEALED SB "SW DLC 39 BT"
 SAWED STUMP

SMALL BENCH ON MOD, NE SLOPE
 NEWER REPROD FIR WEST & SOUTH
 NE QUAD IS PASTURE RECENTLY PLANTED IN FIR & PINE

LONE ROCK TIMBER
 T 25 S
 SW
 DLC 39
 R4W
 2000
 PLS 2291

NEW BTs

7" D.FIR "SSW DLC 39 CS" "BT" S 36 1/2 E, 52 1/2

6" D. FIR "X" "CSBT" ON HIGH-LOW BLAZE N 63 1/4 W, 28.5 FT

CS 67/48-10 (3)