

GOVERNMENT CORNER RESTORATION FORM
DOUGLAS COUNTY SURVEYOR
DOUGLAS COUNTY, OREGON

TOWNSHIP 25S RANGE 04W DLC No. 41 PLSS/GCDB No. 25-04-041030
CORNER DESIGNATION: SW CORNER JAMES ODLES DLC NO. 41

CORNER HISTORY, PREVIOUS RENEWALS OR SURVEYS:

Original Survey by D. Hathorn, 1856

MONUMENT FOUND (CONDITION AND SOURCE):

None

ACCESSORIES FOUND (CONDITION, SOURCE & RECORD):

Original Bearing Tree:

A 20" x 2' high rotted and broken fir stump bears N.52°W., 9.9 feet with scribe mark "T" visible with an axe notch

MONUMENT SET (PROCEDURES AND DESCRIPTION):

At the record bearing and distance from the found original bearing tree I set a 1 1/4" x 32" iron post, 26" in the ground with a 2 1/2" brass cap marked as noted.

NEW ACCESSORIES:

A 15" x 4 1/2' high D. fir stump bears S.76 1/2° E., 24.2 feet scribed "SW DLC 41 CS BT".

A 32" x 4 1/2' high D. fir stump bears S.15° W., 24.0 feet scribed "SW DLC 41 CS BT".

A 10" x 3 1/2' high D. fir stump bears S.89° W., 20.4 feet scribed "SW DLC 41 CS BT".

A 26" x 4 1/2' high D. fir stump bears N.46° W., 14.2 feet scribed "SW DLC 41 CS BT".

All new bearing trees were cut to high stumps shortly after renewal.

COMPASS DECLINATION: 15 1/2°

AGENCY: Douglas County Surveyor

PARTY CHIEF: Stephen J. Flause

WITNESSES: M.S. Koch

NOTES: Attached

GEODETIC COORDINATES:

LATITUDE:

LONGITUDE:

ELLIPSOID HEIGHT:

DATUM:

SOURCE:

LOCATION & COMMENTS:

All bearing trees have BT tags attached. All new bearing trees have double blazed faces with bearings measured to the center of the tree at the root crown and distances measured to the side and center of the root crown.

Corner falls on a moderate Easterly Slope in a new clearcut unit approximately 100 feet North of a draw bearing NW.

SURVEYOR'S SEAL

REGISTERED
PROFESSIONAL
LAND SURVEYOR

OREGON
JULY 17, 1981
KRISTIAN O. DEGROOT
1941

RENEWAL DATE: 12-31-2021

FILED
Date: 1/27/2021

By: JC

Corner Form and Field Notes:

C.S. 67/48-7

3PWS
DOUGLAS COUNTY SURVEYOR

DATE: Dec. 8, 2015

Condition Report Only

Not Found

X Renewed

Unrecorded

Surveyed In

Referenced Out

MONUMENT DETAIL

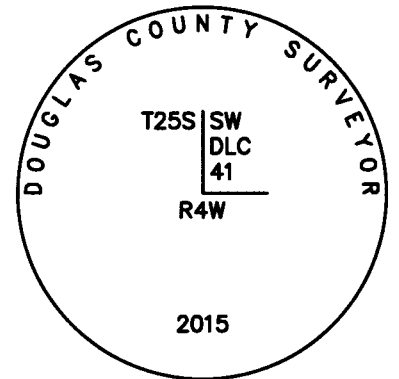

CS 67/48-7

(15)

T25S R4W 041030 DEC 8, 2015

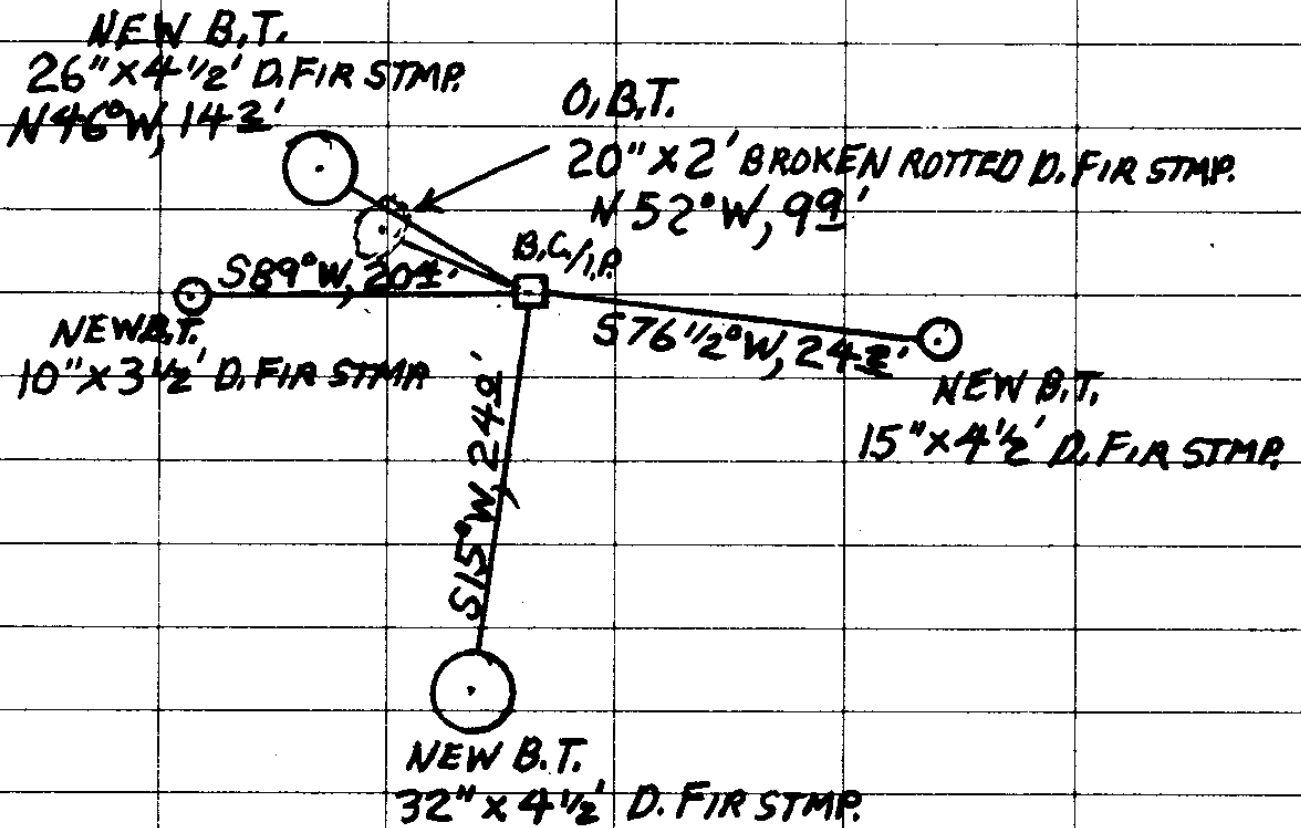
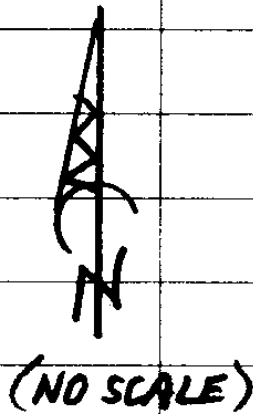

⌞ STEPHEN JOHN FLAUSE
Ⓞ Stephen John Flause
WIT. M. S. KOCH

1/27/2021

CS 62/48-7

(2)

T25 R4

FIELD NOTES

DONATION LAND CLAIMS

CHAINS

T25S R4W DLC # 39

North
6.40

On W boundary claim 39 & Sec 15.
Set post N " cor claim 39 - from which

An oak 24 in dia bears N 89°W 220 lks.
An oak 12 in dia bears S 3° W 83 lks.

East
5.50
28.00
58.40

On N boundary claim 39.
Branch 4 lks wide co N W.
Enter timber co N & S.
To beginning cor.

T25S R4W DLC #41

NEW BTs

49" D. FIR S W, 784

12" APPLE N W, 1798

Field Notes of James Odles Claim No. 41. Con-
taining 320.78 acres.

D. Hathorn 1856

Notification #577.

Beginning at the N E Cor in Sec 9 T 25 S R 4 W.
Set stone post 8x8x18 inches - from which
An oak 12 in dia bears S 68°W 25 lks.
An oak 24 in dia bears S 10-1/4°E 127 lks.

32 S 15° W
10 S 89° W
26 N 46° W

West
.75
1.25
5.66
45.30

On N boundary claim 41.
Calapooia Creek.
Leave same co S.
S W Cor Sec 9 bears S 19.92 chs.
Set flag on right bank of Calapooia Creek.
Offset to a point on opposite bank S of flag & run W.
1.40 chs & N to line.

1234.2
46.80
50.00
64.00

Left bank of same creek.
Road co N W & S E.
Set post N W Cor Claim 41 - from which

ON MOD EASTLY SLOPE
~~610 SECOND GROW FIR IN NEW CLEARCUT~~
100' NORTH OF DRAW RUN N W 1/4

An oak 15 in dia bears N 50°W 20 lks. 1320
An oak 15 in dia bears N 60°E 61 lks. 4026

South
20.10
31.00

On W boundary of Claim 41.
1/4 Sec post S boundary of Sec 8. bears E 18.25 chs.
Set post S W Cor Claim 41 - from which

NO EVID.

A fir 15 in dia bears N 27°E 23 lks.
A fir 15 in dia bears N 52°W 15 lks.

7563 1/4 W, 163

NEW BTs

4 1/2 x 15 D. FIR "SW DLC 41 CS" BT" 57 1/2 E, 242

4 1/2 x 32 " " " " " 515° W, 240

3 1/2 x 10 " " " " SW DLC 41 " CBBT" 589° W, 204

4 1/2 x 26 " " " " " " 506° W, 142

CS 67 | 48-7 (3)

DOUGLAS COUNTY SURVEYOR
T25S | SW
DLC
R4W
2015
PROT 6"

TAGGED
S
A

12/8/15