

GOVERNMENT CORNER RESTORATION FORM
DOUGLAS COUNTY SURVEYOR

FILED
Date: 1/27/2021

By: JC

TOWNSHIP 24S RANGE 04W SECTION 15/16/21/22 PLSS/GCDB No. 24-04-400400

CORNER DESIGNATION: $\frac{S16|S15}{S21|S22}$

Corner Form and Field Notes:

C.S. 67/48-5

5 Pgs
DOUGLAS COUNTY SURVEYOR

CORNER HISTORY, PREVIOUS RENEWALS OR SURVEYS:

- SEE DCSO SURVEY & CORNER RECORDS FOR PLSS 400400
- THE ORIGINAL CORNER WAS RESTORED FROM ORIGINAL EVIDENCE BY E. WOODFORD IN 1945
- CORNER RENEWED BY MILO .E. GODFREY, DEPUTY COUNTY SURVEYOR, IN 1963 PER CS. FILE 53/9-40.
- CORNER RENEWED BY JAMES E. JELLY, CADASTRAL SURVEYOR, UNDER A 1979 USBLM DEPENDENT RESURVEY

DATE: JULY 8, 2015

Condition Report Only
 Not Found
 Renewed
 Unrecorded
 Surveyed In
 Referenced Out

MONUMENT FOUND (CONDITION AND SOURCE):

THE 1979 USBLM 2 1/2" x 28" IRON POST WITH A 3 1/4" USBLM STANDARD BRASS CAP ATTACHED WAS FOUND LAYING FLAT ON TOP OF THE GROUND WITH THE 3/4" (I.D.) x 36" IRON PIPE BY WOODFORD IN 1945 FOUND INSIDE THE USBLM MONUMENT.

THE MONUMENT WAS DISLODGED FROM THE CORNER POSITION BY TRENCH EXCAVATION FOR THE CONSTRUCTION OF A WATER AND POWER LINE ON THE NORTH EDGE OF THE CORNER.

MONUMENT DETAIL

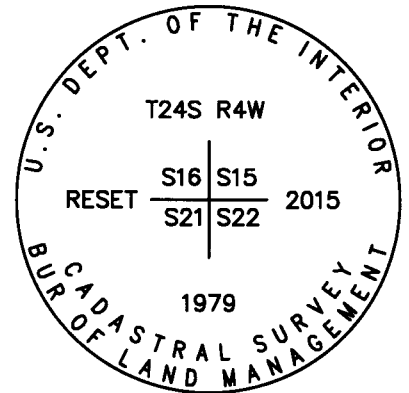

ACCESSORIES FOUND (CONDITION, SOURCE & RECORD):

AN ORIGINAL BEARING TREE:

- A ROOT HOLE BEARS S.8 1/4°E., 300.3 FT. WITH A UPROOTED 28" W. OAK ALONGSIDE WITH NO SCRIBE MARKS VISIBLE ON A PREVIOUSLY OPENED BLAZE.

AND BEARING TREES BY GODFREY IN 1963:

- A 25" ASH BEARS N.49°E., 63.5 FT. WITH A HEALED DOUBLE BLAZE.
- A 18" W. OAK BEARS S.32 1/2°E., 169.6 FT. WITH A HEALED DOUBLE BLAZE. (REC. S.32°E.)
- A 18" W. OAK BEARS S.10°W., 325.3 FT. WITH A HEALED DOUGLE BLAZE.
- A 9" DOUBLE TRUNKED ASH BEARS N.7°W., 155.0 FT. TO THE MOST SOUTHERLY TRUNK WITHA HEALED SINGLE BLAZE.

MONUMENT SET (PROCEDURES AND DESCRIPTION):

AT THE ORIGINAL CORNER POSITION DETERMINED FROM THE FOUND ACCESSORIES, THE 3/4" x 36" IRON PIPE WAS RESET BELOW THE SURFACE OF THE GROUND AND THE 1979 USBLM BRASS CAPPED IRON POST WAS RESET 28" IN THE GROUND OVER THE 3/4" IRON PIPE WITH THE BRASS CAP FLUSH WITH THE GROUND SURFACE AND STAMPED "RESET 2015" AS PER THE MONUMENT DETAIL.

NEW ACCESSORIES:

NONE

COMPASS DECLINATION: 15 1/4° E.

LOCATION & COMMENTS:

ALL BEARING TREES HAVE BT TAGS ATTACHED WITH BEARINGS AND DISTANCES MEASURED TO THE CENTER OF THE TREE AT THE ROOT CROWN.

AGENCY:DCSO

THE CORNER FALLS ON A LARGE FLAT BENCH IN AN OPEN OAK SAVANNA.

PARTY CHIEF: S. J. FLAUSE

WITNESSES: M.KOCH

NOTES: ATTACHED

GEODETIC COORDINATES

LATITUDE:
LONGITUDE:
ELLIPSOID HEIGHT:
DATUM: NAD 83
SOURCE:

CS 67/48-5
10

SURVEYOR'S SEAL

REGISTERED
PROFESSIONAL
LAND SURVEYOR

Kristian O. Degroot

OREGON
JULY 17, 1981
KRISTIAN O. DEGROOT
1941

RENEWAL DATE: 12-31-2021

GOVERNMENT CORNER RESTORATION FORM

FILED

TOWNSHIP 24S RANGE 04W SEC. 15 PLSS # 400400

Date: 1-27/2021 By: X

This survey consists of:

DOUGLAS COUNTY OREGON

DATE JULY 8, 2015

Map: _____

Corner Designation

Narrative: _____

Corner Rpt: CS 67 | 48-5

516 | 515
521 | 522

DOUGLAS COUNTY
SURVEYOR

- _____ Condition Report
- _____ Not Found
- Renewed
- _____ Unrecorded
- _____ Surveyed In
- _____ Referenced Out

Previous Renewals 1945, 1963, 1979
Monument(s) Found: (Condition and Source)

MONUMENT DETAIL

THE 1979 BLM RENEWAL BRASS CAP, 3 1/4 INCHES IN DIAMETER (MARKED AS AT RIGHT), ON A 2 1/2 INCH I.D. IRON PIPE, 28 INCHES LONG IS LOOSE ON SURFACE OF GROUND AND OUT OF POSITION. THE 3/4 INCH I.D. X 36 INCH IRON PIPE SET IN 1945 IS INSIDE THE ABOVE NOTED 2 1/2 INCH I.P.

U.S. DEPT. OF INTERIOR
T24SR4W

516 515
521 522
1979

MONUMENT WAS DISLODGED WHEN AN EAST-WEST RUNNING TRENCH WAS EXCAVATED FOR A WATER, AND POWER, LINE.

BUR. OF LAND MANAGEMENT

Accessories Found

EVIDENCE OF ONE ORIGINAL BEARING TREE;
A W. OAK 12" DIA., NOW A 28 INCH DIA. ROTTEN, FALLEN AND OUT OF POSITION OAK WITH A PREVIOUSLY OPENED BLAZE NO LONGER SHOWING SCRIBING. THE ROOTHOLE OF THIS TREE BEARS S 08 1/4° E, 300.2 FEET DISTANT (AS PER RECORD).
A SEARCH IS MADE FOR THE OTHER OBT'S; NO EVIDENCE REMAINS.

THE FOUR 1963 RENEWAL B.T.'S.
A 14" ASH, NOW A 25 INCH DIA. ASH WITH A FULLY HEALED DOUBLE BLAZE; BEARS N 49° E, 63.5 FEET DISTANT (AS PER RECORD).
A 12" W. OAK, NOW AN 18 INCH DIA. WHITE OAK WITH A FULLY HEALED DOUBLE BLAZE; BEARS S 32 1/2° E, 169.6 FEET DISTANT (RECORD S 32° E, 169.6 FT.).
A 12" W. OAK, NOW AN 18 INCH DIA. WHITE OAK WITH A FULLY HEALED DOUBLE BLAZE; BEARS S 10° W, 325.2 FEET DISTANT (AS PER RECORD).
A 6" ASH NOW A DOUBLE TRUNK ASH, THE MOST SOUTHERLY 9 INCH DIA. TRUNK OF WHICH SHOWS A FULLY HEALED SINGLE BLAZE; BEARS N 7° W, 155.0 FEET DISTANT AT THE G.R.C. (AS PER RECORD).

C.S. File 67 | 48-5

RENEWAL

Monument Set (Procedure and Description)

MONUMENT DETAIL

THE FOUND 1979 BC MONUMENT IS PLACED AT THE POSITION INDICATED BY THE FOUND ACCESSORIES AND NOW THE BRASS CAP IS SET FLUSH WITH THE GROUND SURFACE. THE STAMPING "RESET" "2015" IS ADDED TO THE BRASS CAP AND IT NOW READ AS AT RIGHT.

U.S. DEPT. OF INTERIOR
T245R4W
RESET 516 S15 2015
521 S22
1979
BUR. OF LAND MANAGEMENT

New Accessories

N/A

Sketch of Monument, Accessories, and General Area

Location & Comments

SKETCH SHOWS THE 4 LIVE BT'S

CORNER MONUMENT IS ON LARGE FLAT BENCH IN OPEN OAK SAVANNA.

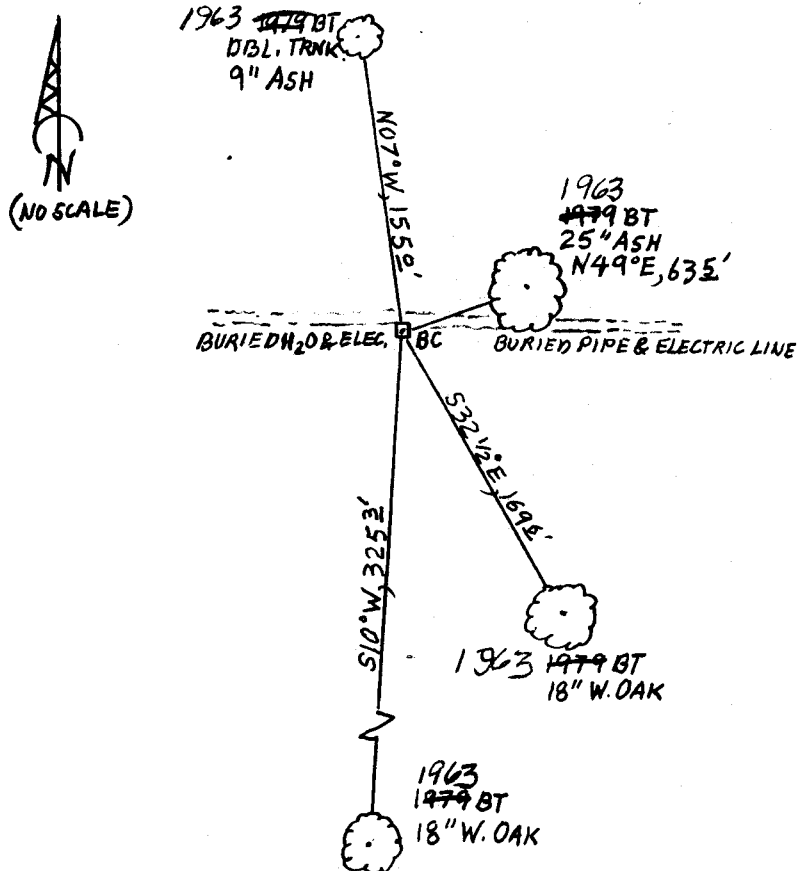

Comp. Decline. 15 1/4° E
Agency DCSD
Party Chief STEPHEN JOHN FRAUSE
Note keeper Stephen John Frause
Witnesses MIKE S. KOCH

Surveyor's Seal

CS 67/48-5
(3)

(Cont. next page)

TOWNSHIP 24 RANGE 04 POINT IDENTIFIER # 400400

PRIMARY CORNER DESCRIPTION Cor. Secs. 15, 16, 21, & 22

| | |
|-------------|-------------------|
| Alias _____ | Description _____ |
| Alias _____ | Description _____ |
| Alias _____ | Description _____ |
| Alias _____ | Description _____ |

and bearing trees mkd. by Godfrey ^{64°}
FHDB An Ash, 17" dia., bears N.49°E., 97 lks., with fragmentary scribe marks visible on open blaze. ^{169°}

18" FHDB A W.Oak, 15" dia., bears S.32°E., 256 lks., with healed blaze.

18" FHDB A W.Oak, 15" dia., bears S.10°W., ^{324°} 491 lks., with healed blaze.

An Ash, 8" dia., bears N.7°W., ^{154°} 234 lks., with fragmentary scribe marks visible on open blaze.

At the corner point
Set an iron post, 28" long, 2½" dia., 24" in the ground, with brass cap mkd: T24S R4W

S 16 S 15
S 21 S 22
1979

Reset iron pipe ~~alongside~~ iron post.

INSIDE

Fd. Ok by DCSO, 2/23/1993 - CS File 64/39

U.S. DEPT OF INTERIOR
(AS ABOVE)

BUR. OF LAND MANAGEMENT

3/4" NOW FLOSH WITH GRND

CS 67/48-5
(5)