

GOVERNMENT CORNER RESTORATION FORM
DOUGLAS COUNTY SURVEYOR

FILED
Date: 1-27-2021

By: XC

Corner Form and Field Notes:

C.S. 67/48-1 4995

DOUGLAS COUNTY SURVEYOR

TOWNSHIP 24S RANGE 04W DLC No. 47 PLSS No. 24-04-047040

CORNER DESIGNATION: SSE CORNER
WM. A. ALLEN DLC No. 47

SSE
DLC
47

DATE: Feb 5, 2015

Condition Report Only

Not Found

X Renewed

Unrecorded

Surveyed In

Referenced Out

CORNER HISTORY, PREVIOUS RENEWALS OR SURVEYS:

- ORIGINAL CORNER ESTABLISHED BY D. HATHORN IN 1856.
- CORNER RESTORED AT RECORD DISTANCE EAST OF THE ORIGINAL SW CORNER OF DLC No. 47 IN 1963 BY MILO E. GODFREY, DEPUTY CO. SURVEYOR, PER CS. 53/9-75.
- THE 1963 BCIP WAS FOUND & HELD PER M 78-33.
- SEE DCSO SURVEY AND CORNER RECORDS FOR PLSS NO. 047040

MONUMENT DETAIL

MONUMENT FOUND (CONDITION AND SOURCE):

1" IRON PIPE (I.D.) BY GODFREY IN 1963 PER CS FILE 53/9-75, FIRMLY SET, PROJECTING 11" ABOVE THE GROUND WITH A 2 1/2" BRASS CAP MARKED:

THE CORNER FALLS IN AN EAST-WEST FENCE LINE 36.5 FEET WEST OF A FENCE CORNER WITH FENCES BEARING NORTH & WEST, SEE CORNER NOTE SKETCH.

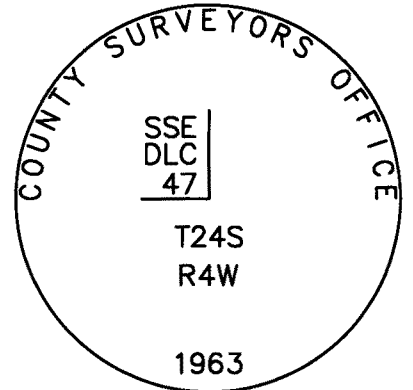

ACCESSORIES FOUND (CONDITION, SOURCE & RECORD):

ORIGINAL BEARING TREES:

- A 49" DIAM. W. OAK BEARS N.52°E., 785.0 FT. WITH A HEALED SINGLE BLAZE. (CS FILE 53/9-75 REC. N.52°E., 785.0 FT.) (ORIG. REC. N.44°E., 1282 LKS.)
- A ROOT HOLE BEARS S.51°W., 318.1 FT.

BEARING TREES BY GODFREY IN 1963 PER C.S. 53/9-75:

- A 8" DIAM. W. OAK BEARS S.41°W., 150.8 FT. WITH A HEALED SINGLE BLAZE.
- A ROOT HOLE BEARS S.20°W., 256.6 FT. WITH A FALLEN 22" DIAM. W. OAK ALONGSIDE.

MONUMENT SET (PROCEDURES AND DESCRIPTION): N/A

NEW ACCESSORIES:

- A 17" DIAM. D. FIR (THE MOST NORTHERLY TRUNK OF A DOUBLE TRUNK D. FIR) BEARS S. 24 3/4°E. 59.3 FT. SCRIBED "SSE DLC 47 CS" " BT".
- A 22" DIAM. D. FIR BEARS S. 7°E. 73.3 FT. SCRIBED "SSE DLC 47" "CS BT".

COMPASS DECLINATION: 15 1/4°E.

AGENCY: DCSO

PARTY CHIEF: S.J. FLAUSE

WITNESSES: M.S. KOCH

NOTES: ATTACHED

LOCATION & COMMENTS:

ALL BEARING TREES HAVE BT TAGS ATTACHED. ALL NEW BEARING TREES HAVE DOUBLE BLAZED FACES WITH BEARINGS MEASURED TO THE CENTER OF THE TREE AT THE ROOT CROWN AND DISTANCES MEASURED TO THE SIDE AND CENTER OF THE ROOT CROWN.

THE CORNER FALLS ON FLAT GROUND AT THE TOP OF A NW SLOPE. THE NW QUADRANT IS CLEARED PASTURE THAT IS NOW OVERGROWN WITH HAWTHORN & THE SW, NE & NW QUADRANTS HAVE OLD OAK AND REGROWN FIR TIMBER.

GEODETIC COORDINATES:

LATITUDE:

LONGITUDE:

ELLIPSOID HEIGHT:

DATUM:

SOURCE:

REGISTERED
PROFESSIONAL
LAND SURVEYOR

Kristian O. Degroot

OREGON
JULY 17, 1981
KRISTIAN O. DEGROOT
1941

RENEWAL DATE: 12-31-2021

CS 67/48-1

GOVERNMENT CORNER RESTORATION FORM

TOWNSHIP 24S RANGE 04W SEC. 20 PLSS # 047040

DOUGLAS COUNTY OREGON

DATE FEB. 5, 2015

FILED

Date: 1-27-2015 By: X

This survey consists of:

Map: _____

Narrative: _____

Corner Rpt: C567/48-1 4 pgs

Corner Designation

SSE
DLC
47

DOUGLAS COUNTY
SURVEYOR

Previous Renewals 1963

Monument(s) Found: (Condition and Source)

- Condition Report
- Not Found
- Renewed
- Unrecorded
- Surveyed In
- Referenced Out

FROM THE 1963 RENEWAL A 2 1/2 INCH BRASS CAP (MARKED AS RIGHT) ON A 1 INCH I.D. IRON PIPE FIRMLY SET PROTRUDING 11 INCHES ABOVE GROUND.

MONUMENT DETAIL

COUNTY SURVEYORS OFFICE

SSE
DLC
47

T24S
R4W
1963

Accessories Found

THE ONE ORIGINAL BEARING TREE (AS FOUND IN 1963 RENEWAL) AN OAK 24" DIA. NOW A 49 INCH DIAM. WHITE OAK WITH A PREVIOUSLY OPENED NOW REHEALED SINGLE BLAZE; BEARS N52°E, 785± FEET DISTANT (AS PER THE 1963 RENEWAL RECORD BUT NOT THE ORIGINAL RECORD). A DISTINCT ROOT-HOLE IS VERY CLOSE TO RECORD B AND D. OF ORIGINAL SOUTHWEST BEARING TREE.

FROM THE 1963 RENEWAL 2 BEARING TREES:
A 7" W. OAK NOW AN 8 INCH DIAM. WHITE OAK WITH A FULLY HEALED SINGLE BLAZE; BEARS S41°W, 150± FEET DISTANT (AS PER RECORD).
A 14" W. OAK (IN A CLUMP OF 8 TREES) NOW A 22 INCH DIAM. WHITE OAK FALLEN (APPEARS TO HAVE FALLEN ON FACE AND OTHER TREES IN NOTED CLUMP ARE ALSO FALLEN OR ROTTEN AWAY). THE C.R.C. OF THE FOUND FALLEN 22 INCH TRUNK BEARS S20°W, 256± FEET DISTANT. (AS PER RECORD).

CORNER MONUMENT IS IN AN EAST-WEST FENCE LINE WITH A FENCE CORNER (WITH FENCES RUNNING NORTH AND WEST) BEARING EAST 36± FEET DISTANT (AS PER RECORD).

C.S. File 67/48-1

RENEWAL

Monument Set (Procedure and Description)

MONUMENT DETAIL

N/A

N/A

New Accessories

A DOUBLE TRUNK DOUGLAS FIR WITH THE MOST NORTHERLY 17 INCH DIAM. TRUNK SCRIBED "SSE DLG 47CS" "BT" ON A DOUBLE BLAZE; BEARS $S24\frac{3}{4}^{\circ}E$, 59² FEET DISTANT.

A 22 INCH DIAM. DOUGLAS FIR SCRIBED "SSE DLG 47" "CSBT" ON A DOUBLE BLAZE; BEARS $S07^{\circ}E$, 73² FEET DISTANT.

Sketch of Monument, Accessories, and General Area
(SKETCH ONLY SHOWS LIVE TREES)

Location & Comments

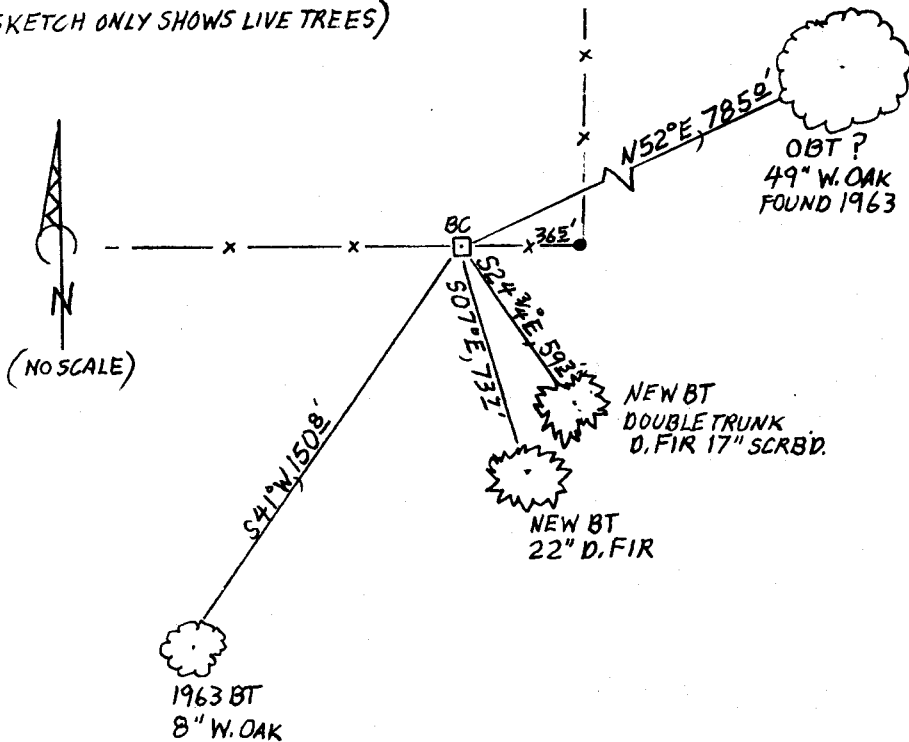

MONUMENT IS ON FLAT GROUND AT TOP OF NW SLOPE. NW QUADRANT ONCE CLEARED FOR PASTURE IS NOW OVERGROWN WITH HAWTHORN. OTHER QUADRANTS HAVE OLD OAK AND FIR REGROWTH.

Comp. Decline. $15\frac{1}{4}^{\circ}E$
 Agency DCSO
 Party Chief STEPHEN JOHN FLAISE
 Note keeper Stephen John Flaiss
 Witnesses MIKE S. KOCH

Surveyor's Seal

TOWNSHIP 24 RANGE 04 POINT IDENTIFIER # 047040

PRIMARY CORNER DESCRIPTION SSE Cor Wm. Allen DLC #47

2/5/15

Alias _____	Description _____
Alias _____	Description _____
Alias _____	Description _____
Alias _____	Description _____

DLC Survey by - Dennis Hathorn, under contract dated Sept 1856 (DCSO DLC records Pg 158)

Set post for cor. - from which ^{846¹²}
 An Oak, 24" dia., bears N.44°E., 1282 lks.
 An oak, 9" dia., bears N.51°W., 482 lks.
 318¹² **OPD 61551W**

Douglas Co. Surveyors Office - Milo E. Godfrey, Deputy Co. Surveyor - Vernon Tracy - Mike Stone - May 1963 - C.S. File 53/9

Set from dist. East of SW cor. DLC 47, according to gov't field notes. Call to NE BT evidently in error - NW tree not fd. - the SW cor. was set from both old BTs.

Found -44 42" W.Oak, N.52°E., 785.0', (record bearing & dist. is N.44°E., 846.1') opened & fd scribing "24S 4W" **RH SB**

Set - **2 1/2" PROTS 11"**
No trace of NW BT
Brass cap at cor. mkd: COUNTY SURVEYORS OFFICE 1963
T24S R4W S SE DLC 47 **F45B**

8" 7" W.Oak, S.41°W., 150.8', mkd: S SE DLC 47 CS BT.
22" 14" W.Oak, (in clump of 8 trees) S.20°W., 256.6',
FALLEN ON FACE mkd: S SE DLC 47 CS BT. **ALL DOWN**
 Corner lies in E. & W. fence line. Fence corner (fences North & West) bears East 36.5'.

DOUBLE TRK D FIR SCRIBE NRTN 17' **THRU** "SSE DLC 47CS" "BT" 524°E, 593'

22" #10 FIR **507°E, 737'** "SSE DLC 47" "CSBT"

COUNTY SURVEYORS OFFICE
 SSE
 DLC
 47
 T24S
 R4W
 1963

CS 67/48-1