

**GOVERNMENT CORNER RESTORATION FORM
DOUGLAS COUNTY SURVEYOR**

TOWNSHIP 24 RANGE 2 SECTION 36 PLSS/GCDB No. 700140

CORNER DESIGNATION: EAST 1/4 CORNER OF SECTION 36 ONLY

CORNER HISTORY, PREVIOUS RENEWALS OR SURVEYS:

- SEE DCSO SURVEY & CORNER RECORDS FOR PLSS 2402700140

MONUMENT (CONDITION AND SOURCE):

- This monument and accessories were burned in the 2020 Archie Creek Fire.
- Found a 1"X36" i.d. iron pipe by L.E. Tallett and C.A. White, USBLM Cadastral Surveyors in 1951, laying out of position near a rough mound of stone with a brass cap marked as follows:
- Reset the 1951 monument 26" in the ground in a rough mound of stone at the distance distance intersection of the NE 1896 bearing tree remnants N. 29 1/2° E., 19.8 ft. (record N. 29° E.) and the NW 1951 bearing tree remnants N. 20° W., 12.5 ft. (record N. 15° W.)

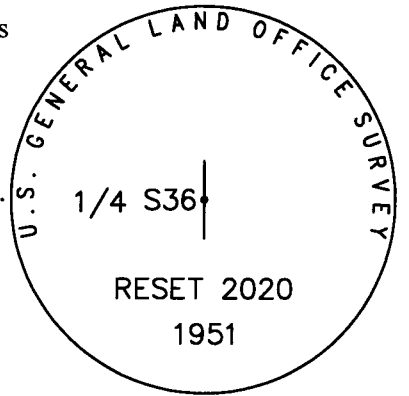

MONUMENT DETAIL

FILED
Date: 12/28/2020
By: SC
Corner Form: CS67/46-50
Field Notes: _____
DOUGLAS COUNTY SURVEYOR
DATE: NOVEMBER, 1, 2020
 Condition Report Only
 Not Found
 Renewed
 Unrecorded
 Surveyed In
 Referenced Out

ACCESSORIES (CONDITION, SOURCE & RECORD):

No Original Bearing Trees

Bearing Trees by Nicklin in 1896:

- The remnants of a burned D. fir stump in the center of a burned out roothole bears N. 29 1/2° E., 19.8 ft. (Rec. N. 29° E., 19.8 ft.)

Bearing Objects by Tallett in 1951:

- The remnants of a burned D. fir stump in the center of a burned out roothole bears N. 15° W., 12.5 ft. (Rec. N. 20° W., 12.5 ft.)

New Bearing Trees:

- A 12" diam. D. fir bears N. 1 1/2° E., 15.8 ft. (Not scribed but tagged and side spiked as a line tree by Lone Rock Timber Co.)
- A 5/8" X 30" I.R. set 28" in the ground in the shoulder of an access road with a "DCSO" yellow plastic cap bears N. 45° E., 28.8 ft.
- A 19" diam. x 2' tall D. fir stump bears N. 69 1/2° W., 38.3 ft. to a 4" mag spike set in the top center.

LOCATION & COMMENTS:

The corner falls on steep South slope in burned old growth timber approximately 28 ft. South from the centerline of a gravel logging access road.

All bearing trees have BT Tags attached. All new bearing trees have double blazed faces with bearing measured to the center of the trees at the root crown and distances measured to a 4" mag spike in the side and center of the root crown unless otherwise stated. Bearings are based on a 2020 Lone Rock Timber Co. Survey.

GEODETIC COORDINATES
LATITUDE: 43°26'51.784"N.
LONGITUDE: 122°52'37.382"W.
DATUM: ITRF2000
SOURCE: LRTC Co.
OREGON SOUTH-ZONE 3602: N=658,054.26, E=4,290,124.92
FILE PATH:

COMPASS DECLINATION: 14 1/2° E.
AGENCY: DCSO
PARTY CHIEF: S. J. Flause
WITNESSES: J. Lorsung
NOTES: ATTACHED

CS 67/46-50

**REGISTERED
PROFESSIONAL
LAND SURVEYOR**

Kristian O. Degroot

OREGON
JULY 17, 1981
KRISTIAN O. DEGROOT
1941

RENEWAL DATE: 12-31-2021

PLSS: 700140

T24S R02W E1/4 S36 ONLY DATE: 11/01/20

CREW: PARTY CHIEF - S. J. FLAISE,
TECH - J. A. LORSUNG

FOUND:

FROM BLM SURVEY DATED
MAY 1951 / AUG. 1963 A 2 1/2 INCH
DIA. BRASS CAP ON A 1 INCH I. D.
X 36 INCH IRON PIPE. BRASS CAP IS
MARKED "U.S. GENERAL LAND OFFICE SURVEY"

1/4 S36

1951

MONUMENT IS LOOSE ON GROUND
SURFACE NEAR A ROUGH AND PARTLY
SCATTERED MOUND OF STONE.
FIRE AND FALLING DEBRIS CAUSED
MONUMENT TO BE AS FOUND.

BEARING TREE EVIDENCE

OVER →

T 245 R 02 W P 55 T 00140 CONT'D

FOUND INDICATE THE POSITION FOR THE B.C.
MON. WOULD BE MOST CONSISTENT WITH
THE SURVEY RECORD IF REESTAB-
LISHED AT A DISTANCE - DISTANCE
INTERSECTION MEASURED FROM
THE REMAINS OF THE 1893 NE
B.T. AND THE 1951/1963 NW
B.T.

THE NE 1896 B.T. IS NOW A
LARGE MOSTLY BURNED AWAY FIR
STUMP IN A ROOTHOLE WITH
NO BLAZE OR SCRIBE EVIDENCE

BEARING $N29\frac{1}{2}^{\circ}E$, 198 FT. DISTANT
(RECORD. $N29^{\circ}E$, 198 FT. DIST.)

THE NW 1951/1963 B.T. IS NOW
A BURNED AWAY FIR STUMP IN
A ROOTHOLE WITH NO BLAZE OR

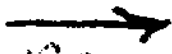
NEXT PG. 

(2)

T245R02W PLSS 700140 CONT'D

SCRIBE EVIDENCE BEARING

N15°W, 12⁵ FT. DISTANT (RECORD

N20°W, 12⁵ FT. DIST.)

MONUMENT SET:

AT THE POSITION DESCRIBED ABOVE
BASED ON THE FOUND B.T. EVIDENCE

(THIS LOCATION IS FURTHER VERIFIED

BY A PRIVATE SURVEY MEASURING

TO THE NEAREST MONUMENTED

GOVERNMENT CORNERS) WE

REESTABLISH THE DESCRIBED

FOUND GLO BRASS CAP/I.P.

MONUMENT WHICH NOW PROJECTS

10 INCHES ABOVE GROUND IN A

ROUGH MOUND OF STONE. THE STAMP-

ING "RESET 2020" IS ADDED TO B.G.

OVER →

T245 R02 W P LSS 700140 CONT'D

NEW REFERENCES:

A 12" DIA. D. FIR LINE TREE
NOT BLAZED OR SCRIBED BUT
HAVING A 4" MAG NAIL AT ITS
RIGHT SIDE CENTER; BEARS
N 01'12" E, 15 ⁸/₃ FT. DISTANT
THIS TREE IS TAGGED ONLY AS A LINE
TREE.

A 5/8" DIAM X 30" LONG IRON
ROD WITH A DCSU YELLOW PLASTIC
CAP SET PROJ. 2" ABOVE GROUND
IN A GRAVELLED RD. SHOULDER; BEARS
N 45° E, 28 ⁸/₃ FT. DISTANT.

A 4" MAG NAIL IN TOP CENTER
OF A FIR SINGED BUT SOLID 19" DIA.
2 FT TALL D. FIR STUMP; BEARS
N 69'12" W, 38 ³/₃ FT. DISTANT

NEXT PG. →

(3)

T245 R02W PLS 700140 CONT'D

MONUMENT IS ON VERY STEEP SOUTH SLOPE IN NOW PARTIALLY BURNED OLD GROWTH FOREST. MONUMENT IS 28 FT. SOUTH FROM CENTERLINE OF GRAVELLED FOREST ACCESS ROAD.

DECLINATION $14\frac{1}{2}^{\circ} E$

SKETCH:

NAIL IN
19" X 2 FT SIMP



(NO SCALE)

GRAVEL RD

RIDGE TOP ACCESS

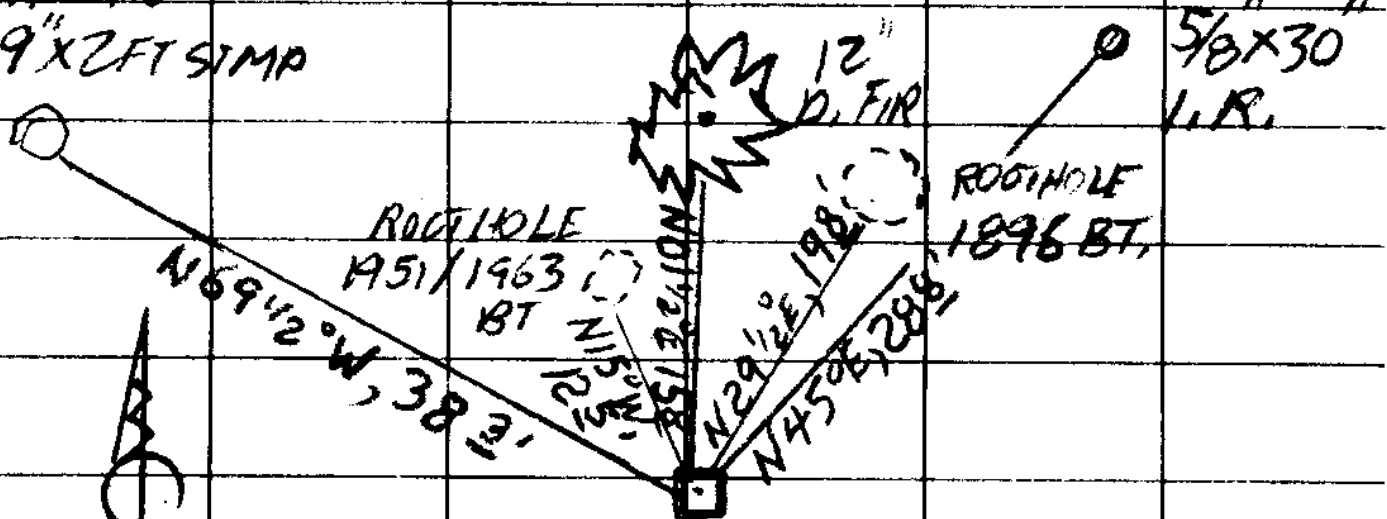

5/8" X 30" L.R.

ROOTHOLE
1896 BT.

ROOTHOLE
1951/1963
BT

$N 69\frac{1}{2}^{\circ} W, 38'$

$N 12^{\circ} E, 15'$

$N 29\frac{1}{2}^{\circ} E, 198'$

$N 45^{\circ} E, 288'$

11/01/20

TOWNSHIP 24 RANGE 02 POINT IDENTIFIER # 700140

PRIMARY CORNER DESCRIPTION E. 1/4 Cor. for Sec. 36 only

Alias _____	Description _____
Alias _____	Description _____
Alias _____	Description _____
Alias _____	Description _____

GLO survey by John A. McQuinn, Deputy Surveyor, under Contract #466, dated April 5, 1883 (DCSO records Vol. 7 Page(s) 2873 (and duplicate pg. 2761)

Set a Dogwood post, 3 ft. long, 3" sq., 24" in the ground for 1/4 sec. cor. mkd. 1/4 S. on W. face, from which

A Fir 16" dia., bears S.85°E., 34 lks. dist. mkd. 1/4 S BT.

A Fir 6" dia., bears S.73°W., 16 lks. dist. mkd. 1/4 S BT.

GLO survey by Carl S. Nicklin, Deputy Surveyor, under joint contract #664 dated May 23, 1896 (DCSO records Vol. 7 Page(s) 2939)

The 1/4 sec. cor. I find in a delapidated condition; BT in sec. 31 blown down; no trace of post to be found. I re-establish as follows:

At the exact point for the 1/4 sec. cor. determined by the old BT and data furnished by the surveyor general.

Set a basalt stone 10x10x8 ins., 7" in the ground for 1/4 sec. cor. mkd. 1/4 on W. face, from which

A Fir 24" dia., bears N.29°E., 30 lks. dist. mkd. 1/4 S BT.

A Fir 6" dia., bears S.73°W., 16 lks. dist. mkd. 1/4 S BT.

BLM resurvey by Levi E. Tallett and C. Albert White, Cadastral Surveyors, under Group #294, Surveyed May 1951/Aug. 1963 - (DCSO records Vol. 32 Page(s) 13285)

The 1/4 sec. cor. of sec. 36, determined at record bearing and distance from the 1883 SW. BT and the 1896 NE. BT. from which the old bearing trees:

BURNT OUT FIR STMP IN ROOT HOLE
~~1896 BT~~
~~1896 BT~~
~~1896 BT~~
NO EVID

~~1896 BT~~
~~1896 BT~~
~~1896 BT~~
~~1896 BT~~

At the corner point Set an ~~iron post~~, 6" in the ground to solid rock and ~~base of stone~~, 4 ft. base to top, with brass cap mkd:

S 36
1951

from which

N15°W, 12 54

U.S. GENERAL LAND OFFICE SURVEY

1951 PROJ 10" ABS GRND

BURNT OUT FIR STMP IN ROOT HOLE

~~1896 BT~~
~~1896 BT~~
~~1896 BT~~
~~1896 BT~~

NEW REFS MON. ON STEEP SOUTH SLOPE IN OLD GROWTH FIR 28 FT SOUTH FROM GRVLD LOGGING RD.

12" D FIR LINE TREE NOT SCRIBED BUT TAGGED WITH 4" MAGNAIL RSC N01 1/2° E, 158

5/8" IR/YEL PLSTC CAP PROJ 2" ABS GRND IN RD SHLD BEARS N45°E, 288

19" X 2 FT SOLID SINGED FIR STMP 4" MAGNAIL TOP CNTR. OVER CRC N69 1/2° W, 383