

GOVERNMENT CORNER RESTORATION FORM
DOUGLAS COUNTY SURVEYOR

FILED
Date: 3-17-2020
By: SC
Corner Form: CS 67/46-21
Field Notes: 6 Pgs
DOUGLAS COUNTY SURVEYOR

TOWNSHIP 30 S RANGE 04 W SECTION 15

PLSS/GCDB No.30-04-047050

CORNER DESIGNATION: Witness Corner to the SSW Corner of Geo T. Day DLC No. 47

CORNER HISTORY, PREVIOUS RENEWALS OR SURVEYS:

- SEE DCSO SURVEY & CORNER RECORDS FOR PLSS 3004047050

DATE: August, 9, 2016

- Condition Report Only
- Not Found
- Renewed
- Unrecorded
- Surveyed In
- Referenced Out

MONUMENT (CONDITION AND SOURCE):

- Found a 1" diam. i.d. iron pipe by William Ruppert per C.S. File 58/215, plumb and firmly set, projecting 12" above a 3 ft. diam. stone collar with a 2 1/2" diam. brass cap marked as noted:

MONUMENT DETAIL

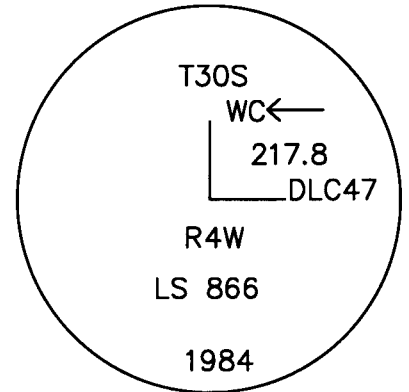

ACCESSORIES (CONDITION, SOURCE & RECORD):

A bearing tree by James W. Byron, Deputy County Surveyor, in 1963 per C.S. File 53/26:

- A 31" diam. D. fir bears S. 56° E., 48.5 ft. with a healed blaze.

A bearing object by Ruppert in 1984:

- A 5/8" diam. iron rod projecting 4" above the ground bears N. 79° E., 26.8 ft. (Rec. N. 79°07' E., 26.81 ft.)

New Bearing Trees:

- A 12" diam. P. pine bears S. 70° E., 16.5 ft. scribed "WC SSW DLC 47" "CS BT" .
- A 24" diam. P. pine bears N. 4 1/2° W., 24.6 ft. scribed "WC SSW DLC 47 CS" "BT".

LOCATION & COMMENTS:

All bearing trees have BT Tags attached. All new bearing trees have double blazed faces with bearing measured to the center of the trees at the root crown and distances measured to the side and center of the root crown.

The corner falls on a gentle slope on the east shore of the South Umpqua River near the mean high water line.

REGISTERED
PROFESSIONAL
LAND SURVEYOR

Kristian O. Degroot

OREGON
JULY 17, 1981
KRISTIAN O. DEGROOT
1941

RENEWAL DATE: 12-31-2021

GEODETIC COORDINATES
LATITUDE:
LONGITUDE:
DATUM: NAD 83
SOURCE: GeoXT6000
OREGON SOUTH-ZONE3602:
FILE PATH:

COMPASS DECLINATION: 15° E.
AGENCY:DCSO
PARTY CHIEF: S. J. Flause
WITNESSES: M. S. Koch
NOTES: ATTACHED

C.S. FILE 67/46-21

AUGUST 9, 2016

T30S, R04W, WC TO SSW COR DLC47, PLSS 047050

MONUMENTS FOUND:

NO EVIDENCE OF MONUMENTS SET BEFORE 1984 REMAINS. MONUMENT SET BY RUPERT IN 1984 IS NOW A 2 1/2" DIA. BRASS CAP ON A 1" I.D. IRON PIPE PROTRUDING PLUMB 12" ABOVE A ROUGH 3 FT. DIA. MOUND OF STONE.

THE BRASS CAP IS MARKED AS FOLLOWS:

" T 30 S "

WC ←

| 217.8

— DLC 47

R4W

LS 866

1984

ACCESSORIES FOUND:

NO EVIDENCE REMAINS OF ANY BEARING TREES MARKED BEFORE 1963.

THE ONE NEW IN 1963 B.T. A 16" R. FIR, NOW A 31" DIA. D. FIR WITH A FULLY HEALED DOUBLE BLAZE; BEARS S56°E, 48[±] FT. DISTANT (AS PER RECORD)

THE 5/8" x 30" IRON ROD WITH A 3/4" WASHER

(2)

CS 67146-21

(2)
T30S, R04W, PLSS 047050 (CONT'D)

● SET IN 1934, IS NOW A $\frac{5}{8}$ " DIA. IRON ROD ($\frac{3}{4}$ " BRASS WASHER NOW MISSING) PROTRUDING 4 INCHES ABOVE GROUND WHICH BEARS $N79^{\circ}E$, 26^8 FT. DISTANT (AS PER RECORD).

NEW ACCESSORIES:

● A 12" DIA. PONDEROSA PINE SCRIBED "WCSSW DLC 47" "CSBT" ON A DOUBLE BLAZE; BEARS $S70^{\circ}E$, 16^5 FT. DISTANT.

A 24" P. PINE SCRIBED "WCSSW DLC 47CS" "BT" ON A DOUBLE BLAZE; BEARS $N04^{\circ}12'W$, 24^6 DISTANT.

DECLINATION $15^{\circ}E$

● CORNER MONUMENT IS ON GENTLY SLOPING EAST SHORE OF THE SOUTH UMPQUA RIVER, NEAR THE MEAN HIGH WATERLINE.

● T STEPHEN J. FLAUSE

‡ MIKE S. KOCH

● M Stephen John Flause

(3)

CS 67/46-21

(3)
T305, R04W, PLSS 047050 (CONT'D)

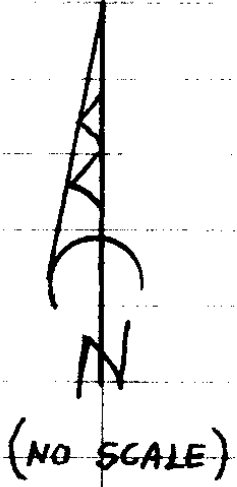
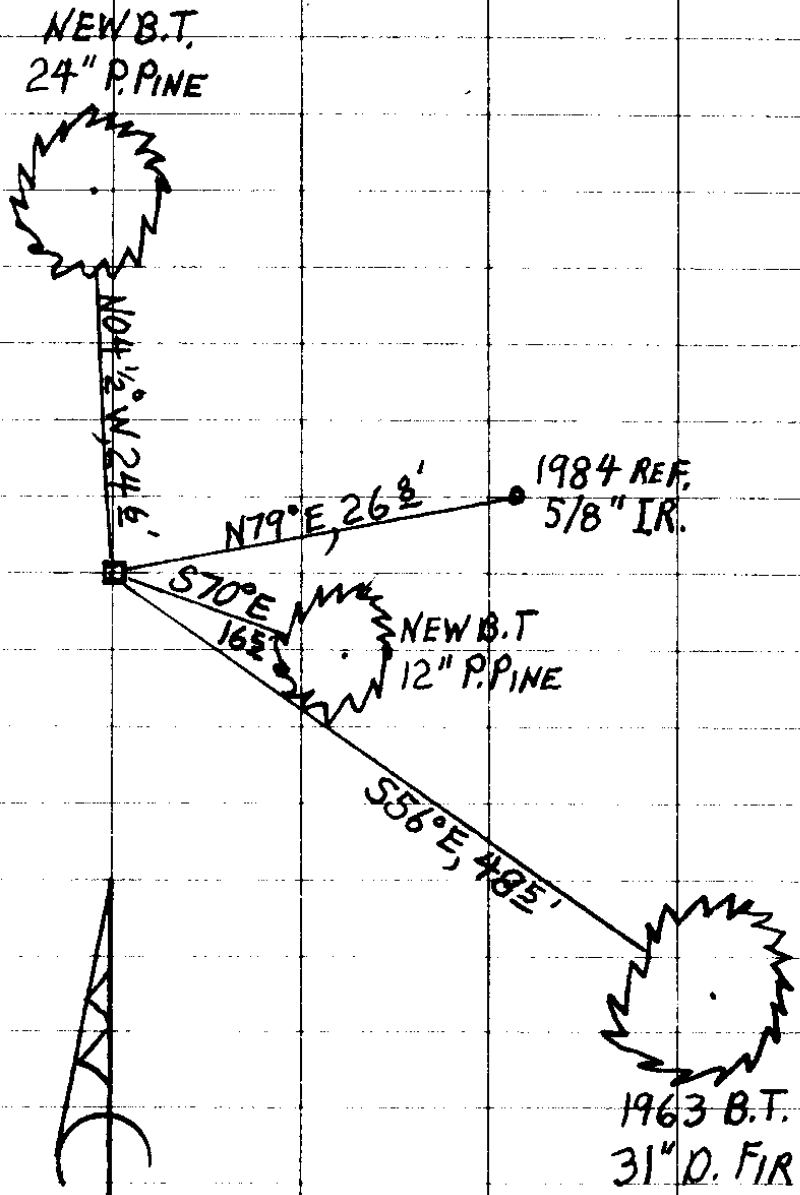

(4)

CS 67/46-21

TOWNSHIP 30 RANGE 04 POINT IDENTIFIER # 047050

PRIMARY CORNER DESCRIPTION S SW Cor Geo T Day DLC #47

Alias _____	Description _____	8/9/16
Alias _____	Description _____	
Alias _____	Description _____	
Alias _____	Description _____	

Original - GLO survey by Bowman and Burnett, under Contract dated Sept. 1855 (DLC survey Volume Page 611)

Cor. on edge of river, from which
A W.Oak 20" dia., bears N.88°E., 438 lks. dist.

GLO survey by Wm. Thiel, Deputy Surveyor, under Contract #535, dated Feb. 5, 1889 (DCSO records DLC Volume, Pages 711-12)

----- 2178'

As the true corner is in the river, at a point 3.30 chs. East of true corner, I set a basalt stone 24 x 8 x 4" marked 47 W.C. on NE. face in a mound of stone, from which

No Evid A Laurel 9" dia., bears S.70½°E., 33 lks. dist. mkd. T30S R4W C.47 W.C. BT.

" A Pine 12" dia., bears N.40 3/4°E., 30 lks. dist. mkd. T30S R4W C.47 W.C. BT.

The old post, set for this cor. is gone, also the bearing tree: but the line tree described in the field notes, namely a B.Oak 14" dia. is standing, marked with 2 notches on E. and W. sides, which enabled me to find the true line. 701 58 TO LINE TREE

G.G. Stewart, Deputy Co. Surveyor - Wit: Montgomery, Morgan, Moore and Beals - M 2-9; Vol. 3 Pg. 136; C.S. File 7/31 1922

Found one original BT and stump of other. Together with rock for corner. Marked:

No Evid An 8" Fir S.12°E., 18.9 ft.

" An 18" Laurel (?), 21.7 ft. (O.B.T.)

Douglas Co. Surveyors Office - James W. Byron, Deputy - Milo Godfrey and Mike Stone, crew - Aug/Sept. 1963 - C.S. File 53/26

Found - 6" x 8" stone, 12" above ground with chisled + on top.

Now 24" Laurel that shows part of old face and good scar below, S.70°E., 21.8 ft.

No trace of Fir to SE.

Corner near top of river bank and 6 ft. North of old fence line.

New BT - 31" D. FIR \checkmark FHDB bears S.56°E., 48.5 ft. scribed WC SSW DLC 47 CS BT.

Rescribe-24" ~~GONE~~ Laurel S.70°E., 21.5 ft. WC DLC 47 CS BT.

(Cont. Next Page)

5

CS 67/46-21

TOWNSHIP 30 RANGE 04 POINT IDENTIFIER # 047050

PRIMARY CORNER DESCRIPTION S SW Cor. Geo. T. Day DLC #47

Alias _____	Description _____
Alias _____	Description _____
Alias _____	Description _____
Alias _____	Description _____

Survey by William Ruppert, LS #866 - For: Don Phillips -
Sept. 1984 - C.S. File 58/215

Found - ^{31"} ~~22"~~ D. Fir, good scar, and BLM BT tag.
 Set 1" x ^{30"} ~~30"~~ Iron pipe with ^{2 1/2"} ~~2 1/2"~~ brass cap, N.56°W., 48.5 ft.
 from bearing tree. Brass cap mkd. T 30 S
 MON PROT, 12" WC -
 FROM ROUGH 3' DIAM. | 217.8
 MOUND OF STONE ----DLC47

R4W
 LS 866
 1984
 Set a ^{5/8"} ~~5/8"~~ x 30" Iron rod with a ^{3/4"} ~~3/4"~~ brass washer marked
 LS866, N.79°07'E., 26.81 ft. as a reference. ~~GONE~~

Fd. OK by D. Beedle, Sept. 2003 - see part. plat 2003-0074

NEW BTs

12" P. PINE SCRIBED "WC SSW/DLC 47" "CSBT" S 70° E, 16 1/2'

24" P. PINE SCRIBED "WC SSW/DLC 47C5" "BT" N 4 1/2° W, 24 1/2'

MON IS GENTLE EAST SHORE SLOPE OF SOUTH UMPQUA, NEAR MEAN HIGH WATER LINE

CS 67/46-21

6

24
24
371
071