

GOVERNMENT CORNER RESTORATION FORM
DOUGLAS COUNTY SURVEYOR

TOWNSHIP 32S RANGE 06W SECTION 33

PLSS/GCDB No. 32-06-300200

CORNER DESIGNATION: Section Corner of 28,29,32 and 33

FILED
Date: 3-17-2020

By: *X*

Corner Form: CS 67/46-18

Field Notes: *Legs*

DOUGLAS COUNTY SURVEYOR

DATE: April, 4, 2016

- Condition Report Only
- Not Found
- Renewed
- Unrecorded
- Surveyed In
- Referenced Out

CORNER HISTORY, PREVIOUS RENEWALS OR SURVEYS:

- See DCSO Survey & Corner Records for PLSS 32-06-300200

MONUMENT DETAIL

MONUMENT FOUND (CONDITION AND SOURCE):

- Found a 1" i.d. iron pipe by S.J. Flause, Deputy County Surveyor, in 1981 per C.S. File 61/19, firmly set, projecting 3" above the ground with a 2 1/2" diam. brass cap marked as follows:

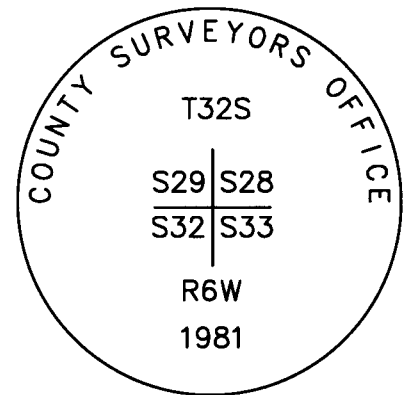

ACCESSORIES (CONDITION, SOURCE & RECORD):

An original bearing tree George W. Hyde and Charles H. Gardner, Deputy Surveyors, in 1855:

- A root hole bears S. 56° E., 28.4 ft. with a rotted 21" x 2 ft. tall fir stump is tipped downhill out of position.

Bearing Trees by S. J. Flause in 1981:

- A root hole bears N. 51 1/2° E., 26.0 ft. with a D. fir stump tipped out of position, upside down and buried laying alongside.
- A 15" Grand fir bears S. 32° W., 29.0 ft. with a healed blaze. (Rec. 29.6 ft.)
- A 22" D. Fir bears N. 3° W., 28.6 ft. with a healed blaze.

New Bearing Trees:

- A 11" Grand fir bears N. 30° E., 42.2 ft. scribed "T32S R6W S28" "CS BT"
- A 9" Maple bears S. 82 1/2° E., 34.8 ft. scribed "T32S R6W S33" "CS BT"

LOCATION & COMMENTS:

All bearing trees have BT tags attached. All new bearing trees have double blazed faces with bearings measured to the center of the tree at the root crown and distances measured to the side and center of the root crown.

Monument falls near the bottom of a shallow draw in the NW corner of new clearcut with older reprod. fir in the NE and partial cut old growth in the SW.

GEODETIC COORDINATES
LATITUDE:
LONGITUDE:
ELLIPSOID HEIGHT:
DATUM: NAD 83
SOURCE: Trimble GeoXT 6000

COMPASS DECLINATION: 15° E.
AGENCY: DCSO
PARTY CHIEF: S. J. Flause
WITNESSES: M. S. Koch
NOTES: Attached

REGISTERED
PROFESSIONAL
LAND SURVEYOR

Kristian O. Degroot

OREGON
JULY 17, 1981
KRISTIAN O. DEGROOT
1941

RENEWAL DATE: 12-31-2021

C.S. FILE 67/46-18

APRIL 4, 2016

T32S, R06W, SW28, PLSS 300200

MONUMENT FOUND:

FROM THE 1981 DCSD RENEWAL, THE BC/IP MONUMENT. A 2 1/2" DIA. BRASS CAP ON A 1" I.D. IRON PIPE SET PLUMB AND PROTRUDING 3" ABOVE GROUND. THE BRASS CAP IS MARKED AS FOLLOWS:

"DOUGLAS COUNTY SURVEYOR"

T32S

S29 | S28

S32 | S33

R6W

1981

ACCESSORIES FOUND:

EVIDENCE OF ONE O.B.T.

A FIR 5" DIA. NOW A 2 1/2" DIA. 2 FT. TALL ROTTED FIR STUMP WITH A PREVIOUSLY OPENED BUT NOW COMPLETELY ROTTED AWAY BLAZE IS TIPPED DOWNHILL OUT OF POSITION. THE ROOTHOLE OF THIS STUMP BEARS S56°E, 28 1/2 FT. DISTANT (AS PER RECORD).

EVIDENCE OF THE THREE 1981 RENEWAL B.T.'S.

A 10" DBH D. FIR NOW A D. FIR STUMP, TIPPED OUT

②

CS 67146-18

(E)
T32S, R06W, PLSS 300200 (CONT'D)

● UPSIDE DOWN AND BURIED (SIZE NOT PRACTICAL TO MEASURE), BLAZE EVIDENCE NOT VISIBLE. THE ROOTHOLE OF THIS B.T. STUMP BEARS $N51\frac{1}{2}^{\circ}E$, 26⁰ FT. DISTANT (AS PER RECORD).

● A 6" DBH W. FIR, NOW A 15" DIA. GRAND FIR (A.K.A. ^{LOWLAND} WHITE FIR) WITH A FULLY HEALED DOUBLE BLAZE; BEARS

● $S32^{\circ}W$, 29⁰ FT. DISTANT (RECORD $S32^{\circ}W$, 29⁰ FT.).

● AN 11" DBH D. FIR, NOW A 22" DIA. D. FIR WITH A FULLY HEALED DOUBLE BLAZE; BEARS $N03^{\circ}W$, 28⁰ FT. DISTANT (AS PER RECORD).

NEW ACCESSORIES:

● AN 11" DIA. GRAND FIR SCRIBED "T32SR6W S28" "CSBT" ON A DOUBLE BLAZE; BEARS $N30^{\circ}E$, 42⁰ FT. DISTANT.

● A 9" DIA. MAPLE SCRIBED "T32SR6WS33" "CSBT"; BEARS $S82\frac{1}{2}^{\circ}E$, 34⁰ FT. DISTANT.

DECLINATION $15^{\circ}E$

● BRASS CAP MONUMENT IS NEAR BOTTOM OF A SHALLOW DRAW IN THE NW CORNER OF NEWER CLEARCUT. OLD REGROWTH FIR IN NE QUADRANT. PARTIAL CUT OLD GROWTH FIR IN SW QUADRANT.

③

CS 67/46-18

(3)
T32S, R06W, PLSS 300200 (CONT'D)

● OLDER REPROD FIR IN NW QUADRANT.

⌘ S.J. FLAUSE

⌘ M.S. KOCH

⌘ Stephen John Flause

(4)

CS 67/46-18

(4)

T32S, R06W, PLSS 300200 (CONT'D)

SKETCH SHOWS LIVE B.T.'S ONLY:

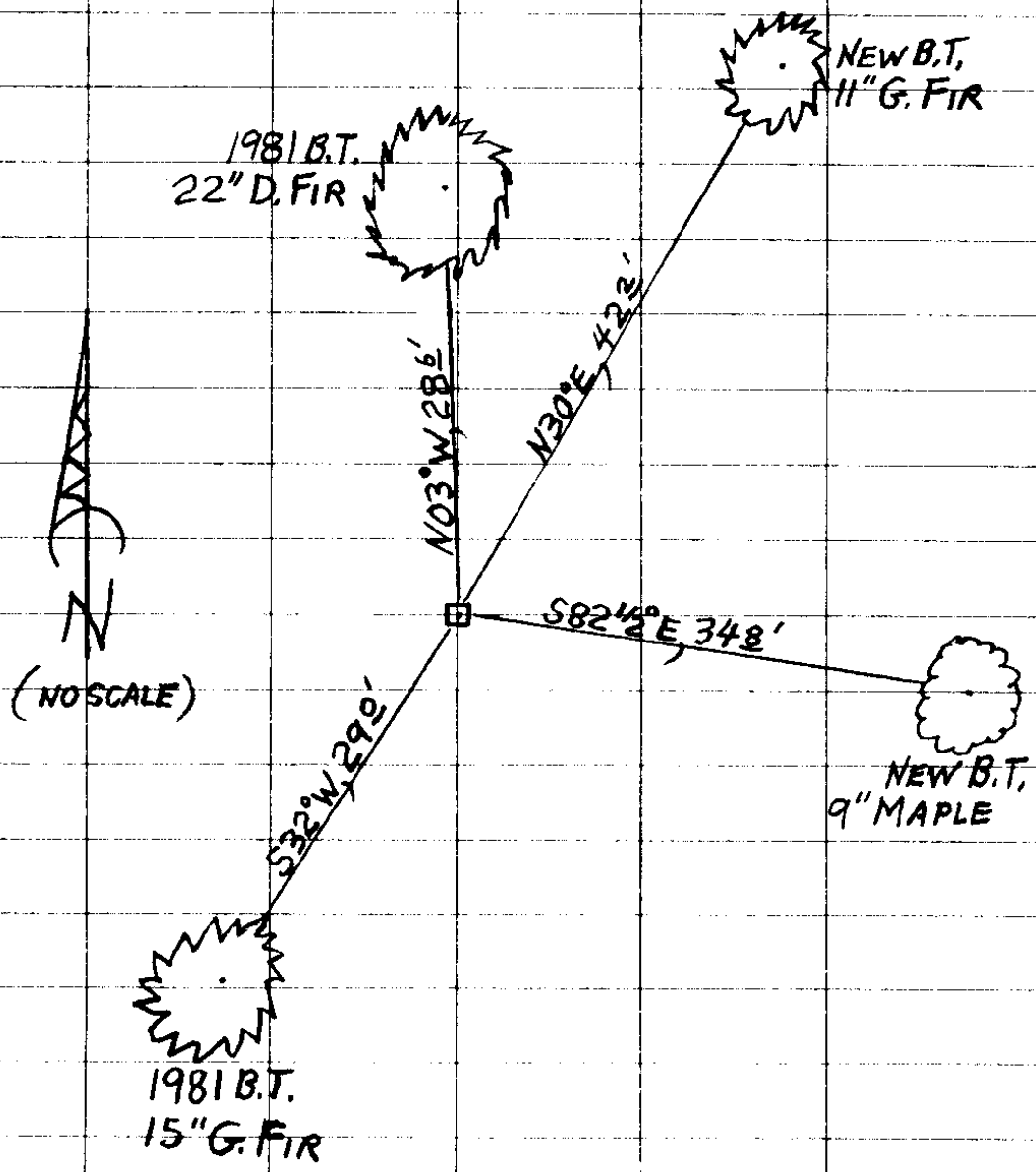

(5)

CS 67 / 46-18

ie RON QUIMBY 673-0166
OFFICE #

Renew request by R. Quimby 4/4/16

TOWNSHIP 32 RANGE 06 POINT IDENTIFIER # 300200

PRIMARY CORNER DESCRIPTION Sec. Cor. for 28, 29, 32 and 33

CALL MONDAY

Alias	Description
_____	_____
_____	_____
_____	_____
_____	_____

GLO survey by George W. Hyde and Charles H. Gardner, Deputy Surveyors, under Contract #54, dated Feb. 19, 1855 (DCSO records Vol. 20 Page(s) 8652-53)

Set post cor. to secs. 28, 29, 32 and 33, from which

- A Laurel 10" dia., bears N.8°E., 22 lks. dist. ¹⁴ 22
- A Laurel 10" dia., bears N.33°W., 63 lks. dist. ⁴¹ 58
- A B.Oak 10" dia., bears S.26°W., 47 lks. dist. ³¹ 02
- A Fir 5" dia., bears S.56°E., 43 lks. dist. ²⁸ 38

A.R. Evans - 1953 - C.S. File 41/241

Found Cedar post, 2 BTs

- 18" Fir, S.50°E., 28.2 ft.
- Madrone, N.33°W., 41.6 ft.

Douglas Co. Surveyors Office - S.J. Flauser, Deputy, Terrie Plouff; Karen Mosely, crew - April 6, 1981 - C.S. File 61/19

Found - A cedar post approx. 12" dia. & 8 ft. long. Post has rotted off approx. 2" below ground level. The upper 5 ft. of said post has fence wires attached from fences running South and East; this section of post has rolled downhill and lies 6 ft. southeast of the above mentioned post remains in the ground.

21'x2' TALL An orig. 5" Fir now a 22" DBH D.Fir bears S.56°E., ^{28.4} 28.4 ft. Tree has an opened face but no scribe marks are observed. Tree is opened further to reveal orig. axe marks and a scribed "T" (age verified by growth ring count) ^{ROOT HOLE} ^{NOW ROTTED NO SCRIB.}

Possible but inconclusive evidence of a stump hole is found at the record bearing and distance of the orig. NW bearing tree.

No evidence of the other orig. BTs is found.

The location of the cedar post remains in the ground, which agrees with the record bearing and distance from the orig. SE BT, is referenced out, the post remains are removed and a DCSO 2 1/2" brass cap on a 1" x 30" iron pipe is placed in the referenced location. Cap monument firmly set and protrudes 5" from ground and mkd: DOUGLAS COUNTY SURVEYOR T32S S29 S28 S32 S33 R6W 1981. ^{FIRM PLMB} ^{PROT 3"}

New BTs -10" DBH D.Fir bears N.51°E. ^{RN} 26.0 ft. Tree is scribed T32S R6W S28 CS BT on a double blaze.

15" 6" DBH W.Fir bears S.32°W., 29.0 ft. Tree is scribed T32S R6W S32 CS BT on a double blaze. ^{FHDB}

22" 11" DBH D.Fir bears N.06°W., 28.6 ft. Tree is scribed T32S R6W S29 CS BT on a double blaze. ^{FHDB}

All BTs are tagged with DCSO BT tags.

NEW BTs

11" G FIR "T32SR6WS28" "CSBT" N30°E, 42 2/3' CS62/46-18

9" MAPLE "T32SR6WS33" "CSBT" S82 1/2°E, 34 1/2'

DOUGLAS COUNTY SURVEYOR
T32S
S29 | S28
S32 | S33
R4W
1981

Handwritten notes on left margin, partially obscured.

STAMP

Handwritten circled number 6.