

GOVERNMENT CORNER RESTORATION FORM
DOUGLAS COUNTY SURVEYOR

FILED
Date: 3-17-2020

By: JC

Corner Form: CS 67/46-14

Field Notes: 8 pgs

DOUGLAS COUNTY SURVEYOR

DATE: November, 3, 2015

- Condition Report Only
- Not Found
- Renewed
- Unrecorded
- Surveyed In
- Referenced Out

TOWNSHIP 25S RANGE 04W SECTION 17

PLSS/GCDB No. 25-04-240400

CORNER DESIGNATION: 1/4 Corner of sections 17 & 20

CORNER HISTORY, PREVIOUS RENEWALS OR SURVEYS:

- See DCSO Survey & Corner Records for PLSS 25-04-240400

MONUMENT FOUND (CONDITION AND SOURCE):

- Found a 1"x1"x 36" "T-iron" by W. Haines per M 2-14 in 1956, out of position, bent and laying on the surface of the ground. A 2" I.D. iron pipe by Zirpel, Corbin and Roseberry per a 1959 USBLM Dependent Resurvey, found out of position laying on the surface of the ground with a bent 3 1/4" brass cap:

ACCESSORIES FOUND (CONDITION AND SOURCE):

An original bearing tree by W. H. Byars in 1871:

- A rotted root remains of a 18" D. fir bears N.32°W., 38.3 ft. and bearing trees by Zirpel, Corbin and Roseberry in 1957:
- A root hole bears N.83°E., 98.7 ft. with a uprooted and rotted 24" D. Fir alongside
- A 32" x 4' tall Cedar stump bears S.41 1/2°W., 32.7 ft. with a healed blaze. and a bearing tree by V. Tracy, DCSO in 1965 per C.S. File No. 53/47:
- A 42" Incense Cedar bears N.10°W., 55.1 ft. with a healed blaze.

MONUMENT DETAIL

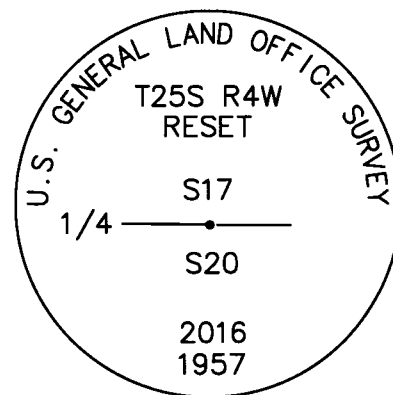

MONUMENT SET (PROCEDURE AND DETAIL):

At the position determined from the found accessories, the 1957 USGLO monument is reset 24" in the ground and now projects 6" above the ground. The brass cap is re-stamped "RESET 2016" as noted. The 1"x1"x36" "T-iron" is straightened and reset on the East edge of the brass capped monument with its top just below the brass cap.

NEW ACCESSORIES:

New Bearing Trees:

- A 6" D. Fir bears S 66 1/2° E, 35.9 ft. scribed "X", "CS BT"
- A 18" D. Fir bears N 45° W, 13.5 ft. scribed "1/4 S17 CS", "BT"

LOCATION & COMMENTS:

All bearing trees have BT tags attached. All new bearing trees have double blazed faces with bearings measured to the center of the tree at the root crown and distances measured to the side and center of the root crown.

Monument falls just south of a high East-West Ridge and 65 feet north of a gravel forest access road. Recently logged to the south with young reprod. to the NE and old growth to the NW.

REGISTERED
PROFESSIONAL
LAND SURVEYOR

Kristian O. Degroot

OREGON
JULY 17, 1981
KRISTIAN O. DEGROOT
1941

RENEWAL DATE: 12-31-2021

GEODETIC COORDINATES

LATITUDE:
LONGITUDE:
ELLIPSOID HEIGHT:
DATUM: NAD 83
SOURCE: Trimble GeoXT 6000

COMPASS DECLINATION: 15 1/4° E.

AGENCY:DCSO
PARTY CHIEF: S. J. Flause
WITNESSES: M. S. Koch
NOTES: Attached

C.S. FILE 67/46-14

Nov. 3, 2015

T25S, R04W, S¹/₄ SEC 17, PLSS 240400

MONUMENTS FOUND:

FROM THE 1956 HAINES RENEWAL, A 36" LONG HAINES "T" IRON IS EXTREMELY BENT AND LOOSE ON GROUND SURFACE.

FROM THE 1957-1958 BLM RENEWAL A 3¹/₂" DIA. BRASS CAP, ONE QUARTER OF WHICH IS BENT DOWN PERPENDICULAR FROM THE CAP SURFACE, ON A 2" I.D. X 36" LONG IRON PIPE IS LOOSE ON SURFACE OF GROUND. THE FOUND BRASS CAP MONUMENT IS MARKED AS FOLLOWS:

" U. S. GENERAL LAND OFFICE SURVEY "

T 2 5 S R 4 W

1/4 S17

520

1957

ACCESSORIES FOUND: (A POSITION FOR THE CORNER DETERMINED FROM THE NEAREST FOUND B. T. EVIDENCE IS USED FOR THE FOLLOWING BEARING AND DISTANCE MEASUREMENTS.)

(2)
T255, R04W, P155 240400 (CONT'D)

● POSSIBLE EVIDENCE OF ONE D.B.T.
A FIR 18" DIA. NOW A ROTTED FIR ROOT
FLAIR (THE HIGH POINT OF WHICH PROBABLY
CORRESPONDS WITH ORIGINAL CENTER OF THE
ROOT-CROWN); BEARS N32°W, 38³ FT.
DISTANT (AS PER RECORD).

● NO EVIDENCE FROM 1939 IRVING
RENEWAL TREES.

FROM THE 1957 BLM RESURVEY THE TWO
NEW BEARING TREES. A FIR 21" DIA. NOW
A FALLEN AND ROTTED FIR APPROX. 24"
IN DIAM WITH NO VISIBLE BLAZE OR SCAND-
ING MARKS; BEARS N83°E, 98⁷ FT. DIS-
TANT (AS PER RECORD).

● A CEDAR 14" DIA. NOW A 32" DIA., 4 FT. TALL
TAGGED CEDAR STUMP WITH A FULLY
HEALED BLAZE; BEARS S41¹/₂°W, 32⁷ FT.
DISTANT (AS PER RECORD).

FROM THE 1965 DCSD RENEWAL THE ONE
NEW BT, A 26" CEDAR, NOW A 42" DIA.

● INCENSE CEDAR WITH A FULLY HEALED
BLAZE; BEARS N10°W, 55⁴ FT. DISTANT
(AS PER RECORD).

(3)

CS 67/46-14

(3)
T255, R04W, PASS 240400 (CONT'D)

MONUMENT RESET:

AT THE POSITION DETERMINED FROM THE FOUND ACCESSORIES IS SET THE FOUND 1957 GLO BC/IP MONUMENT. THIS MON. NOW PROTRUDES 6" ABOVE GROUND.

THE FOUND HAINES "T" IRON IS STRAIGHTENED AND IS SET ON THE EAST EDGE OF THE B.C. MON. WITH ITS TOP JUST BELOW THE BRASS CAP.

THE STAMPING ON THE B.C. IS ALTERED AS FOLLOWS

" T255 R4W "

RESET

1/4 517

2016

1957

NEW ACCESSORIES:

A 6" DIA. D. FIR, SCRIBED "X" "CSBT" ON A HIGH-LOW BLAZE; BEARS $S66\frac{1}{2}^{\circ}E$, 35⁹ FT. DISTANT.

AN 18" DIA. D. FIR, SCRIBED "1/4 517 CS" "BT" ON A DOUBLE BLAZE; BEARS $N45^{\circ}W$, 13⁵ FT. DISTANT

(4)

DECLINATION $15N4^{\circ}E$ CS 67/46-14

(4)
T255, R. 04W, P. 55 24400 (CONT'D)

BRASS CAP IS ON GENTLE SOUTH SLOPE
NEAR TOP OF BROAD ENE RUNNING RIDGE.
GRAVELLED FOREST ACCESS ROAD TRAVERSES
RIDGE RUNNING EAST NORTH OF CORNER AND
WEST SOUTH OF CORNER.

A S.J. FLAUSE

□ Stephen John Flause

† M.S. KOCH ✓

CS 67/46-14

(5)

T255, R04W, 240400 11/3/15

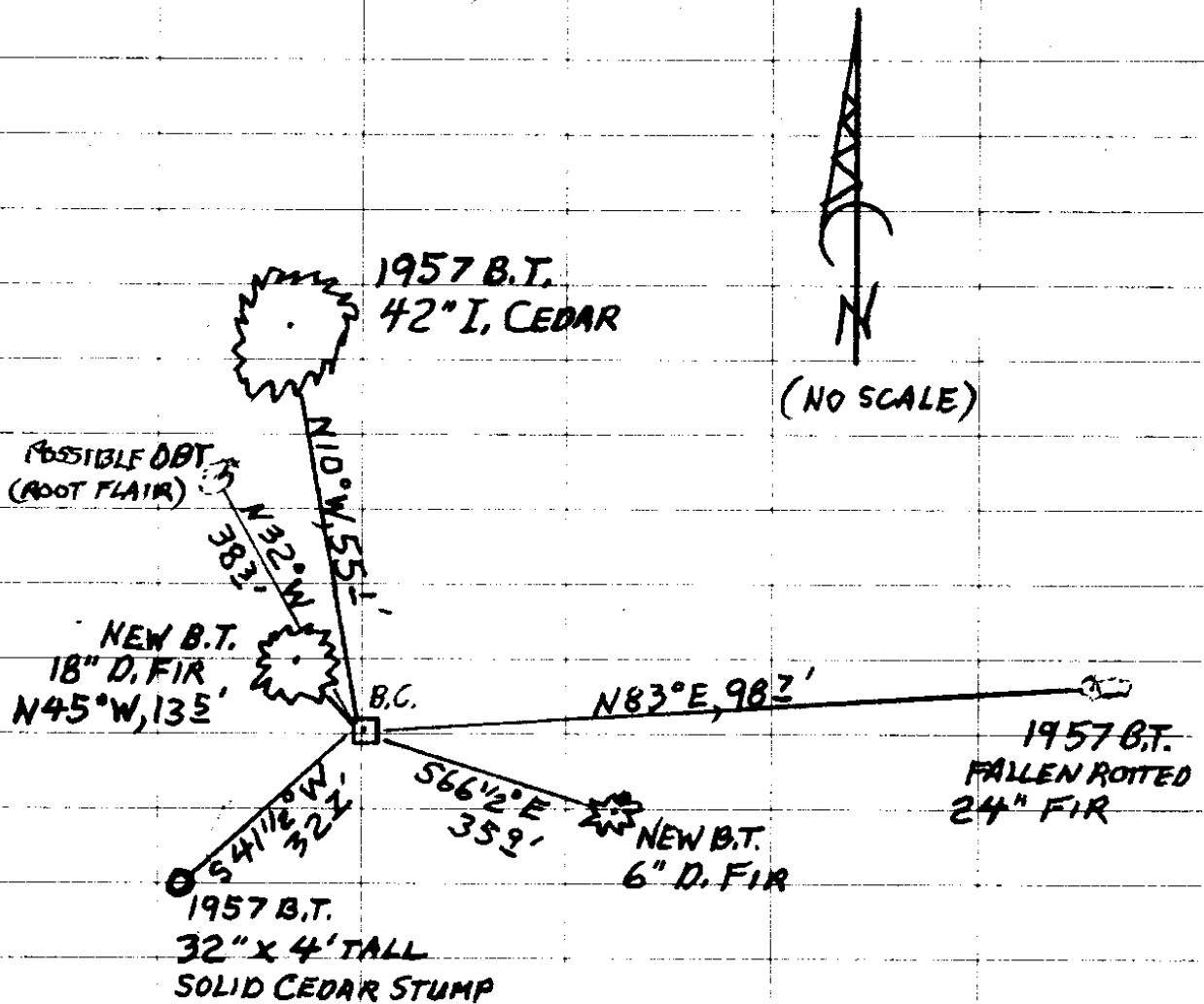

GRAVELLED FOREST RD.
SOUTH 65'

T S. J. FLAUSE
M Stephen John Flause
WIT. M. S. KOCH

6

CS 67/46-14

11/3/15

TOWNSHIP 25 RANGE 04 POINT IDENTIFIER # 240400

PRIMARY CORNER DESCRIPTION 1/4 Cor. for Secs. 17 and 20

Alias _____	Description _____
Alias _____	Description _____
Alias _____	Description _____
Alias _____	Description _____

Original - W. H. Byars, Deputy Surveyor under Contract #152 dated June 3, 1871 (DCSO records, Volume 9 Page 3755)

Set 1/4 sec. post, from which ³⁸²⁸
~~SEE BELOW~~ A Fir 16" dia. bears N.32°W., 58 lks. dist.
~~NO EVID.~~ A Fir 18" dia. bears S.70°E., 52 lks. dist.

Ben B. Irving, Dep. Co. Surveyor - For: State of Oregon
N.E. Richardson; Robt. Helliwell; Harvey Eppstein, Jr.
C.S. File 37/204 and M 5-66 (1939)

Location identified from original bearing trees, both of which are standing.

The BT, Fir 18" dia. S.70°E., 52 lks. is now dead and was chopped out. Scribe marks in good condition.
 Set a 6" x 6" x 48" Cedar Post for the corner properly scribed and marked new BTs as follows:
~~NO EVID~~ Fir 12" dia. N.37°E., 36 lks.
~~NO EVID~~ Fir 30" dia. S.79°W., 65 lks.
 Fir 24" dia. N.32°W., 58 lks. ~~REMN. OF ROOT FLAIR~~
 Original BT remarked. ^{383'}

Wilford N. Haines - For Mt. Baldy Lbr. Co. February 15, 1956
M 2 - 14

 Found scribed stake, original BT, S.70°E., 52 lks. (dead) and 30" Fir, S.79°W., 42.9 ft. Other 2 BTs down.
 Set 36" angle iron with brass cap inscribed, "Survey Point - Wilford N. Haines # 239".

Bureau of Land Management Dependent Resurvey - Zirpel, Corbin; and Roseberry - Special Instructions dated July 8, 1957 and July 15, 1958 (DCSO records, Volume 29, Page 12314)

 Found - Haines Angle iron.
~~GONE~~ A Fir snag (Orig.) 29" dia. bears S.70°E., 52 lks. with scribe marks 1/4 S visible on partly healed blaze.
~~GONE~~ An uprooted fir, 14" dia. bears N.37°E., 36 lks. with scribe marks CS visible on partly opened blaze. (A local bearing tree)

(Continued Next page)

CS 67/46-14

TOWNSHIP 25 RANGE 04 POINT IDENTIFIER # 240400

PRIMARY CORNER DESCRIPTION 1/4 Cor Sections 17 and 20

Alias _____	Description _____
Alias _____	Description _____
Alias _____	Description _____
Alias _____	Description _____

FOUND LOUGE ON SURFACE NO POS. U.S. GENERAL LAND OFFICE SURVEY
 Set an iron post, 3 ft. long 2" dia. 28" in the ground with
 brass cap marked T25S R4W
 3 1/2" 1/4 S 17 PLACE HAINES T IRON ON EAST EDGE
 SOUTH 1/4 BENT DOWN S 20
 PERK. TO CAP SURFACE 1957 NOW PRT. 6" from which
 SEE BELOW A Fir 21" dia. bears N.83°E., 149 1/2 lks. dist., marked
 1/4 S 17 BT. 982'
 " A Cedar, 14" dia. bears S.41 1/2°W., 49 1/2 lks. dist. marked
 1/4 S 20 BT. 322'
 Reset the angle iron alongside the iron post. FOREST SKVL RD SOUTH 65'

JUST SOUTH OF HIGH E-W RIDGE CREST RECENTLY LOGGED TO SOUTH
 YOUNG REPROD TO NE, OLD GROWTH TO NW
 Vernon Tracy, Doug. Co. Surveyors Office - Mike Darby; Jack
 Barnett - January/Feb. 1965 - C.S. File 53/47

Found - Haines "T" iron and BLM brass cap, 1957.
 DOWNROTEN 21" now 24" Fir N.83°E., 98 ft. down & dead,
 scribe visible.
 FHB 32" X 4" TALL - 14" now 20" Cedar S.41 1/2°W., 32 ft. scribe visible
 TAGGED STAMP on partially grown over face, alive & in good
 condition.
 FHB New BT 4226" Cedar N.10°W., 55.1 ft. mkd: 1/4 S17 CS BT.
 Corner lies on edge of heavy reproduction area approx. 200 ft.
 East of ridge top.

Fd. & used on BLM dependent resurvey by Wayne L. Rogers, Bryan
 S. Seibold, Cadastral Surveyors & Robert H. Browning,
 Surveying Technician, under Group #1755 surveyed June/Oct.
 1995 - (DCSO records Vol. 52 Page(s) 19899-900)

Found OK by T. Hostetter, May 2003 - M142-20

NEW BTs
 6" D. FIR "X" CSBT ON PI-LOW BLZ.; S66°2E, 352
 18" D. FIR "1/4 S17CS" BT ON DB: N45°W, 132
 ADDED STAMPING ON CAP NOW READ "T25S R4W"
 RESET
 1/4 S17
 S20
 2016
 1957