

GOVERNMENT CORNER RESTORATION FORM
DOUGLAS COUNTY SURVEYOR

TOWNSHIP 30 S RANGE 05 W SECTION 21

PLSS/GCDB No.30-05-047030

CORNER DESIGNATION: SW corner of DLC #47

FILED
Date: 3-16-2020
By: SC
Corner Form: 67/46-12
Field Notes: _____
DOUGLAS COUNTY SURVEYOR

CORNER HISTORY, PREVIOUS RENEWALS OR SURVEYS:

- SEE DCSO SURVEY & CORNER RECORDS FOR PLSS 30-05-047030

MONUMENT (CONDITION AND SOURCE):

- Found a 1" i.d. iron pipe, firmly set, projecting 12" above the ground with a 2 1/2" diam. brass cap marked as noted:

(Monument was found leaning out of plumb, we referenced it out and returned the monument to plumb position, When returned to plumb stamping is oriented Northeasterly and projects 9" above ground. All measurements were verified from said plumb position)

DATE: November, 8, 2012

Condition Report Only
 Not Found
 Renewed
 Unrecorded
 Surveyed In
 Referenced Out

MONUMENT DETAIL

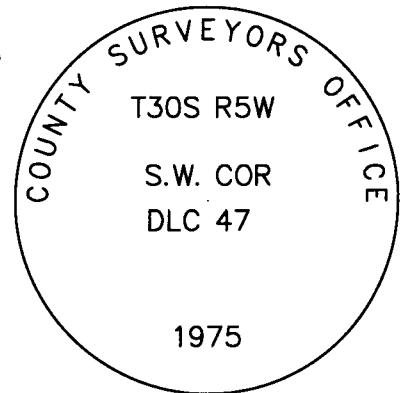

ACCESSORIES (CONDITION, SOURCE & RECORD):

Bearing Trees by E. Summers in 1920 per DCSO Vol. 3, Pg. 68:

- A 32" diam. madrone bears S. 19° E., 13.9 feet with a previously opened blaze showing no legible scribing.
- A 39" diam. madrone bears N. 69° W., 19.1 feet with a previously opened blaze "L 47" scribing visible.

Bearing Trees by J. Byron in 1963 per C.S. File No. 53/26:

- A 11" x 6' D. fir snag bears N. 41° E., 15.4 feet opened to reveal "D 47" scribing. (Rec. N. 39° E., 14.8 ft.)
- 3/4" I.D. I.P. protruding 10" bears N. 60° E., 1.35 ft. (rec. N. 70° E., 1.35 ft.) this monument may have been disturbed pipe is now against South edge of recently set large fence post with fence lines north and east.

New Bearing Trees:

- A 10" diam. D. fir bears S. 86° E., 19.0 feet, scribed "SW DLC 47 CS" "BT".

LOCATION & COMMENTS:

The corner falls near the top of a moderately steep NE slope in oak/madrone mixed timber.

All bearing trees have BT Tags attached. All new bearing trees have double blazed faces with bearing measured to the center of the trees at the root crown and distances measured to the side and center of the root crown.

GEODETIC COORDINATES
LATITUDE:
LONGITUDE:
DATUM: NAD 83
SOURCE: GeoXT6000
OREGON SOUTH-ZONE3602:
FILE PATH:

COMPASS DECLINATION: 15 1/2° E.
AGENCY:DCSO
PARTY CHIEF: S. J. Flause
WITNESSES: M. S. Koch
NOTES: ATTACHED



Kristian O. Degroot

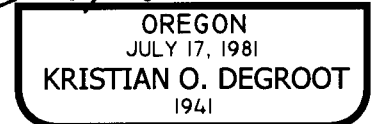

RENEWAL DATE: 12-31-2021

C.S. FILE: 67/46-12

GOVERNMENT CORNER RESTORATION FORM

FILED

TOWNSHIP 30S RANGE 05W SEC. 21 PLSS # 047030

Date: _____ By: _____

This survey consists of: _____

DOUGLAS COUNTY OREGON

DATE NOV. 8, 2012

Map: _____

Narrative: _____

Corner Rpt: _____

Corner Designation

DOUGLAS COUNTY SURVEYOR

SW
PLC 47

Previous Renewals: 1920, 1963, 1975
Monument(s) Found: _____ (Condition and Source)

- _____ Condition Report
- _____ Not Found
- Renewed
- _____ Unrecorded
- _____ Surveyed In
- _____ Referenced Out

A 2 1/2 INCH DIAMETER BRASS CAP (MARKED AS AT RIGHT) ON A 1 INCH I. D. IRON PIPE PROTRUDES 12 INCHES FROM GROUND AND LEANING ENE APPROX. 10 FEET FROM PLUMB

MONUMENT DETAIL

DOUGLAS CO. SURVEYOR
T30S R5W
S.W. COR.
D.L.C. 47
1975

(ALL FOLLOWING MEASUREMENTS ARE FROM ABOVE MONUMENT RETURNED TO ITS PLUMB POSITION.)

(WHEN MONUMENT IS RETURNED) TO PLUMB STAMPING IS ORIENTED NE'LY

FROM THE 1963 RENEWAL A 3/4 INCH I. D. IRON PIPE PROTRUDING APPROX 10 INCHES ABOVE GROUND BEARS N60°E, 13 3/5 FEET DISTANT (RECORD N70°E 13 3/5 FEET). THIS MONUMENTS POSITION MAY HAVE BEEN DISTURBED; PIPE IS NOW AGAINST SOUTH EDGE OF RECENTLY SET LARGE FENCEPOST.

Accessories Found

NO EVIDENCE OF D.B.T. POSITION NOW FALLS IN SKID ROAD.

TWO 1920 RENEWAL B.T.s. A LAUREL 21" DIA. NOW A 32 INCH DIAMETER MADRONE WITH A POSSIBLE PREVIOUSLY OPENED BLAZE SHOWING NO LEGIBLE SCRIBING; BEARS S19°E, 13 3/5 FEET DISTANT (AS PER RECORD).

A LAUREL 36" DIA. NOW A 39 INCH DIAMETER MADRONE WITH A PREVIOUSLY OPENED BLAZE SHOWING THE PARTIALLY LEGIBLE SCRIBING "L 47"; BEARS N69°W, 19 1/2 FEET DISTANT (AS PER RECORD).

EVIDENCE OF THE 1963 RENEWAL B.T. A 12" R. FIR NOW A PARTLY ROTTED 11 INCH DIAMETER APPROX 6 FOOT TALL DOUGLAS FIR STUB, WITH A HEALED BLAZE, WHICH IS OPENED ENOUGH TO REVEAL THE SCRIBING "D" "47"; BEARS N41°E, 15 1/2 FEET DISTANT (RECORD N39°E, 41 1/2 FT., EXISTING TAG FOUND IN 1975 WAS MARKED N41°E, 14 1/2 FT.)

PLUMB POSITION OF FOUND B.C. MONUMENT
BEST AGREES WITH FOUND ACCESSORIES.
MONUMENT IS RETURNED TO PLUMB POSITION
AND IS NOW FIRMLY SET PROTRUDING 9 INCHES
ABOVE GROUND.

N/A

New Accessories

A 10 INCH DIAMETER DOUGLAS FIR SCRIBED "SW PLC 47 CS" "BT" ON A
DOUBLE BLAZE; BEARS S86°E, 19° FEET DISTANT.

Sketch of Monument, Accessories, and General Area

Location & Comments

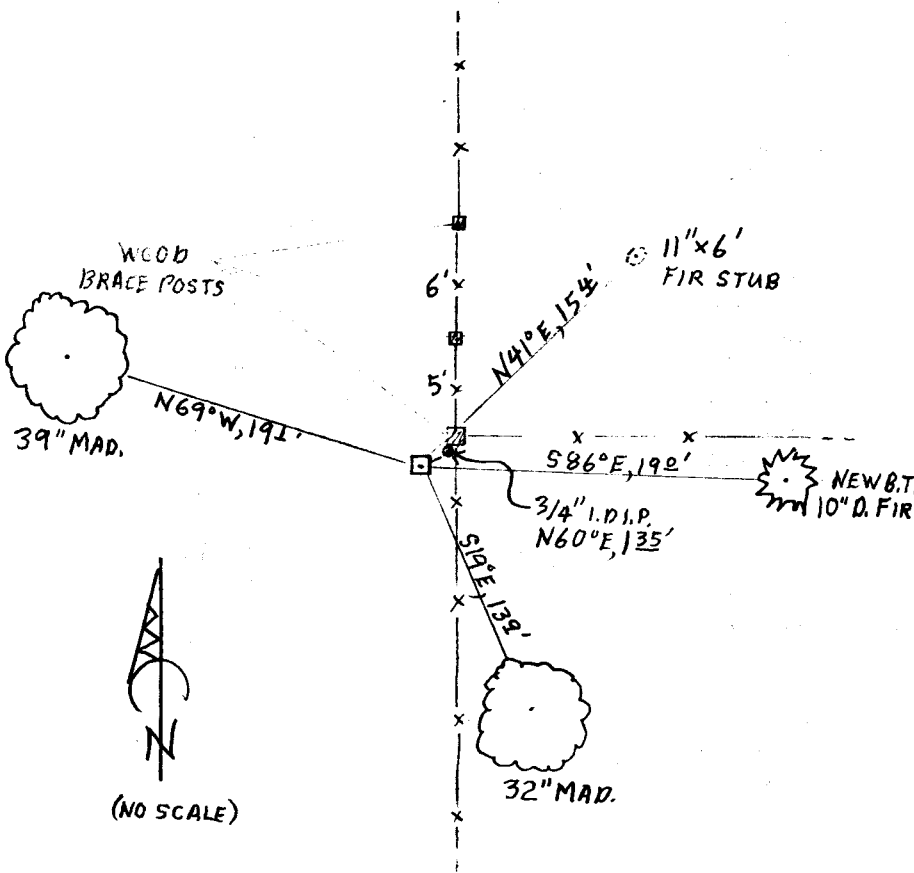

MONUMENT IS NEAR
TOP OF A MODERATELY
STEEP NORTHEAST SLOPE
IN MIX MADRONE, OAK
AND FIR WOODLAND.

Comp. Decline. 15 1/2° E
Agency PCSO
Party Chief S. J. FLAUSE
Note keeper Stephen John Flause
Witnesses M.S. KOCH

Surveyor's Seal

TOWNSHIP 30 RANGE 05 POINT IDENTIFIER # 047030

PRIMARY CORNER DESCRIPTION SW Cor Briggs DLC #47

Alias _____	Description _____
Alias _____	Description _____
Alias _____	Description _____
Alias _____	Description _____

Original DLC survey by Bowman and Burnett under Contract date Sept. 24, 1855

Set a post on hill side, marked, from which
A B.Oak 6" dia., bears N.20°E., 41 lks. **27⁰⁶ FALL IN ROAD** ^{OLD}

E. Summers - For: Bollenbaugh Estate - April 2, 1920 - Vol. 3 Page 68

Reset from old BTs. Set stone from which new BTs bear as follows:

A Laurel 21" dia., bears S.19°00'E., 21 lks. **13⁸⁶**
A Laurel 36" dia., bears N.69°00'W., 29 lks. **19¹⁴**

Doug. County Surveyors Office - James Byron, Deputy - Mike Darby; Jim Halterman - Oct./Nov. 1963 - C.S. File 53/26

Found - 3/4" I.P. at corner and both BTs as recorded by Summers. Each shows scribing.

Fence corner bears N.33°E., 8.0 ft.

New BT - 12" R.Fir bears N.39°E., 41.5 ft. scribed CL 47 SW CS BT. **N 41° E 15 4**

Doug. County Surveyors Office - Clell Goodwin; Gary Langlitz; Vic Cangie; Lenora Ladig - Oct. 24, 1975 - C.S. File 57/36

Found - 3/4" Iron pipe, from which

32" Orig. 21" now **33"** Laurel bears S.17°E., 13.9 ft. **POSSIBLE POB NO SCRIBE**
(Call: S.19°E., 13.9 ft.) - FROM BC

39" Orig. 36" now **39"** Laurel bears N.71°W., 20.2 ft. **POB**
(Call: N.69°W., 19.2 ft.) - FROM BC **2 1/2"** **L AND 47 LEGIBLE**

Set 1" x 30" I.Pipe with brass cap mkd: Douglas Co. Surveyor

FOUND PROT 12" LEANING PIPE 12"

NOW PLUMB PROT 9"

T 30 S R 5 W

S.W. Cor.

DLC, 47

ORIENTED NE WHEN PLUMB

15 4

Set brass cap to match orig. call I.P. bears N.70°E., 1.35 ft. - 12" R.Fir bears N.41°E., 14.8 ft. (Call: N.39°E., 41.5 ft. to notes - tag + indicates calls as N.41°E., 14.5 ft. **OPEN BLZ FIND 'D' 47"**

Fd. Brass cap as per record, R. Brown, May 1993, M 112-76 A-C
Fd. Ok by R. Brown, 1/97, M 124-40.

CAP IS ~ 1 1/2 WEST N-5 FNC
NEW BT 10" D FIR "SW DLC 47 CS" BT" BEARS S 86° E, 19 0 FT

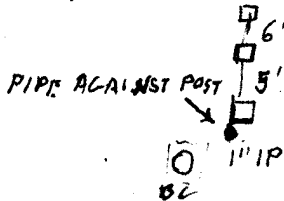

MON NE DR TOP MOD STEEP NE SLOPE

$$\begin{array}{r} 125 \\ \underline{6} \\ 750 \\ \underline{750} \\ 82,50 \end{array}$$
$$\begin{array}{r} 158 \\ \underline{6} \\ 948 \\ \underline{948} \\ 104,28 \end{array}$$
$$\begin{array}{r} 898 \\ \underline{6} \\ 5358 \\ \underline{5358} \\ 589,38 \end{array}$$
$$\begin{array}{r} 66 \\ \underline{462} \\ 61,38 \end{array}$$
$$\begin{array}{r} 93 \\ \underline{6} \\ 558 \\ \underline{558} \\ 61,38 \end{array}$$
$$\begin{array}{r} 245 \\ \underline{6} \\ 1470 \\ \underline{447} \\ 2617 \end{array}$$
$$\begin{array}{r} 41 \\ \underline{6} \\ 246 \\ \underline{246} \\ 8706 \end{array}$$
$$\begin{array}{r} 21 \\ \underline{6} \\ 126 \\ \underline{126} \\ 1386 \end{array}$$
$$\begin{array}{r} 29 \\ \underline{6} \\ 174 \\ \underline{174} \\ 1914 \end{array}$$