

**GOVERNMENT CORNER RESTORATION FORM
DOUGLAS COUNTY SURVEYOR**

Date: 12/5/2018 FILED
By: SC
Corner Form: CS 67/45-24
Field Notes: _____
DOUGLAS COUNTY SURVEYOR

TOWNSHIP 29S RANGE 02W SECTIONS 2&3 PLSS/GCDB No. 29-02-500700
CORNER DESIGNATION: North Section Corner of 2 & 3 only

CORNER HISTORY, PREVIOUS RENEWALS OR SURVEYS:

- See DCSO Survey & Corner Records for PLSS 29-2-500700
- The corner was restored from original evidence by Dennis Gaylord in 1978 per C.S. file 59/46-53

DATE: October, 9, 2018
 Condition Report Only
 Not Found
 Renewed
 Unrecorded
 Surveyed In
 Referenced Out

MONUMENT (CONDITION, SOURCE & RECORD):

- Found a 1" i.d. iron pipe, firmly set, projecting 13" above the ground in a 18" diam. stone collar by D. Gaylord in 1978 with a 2 1/2" diam. brass cap marked as noted:

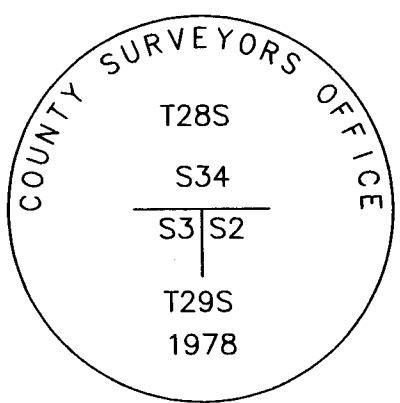

ACCESSORIES (CONDITION, SOURCE & RECORD):

- Original bearing tree by E. Strickler in 1917:
- A rotted and tipped out pine bears, S.79° E., 29.7 ft. to center of the roothole.

- Bearing Trees by D. Gaylord in 1978:
- A 25" D. fir bears, S.10° E., 144.4 ft. with a healed blaze.
 - A 29" D. fir bears, S.37° 30' W., 115.8 ft. with a healed blaze.
 - A 17" x 5' D. fir stump bears, S.40° W., 12.5 ft. with healed blaze.

- New Bearing Trees:
- A 11" D. fir bears N. 60° E., 14.5 ft. scribed "T28S R2W S34", "CS BT" .
 - A 9" D. fir bears N.82 1/2° W., 28.6 ft. scribed "T28S R2W S34", "CS BT".

LOCATION & COMMENTS:
All bearing trees have BT tags attached. All new bearing trees have double blazed faces with bearings measured to the center of the tree at the root crown and distances measured to a 2 1/2" PK nail in the side and center of the root crown.

The corner monument is approximately 50 ft. North of National Forest Road 2810.

✓ N 525821.63
GEODETTIC COORDINATES
LATITUDE: 43° 05' 01.717" N.
LONGITUDE: 122° 55' 18.585" W.
ELLIPSOID HEIGHT:
DATUM: NAD 83, Epoch 2010.00
SOURCE: Trimble GeoXT 6000
C092412A

E 4,274,404.10
COMPASS DECLINATION: 15° E.
AGENCY:DCSO
PARTY CHIEF: S. J. Flause
WITNESSES: Jeff A. Lorsung
NOTES: Attached

REGISTERED
PROFESSIONAL
LAND SURVEYOR

Kristian O. Degroot
OREGON
JULY 17, 1981
KRISTIAN O. DEGROOT
1941
RENEWAL DATE: 12-31-2019

CS 67/45-24

T 29 R 2 S 243 DATE 10-9-18

PLSS: 500 700

FOUND: 1" I.P. I.P. FIRMIY SET
PROJECTING 13" IN STONE
COLLAR 18"

ACC. FOUND: 25" D. FIR, S 10° E, (REC 18")
ROTTED PINE, S 79° E, 29' to root hole
17" x 5' FIR STUMP, S 40° W, 12.5 FT
29" D. FIR, S 37° 36' W, 115' FT (REC 22")

NEW:
11" D. FIR SCRIBED " T 28 S R 2 W S 34 "
N 60° E, 14.5 FT
9" D. FIR SCRIBED " " " "
N 82 1/2° W, 28.6'

CS 67/45-24

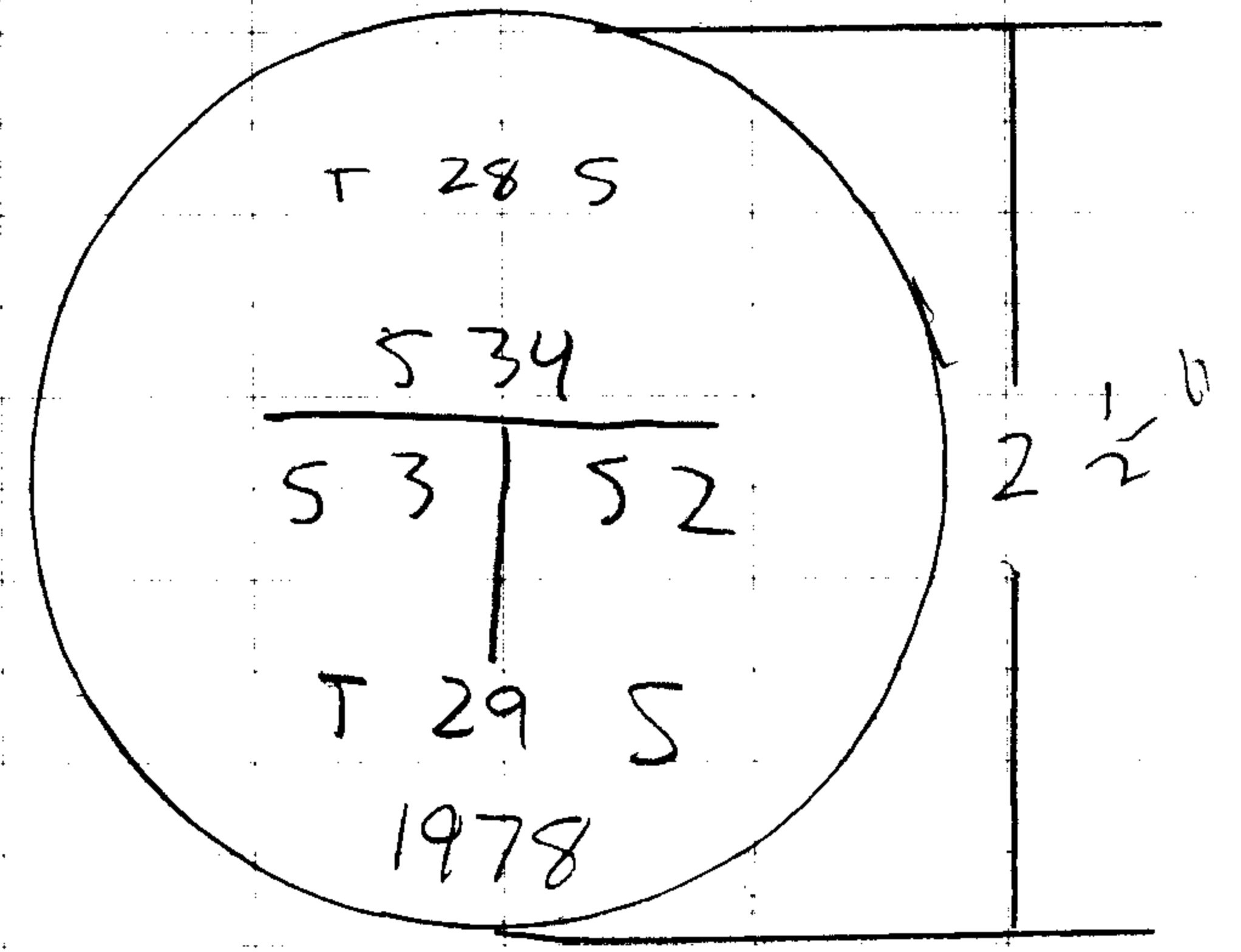

PROJECTING: 13"

SKETCH

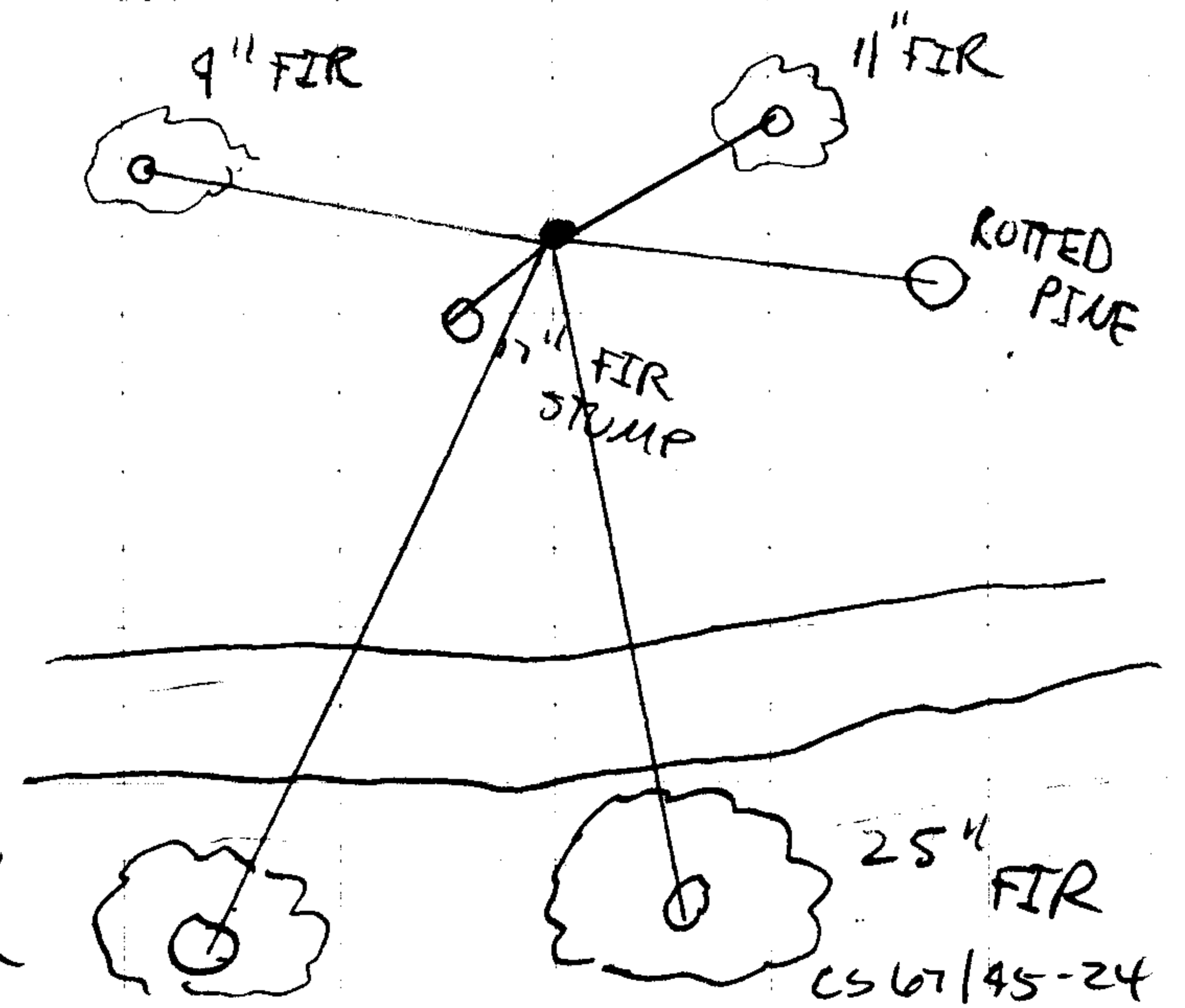

ALL WEATHER WRITING PAPER

144 FT

J.L. DARLING CORP. IACOMA, WA 98574-1017
www.RiteintheRain.com

No. 312