

**GOVERNMENT CORNER RESTORATION FORM
DOUGLAS COUNTY SURVEYOR**

TOWNSHIP 30S RANGE 03W SECTION 08

PLSS/GCDB No. 30-03-300540

CORNER DESIGNATION: 1/4 Corner for Sections 8 & 9

Date: 12/5/2018 FILED

By: SC

Corner Form: CS 67/45-20

Field Notes: _____

DOUGLAS COUNTY SURVEYOR

CORNER HISTORY, PREVIOUS RENEWALS OR SURVEYS:

- See DCSO Survey & Corner records for PLSS 30-03-300540

DATE: SEPT, 11, 2018

- Condition Report Only
- Not Found
- Renewed
- Unrecorded
- Surveyed In
- Referenced Out

MONUMENT FOUND (CONDITION AND SOURCE):

- A 2" i.d. iron pipe by B. A. Shaner in 1979 per M 79-2, firmly set, projecting 9" above the ground with a 2 1/2" brass cap marked as follows:

MONUMENT DETAIL

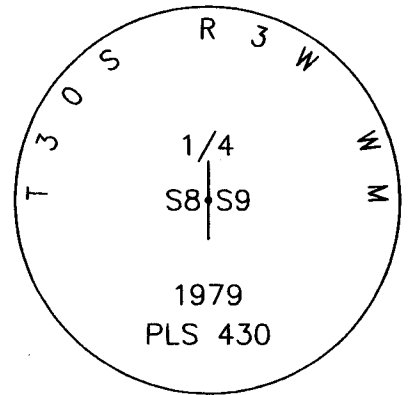

ACCESSORIES FOUND (CONDITION, SOURCE & RECORD):

Bearing trees by B. A. Shaner in 1979:

- A 29" x 3.5' tall D. fir stump bears S.52°E., 19.2 ft. with a healed blaze.
- A 15" x 6.5' tall D. fir stump bears S.72°W., 25.6 ft. with a healed blaze.

NEW ACCESSORIES:

- A 13" D. fir bears, N.0 1/2° E., 45.5 ft. scribed "1/4 S9 CS" "BT".
- A 17" madrone bears N.89 1/4°E., 55.2 ft.scribed "1/4 S9", "CSBT".
- A 5" D. fir bears N.55 1/2° W., 36 ft. scribed "X" "CSBT".

LOCATION & COMMENTS:

All bearing trees have BT tags attached. All new bearing trees have double blazed faces with bearings measured to the center of the tree at the root crown and distances measured to the side and center of the root crown.

A K-tag was placed due west approximately 45 ft. from the monument along the access road.

Northing 490,121.40
GEODETIC COORDINATES
LATITUDE: 42° 58' 56.359" N.
LONGITUDE: 123° 04' 52.067" W.
ELLIPSOID HEIGHT:
DATUM: NAD 83, Epoch 2010.00
SOURCE: Trimble GeoXT 6000
CO91114A

Easting 4,230,732.93
COMPASS DECLINATION: 15° E.
AGENCY:DCSO
PARTY CHIEF: S. J. FLAUSE
WITNESSES: J. LORSUNG
NOTES: ATTACHED

REGISTERED
PROFESSIONAL
LAND SURVEYOR

Kristian O. Degroot

OREGON
JULY 17, 1981
KRISTIAN O. DEGROOT
1941

RENEWAL DATE: 12-31-2019

CS 67/45-20

T30 R3 S849 DATE: 9-11-18

FOUND: FIRMLY SET 2" I.D., I.P.
W/ BRASS CAP

ACC. FOUND:
3.5' x 29" D. FIR STUMP, S52°E, 19 2/3 FT
6.5' x 15" D. FIR STUMP, S72°W, 25 6/8 FT

BOTH HEALED BLAZE

NEW:
13" D. FIR, N 0 1/2° E, 45 5/8 FT
SCRIBED "1/4 59 CS" "BT"
17" MADROVE, N 89 1/4° E, 55 2/3 FT
SCRIBED "1/4 59" "CSBT"
5" D. FIR, N 55 1/2° W, 36° FT
SCRIBED "X" "CSBT"

NOTES:
CROSSING TAG SET DUE WEST
APP. 45'

PLSS: 300540

CS 67/45-20

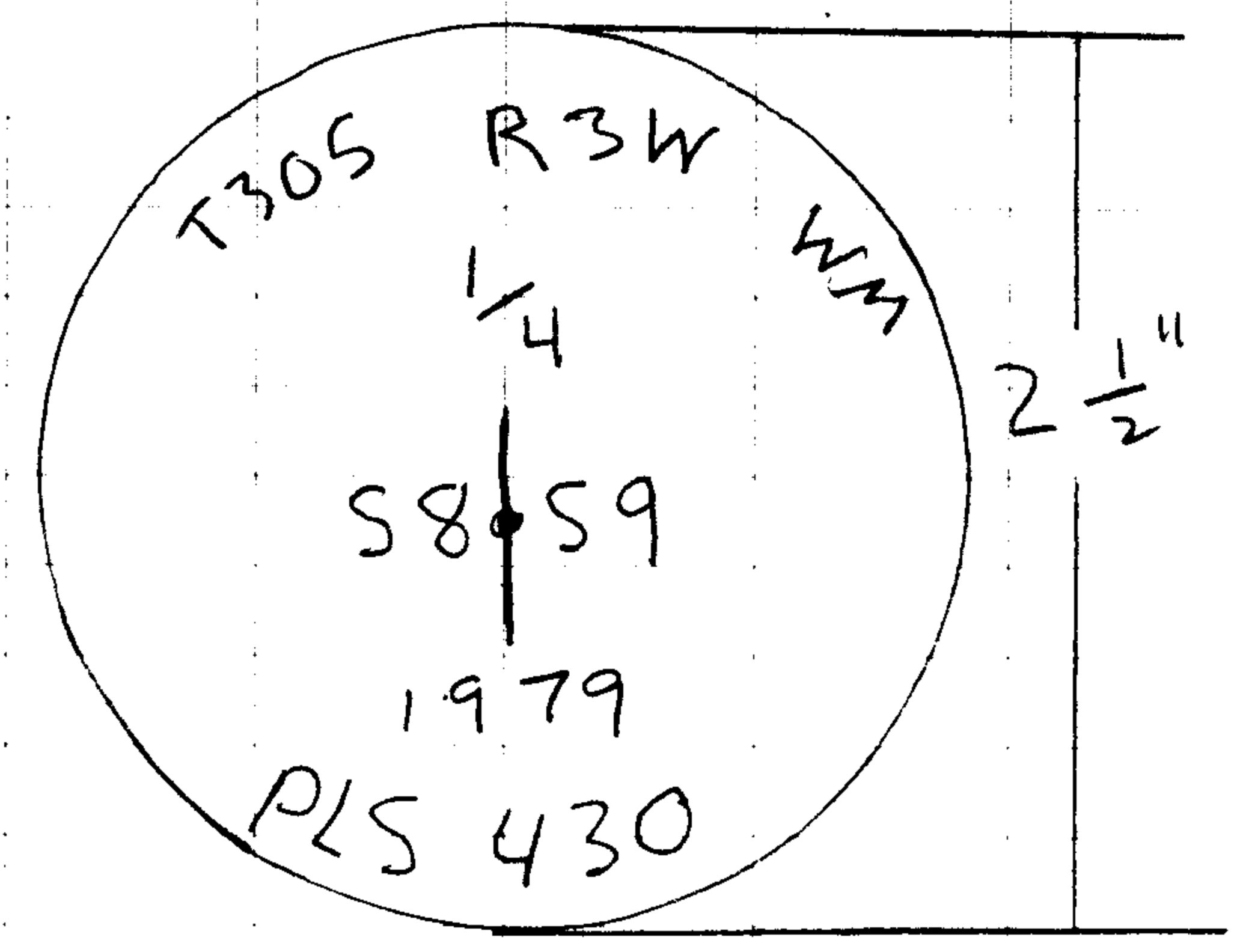

PROJECTING: 9"

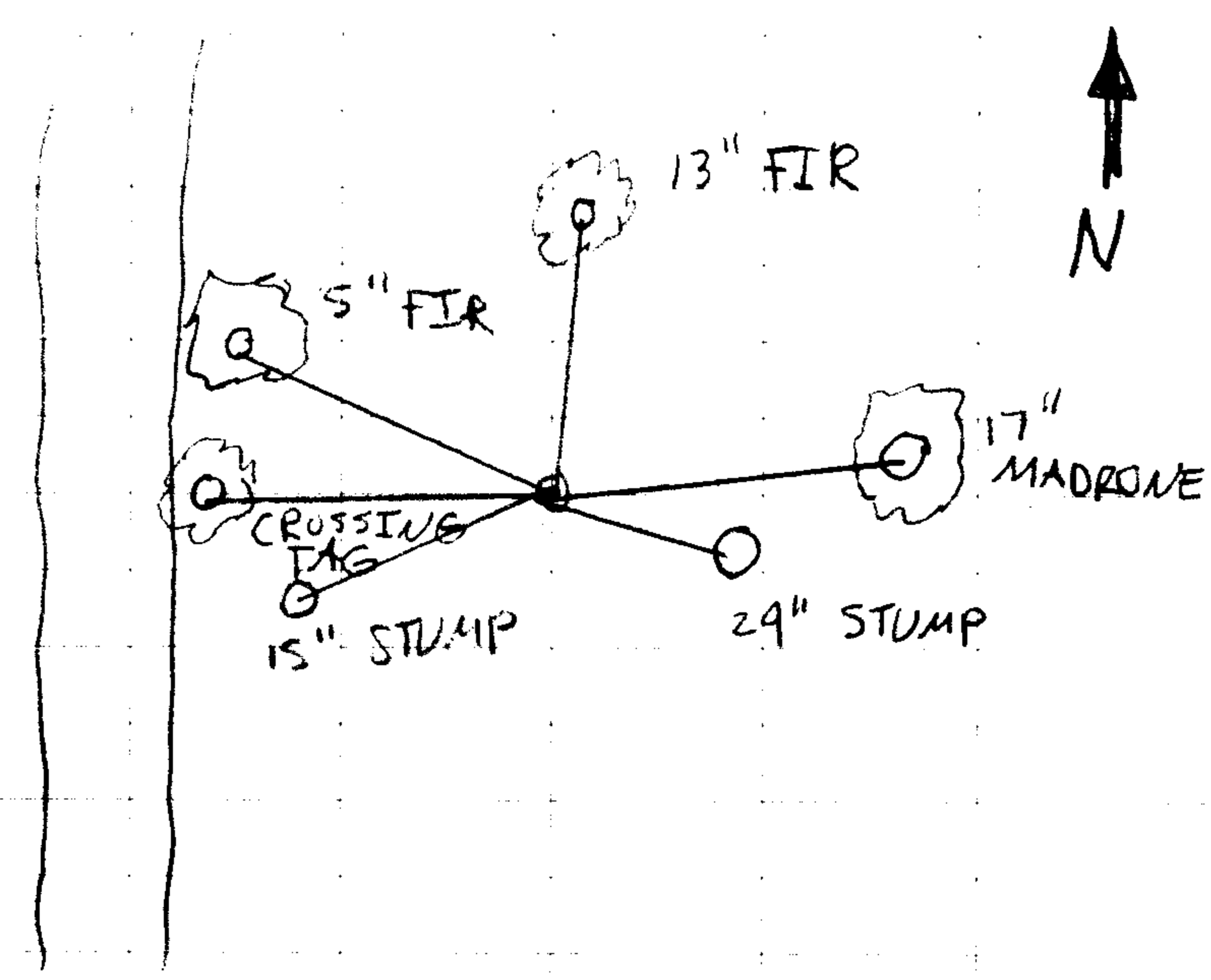

CS 67/45-20

ALL WEATHER WRITING PAPER

J.L. DARLING CORP. TACOMA, WA 98424-1017
www.RiteInTheRain.com

No. 312