

**GOVERNMENT CORNER RESTORATION FORM  
DOUGLAS COUNTY SURVEYOR**

TOWNSHIP 30S RANGE 03W SECTION 02

PLSS/GCDB No. 30-03-540640

CORNER DESIGNATION: Center 1/4 Corner of Section 2

**CORNER HISTORY, PREVIOUS RENEWALS OR SURVEYS:**

- See DCSO Survey & Corner records for PLSS 30-03-540640

**MONUMENT FOUND (CONDITION AND SOURCE):**

- A 5/8" iron rod by H. Johnstone in 1980 per M 86-6, firmly set, projecting 12" above the ground with a 2" aluminum cap marked as follows:

**ACCESSORIES FOUND (CONDITION, SOURCE & RECORD):**

- A rotted 8" diam. x 8" tall D. fir stump bears, N.79° E., 22.9 ft. (Rec. 23.6 ft.)

**NEW ACCESSORIES:**

- A 11" D. fir bears N.4°E., 6.6 ft. scribed "C 1/4 S2" "CSBT".
- A 12" D. fir bears, S.22 1/2° E., 5.2 ft. scribed "C 1/4 S2 CS" "BT".
- A 10" D. fir bears, S.84°W., 15.5 ft. scribed "C 1/4 S2" "CSBT".
- A 14" D. fir bears, N.38 1/2°W., 22.0 ft. scribed "C 1/4 S2", "CSBT".

**LOCATION & COMMENTS:**

All bearing trees have BT tags attached. All new bearing trees have double blazed faces with bearings measured to the center of the tree at the root crown and distances measured to the side and center of the root crown.

K-tag placed East approximately 50 ft. along the unnamed BLM ridge road.

Northing 495,107.50  
 GEODETIC COORDINATES  
 LATITUDE: 42° 59' 49.625" N.  
 LONGITUDE: 123° 01' 54.087" W.  
 ELLIPSOID HEIGHT:  
 DATUM: NAD 83, Epoch 2010.00  
 SOURCE: Trimble GeoXT 6000  
 091013A

Easting 4,244,118.23  
 COMPASS DECLINATION: 15° E.  
 AGENCY:DCSO  
 PARTY CHIEF: S. J. FLAUSE  
 WITNESSES: J. LORSUNG  
 NOTES: ATTACHED

Date: 12/5/2018 FILED  
 By: SC  
 Corner Form: CS 67/45-19  
 Field Notes: \_\_\_\_\_  
 DOUGLAS COUNTY SURVEYOR  
 DATE: SEPT. 10, 2018  
 Condition Report Only  
 Not Found  
 Renewed  
 Unrecorded  
 Surveyed In  
 Referenced Out

**MONUMENT DETAIL**

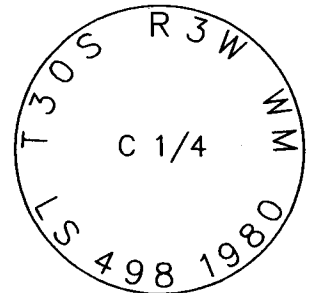

REGISTERED  
 PROFESSIONAL  
 LAND SURVEYOR  
  
 OREGON  
 JULY 17, 1981  
 KRISTIAN O. DEGROOT  
 1941  
 RENEWAL DATE: 12-31-2019

CS 67/45-19

T 30 R 3 S 02 C 1/4 DATE 09-10-18

ALL WEATHER WRITING PAPER

FOUND: FIRMLY SET 5/8 IR  
w/ ALUM CAP

ACC FOUND:

4" FIR - N 79° E ROTTED 8" x 8" STUMP

3" FIR - S 48° E (GONE - CUT BANK) 229

J. L. DARLING CORP. TACOMA, WA 98424-1017  
www.RiteInTheRain.com

NEW:

11" D. FIR, N 04° E, 6 1/2 FT "C 1/4 S 2"

"CSBT"

12" D. FIR, S 22 1/2° E, 5 2/3 FT "C 1/4 S 2 C"

"BT"

10" D. FIR, S 84° W, 15 1/2 FT "C 1/4 S 2"

"CSBT"

14" D. FIR, N 38 1/2° W, 22° FT, "C 1/4 S 2"

"CSBT"

CS 67/45-19

No. 312

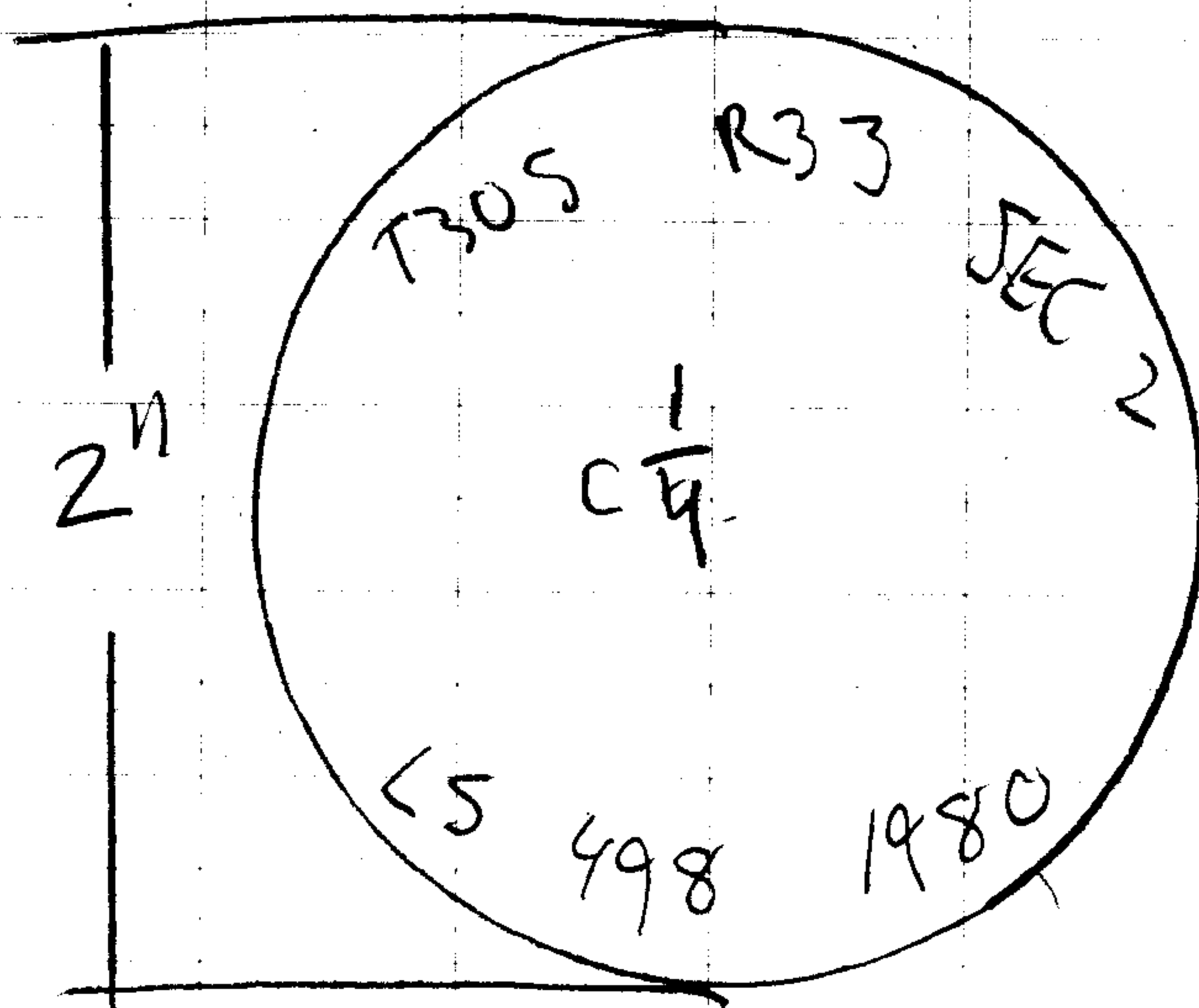

PROJECTING: 12"

SECTOR SKETCH:

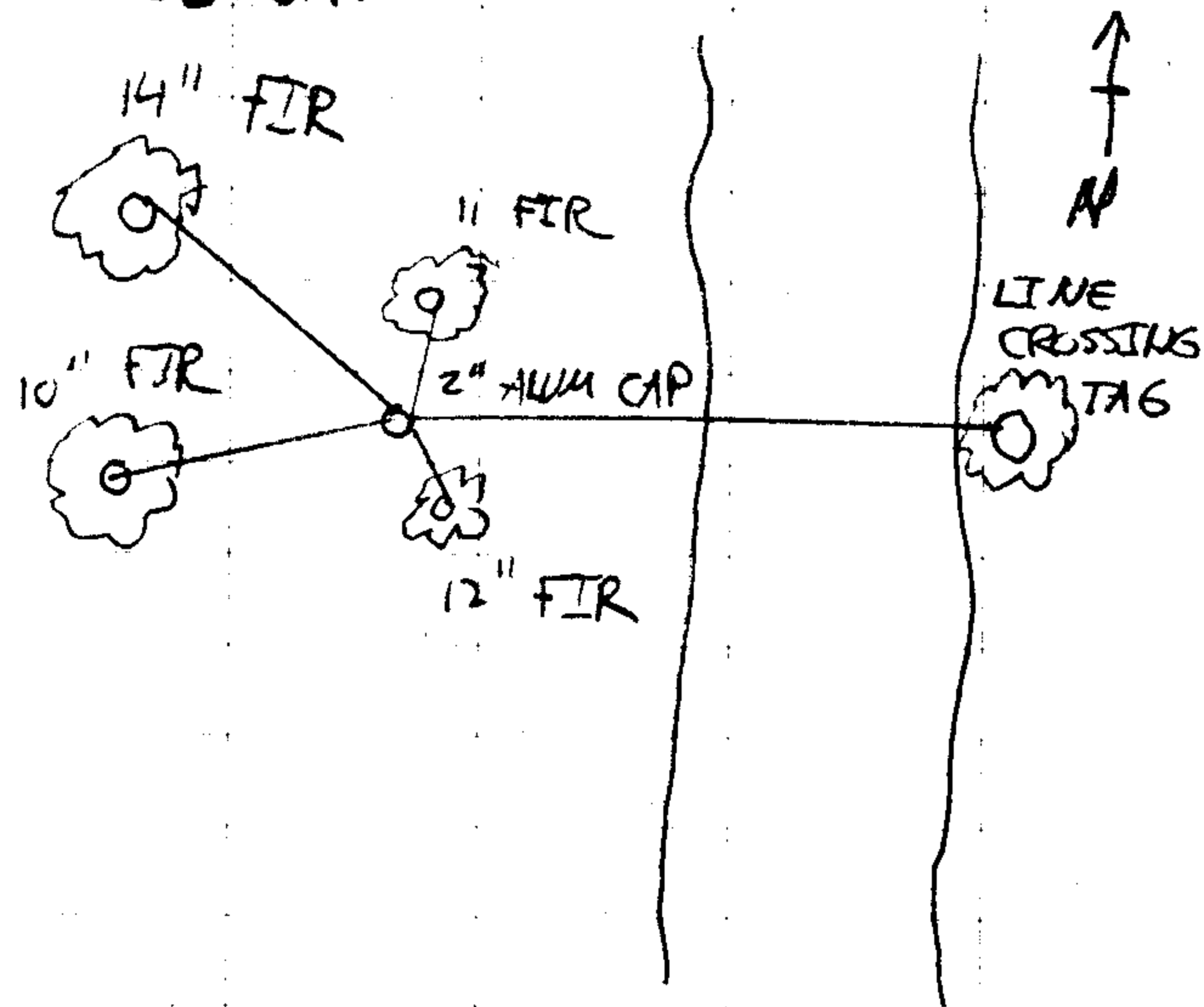

CS 67/45-19