

GOVERNMENT CORNER RESTORATION FORM  
DOUGLAS COUNTY SURVEYOR

TOWNSHIP 30S RANGE 04W SECTION 12

PLSS/GCDB No. 30-04-700557

CORNER DESIGNATION: AP on East body of Section 12

CORNER HISTORY, PREVIOUS RENEWALS OR SURVEYS:

- See DCSO Survey & Corner Records for PLSS 30-04-700557

MONUMENT FOUND (CONDITION AND SOURCE):

- Found a 2 1/2" o.d. iron pipe by J. Jelley, Cadastral Surveyor, per a 1965 USBLM Dependent Resurvey bent and buried 6" below ground with the brass cap missing.

MONUMENT SET (PROCEDURES AND DESCRIPTION):

- The USBLM Monument had been bent and graded over by a bulldozer. I referenced the base of the monument and measured N.2°34'E., 792.62 ft. (USBLM Rec. 792.66 ft.) to the brass capped iron pipe monument at the West quarter corner of Section 7 and also measured 46.5 ft. (USBLM Rec. 70.5 lks.) to the 1965 NE bearing tree stump to verify that the base of the monument was still in its original position and therefore accepted this position as the 1965 corner position.
- At the position of the base of the 1965 USBLM monument, I set a 1" x 32" i.d. iron pipe 26" in the ground in a 18" diam. stone collar with a 2 3/8" brass cap marked as follows:

ACCESSORIES (CONDITION, SOURCE & RECORD):

Bearing Trees by J. Jelley in 1965:

- A 12" diam. x 18" high sawn Cedar stump bears N.28°00' E., 46.5 ft. (Rec. N.30 1/2°E.)
- A 18" diam. rotted D. fir stump bears S.87° W., 101.0 ft.

New Bearing Trees:

- A 20" diam. x 12" high D. fir stump bears N.24° 27' E., 57.50 ft to a 60d spike in the top center of the stump.
- A 12" diam. x 12" high D. fir stump bears S.26° 33' E., 43.57 ft. to a 60d spike in the top center of the stump.
- A 7" diam. D. fir bears S.72° 34' W., 100.1 ft. scribed "AP S12 CS" & "BT" on a double blaze.
- A 24" diam. P. pine bears N.43° 44' W., 101.0 ft. scribed "AP S12" & "CS BT" on a double blaze.

LOCATION & COMMENTS:

The basis of bearings is N.2°34' E., 792.66 ft. between this corner (PLSS 30-04-700557) and the 1/4 |S7 only T.30S., R.3W. (PLSS 30-04-700566) per the 1965 USBLM Dependent Resurvey. Survey equipment: Nikon DTM 520 Total Station & a Trimble GeoXT 6000 handheld GPS receiver. The monument is located roughly 25 ft. East of the center of a spur road on the edge of a clearcut and approximately 150 ft. north of a 3-way road intersection.

GEODETIC COORDINATES  
LATITUDE: 42°58'44.14" N.  
LONGITUDE: 123°07'11.16" W.  
ELLIPSOID HEIGHT:  
DATUM: NAD 83  
SOURCE: Trimble GeoXT 6000

COMPASS DECLINATION: 15° E.  
AGENCY:DCSO  
PARTY CHIEF: S. J. Flause  
WITNESSES: Jeff A. Lorsung  
NOTES: Attached

FILED  
Date: 9-11-2018  
By: SC  
Corner Form: \_\_\_\_\_  
Field Notes: CS 67/45-7  
DOUGLAS COUNTY SURVEYOR  
DATE: August 28, 2018  
 Condition Report Only  
 Not Found  
 Renewed  
 Unrecorded  
 Surveyed In  
 Referenced Out

MONUMENT DETAIL

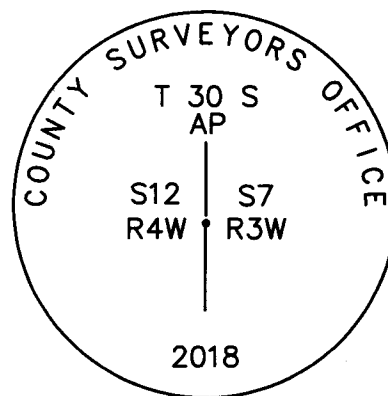

REGISTERED  
PROFESSIONAL  
LAND SURVEYOR  
*Kristian O. Degroot*  
OREGON  
JULY 17, 1981  
KRISTIAN O. DEGROOT  
1941  
RENEWAL DATE: 12-31-2019

CS 67/45-7

# NEW MONUMENT PLACED

T 30 R 04 S 12 E AP

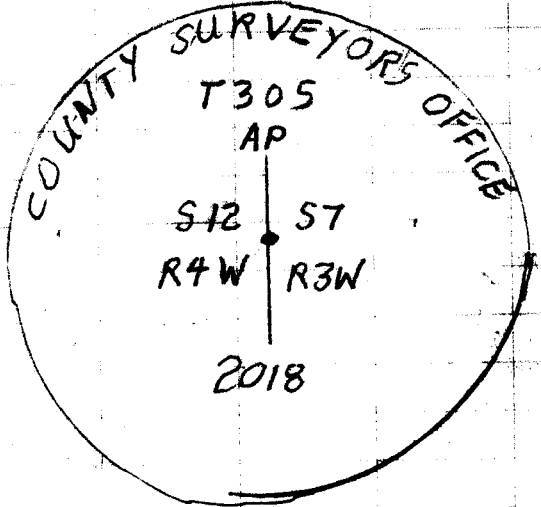

Found: 2 1/2" I.D. IRON PIPE  
 BEAT 6" UNDER GROUND  
 CAP MISSING

## ACCS FOUND:

8" CED. NOW 12" x 1 1/2" STUMP  
 BEARS N 28° 05' E, 46 5/8"

FIR ROTTED STUMP - S 87° W, 101°  
 NEW BT'S.

1 FT x 20" FIR. STUMP W/ SPIKE -  
 N 24° 27' E, 57 5/8 FT.

1 FT x 12" FIR STUMP W/ SPIKE -  
 S 26° 33' E, 43 5/8"

7" FIR -  
 S 72° 34' W, 100 1/2 FT.  
 SCRIBED "AP SIZES, BT"

24" PINE -  
 N 43° 44' W, 101° FT.  
 "AP SD, CSBT"

## PROJECTS 7" IN STONE COLLAR

