

GOVERNMENT CORNER RESTORATION FORM  
DOUGLAS COUNTY SURVEYOR

FILED  
Date: 12/12/2017

By: JC

Corner Form: CS 67/44-24

Field Notes: 6 pgs

DOUGLAS COUNTY SURVEYOR

DATE: JULY 20, 2017

Condition Report Only  
 Not Found  
 Renewed  
 Unrecorded  
 Surveyed In  
 Referenced Out

TOWNSHIP 30S RANGE 04W SECTION 7

PLSS/GCDB No. 30-04-039020

CORNER DESIGNATION: NW COR. CHARLES W. BECKWORTH DLC NO. 39

CORNER HISTORY, PREVIOUS RENEWALS OR SURVEYS:

- SEE DCSO SURVEY & CORNER RECORDS FOR PLSS 30-04-039020.
- ORIGINAL CORNER ESTABLISHED BY BOWMAN & BURNETT IN 1855.
- CORNER RESTORED FROM ORIGINAL EVIDENCE BY J. H. MARKHAM IN 1954 PER C.S. 41/308.
- CORNER RENEWED BY J.W. BYRON, DEPUTY CO. SURVEYOR, IN 1961 PER C.S. 49/67.
- CORNER RESTORED FROM C.S. 49/67 EVIDENCE BY G. QUIBELL, DEPUTY CO. SURVEYOR IN 1982 PER C.S. 62/1-24.

MONUMENT FOUND (CONDITION AND SOURCE):

- A 1"(I.D.) IRON PIPE BY QUIBELL IN 1982, FIRMLY SET, PROJECTING 2" ABOVE THE GROUND WITH A 2 1/2"BRASS CAP MARKED AS NOTED:
- UNDER THIS CORNER RENEWAL IT IS DETERMINED THAT THIS MONUMENT WAS INCORRECTLY SET FROM EXISTING EVIDENCE IN 1982 AND IS BEING RESTORED TO THE ORIGINAL CORNER POSITION AT A RECORD DISTANCE-DISTANCE INTERSECTION FROM AN ORIGINAL BEARING TREE AND A BEARING TREE BY BYRON IN 1961.

MONUMENT SET (PROCEDURES AND DESCRIPTION):

- THE 1982 BRASS CAP MONUMENT IS REMOVED AN RESET AT A POSITION N.55°32'15"E., 4.42 FT. FROM WHERE FOUND, NOW PROJECTING 4" ABOVE THE GROUND WITH THE DATE "2017" ADDED TO THE BRASS CAP.

ACCESSORIES FOUND (CONDITION, SOURCE & RECORD):

AN ORIGINAL BEARING TREE:

- A 38" DIA. x 30" TALL BROKEN AND PARTIALLY BURIED FIR STUMP BEARS S.17 1/2°E., 59.4 FT. WITH BLAZE BURLING NEAR THE ORIGINAL 26" DIA. AND FAINT ILLEGIBLE SCRIBE MARKS VISIBLE. (REC. S.18°E.)

AND A BEARING TREE BY MARKHAM IN 1954:

- A LARGE MULTI-TRUNK MAPLE BEARS S.61°W., 30.0 FT.

AND A BEARING TREE BY BYRON IN 1961:

- A 22" DIA. x 6' TALL BROKEN D. FIR SNAG BEARS N.39 3/4°E., 77.7 FT. WITH A HEALED DOUBLE BLAZE. (REC. N. 43 1/2°E.)

AND A BEARING TREE BY QUIBELL IN 1982 WITH A NEW TIE:

- A 19" DIA. x 4 1/2' TALL SAWN D. FIR STUMP BEARS S.20°E., 47.1 FT. WITH A HEALED DOUBLE BLAZE. (REC. S.22°E., 50.8 FT.)

AND A BEARING OBJECT BY QUIBELL IN 1982 WITH A NEW TIE:

- A 3/4" IRON ROD BURIED 2 " BELOW GROUND LEVEL BEARS N.31°43'39"W., 3.89 FT. (REC. N.63°E., 1.7 FT.)

A NEW BEARING TREE:

- A 24" DIA. I. CEDAR BEARS S.7 1/2°W., 51.3 FT. SCRIBED "NW DLC 39 CS BT".

A NEW BEARING OBJECT:

- A 5/8" x 32" IRON ROD BEARS EAST, 40.00 FT., SET 27" IN THE GROUND WITH A 1 1/2" ALUMINUM CAP STAMPED AS NOTED:
- A STEEL POST WITH A WHITE WITNESS SIGN ATTACHED BEARS SOUTH, 3.0 FT.

LOCATION & COMMENTS:

ALL BEARING TREES HAVE BT TAGS ATTACHED. ALL NEW BEARING TREES HAVE DOUBLE BLAZED FACES WITH BEARINGS MEASURED TO THE CENTER OF THE TREE AT THE ROOT CROWN AND DISTANCES MEASURED TO THE SIDE AND CENTER OF THE ROOT CROWN. SURVEY MEASUREMENTS WERE TAKEN WITH A NIKON DTM 520 TOTAL STATION.

THE CORNER FALLS ON A STEEP FILL SLOPE OFF THE WEST EDGE OF DAYS CREEK CUTOFF COUNTY ROAD NO. 42 APPROXIMATELY 0.55 MILES NORTH OF TILLER-TRAIL HIGHWAY NO. 227. SEE SKETCH MAP IN ATTACHED NOTES.

MONUMENT DETAIL

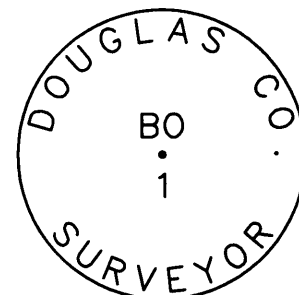
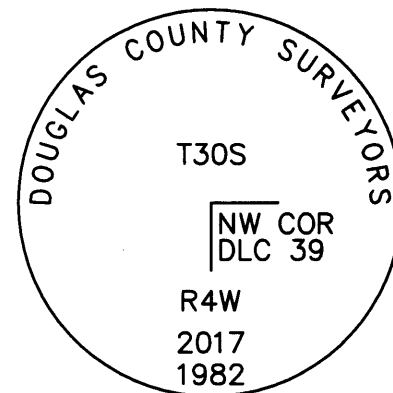

GEODETIC COORDINATES

LATITUDE:  
LONGITUDE:  
ELLIPSOID HEIGHT:  
DATUM: NAD 83  
SOURCE:

COMPASS DECLINATION: 15° E.

AGENCY:DCSO  
PARTY CHIEF: S. J. FLAUSE  
WITNESSES: M. KOCH  
NOTES: ATTACHED

REGISTERED  
PROFESSIONAL  
LAND SURVEYOR

*Kristian O. Degroot*

OREGON  
JULY 17, 1981  
KRISTIAN O. DEGROOT  
1941

RENEWAL DATE: 12-31-2017

CS 67/44-24

00 JULY 20 2017  
 T305, R04W, NW D1C 39 PLSS 089020  
 MONUMENT FOUND:  
 1982 2 1/2" DIAM B.C. OR A 1" I.D.  
 IRON PIPE, SET PLUMB, PARTIALLY  
 2" ABOVE GROUND. CAP IS MARKED  
 "DOUGLAS CO. SURVEYOR"  
 T305  
 NW COR  
 4  
 W D1C 39  
 1982  
 ACCESSORIES FOR FOUND MON:  
 POSSIBLE EVIDENCE OF THE ORIG.  
 26" RED FIR, NOW A 38" DIA. X 2 1/2 FT  
 TALL BROKEN AND PARTLY BURIED  
 FIR STUMP, BLAZE BURLING NEAR  
 CS 67/44-24A

(2)  
 T305, R04W, NW D1C 39 CONT'D.  
 RECORD ORIG. DIA., WITH POSSIBLE FAINT  
 ILLEGIBLE SCRIBING. THIS STUMP BEARS  
 S20°E, 62' DIST. (REC. S18°E, 59'4")  
 FROM 1954 MARKHAM RENEWAL;  
 A LARGE MULTI-TRUNK MAPLE FOUND  
 NEAR BED OF CALLED 12" MAPLE.  
 NO EVIDENCE OF 11' CEDAR REMAINS  
 FROM 1961 DCSO RENEWAL;  
 A 14" R. FIR NOW A 22" DIA. 6' TALL  
 BROKEN D. FIR SNAG WITH A FULLY  
 HEALED DOUBLE BLZ.; BEARS  
 N43°E, 78' DIST. (REC. N43'2"E,  
 77'3")  
 FROM 1982 DCSO RENEWAL;  
 A 3/4" DIA. IRON ROD OF UNKNOWN  
 ORIGIN (FIRST NOTED ON MAP M90-27)  
 SET PLUMB AND 2" BELOW GROUND;  
 CS 67/44-24B

(3)  
 T305, R04W, NW D1C 39 CONT'D  
 BEARS N63 1/4°E, 18' DIST. (REC. N63°E, 17')  
 A 10" FIR NOW A 19" DIA. 4' 1/2" TALL  
 SAWN D. FIR STUMP WITH A FULLY  
 HEALED DOUBLE BLAZE; BEARS  
 S22 3/4°E, 50' DIST. (REC. S22°E, 50'8")  
 DUE TO POOR DISTANCE MEASUREMENT  
 FROM FOUND 1982 B.C. MON. TO O.B.T.  
 STUMP A NEW POSITION FOR THE  
 B.C. MONUMENT IS DETERMINED. AT  
 THIS NEW POSITION THE DISTANCE TO THE O.B.T.  
 AND THE DISTANCES TO THE OTHER  
 ACCESSORIES FOUND PRIOR TO 1982  
 ARE ALL IN AGREEMENT.  
 1982 B.C. MONUMENT IS RE-  
 MOVED FROM GROUND AND RESET  
 AT A POSITION S55°32'15"E, 44'2" DIST.  
 CS 67/44-24C

cont

(4)

T305, R04W, SW 1/4 SEC 39 CONT'D

BRASS CAP MONUMENT IS NOW SET PLUMB  
PROTRUDING 4" ABOVE GROUND. MONUMENT  
IS MARKED AS PREVIOUSLY WITH THE RATE  
"2017" ADDED ABOVE THE EXISTING 1982.

ALL FOUND ACCESSORIES ARE AS PREV-  
IOUSLY DESCRIBED BUT ARE NOW ORIENTED  
TO BRASS CAP AS FOLLOWS:

THE O.B.T. STUMP BEARS S17°E, 594' DIST.  
THE 1954 MAPLE (NOW MULTI-TRUNK POSSIBLY  
REGROWTH) VERY CLOSE TO RECORD B&D.

THE 1961 NEW BT 14" R. FIR BEARS  
N39°34'E, 777' DIST.

THE 1982 FOUND 3/4" I.R. BEARS  
N31°43'39"W, 389' DIST.

THE 1982 NEW BT 10" FIR BEARS  
S20°E, 471' DIST.

CS 67/44-24D

(5)

T305, R04W, NW 1/4 SEC 39 CONT'D

NEW ACCESSORIES:

A DONGLAS CO. SURVEYOR 1 1/2"  
DIA. ALUMINUM CAP STAMPED "B0"  
ON A 5/8" X 3/2" IRON ROD SET PRO-  
TRUDING 5" ABOVE GROUND; BEARS  
EAST, 40 00'.

A 24" DIA. I CEDAR SCRIBED  
"NW 1/4 SEC 39" "BT" ON A DOUBLE BLAZE;  
BEARS S7 1/2°E, 513' DIST.

A WHITE PAINTED METAL WITNESS  
SIGN ON A STEEL POST; BEARS SOUTH  
30' DIST.

MONUMENT IS IN STEEP FILL SLOPE  
OFF WEST EDGE OF DAYS CREEK CUTOFF

R.D. (Co. Rd. #42) A S. I. FLAUS  
M.S. KOCH

COMPASS DECLIN-  
ATION 15° EAST

M. Stephen John House  
CS 67/44-24E

(6)

T305, R4W, NW 1/4 SEC 39 CONT'D

1961 B.T.  
22" X 6" TALL  
D. FIR SNAG

(NO SCALE)

1982 FOUND 3/4" I.R.  
N31°43'39"W, 389'

B.C. MONUMENT  
RESET 55°32'15"E, 492'  
FROM 1982 B.C.  
POSITION

CO. RD. #42

1982 BT  
19" X 4 1/2" TALL  
R. FIR STUMP

NEW BT  
24" I. CEDAR

O.B.T.  
38" X 2 1/2"  
BROKEN, ROTTED  
FIR STUMP  
S17 1/2°E, 594'

CS 67/44-24F

