

GOVERNMENT CORNER RESTORATION FORM  
DOUGLAS COUNTY SURVEYOR

TOWNSHIP 24S RANGE 03W SECTION 31

PLSS/GCDB No. 24-03-160140

CORNER DESIGNATION: CE 1/16 SECTION 31

FILED  
Date: 12/12/2017

By: JC

Corner Form: CS67/44-19

Field Notes: 4pgs

DOUGLAS COUNTY SURVEYOR

CORNER HISTORY, PREVIOUS RENEWALS OR SURVEYS:

THE CORNER WAS ESTABLISHED BY Wm. GLENN, CADASTRAL SURVEYOR, IN A 1958 USBLM DEPENDENT RESURVEY & SUBDIVISION OF SECTION 31.

DATE: JULY 11, 2016

- Condition Report Only
- Not Found
- Renewed
- Unrecorded
- Surveyed In
- Referenced Out

MONUMENT DETAIL

MONUMENT FOUND (CONDITION AND SOURCE):

- A 2 1/2" DIA. IRON POST BY WM. GLENN, CADASTRAL SURVEYOR PER A 1958 USBLM DEPENDENT RESURVEY AND SUBDIVISION OF SECTION 31, EMBEDDED IN THE ROOT WAD OF AN UPROOTED 20" DIA. FIR AND 4 FT. ABOVE THE GROUND WITH A 3 1/4" BRASS CAP MARKED:
- THE REMNANTS OF A MOUND OF STONE WERE FOUND AT THE ORIGINAL MONUMENT POSITION.

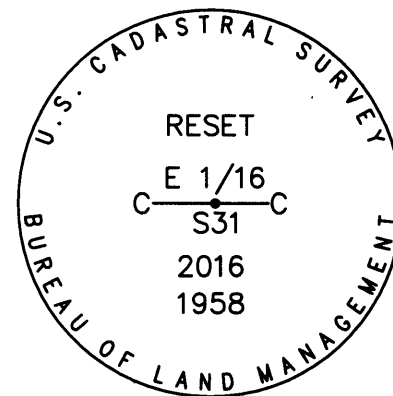

ACCESSORIES FOUND (CONDITION, SOURCE & RECORD):

BEARING TREES BY GLENN IN 1958:

- A 17" DIA. x 24" TALL D. FIR STUMP BEARS N. 51 1/2°E., 20.1 FT. WITH A HEALED REMAINS OF A LOW BLAZE.
- A 20" DIA. x 5' TALL D. FIR STUMP BEARS S. 56°E., 28.7 FT. WITH A HEALED DOUBLE BLAZE.

MONUMENT SET (PROCEDURES AND DESCRIPTION):

THE 2 1/2" DIA. x 28" 1958 USBLM MONUMENT IS RESET AT RECORD BEARING AND DISTANCE FROM THE 1958 BEARING TREES. SET 16" IN THE GROUND AND PROJECTING 2" ABOVE THE TOP OF A 24" DIA. MOUND OF STONE WITH "RESET" AND "2016" ADDED TO THE BRASS CAP MARKINGS.

NEW ACCESSORIES:

- A 6" DIA. D.FIR BEARS N.75°E., 34.6 FT. SCRIBED "X CS BT".
- A 21" DIA. I. CEDAR BEARS N.48 1/2°W., 52.2 FT. SCRIBED "CE 1/16 S31 CS BT".

LOCATION & COMMENTS:

ALL BEARING TREES HAVE BT TAGS ATTACHED. ALL NEW BEARING TREES HAVE DOUBLE BLAZED FACES WITH BEARINGS MEASURED TO THE CENTER OF THE TREE AT THE ROOT CROWN AND DISTANCES MEASURED TO THE SIDE AND CENTER OF THE ROOT CROWN. THE MONUMENTS FALLS NEAR THE TOP OF A VERY STEEP SOUTH SLOPE, 50 FT. SOUTH OF AN OLD GROWTH TIMBER CUTTING CORNER WITH OLD GROWTH FOREST IN THE NW QUADRANT AND A RECENT CLEARCUT IN THE NE, SE & SW QUADRANTS. THE CORNER IS LOCATED APPROXIMATELY 325 FT. NORTH OF THE INTERSECTION OF NONPAREIL & HINKLE CREEK ROADS.

GEODETIC COORDINATES

LATITUDE:  
LONGITUDE:  
ELLIPSOID HEIGHT:  
DATUM: NAD 83  
SOURCE:

COMPASS DECLINATION: 15° E.

AGENCY:DCSO  
PARTY CHIEF: S. J. FLAUSE  
WITNESSES: M. KOCH  
NOTES: ATTACHED

REGISTERED  
PROFESSIONAL  
LAND SURVEYOR

*Kristian O. Degroot*

OREGON  
JULY 17, 1981  
KRISTIAN O. DEGROOT  
1941

RENEWAL DATE: 12-31-2017

CS 67/44-19

July 11, 2016

T24S, R03W, CE 1/16 S31, PLS 160140

MONUMENT FOUND:

FROM THE 1958 BLM SUBDIVISION OF SECTION 31; A 3 1/4 INCH DIA.

B.C. AND A 2 INCH I.P. IRON PIPE IS OUT OF GROUND AND EMBEDDED IN A ROOT-WAD OF A FALLEN <sup>20"</sup>FIR 4 FT. ABOVE ITS ORIGINAL POSITION. BRASS CAP

IS MARKED AS FOLLOWS

" U.S. CADASTRAL SURVEY "

C E 1/16 C  
S31

1958

BUREAU OF LAND MANAGEMENT

REMAINS OF STONE MOUND FOUND AT LOCATION WHERE MON. HAD BEEN SET.  
CS 67144-19A

(3)

T24S, R03W, PLS 160140 CONT'D

NEW BEARING TREES:

A 6" DIA. D. FIR SCRIBED "X" "CSBT" ON A HI-LO BLZ.; BEARS N 75° E, 34 1/2 FT. DISTANT.

A 21" DIA. I. CEDAR SCRIBED "CE 1/16 S31" "CSBT" ON A DOUBLE BLZ.; BEARS N 48 1/2° W, 52 1/2 FT. DISTANT.

DECLINATION 15° EAST

B.C. MONUMENT IS NEAR TOP OF VERY STEEP SOUTH SLOPE AND 50 FT SOUTH OF AN OLD GROWTH TIMBER CUTTING CORNER.

OLD GROWTH FOREST IN NW QUADRANT, RECENT CLEAR-CUT IN THE OTHER QUAD.S

B.C. MONUMENT IS APPROX. 325 FT. NORTH FROM THE INTERSECTION OF NON PAREIL RR. AND HINKLE CREEK. RD.

T. S. J. FLAUSE

† M. S. KOCH

M. Stephen John Flause

CS 67144-19C

(2)  
T24S, R03W PLS 160140 CONT'D

ACCESSORIES FOUND:

EVIDENCE OF THE 2 ORIGINAL B.T.S. FROM 1958

A FIR, 6 IN. DIA. NOW A 17" DIA. X 2' TALL D. FIR STUMP, SHOWING THE HEALED REMAINS OF A LOW BLZ.; BEARS N 51 1/2° E, 20 1/2 FT. DISTANT (AS PER RECORD).

A FIR, 10 IN. DIA. NOW A 20" DIA. X 5' TALL D. FIR STUMP, SHOWING A FULLY HEALED DOUBLE BLZ.; BEARS S 56° E, 28 1/2 FT. DISTANT (AS PER RECORD).

MONUMENT RESET:

AT POSITION DETERMINED FROM FOUND B.T. EVIDENCE, FOUND B.C. MONUMENT IS SET AS FOLLOWS:

B.C. / I.P. NOW PROTRUDES 12" ABOVE GROUND AND TOP OF MONUMENT IS 2" ABOVE ROUGH 2 FT. DIA. MOUND OF STONE.

THE STAMPING "RESET" AND "2016" IS ADDED TO B.C. MARKING.

CS 67144-19B

(4)

T24S, R03W, PLS 160140 CONT'D

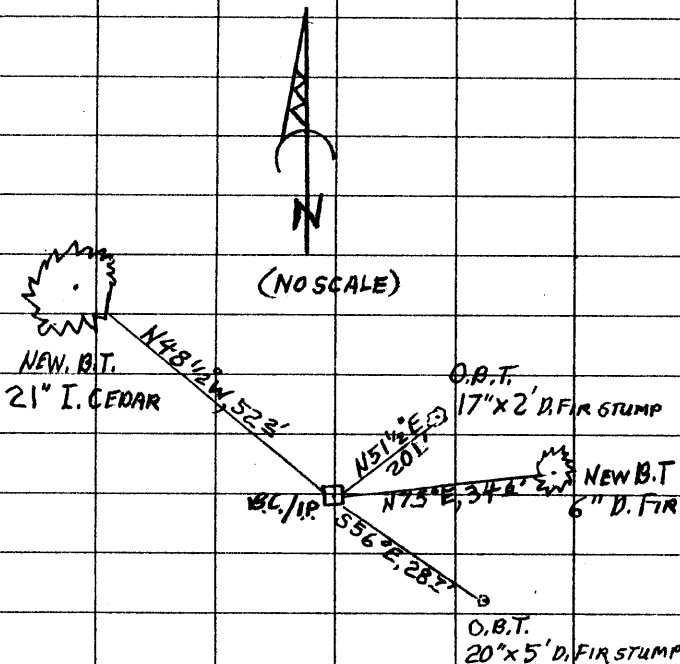

CS 67144-19D