

GOVERNMENT CORNER RESTORATION FORM
DOUGLAS COUNTY SURVEYOR

FILED
Date: 12-12-2017
By: SC
Corner Form: CS 67/44-15
Field Notes: 3 Pgs
DOUGLAS COUNTY SURVEYOR

TOWNSHIP 24S RANGE 03W SECTION 31

PLSS/GCDB No. 24-03-140140

CORNER DESIGNATION: CENTER 1/4 SECTION 31

DATE: JUNE 16, 2016
 Condition Report Only
 Not Found
 Renewed
 Unrecorded
 Surveyed In
 Referenced Out

CORNER HISTORY, PREVIOUS RENEWALS OR SURVEYS:

- SEE DCSO SURVEY & CORNER RECORDS FOR PLSS 24-03-140140

MONUMENT DETAIL

MONUMENT FOUND (CONDITION AND SOURCE):

A 2 1/2" DIA. IRON POST BY WM. GLENN, CADASTRAL SURVEYOR PER A 1958 USBLM DEPENDENT RESURVEY AND SUBDIVISION OF SECTION 31, FIRMLY SET, PROJECTING 2" ABOVE THE GROUND AND SURROUNDED BY THE REMNANTS OF A STONE MOUND WITH A 3 1/4" BRASS CAP MARKED:

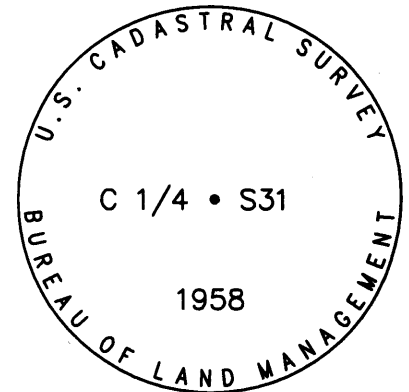

ACCESSORIES FOUND (CONDITION, SOURCE & RECORD):

THE 1958 BEARING TREES WHICH WERE RECOVERED BY K. HOFFINE IN 2009 PER M 160-19 HAVE BEEN REMOVED BY ROAD WORK SOUTH OF THE CORNER.

MONUMENT SET (PROCEDURES AND DESCRIPTION): NONE

NEW ACCESSORIES:

- A 18" DIA. MAPLE BEARS N.27 1/2°E., 18.0 FT. SCRIBED "C1/4 S31 CS BT".
- A 6" DIA. D. FIR BEARS N.46°E., 9.9 FT. SCRIBED "X CS BT".
- A 9" DIA. I. CEDAR BEARS N.87 1/2°E., 43.2 FT. SCRIBED "C1/4 S31 CS BT".
- A 9" DIA. D. FIR BEARS N.41 1/2°W., 32.8 FT. SCRIBED "C1/4 S31 CS BT".

LOCATION & COMMENTS:

ALL BEARING TREES HAVE BT TAGS ATTACHED. ALL NEW BEARING TREES HAVE DOUBLE BLAZED FACES WITH BEARINGS MEASURED TO THE CENTER OF THE TREE AT THE ROOT CROWN AND DISTANCES MEASURED TO THE SIDE AND CENTER OF THE ROOT CROWN. THE CORNER FALLS ON A STEEP SOUTHSLOPE AT THE TOP OF A 15 FT. HIGH CUT BANK AND APPROXIMATELY 30 FT. NORTH OF THE CENTERLINE OF A DIRT LOGGING ROAD.

GEODETIC COORDINATES

LATITUDE:

LONGITUDE:

ELLIPSOID HEIGHT:

DATUM: NAD 83

SOURCE:

COMPASS DECLINATION: 15° E.

AGENCY: DCSO

PARTY CHIEF: S. J. FLAUSE

WITNESSES: M. KOCH

NOTES: ATTACHED

REGISTERED
PROFESSIONAL
LAND SURVEYOR
Kristian O. Degroot
OREGON
JULY 17, 1981
KRISTIAN O. DEGROOT
1941
RENEWAL DATE: 12-31-2017

CS 67/44-15

JUNE 16, 2016

T24S, R03W, C14S31, PLSS140140

MONUMENT FOUND:

FROM THE 1958 BLM DEPENDENT RESURVEY
A 3 1/4" DIA. BRASS CAP ON A 2" I.D. IRON PIPE.

MONUMENT IS SET PLUMB, PROTRUDING 2"
ABOVE GROUND AND SURROUNDED BY REMNANTS
OF A STONE MOUND.

BRASS CAP OF FOUND MONUMENT IS MARKED
AS FOLLOWS:

" U.S. CADASTRAL SURVEY "

C14-S31

1958

BUREAU OF LAND MANAGEMENT

ACCESSORIES FOUND:

BOTH O.B.T.'S REMOVED BY ROAD WORK
DONE SOUTH OF CORNER.

FOUND B.C. MONUMENT POSITION IS SOLID
AND APPEARS UNDISTURBED SINCE 1958.

NEW ACCESSORIES:

NEW 18" DIA. MAPLE SCRIBED "C14S31CS"
CS 67/44-15A

(2)

T24S, R03W, PLSS140140 (CONT'D)

"BT" ON A DOUBLE BLAZE; BEARS
N27 1/2° E, 18° FT. DISTANT.

A 6" DIA. D. FIR SCRIBED "X" "CS BT"
ON A HI-LO BLAZE; BEARS N46° E,
9° FT. DISTANT.

A 9" DIA. I. CEDAR SCRIBED "C14S31
CS" "BT" ON A DOUBLE BLAZE; BEARS
N87 1/2° E, 43° FT. DISTANT.

A 9" DIA. D. FIR SCRIBED "C14S31CS"
"BT" ON A DOUBLE BLAZE; BEARS
N41 1/2° W, 32° FT. DISTANT.
DECLINATION 15° E

B.C. MONUMENT IS ON STEEP SOUTH SLOPE
AT THE TOP OF A 15 FT CUT-BANK AND
APPROX. 30 FT. NORTH FROM C OF
PIRT LOGGING ROAD.

S. J. FLAUSE

M. S. KOCH

Stephen John Flause

CS 67/44-15B

(3)

T24S, R03W, PLSS140140 (CONT'D)

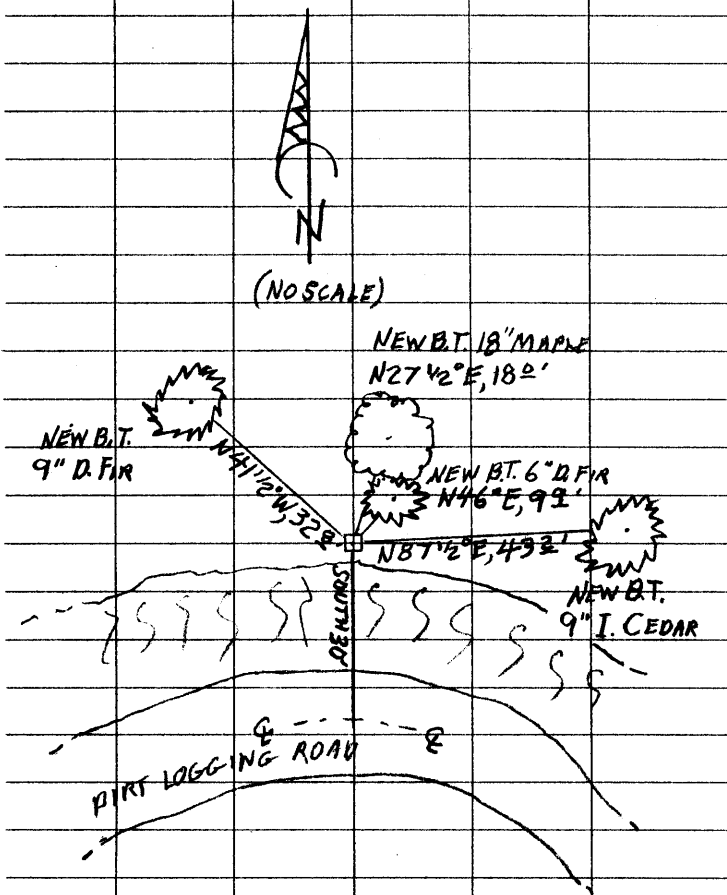

CS 67/44-15C