

GOVERNMENT CORNER RESTORATION FORM  
DOUGLAS COUNTY SURVEYOR

TOWNSHIP 24S RANGE 03W SECTION 31

PLSS/GCDB No. 24-03-160160

CORNER DESIGNATION: NE 1/16 SECTION 31

FILED  
Date: 12/12/2017  
By: JC  
Corner Form: CS 67/44-12  
Field Notes: ~1 pgs  
DOUGLAS COUNTY SURVEYOR

CORNER HISTORY, PREVIOUS RENEWALS OR SURVEYS:

THE CORNER WAS ESTABLISHED BY Wm. GLENN, CADASTRAL SURVEYOR, IN A 1958 USBLM DEPENDENT RESURVEY & SUBDIVISION OF SECTION 31.

DATE: MAY 11, 2016  
 Condition Report Only  
 Not Found  
 Renewed  
 Unrecorded  
 Surveyed In  
 Referenced Out

MONUMENT FOUND (CONDITION AND SOURCE):

A 2 1/2" DIA. IRON POST BY WM. GLENN, CADASTRAL SURVEYOR PER A 1958 USBLM DEPENDENT RESURVEY AND SUBDIVISION OF SECTION 31, PROJECTING 10" ABOVE A ROAD FILL BANK AND LEANING WESTERLY APPROXIMATELY 4" AT THE TOP, WITH A 3 1/4" BRASS CAP MARKED:

MONUMENT DETAIL

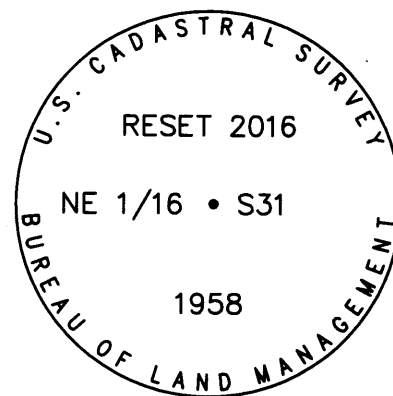

ACCESSORIES FOUND (CONDITION, SOURCE & RECORD):

BEARING TREES BY GLENN IN 1958:

- A 25" DIA. x 6' TALL D. FIR STUMP BEARS S.32 1/2°E., 91.1 FT. WITH A HEALED SINGLE BLAZE.
- A ROOT HOLE BEARS N.40°W., 78.2 FT. WITH AN UPROOTED 42" DIA. D. FIR LAYING ALONGSIDE WITH SCRIBE MARKS NE 1/16 S31 BT" VISIBLE ON A PARTIALLY HEALED SINGLE BLAZE.

MONUMENT SET (PROCEDURES AND DESCRIPTION):

THE 1958 USBLM MONUMENT IS RESET IN A PLUMB POSITION WHICH MATCHES THE ORIGINAL BEARING AND DISTANCE TO THE FOUND 1958 BEARING TREE.

NEW ACCESSORIES:

- A 14" DIA. MAPLE BEARS N.37 1/2°E., 8.8 FT. SCRIBED "NE 1/16 S31 CS BT".
- A 23" DIA. D. FIR BEARS S.02 1/2°W., 17.0 FT. SCRIBED "NE 1/16 S31 CS BT".

LOCATION & COMMENTS:

ALL BEARING TREES HAVE BT TAGS ATTACHED. ALL NEW BEARING TREES HAVE DOUBLE BLAZED FACES WITH BEARINGS MEASURED TO THE CENTER OF THE TREE AT THE ROOT CROWN AND DISTANCES MEASURED TO THE SIDE AND CENTER OF THE ROOT CROWN. THE CORNER FALLS IN THE WESTERLY FILL BANK AND APPROXIMATELY S.45°W., 35 FT. FROM THE CENTERLINE OF A ROCKED FOREST ACCESS ROAD AND APPROXIMATELY N.45°E., 80 FT. FROM A STREAM, COURSE SE. THE SE QUADRANT IS MOSTLY A CLEARCUT UNIT & THE NE, NW & SW QUADRANTS ARE FORESTED WITH OLDER GROWTH FIR TIMBER.

GEODETTIC COORDINATES

LATITUDE:  
LONGITUDE:  
ELLIPSOID HEIGHT:  
DATUM: NAD 83  
SOURCE:

COMPASS DECLINATION: 15° E.  
AGENCY: DCSO  
PARTY CHIEF: S. J. FLAUSE  
WITNESSES: M. KOCH  
NOTES: ATTACHED

REGISTERED  
PROFESSIONAL  
LAND SURVEYOR

*Kristian O. Degroot*

OREGON  
JULY 17, 1981  
KRISTIAN O. DEGROOT  
1941

RENEWAL DATE: 12-31-2017

CS 67/44-12

MAY 11, 2016

T24S, R03W, NE 1/16 S31, PLSS 160160

MONUMENT FOUND:

FROM THE 1958 BLM SUBDIVISION OF SECTION 31, A 3 1/4" DIA. BRASS CAP ON A 2" I.D. IRON PIPE PROTRUDING 10" FROM A ROAD FILL BANK AND LEANING WEST'LY FROM PLUMB APPROX. 035 FT. THE BRASS CAP IS MARKED AS FOLLOWS:

"U.S. CADASTRAL SURVEY"

NE 1/16 S31

1958

BUREAU OF LAND MANAGEMENT

ACCESSORIES FOUND:

(MEASUREMENTS ARE MADE FROM PLUMB POSITION OF FOUND B.C. MONUMENT.)

EVIDENCE OF THE TWO 1958 O.B.T.'S

A FIR 8" NOW A 25" DIA. 6 FT. TALL, SOLID, D. FIR STUMP WITH A FULLY HEALED SINGLE BLAZE; BEARS S32 1/2° E, 91± FT. DISTANT (AS PER RECORD).

CS 67/44-12A

(3)

T24S, R03W, S31, PLSS 160160 (CONT'D)

THE B.C. MONUMENT IS IN THE SOUTHWEST FACING FILL BANK OF A GRAVEL FOREST ACCESS RD.

THE CENTERLINE OF THE FOREST RD. IS APPROX. N45° E, 35 FT. A STREAM RUNNING SE IS APPROX S45° W, 80 FT.

THE SOUTHEAST QUADRANT IS MOSTLY CLEARCUT NEAR THE CORNER MON. THE OTHER THREE QUADS ARE FORESTED WITH OLDER GROWTH FIR.

⌈ S.J. FLAUSE

⌋ M.S. KOCH

⌋ Stephen John Flause

CS 67/44-12C

(2)

T24S, R03W, S31, PLSS 160160 (CONT'D)

A 40" FIR NOW A FALLEN OUT OF POSITION 42" DIA. D. FIR, WITH A PARTIALLY HEALED SINGLE BLAZE, WITH ALL OF RECORD SCRIBING VISIBLE. THE APPROX. CENTER OF THIS FALLEN B.T.'S ROOT-HOLE BEARS N40° W, 78± FT. DISTANT (AS PER RECORD).

THE BRASS CAP MONUMENT IS RETURNED TO PLUMB. THIS POSITION AGREES WITH THE FOUND BEARING TREE EVIDENCE.

NEW BEARING TREES:

A 14" DIA MAPLE, SCRIBED "NE 1/16 S31 CS" "BT" ON A DOUBLE BLAZE; BEARS N37 1/2° E, 88 FT. DISTANT.

A 23" D. FIR, SCRIBED "NE 1/16 S31" "CSBT" ON A DOUBLE BLAZE; BEARS S02 1/2° W, 17± FT. DISTANT.

DECLINATION 15° E

CS 67/44-12B

(4)

T24S, R03W, S31, PLSS 160160 (CONT'D)

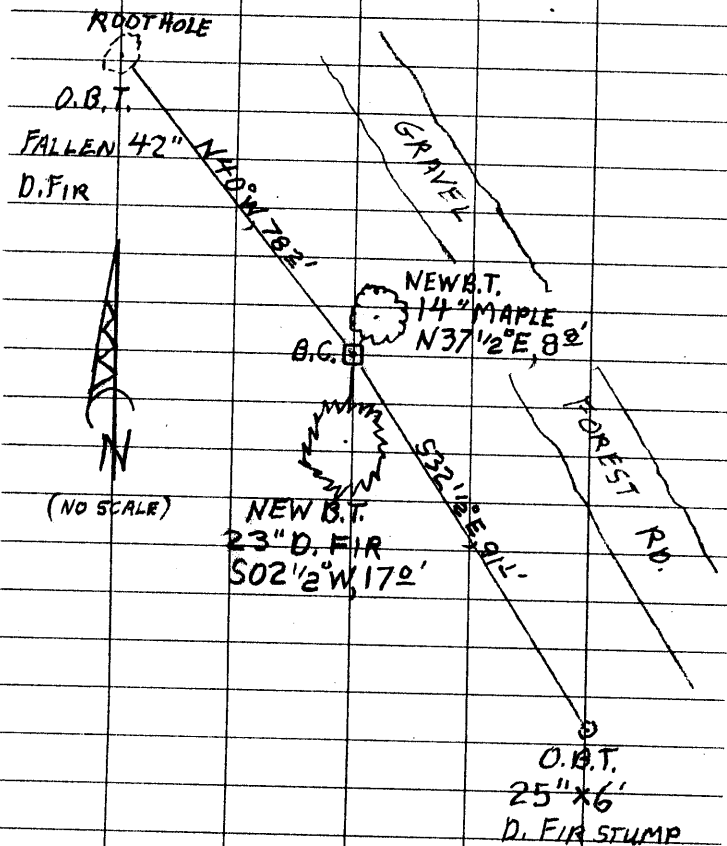

(NO SCALE)

NEW B.T. 14" MAPLE N37 1/2° E, 88'

NEW B.T. 23" D. FIR S02 1/2° W, 17'

O.B.T. 25" x 6' D. FIR STUMP

CS 67/44-12D