

GOVERNMENT CORNER RESTORATION FORM
DOUGLAS COUNTY SURVEYOR

FILED
Date: 12/12/2017

By: JC

TOWNSHIP 25S RANGE 03W SECTION 7

PLSS/GCDB No. 25-03-100540

Corner Form: CS67/44-5

CORNER DESIGNATION: 1/4 S12/S7

Field Notes: 4pgs

DOUGLAS COUNTY SURVEYOR

CORNER HISTORY, PREVIOUS RENEWALS OR SURVEYS:

DATE: APRIL 11, 2017

- SEE DCSO SURVEY & CORNER RECORDS FOR PLSS 25-03-100540 OR 25-04-700540

- Condition Report Only
- Not Found
- Renewed
- Unrecorded
- Surveyed In
- Referenced Out

MONUMENT DETAIL

MONUMENT FOUND (CONDITION AND SOURCE):

A 1" IRON PIPE BY N. PRICE, U.S.G.L.O. ASSOCIATE CADASTRAL ENGINEER, IN 1944, FIRMLY SET FLUSH WITH THE GROUND WITH A 2 1/2" DIAMETER BRASS CAP MARKED AS NOTED:

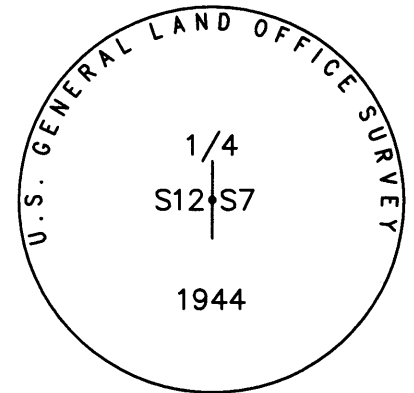

ACCESSORIES FOUND (CONDITION, SOURCE & RECORD):

ORIGINAL BEARING TREES BY GORDON & GARDNER IN 1855:

- 25" DIAM. x 10' TALL W. OAK STOB, BEARS N. 10 3/4°E., 128.7 FT. WITH A PREVIOUSLY OPENED BUT NOW ROTTED BLAZE. (REC. N.18°E.)
 - A ROOT HOLE BEARS N.26°W., 116.2 FT. WITH ROTTED OAK FRAGMENTS ALONGSIDE. (REC. N.28°W.)
- AND BEARING TREES BY N. PRICE IN 1944:

- A 23" DOUBLE TRUNK B. OAK BEARS N.18 3/4°E., 134.6 FT. WITH A HEALED SINGLE BLAZE.
 - A 19" TRIPLE TRUNK W. OAK BEARS N.43 3/4°W., 177.5 FT. WITH A HEALED SINGLE BLAZE. (REC. N.43°W.)
- THE CENTER OF THE ROOT CROWN OF THE NOW TRIPLE TRUNK W. OAK BEARS N.43 1/4°W., 180.0 FT.

MONUMENT SET (PROCEDURES AND DESCRIPTION):

NONE

NEW ACCESSORIES:

- A 9" DIA. I. CEDAR BEARS N. 85 1/2°E., 129.3 FT. SCRIBED "1/4 S7 CS BT".
- A 11" DIA. W. OAK BEARS N. 67 1/2°W., 62.6 FT. SCRIBED "1/4 S12 CS BT".

COMPASS DECLINATION: 15° E.

LOCATION & COMMENTS:

AGENCY: DCSO

ALL BEARING TREES HAVE BT TAGS ATTACHED. ALL NEW BEARING TREES HAVE DOUBLE BLAZED FACES WITH BEARINGS MEASURED TO THE CENTER OF THE TREE AT THE ROOT CROWN AND DISTANCES MEASURED TO THE SIDE AND CENTER OF THE ROOT CROWN UNLESS OTHERWISE NOTED.

PARTY CHIEF: S. J. FLAUSE

CORNER FALLS ON A GENTLE NW SLOPE AT THE N. EDGE OF AN OPEN PASTURE SURROUNDED BY A MIXED WOODLAND OF OAK, FIR AND CEDAR.

WITNESSES: M. KOCH

NOTES: ATTACHED

GEODETTIC COORDINATES

LATITUDE:

LONGITUDE:

ELLIPSOID HEIGHT:

DATUM: NAD 83

SOURCE:

REGISTERED
PROFESSIONAL
LAND SURVEYOR

Kristian O. Degroot

OREGON
JULY 17, 1981
KRISTIAN O. DEGROOT
1941

RENEWAL DATE: 12-31-2017

CS 67/44-5

(1)

APRIL 11, 2017

T25S, R03W, W 1/4 S7, PLSS 100540

MONUMENT FOUND:

FROM THE 1943 GLO DEPENDENT RESURVEY (INSTRUCTIONS DATED 1940) A 2 1/2" DIA. BRASS CAP ON A 1" I.D. IRON PIPE SET FLUSH WITH GROUND SURFACE. THE BRASS CAP IS MARKED AS FOLLOWS:

" U.S. GENERAL LAND OFFICE SURVEY "

1/4

S12 S7

1944

ACCESSORIES FOUND:

EVIDENCE OF THE 2 ORIGINAL B.T.'S FROM 1855.

A W. OAK 5" DIA., NOW A 25" DIA., 10 FT. TALL W. OAK STUMP WITH A PREVIOUSLY OPENED, BUT NOW ROTTED AWAY, BLAZE; BEARS N10 3/4° E, 128 2/3 FT. DISTANT (RECORD N18° E, 128 2/3 FT., FOUND B. AND D. AGREE WITH 1944 GLO RECORD)

A W. OAK 24" DIA., NOW A DISTINCT BIRTHHOLE WITH ROTTED OAK FRAGMENTS; BEARS N26° W 116 2/3 FT. DISTANT (RECORD N28° W, 116 2/3 FT.)

CS 67/44-5A

(2)

T25S, R03W, PLSS 100540 (CONT'D)

THE TWO 1944 GLO RENEWAL B.T.'S.

A B. OAK 15" DIA., NOW 23" DIA. (SIZE OF SCRIBED TRUNK) DOUBLE TRUNK B. OAK WITH A FULLY HEALED SINGLE BLAZE; BEARS N18 3/4° E, 134 2/3 FT. DISTANT (AS PER RECORD).

A W. OAK 11" DIA., NOW A 19" DIA. (SIZE OF SCRIBED TRUNK) TRIPLE TRUNK (THREE SEPARATE TREES NOW GROWN TOGETHER AT BASE) WITH A FULLY HEALED SINGLE BLAZE. THE BASE OF THE SCRIBED TRUNK BEARS N43 3/4° W, 177 1/2 FT. DISTANT (RECORD N43° W, 177 1/2 FT.). THE CENTER OF THE ROOTCROWN OF THE NOW TRIPLE TRUNK W. OAK BEARS N43 1/4° W, 180° FT. DISTANT.

NEW ACCESSORIES:

A 9" DIA. L. CEDAR SCRIBED "1/4 S7CS" "BT" ON A DOUBLE BLAZE; BEARS N85 1/2° E, 129 2/3 FT. DISTANT.

AN 11" DIA. W. OAK SCRIBED "1/4 S12" "CSBT" ON A DOUBLE BLAZE; BEARS N67 1/2° W, 62 2/3 FT. DISTANT.

DECLINATION 15° E

CS 67/44-5B

(3)

T25S, R03W, PLSS 100540 (CONT'D)

CORNER MONUMENT IS ON A GENTLE NW SLOPE AT THE NORTH EDGE OF OPEN PASTURE-LAND. PASTURE IS SURROUNDED BY A MIXED WOODLAND OF OAK, FIR AND CEDAR.

⌘ S. J. FLAUSE

† M. S. KOCH

☑ Stephen John Flause

CS 67/44-5C

(4)

T25S, R03W, PLSS 100540 (CONT'D)

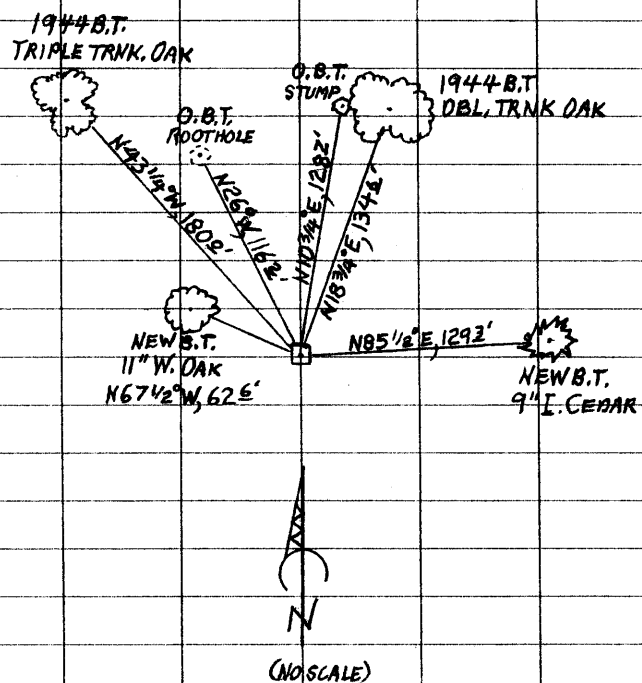

(NO SCALE)

CS 67/44-5D