

GOVERNMENT CORNER RESTORATION FORM

FILED

TOWNSHIP 24S RANGE 04W SEC. 16 PLSS # 039010

Date: 11-24-2015 By: X

This survey consists of:

DOUGLAS COUNTY OREGON

DATE FEB. 27, 2015

Map: _____

Narrative: _____

Corner Designation

Corner Rpt: CS67/42-13

DOUGLAS COUNTY SURVEYOR

NE
DLC 39

- ___ Condition Report
- ___ Not Found
- Renewed
- ___ Unrecorded
- ___ Surveyed In
- ___ Referenced Out

Previous Renewals 1945, 1956, 1963 (COND' REP)
Monument(s) Found: (Condition and Source)

MONUMENT DETAIL

FROM THE 1956 RENEWAL A 2 1/2 INCH DIAMETER BRASS CAP (MARKED AS AT RIGHT) ON A 1 INCH I.D. IRON PIPE FIRMLY SET PROTRUDING 12 INCHES ABOVE GROUND.

COUNTY SURVEYORS OFFICE
T24S R4W

AND A NO LONGER ACCEPTED 1945 MONUMENT. A 1 1/2 INCH I.D. IRON PIPE PROTRUDING 14 INCHES ABOVE GROUND AND LEANING SOUTHERLY. THIS PIPE IS IN A N-S FENCELINE AND BEARS S27°E, 3 1/2 FEET DISTANT FROM BC MONUMENT (SEE 1956 AND 1963 ACCES'S BELOW).

CL. 39
N.E. COR.

1956

Accessories Found

EVIDENCE OF TWO ORIGINAL BEARING TREES.
AN OAK 12" DIA. NOW A SHALLOW ROOT-HOLE WITH OAK ROOTS; BEARS N01°E, 82 1/2 FEET DISTANT (AS PER RECORD).
AN OAK 18" DIA. NOW LARGE DISTINCT ROOT-HOLE; BEARS S24°W, 48 1/2 FEET DISTANT (AS PER RECORD).

TWO 1956 RENEWAL BT'S.
AN 18" CEDAR NOW A 25 INCH DIAM. INCENSE CEDAR WITH A PARTIALLY HEALED DOUBLE BLAZE, SHOWING ILLEGIBLE SCRIBING; BEARS N26 1/2°E, 39 1/2 FEET DISTANT (RECORD N28 1/2°E, 39 1/2').
A 12" W. OAK NOW A ROTTED AND TIPPED 8 INCH DIAM. 2 FOOT TALL OAK STUMP WITH EVIDENCE OF A BLAZE AND A ROTTED FACE (NO SCRIBING); BEARS N87 1/2°E, 27 1/2 FEET DISTANT (RECORD N85°E, 27 1/2').

THE 1945 MONUMENT NOTED ABOVE IS DESCRIBED AS BEARING N27°W, 3 1/2 FEET DISTANT IN THE 1956 RENEWAL AND THIS IS AMENDED TO S27°E, 3 1/2 FEET IN THE 1963 CONDITION REPORT.

A N-S FENCELINE IS EAST, 2 FEET DISTANT

C.S. File 67/42-13

Monument Set (Procedure and Description)

MONUMENT DETAIL

N/A

N/A

New Accessories

THREE NEW BEARING TREES.

A 7 INCH DIAM. MADRONE SCRIBED "NE DLC 39 CS" "BT" ON A DOUBLE BLAZE; BEARS N01°E, 11 1/2 FEET DISTANT.

A 3 1/2 INCH DIAM. INCENSE CEDAR SCRIBED "NE DLC 39" "CSBT" ON A DOUBLE BLAZE; BEARS S53 1/2°E, 19 1/2 FEET DISTANT.

A 9 INCH DOUGLAS FIR SCRIBED "NE DLC 39 CS" "BT" ON A DOUBLE BLAZE; BEARS S83°W, 6 1/2 FEET DISTANT.

Sketch of Monument, Accessories, and General Area (SKETCH ONLY SHOWS LIVE TREES)

Location & Comments

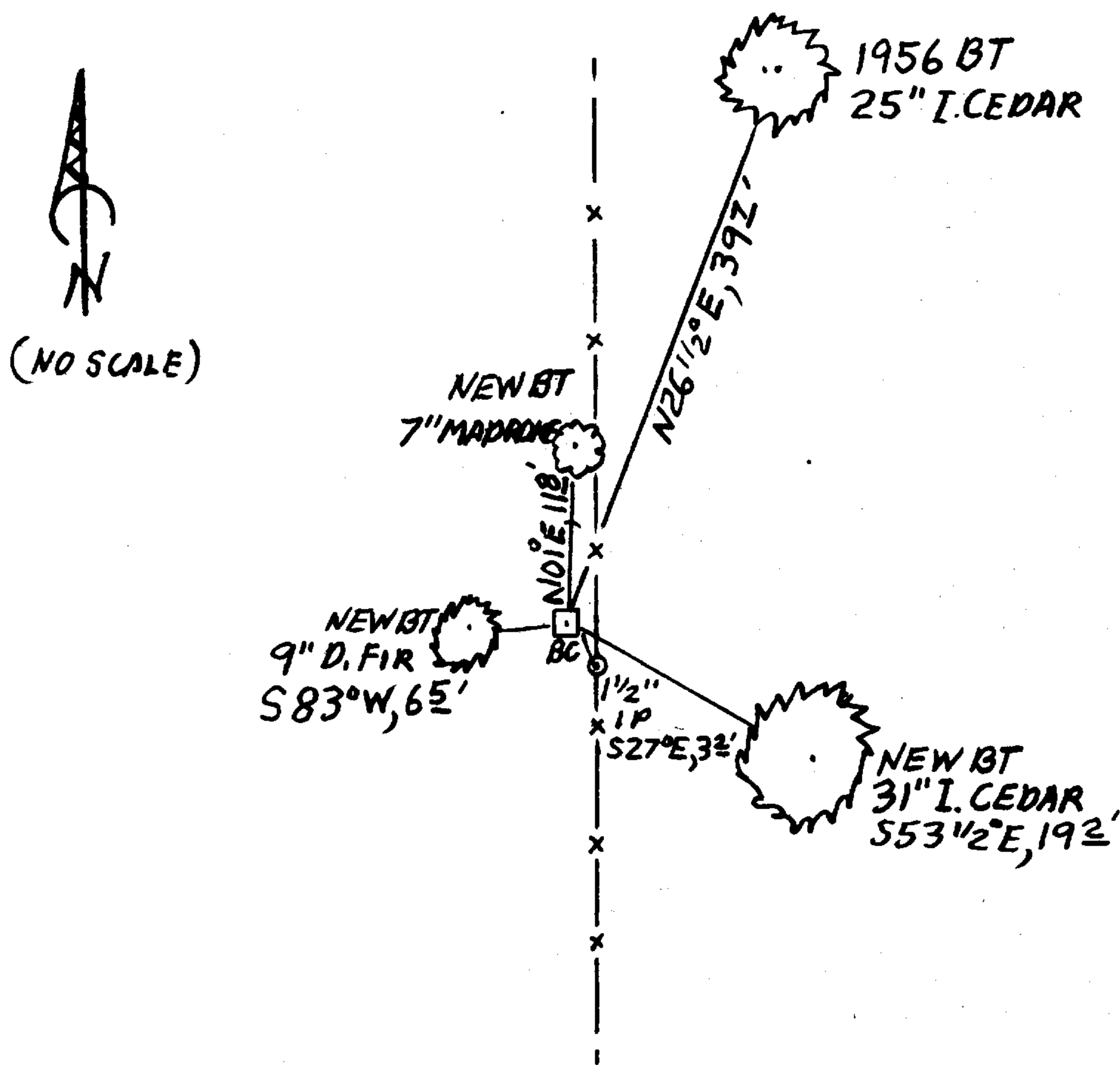

BC MONUMENT IS IN OLDER FIRE REPROD. FOREST OF CEDAR, FIR AND MADRONE, SOME OAK.

Comp. Decline. 15 1/4° E

Agency DCSO

Party Chief STEPHEN JOHN FLAUSE

Note keeper Stephen John Flause

Witnesses MIKE S. KOCH

Surveyor's Seal

REGISTERED PROFESSIONAL LAND SURVEYOR

Kristian O. DeGroot

OREGON
JULY 17, 1981
KRISTIAN O. DeGROOT
1941

RENEWAL 12/31/15