

GOVERNMENT CORNER RESTORATION FORM

FILED

TOWNSHIP 24S RANGE 25W SEC. 9 PLSS # 400500

Date: 8-10-2015 By: JC
This survey consists of:

DOUGLAS COUNTY OREGON

DATE FEB 3, 2015

Map: _____

Narrative: _____
Corner Rpt: C567 | 42-8

Corner Designation

DOUGLAS COUNTY
SURVEYOR

59 | S10
S16 | S15

Previous Renewals 1960
Monument(s) Found: _____ (Condition and Source)

- _____ Condition Report
- _____ Not Found
- Renewed
- _____ Unrecorded
- _____ Surveyed In
- _____ Referenced Out

FROM THE 1960 RENEWAL A 2 1/2 INCH DIAMETER BRASS CAP (MARKED AS A7 RIGHT) ON A 1 INCH I.D. IRON PIPE IS FIRMLY SET, PROTRUDING 14 INCHES ABOVE GROUND. THIS MONUMENT IS SET AGAINST THE SOUTH EDGE AND JUST INSIDE THE SOUTHEAST CORNER OF OF A 6x6 INCH, 6 3/4 FOOT TALL PRESSURE TREATED FENCE POST. SAID POST IS IN AN EAST-WEST FENCE LINE.

MONUMENT DETAIL

COUNTY SURVEYORS OFFICE
T24S R5W

59 | S10
S16 | S15
1960

Accessories Found

- NO EVIDENCE OF O.B.T.S REMAINS; AREA SURFACE DISTURBED SINCE 1960.
- TWO 1960 BEARING TREES FOUND; NO EVIDENCE OF NE AND NW BEARING TREES REMAINS.
- A 7" W. OAK NOW A 9 INCH DIAM. WHITE OAK WITH A FULLY HEALED DOUBLE BLAZE BEARS S37°E, 22° FEET DISTANT (AS PER RECORD).
- AN 8" R. FIR NOW A MOSTLY ROTTEN 20 INCH DIAM. DOUGLAS FIR STUMP CUT TO JUST ABOVE GROUND LEVEL; BEARS S73 1/2°W, 54° FEET DISTANT (RECORD S74°W, 54° FT).
- E-W WIRE FENCE 5 FT. NORTH OF CORNER NOW GONE; SOME EVIDENCE OF THIS FENCE TO THE EAST.

C.S. File 67 | 42-8

RENEWAL

Monument Set (Procedure and Description)

MONUMENT DETAIL

N/A

N/A

New Accessories

THREE NEW B.T.S :

A 13 INCH DIAM. DOUGLAS FIR SCRIBED "T24SR5WS10CS" "BT" ON A DOUBLE BLAZE; BEARS N63°E, 113 FEET DISTANT.

A 15 INCH DIAM. DOUGLAS FIR SCRIBED "T24SR5WS16CS" "BT" ON A DOUBLE BLAZE; BEARS S40 1/2°W, 39 3/4 FEET DISTANT.

A 21 INCH DIAM. WHITE OAK SCRIBED "T24SR5WS9CS" "BT" ON A DOUBLE BLAZE; BEARS N39 3/4°W, 47 1/2 FEET DISTANT.

Sketch of Monument, Accessories, and General Area

Location & Comments

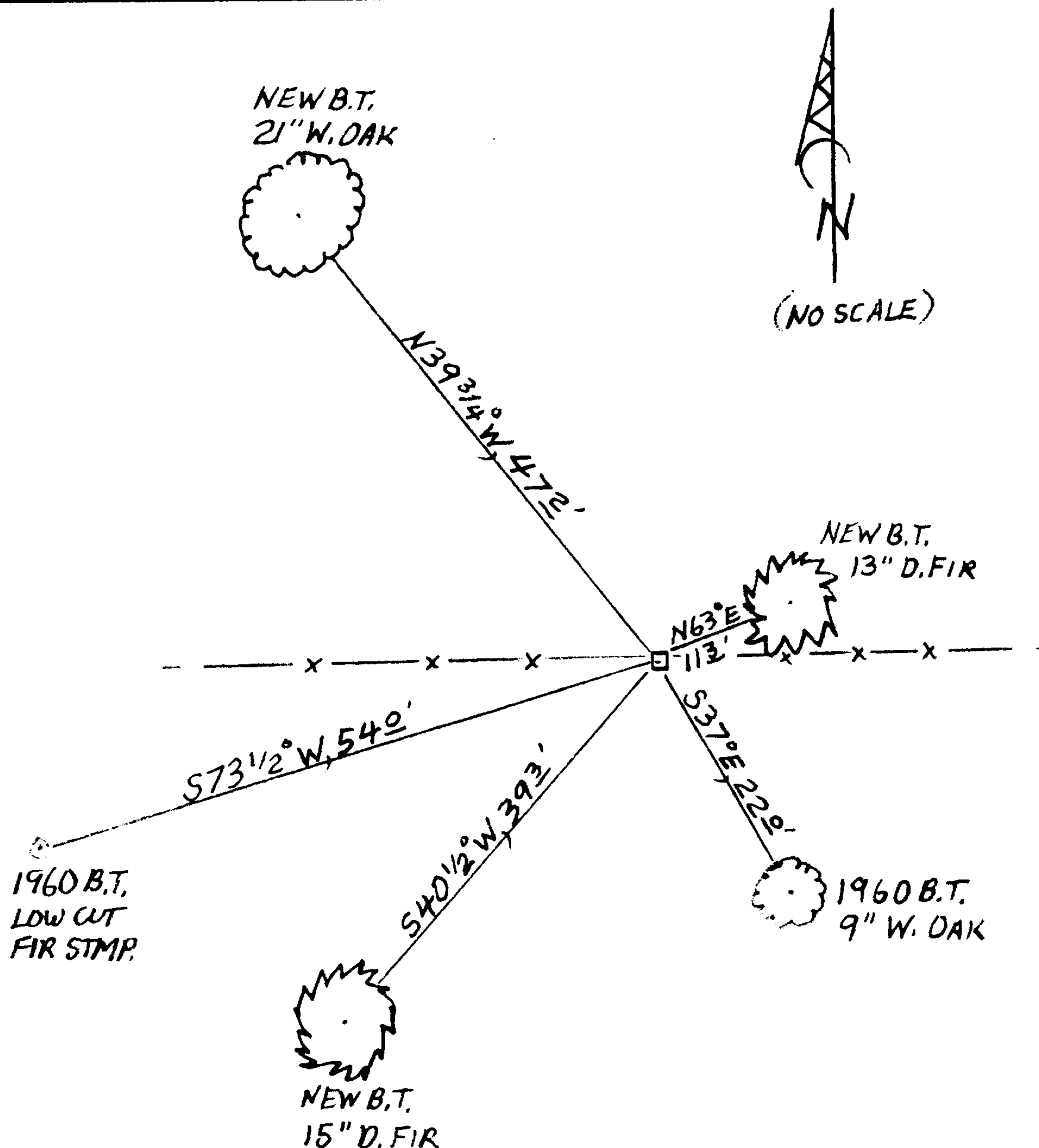

B.C. MONUMENT IS ON MODERATE EAST SLOPE IN AN OPEN FIR, OAK AND MADRONE WOODLAND.

Comp. Decline. 15 1/4°E

Agency DCSO

Party Chief STEPHEN JOHN FLAUSE

Note keeper Stephen John Flause

Witnesses MIKE S. KOCH

Surveyor's Seal

REGISTERED PROFESSIONAL LAND SURVEYOR

Kristian O. DeGroot

OREGON
JULY 17, 1981
KRISTIAN O. DeGROOT
1941

RENEWAL 12/31/15