

GOVERNMENT CORNER RESTORATION FORM

FILED

TOWNSHIP 23 S RANGE 07 W SEC. 31 PLSS # 200100

Date: 11-6-2014 By: JC

This survey consists of:

DOUGLAS COUNTY OREGON

DATE SEPT. 18, 2014

Map: _____

Corner Designation

Narrative: _____
Corner Rpt: CS 67/42-1

S31/S32

DOUGLAS COUNTY
SURVEYOR

Previous Renewals 1960, 1982
Monument(s) Found: _____ (Condition and Source)

- _____ Condition Report
- _____ Not Found
- Renewed
- _____ Unrecorded
- _____ Surveyed In
- _____ Referenced Out

FROM THE 1960 DCSD RENEWAL, A 2 1/2 INCH DIAMETER BRASS CAP (MARKED AS AT RIGHT) ON A 1 INCH I.D. IRON PIPE LEANING NW'LY 0 5 FEET AND PROTRUDING 18 INCHES ABOVE GROUND.

MONUMENT DETAIL

COUNTY SURVEYOR'S OFFICE
T235 RTW
S31/S32
T245 RTW
1960

Accessories Found

(ALL ACCESSORIES ARE MEASURED FROM PLUMB POSITION OF FOUND B.C. MONUMENT.)

EVIDENCE OF THREE O.B.T.'S:
A W. OAK 16" DIA., NOW 39 INCH DIAM. WHITE OAK WITH HEALED SCAR OF 1960 SCRIBING SEARCH; BEARS S11 1/2° W, 35 1/2 FEET DISTANT (RECORD S10° W, 35 1/2 FEET).
A FIR 24" DIA., NOW A 56 INCH DIAM., 3 1/2 FOOT TALL SAWED AND ROTTEN FIR STUMP (WHICH IS OPENED BUT NO SCRIBING IS FOUND); BEARS N10° W, 107 1/2 FEET DISTANT (RECORD N13° W, 105 1/2 FEET). 1960 AND 1982 RENEWALS NOTE A LARGE FIR AT RECORD BEARING AND DIST. BUT NOT EVEN A ROOT-HOLE IS FOUND AT THAT POSITION.
A FIR 8" DIA., NOW A 48 INCH DIAM. 4 FOOT TALL PARTIALLY ROTTEN SAWED DOUGLAS FIR STUMP WHICH IS OPENED TO FIND THE SCRIBING "RTW T24 S. S5"; BEARS S39 1/4° E, 137 1/2 FEET DISTANT (RECORD S40° E, 137 1/2 FEET).

EVIDENCE OF THE TWO 1960 RENEWAL BEARING TREES.
A 14" R. FIR NOW A 30 INCH DIAM. DOUGLAS FIR WITH A FULLY HEALED DOUBLE BLAZE; BEARS N14° E, 13 1/2 FEET DISTANT (AS PER RECORD).
A 10" W. FIR NOW A 12 INCH DIAM. 5 INCH TALL MOSTLY ROTTEN AWAY FIR STUMP; BEARS N57 1/2° W, 37 1/2 FEET DISTANT (AS PER RECORD).

THE ONE 1983 RENEWAL BEARING TREE:
A FIR 19" DIA., NOW A 19 INCH DIAM. 3 FOOT TALL FIR STUMP WHICH WAS SAWED BUT NOW IS MOSTLY BROKEN OFF TO GROUND LEVEL AND STILL HAS THE INTACT BUT LOOSE FACE WITH ALL THE CORRECT SCRIBING. THIS STUMP BEARS N26° W, 41 1/2 FEET DISTANT (AS PER RECORD).

C.S. File 67/42-1

RENEWAL

Monument Set (Procedure and Description)

MONUMENT DETAIL

THE FOUND B. C. MONUMENT'S PLUMB POSITION IS REFERENCED OUT, THE MONUMENT IS REMOVED AND IS THEN RESET PLUMB AND NOW PROTRUDING 6 INCHES ABOVE GROUND.

N/A

New Accessories

A 20 INCH DIAM. DOUGLAS FIR, SCRIBED "T23S R7WS32 CS" "BT" ON A DOUBLE BLAZE; BEARS N67°E, 24 1/2 FEET DISTANT.

AN 11 INCH DIAM. GRAND FIR, SCRIBED "T23S R7WS31" "CSBT" ON A DOUBLE BLAZE; BEARS N32 1/2°W, 26 1/2 FEET DISTANT.

Sketch of Monument, Accessories, and General Area

Location & Comments

SKETCH ONLY SHOWS LIVE B.T.'S

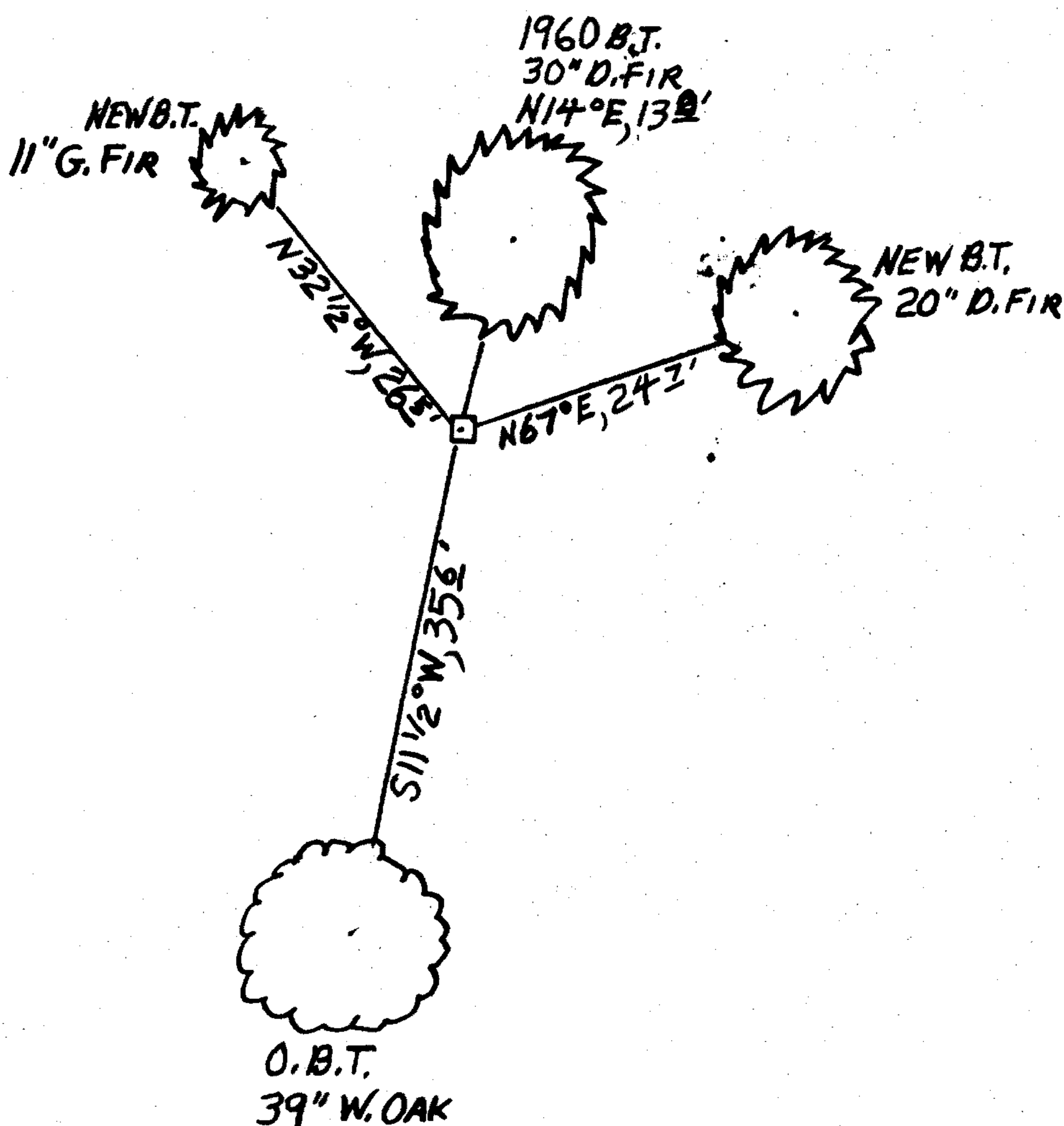

A VERY OLD 16 INCH DIAM. 6 FOOT TALL YEW POST BEARS APPROX. N45°W, 1 1/2 FEET DISTANT. A FENCE CORNER WITH FENCES RUNNING NORTH AND WEST BEARS N35°W, 3 FEET DISTANT.

CORNER IS ON GENTLE WEST-ERLY SLOPE IN VERY OLD SECOND GROWTH FOREST OF MIXED FIR, SOME Comp. Decline. OAK. 15 1/2°E Agency D.C.S.O Party Chief STEPHEN JOHN FLAYKE Note keeper Stephen John Flayke Witnesses MIKE S. KOCH

Surveyor's Seal

REGISTERED PROFESSIONAL LAND SURVEYOR

OREGON JULY 25, 1990 RANDALL W. SMITH 2488

Renewal 6-30-2016