

GOVERNMENT CORNER RESTORATION FORM

FILED

TOWNSHIP 23 S RANGE 07 W SEC. 26 PLSS # 50227

Date: 9-15-2014 By: JC
This survey consists of:

DOUGLAS COUNTY OREGON

DATE AUG. 11, 2014

Map: _____

Narrative: _____

Corner Rpt: CS 67/41-45

Corner Designation

DOUGLAS COUNTY
SURVEYOR

WP
527 | 526

Previous Renewals BLM 1961 SURVEY (FIRST SET WP), 1966
Monument(s) Found: (Condition and Source)

- ___ Condition Report
- ___ Not Found
- Renewed
- ___ Unrecorded
- ___ Surveyed In
- ___ Referenced Out

A WIDE SEARCH IS MADE (USING PIN FINDER)
FOR THE ORIGINAL 1961 BLM MONUMENT
WHICH WAS RESET IN 1966. NO EVIDENCE IS
FOUND. AREA IS SUBJECT TO FREQUENT FLOOD-
ING.

N/A

MONUMENT DETAIL

Accessories Found

NO EVIDENCE REMAINS OF ORIGINAL 18.55 MEANDER CORNER BEARING TREES.

ONE ORIGINAL BEARING TREE TO 1961 WITNESS POINT FOR MEANDER CORNER.
A 22" MYRTLE NOW A 27 INCH DIAMETER MYRTLE WITH A FULLY HEALED HIGH-LOW BLAZE
WHICH IS OPENED TO FIND A ROTTED AWAY UPPER BLAZE AND A PARTLY ROTTED LOWER
BLAZE WHICH SHOWS A CLEAR PARTIAL "BT" SCRIBE. THIS TREE BEARS N 71° E, 56[±] FEET
DISTANT (AS PER ORIGINAL RECORD).

OTHER 1961 B.T. IN FLOOD ZONE IS GONE.

THE 1966 NEW BEARING TREE.

A 9" MYRTLE NOW A 16 INCH DIAM. MYRTLE WITH A FULLY HEALED DOUBLE BLAZE WHICH
IS PARTLY OPENED TO FIND EVIDENCE OF A MOSTLY ROTTED AWAY BLAZE FACE WITH
NO SCRIBING FOUND. THIS TREE BEARS S 01° E, 56[±] FEET DISTANT (RECORD S 01° W, 56[±]
FEET).

RENEWAL

Monument Set (Procedure and Description)

A 2 3/8 INCH DIAMETER BRASS CAP (MARKED AS AT RIGHT) ON A 1 INCH I.D., 32 INCH LONG IRON PIPE IS SET PLUMB, PROTRUDING 3 INCHES ABOVE GROUND. A ROUGH, APPROXIMATELY 2 FOOT DIAM. MOUND OF STONE IS SET AROUND B.C. MONUMENT AND RISES APPROX. 3 INCHES ABOVE IT.

MONUMENT DETAIL

DOUGLAS COUNTY SURVEYOR
T235 R7W
WP
S 27 | S 26
2014

New Accessories

A 20 INCH DIAM. DOUGLAS FIR SCRIBED "WPS26CS" "BT" ON A DOUBLE BLAZE; BEARS S33°E, 28 1/2 FEET DISTANT.

A 2 INCH WIDE "U" SHAPED GALVANIZED STEEL POST PROTRUDING 3 FEET ABOVE GROUND; BEARS S08°W, 4 FEET DISTANT.

Sketch of Monument, Accessories, and General Area

Location & Comments

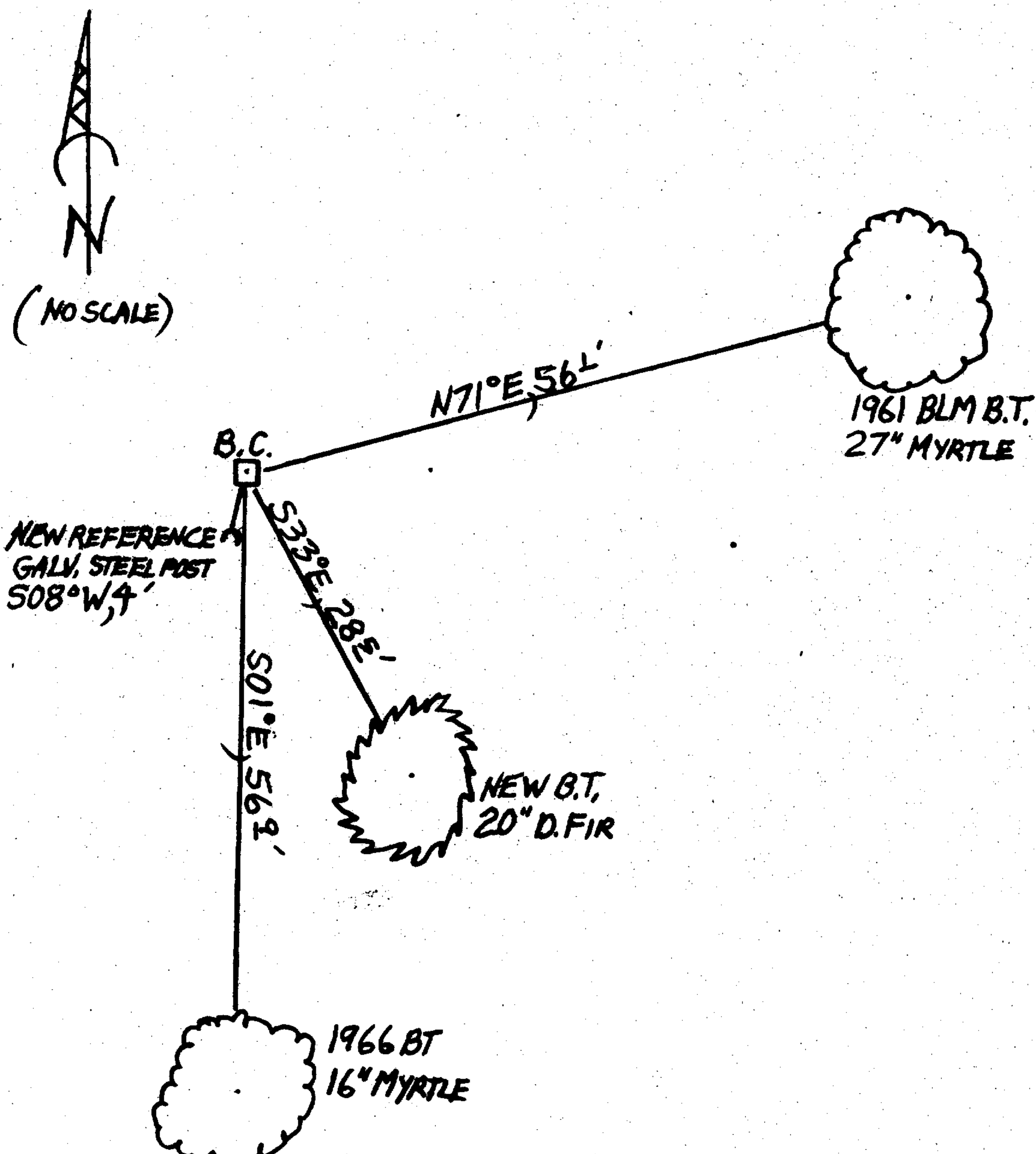

MONUMENT IS HIGH ON EASTERLY EDGE OF THE RIGHT BANK UMPQUA RIVER FLOODPLAIN. AREA SUBJECT TO FLOODING, MONUMENT MAY BE WASHED AWAY OR BURIED. MONUMENT IS ≈ 90 FT. NORTH FROM THE C. OF A GRAVEL RD. RUNNING NE-SW.

Comp. Decline. 15 1/2° E
Agency D.C.S.O.
Party Chief STEPHEN JOHN FLAISE
Note keeper Stephen John Flaise
Witnesses MIKE S. KOHN

Surveyor's Seal

REGISTERED
PROFESSIONAL
LAND SURVEYOR

Randall W. Smith

OREGON
JULY 25, 1980
RANDALL W. SMITH
2488

RWD/ML 6-30-2016