

GOVERNMENT CORNER RESTORATION FORM

FILED

TOWNSHIP 24S RANGE 07W SEC. 11 PLSS # 573500

Date: 8/12/2014 By: JC  
This survey consists of:

DOUGLAS COUNTY OREGON

DATE AUG. 1, 2014

Map: \_\_\_\_\_

Narrative: \_\_\_\_\_

Corner Designation

Corner Rpt: C5 67/41-36

WC S 11  
MC S 14

DOUGLAS COUNTY  
SURVEYOR

Previous Renewals 1994-95 DEPENDENT RESURVEY, BLM  
Monument(s) Found: (Condition and Source)

- \_\_\_ Condition Report
- \_\_\_ Not Found
- Renewed
- \_\_\_ Unrecorded
- \_\_\_ Surveyed In
- \_\_\_ Referenced Out

FROM THE 1994-95 BLM SURVEY:  
A 3 INCH DIAM. BRASS CAP (INCORRECTLY CALLED 3 3/4 INCH PREV.)  
(MARKED AS AT RIGHT) IN BEDROCK SHELF AT THE  
BASE OF A 40+ FOOT HIGH ROCK BLUFF.  
BRASS CAP IS FLUSH WITH ROCK.

MONUMENT DETAIL

U.S. DEPT. OF THE INTERIOR  
 WC  
 T24S R7W  
S 11 → MC  
S 14  
 1994  
 BUR. OF LAND MANAGEMENT

Accessories Found

NO EVIDENCE REMAINS OF 1857 B.T.S OR WITNESS B.T.S.  
THE BEARING TREE AND BEARING OBJECT FROM THE 1994-95 REESTB. OF  
THE WITNESS CORNER TO THE MEANDER CORNER:  
A HEMLOCK 30" DIAM. NOW A 34 INCH DIAM. HEMLOCK WITH A FULLY HEALED BLAZE; BEARS  
N73°E, 508 FEET DISTANT (AS PER RECORD).  
LETTERS SCRIBED IN ROCK BLUFF "X" "BO" ACTUALLY MARKED "B X O" (2 INCH LETTERS AND  
A 3X3 INCH X) THE CENTER OF WHICH BEARS S34°2'W, 132 FEET DISTANT (AS PER RECORD).

C.S. File 67/41-36

N/A

N/A

New Accessories

TWO ACCESSORIES THAT MAY CHANGE POSITION BUT WILL BE USEABLE FOR A FEW YEARS:

A METAL PHONE PEDESTAL MARKED "#7"; BEARS N36°E, 48<sup>1</sup>/<sub>2</sub> FEET DISTANT.

A METAL MILEPOST MARKED "8 DOUGLAS COUNTY 57" ON THE WESTERLY ROAD SHOULDER; BEARS N13<sup>1</sup>/<sub>2</sub>°W 42<sup>2</sup>/<sub>2</sub> FEET DISTANT.

AND A NEW BEARING TREE.

A 22 INCH MYRTLE SCRIBED "WC.CS.BT" ON A SINGLE BLAZE; BEARS N03°W, 143<sup>3</sup>/<sub>3</sub> FEET DISTANT.

Sketch of Monument, Accessories, and General Area

Location & Comments

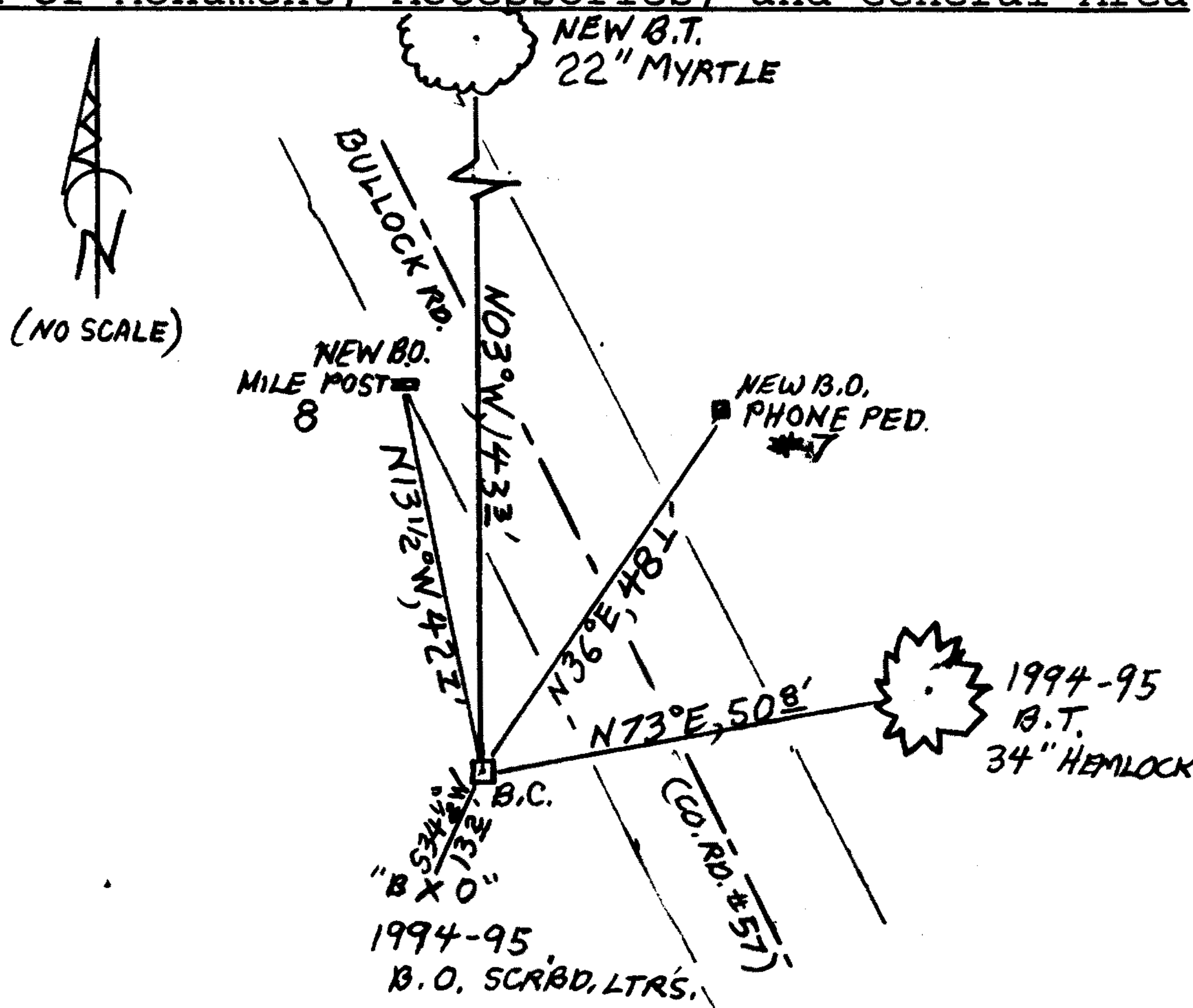

MONUMENT IS IN SOLID ROCK SHELF JUST ABOVE WESTERLY ROAD SHOULDER.

Comp. Decline. 15<sup>1</sup>/<sub>2</sub>°E  
 Agency D.C.S.D.  
 Party Chief STEPHEN JOHN FLAISE  
 Note keeper Stephen John Flaize  
 Witnesses MIKE S. KOCH

Surveyor's Seal

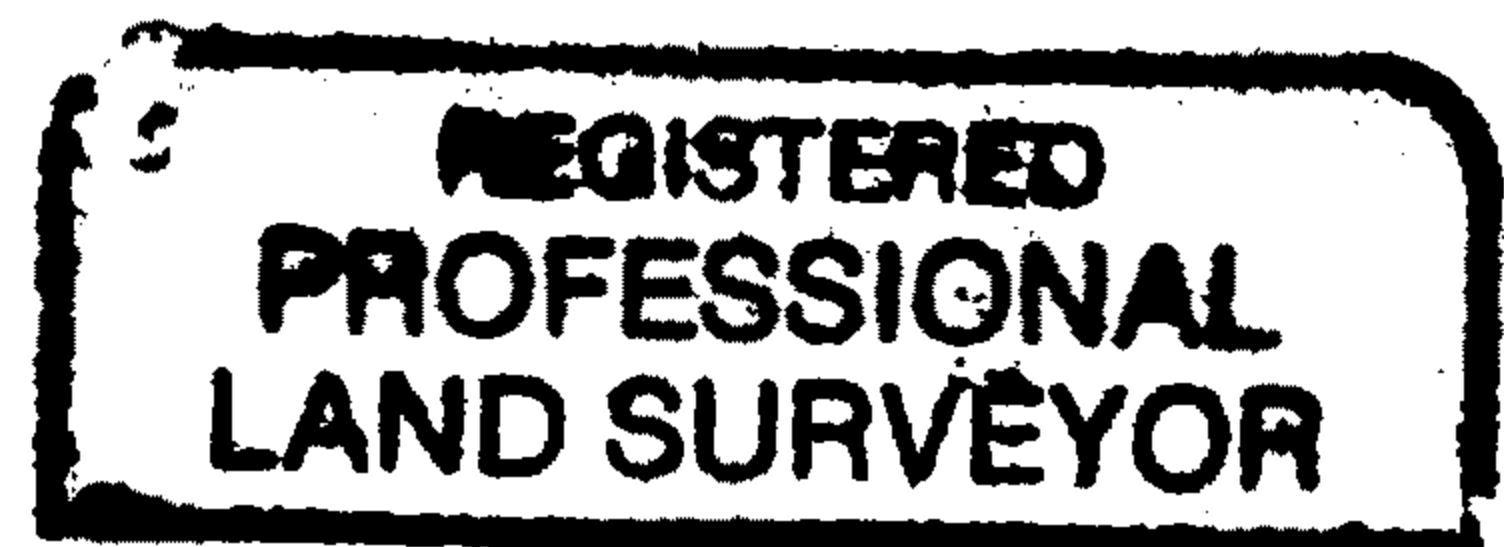

*Handwritten signature of Randall W. Smith*

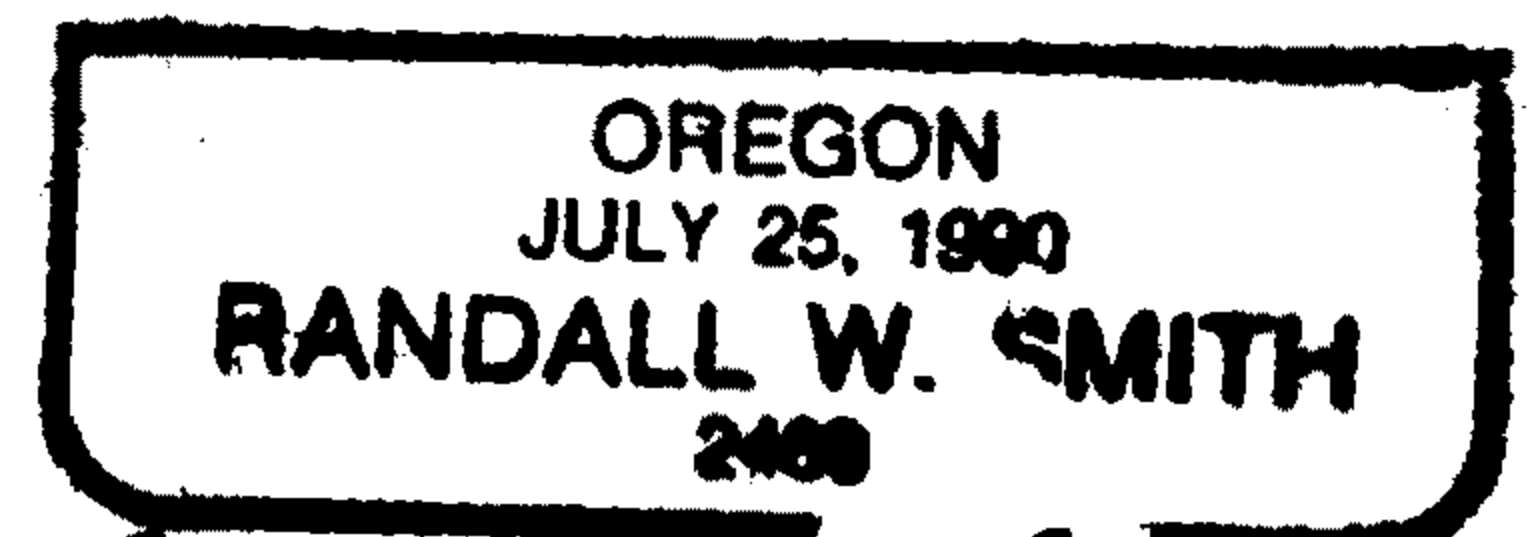

RENEWAL 6-30-2016