

GOVERNMENT CORNER RESTORATION FORM

FILED

TOWNSHIP 24S RANGE 07W SEC. 01 PLSS # 600700

Date: 8-4-2014 By: XC

DOUGLAS COUNTY OREGON

DATE JULY 28, 2014

This survey consists of:

Map: _____

Narrative: _____

Corner Rpt: CS 67/41-32

Corner Designation

S35
S2 | S1

DOUGLAS COUNTY SURVEYOR

Previous Renewals ESTR. 1958, AMENDED 1961-62, REN. 1992-93
Monument(s) Found: (Condition and Source)

- _____ Condition Report
- _____ Not Found
- Renewed
- _____ Unrecorded
- _____ Surveyed In
- _____ Referenced Out

FROM THE 1961-62 AMENDING RESURVEY A
3 1/4 INCH DIAMETER BRASS CAP (MARKED AS AT RIGHT)
ON A 2 INCH I.D. IRON PIPE IS SET NEAR PLUMB
PROTRUDING 5 INCHES ABOVE GROUND.

MONUMENT DETAIL

U. S. CADASTRAL SURVEY

T23 S R7W

S35
S2 | S1

T24 S R7W

CC
1962

BUREAU OF LAND MANAGEMENT

FOUND MON. US CADASTRAL SURVEY
IN ACCESS. T23 S R7W

AM
S35
S2 | S1

Accessories Found

A TIE TO THE CORNER EAST (SECTIONS 35 AND 36 ONLY IN T23S, R7W) IS MADE TO ESTAB-
LISH A BASIS OF BEARING. THE BEARING USED IS N 88° 46' 30" E (AS PER 1992-93 BLM RECORD).
THE DISTANCE MEASURED IS 426.69 FEET (AS PER SAME BLM RECORD).

BUREAU OF LAND MANAGEMENT

FROM THE 1958 BLM SURVEY (AMENDED IN 1961-62 RESURVEY) A 3 1/4 INCH DIAM. BRASS CAP (MARKED
AS IN THE LOWER MONUMENT DETAIL, ABOVE) ON A 2 INCH I.D. IRON PIPE WHICH IS LEANING
APPROX. N 75° W, 09 FEET OFF OF PLUMB. BRASS CAP IS ORIENTED SSW AND SOIL AROUND
MON. APPEARS DISTURBED. WE RETURN MON. TO PLUMB AND PROTRUDING 11 INCHES. WE MEASURE MON.
TO BE N 0° 34' E, 73 1/2 FEET DISTANT (BLM RECORD NORTH 75 1/2 FT, 1962 HAINES SURVEY
M23-64 NORTH 73 1/2 FT) BEARING TREES FOR THIS MON. ARE GONE, ROOT-HOLES NEAR RECORD B AND D.

FROM THE 1961-62 RESURVEY NO EVIDENCE REMAINS OF THE NOTED LOCALLY ESTABLISHED
CLOSING CORNER OR ITS B.T.'S. NO EVIDENCE REMAINS OF THE SE BEARING TREE. A POS-
SIBLE ROOT-HOLE AND LOOSE B.T. TAG ARE FOUND NEAR RECORD B AND D. OF SW BEARING TREE.

FROM THE 1992-93 RESURVEY RENEWAL THE TWO NEW BEARING TREES.
A FIR 10" DIA. NOW A 19 INCH DIAM. DOUGLAS FIR WITH A FULLY HEALED SINGLE BLAZE; BEARS
S64° E, 25 1/2 FEET DISTANT (RECORD S 63° E, 25 1/2 FT.)
A FIR 12" DIA. NOW A 10 INCH DIAM. 8 FOOT TALL DOUGLAS FIR SNAG WITH A FULLY HEALED
SINGLE BLAZE; BEARS S 62° 1/4 W, 21 1/2 FEET DISTANT (RECORD S 58° W, 21 1/2 FEET).

N/A

N/A

New Accessories

A 2 1/2 x 2 1/2 INCH, 4 FOOT TALL STEEL FENCE POST (PAINTED RED AND WHITE); BEARS N 31° E, 32 FEET DISTANT. FALLEN FENCES RUN SOUTH AND WEST FROM THIS CORNER POST.

A 12 INCH DIAM. DOUGLAS FIR SCRIBED "CCT24SR7WS1CS" "BT" ON A DOUBLE BLAZE; BEARS S 31 1/2° E, 27 1/2 FEET DISTANT.

A 27 INCH DIAM. GRAND FIR SCRIBED "CCT24SR7WS2" "CSBT" ON A DOUBLE BLAZE; BEARS S 34° W, 39 1/2 FEET DISTANT.

Sketch of Monument, Accessories, and General Area

Location & Comments

SKETCH SHOWS FOUND MONUMENTS AND NEW ACC.'S ONLY.

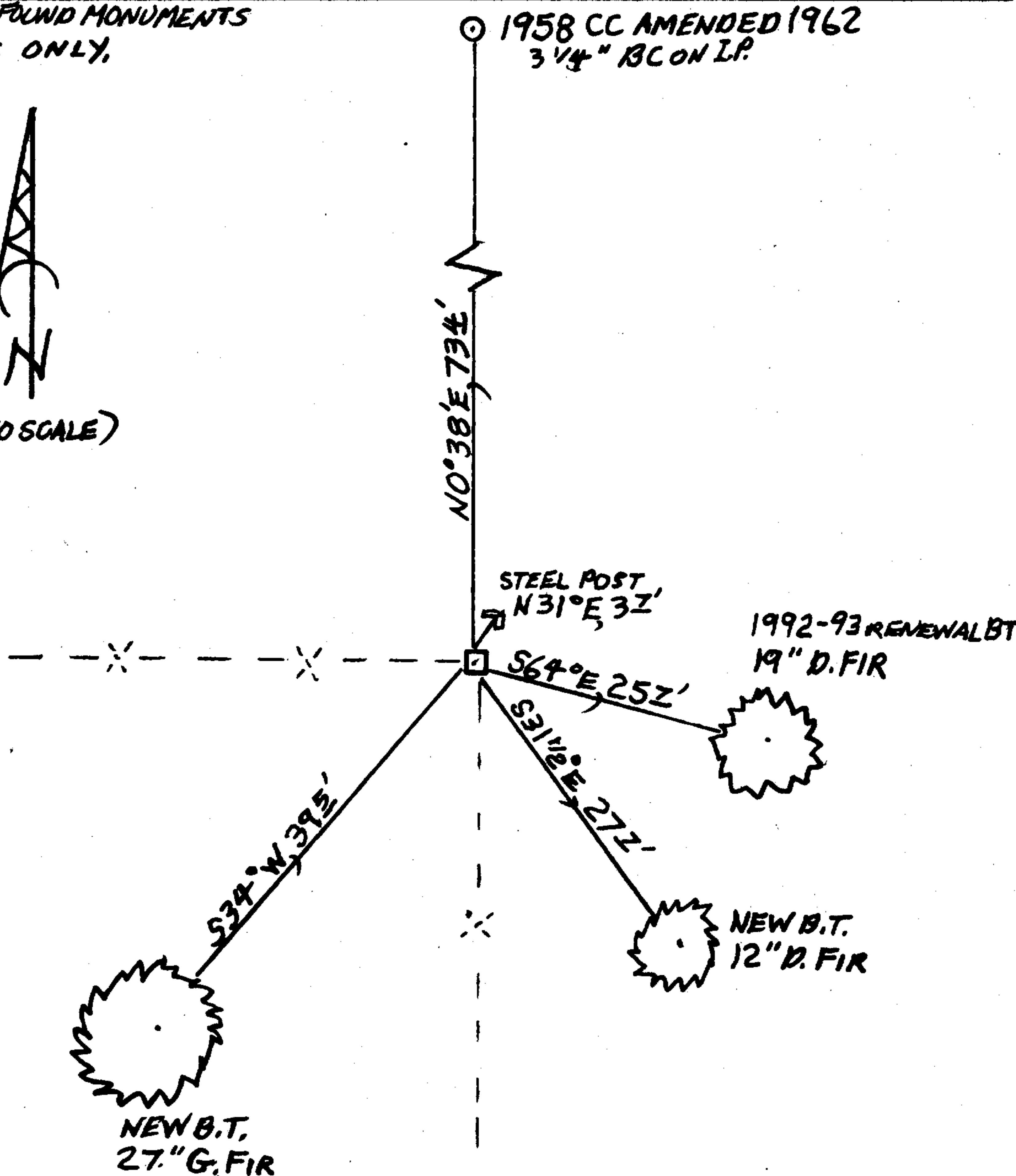
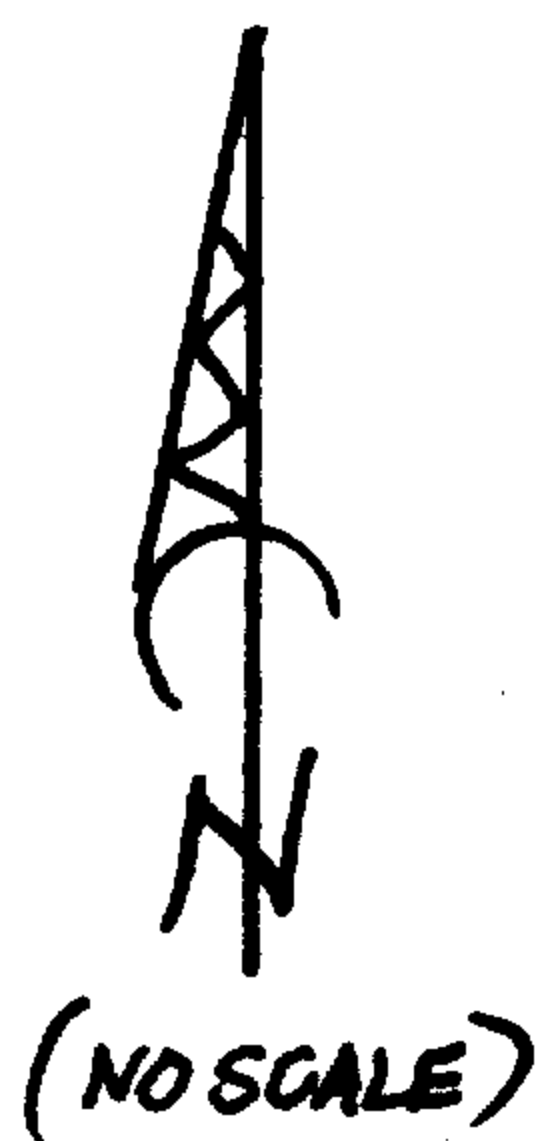

MONUMENT IS ON GENTLY SOUTH SLOPING GROUND IN OLD MIXED FIR REPROD FOREST.

Comp. Decline. 15 1/2° E
Agency D.C.S.O.
Party Chief STEPHEN JOHN FLAUSE
Note keeper Stephen John Flause
Witnesses MIKE S. KOCH

Surveyor's Seal

REGISTERED PROFESSIONAL LAND SURVEYOR

Randall W. Smith

OREGON
JULY 25, 1990
RANDALL W. SMITH
2400

Renewed 6-30-2016