

GOVERNMENT CORNER RESTORATION FORM

FILED

TOWNSHIP 245 RANGE 07W SEC. 01 PLSS # 600600

Date: 8/4/2014 By: JC
This survey consists of:

DOUGLAS COUNTY OREGON

DATE JULY 16, 2014

Map: _____

Narrative: _____
Corner Rpt: CS 67/41-28

Corner Designation

DOUGLAS COUNTY
SURVEYOR

S2 | S1
S11 | S12

- ___ Condition Report
- ___ Not Found
- Renewed
- ___ Unrecorded
- ___ Surveyed In
- ___ Referenced Out

Previous Renewals 1958, 1988
Monument(s) Found: _____ (Condition and Source)

MONUMENT DETAIL

FROM THE 1988 RENEWAL A 2 3/8 INCH DIAM-
ETER BRASS CAP (MARKED AS AT RIGHT) ON A
1 INCH I.D. IRON PIPE IS SET APPROX. FLUSH WITH
THE GROUND. THE 18 X 13 X 3 INCH STONE IS
FOUND AS DESCRIBED IN THE RENEWAL.
THE REMAINS OF THE 1958 B.C. MONUMENT
ARE NOT LOOKED FOR.

DOUGLAS COUNTY SURVEYORS
T 245

S2 | S1
S11 | S12
R7W
1988

Accessories Found

EVIDENCE OF THE 3 O.B.T.'S FOUND IN 1988 REMAINS BUT ALL 3 HAVE FALLEN DOWN.
ALL BEARINGS AND DISTANCES (MEASURED TO FOUND CENTERS OF ROOT-CROWNS) AGREE WITH 1988 RECORD.
THE SW O.B.T IS NOW A FALLEN AND ROTTING 54 INCH DIAM. BLACK OAK WITH FULLY
HEALED BLAZES.
THE NE O.B.T IS NOW A FALLEN AND OUT OF POSITION ROTTING 60 INCH BLACK OAK
WITH BLAZES AS DESCRIBED.
THE NW O.B.T. IS NOW A FALLEN AND ALMOST COMPLETELY ROTTEN AWAY OAK. NO BLAZE EVI-
DENCE REMAINS.

THE 3 NEW IN 1958 B.T.S ARE FOUND AS DESCRIBED IN 1988. BEARINGS AND DISTANCES
AGREE WITH THE 1988 RECORD. THESE B.T.S ARE NOW SIZED AS FOLLOWS:
THE NE'LY B. OAK MEASURES 24 INCHES.
THE SE'LY W. OAK MEASURES 18 INCHES.
THE NW'LY W. OAK MEASURES 26 INCHES.

C.S. File 67/41-28

RENEWAL

Monument Set (Procedure and Description)

MONUMENT DETAIL

N/A

N/A

New Accessories

A 55 INCH DIAM. BLACK OAK SCRIBED "T24SR7W/S11" "CSBT" ON A DOUBLE BLAZE; BEARS S47°W, 992 FEET DISTANT.

Sketch of Monument, Accessories, and General Area

Location & Comments

SKETCH ONLY SHOWS LIVE TREES.

MONUMENT IS ON SOUTHWEST SLOPE IN OPEN GRASSLAND WITH SCATTERED OAKS.

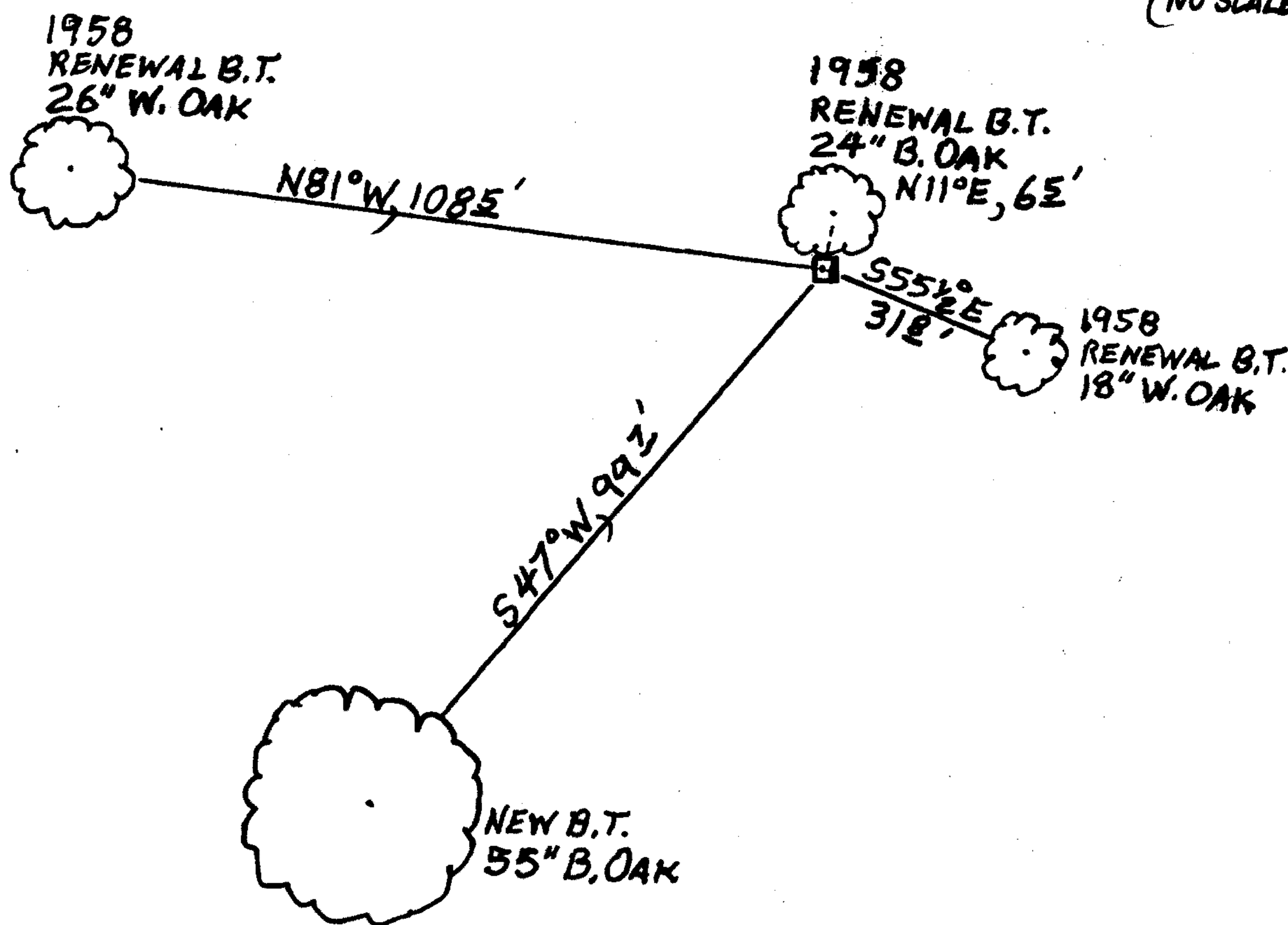

Comp. Decline. 15 1/2° E
Agency D.C.S.O.
Party Chief STEPHEN JOHN FRAUSE
Note keeper Stephen John Frause
Witnesses MIKE S. KOCH

Surveyor's Seal

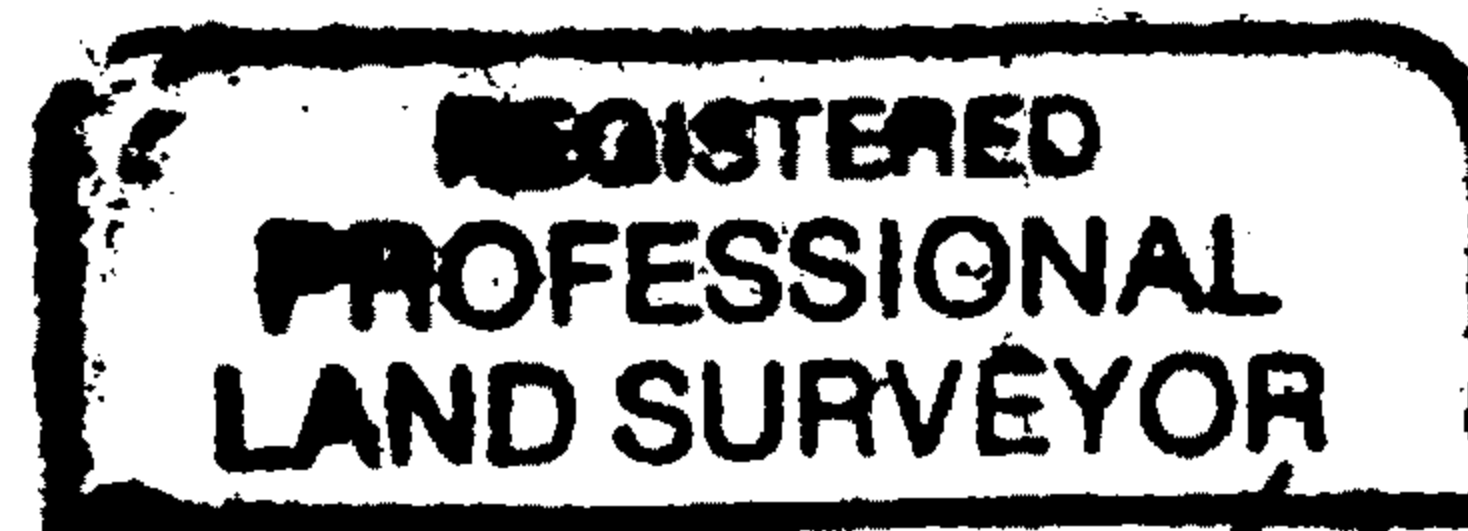

Handwritten signature of Randall W. Smith

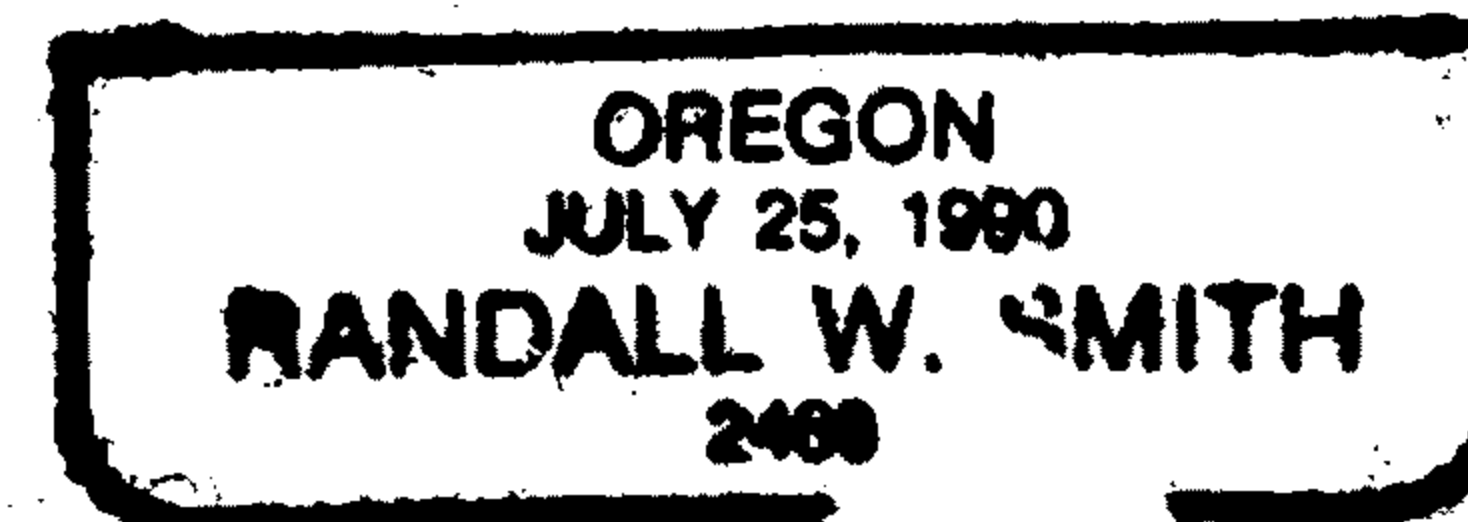

RENEWAL 6-30-2016