

GOVERNMENT CORNER RESTORATION FORM

FILED

TOWNSHIP 28S RANGE 06W SEC. 13 PLSS # 043040

Date: 6/17/2014 By: JC
This survey consists of:

DOUGLAS COUNTY OREGON

DATE MAY 7, 2014

Map: _____

Narrative: _____

Corner Rpt: CS 67/41-22

Corner Designation

DOUGLAS COUNTY
SURVEYOR

SSE
DLC 47

- Condition Report
- Not Found
- Renewed
- Unrecorded
- Surveyed In
- Referenced Out

Previous Renewals 1962
Monument(s) Found: (Condition and Source)

A 2 1/2 INCH DIAMETER BRASS CAP (MARKED AS AT RIGHT) ON A 1 INCH I.D. IRON PIPE, FIRMLY SET AND PROTRUDING 14 INCHES ABOVE GROUND.

MONUMENT DETAIL

COUNTY SURVEYORS OFFICE

T28 S R6W

S.E. COR.

D.L.C. 43

1962

Accessories Found

EVIDENCE OF ORIGINAL B.T.
A B. OAK 8" DIA NOW A VERY ROTTEN 20 INCH DIAM. 1 FOOT TALL OAK STUMP WITH NO REMAINING BLAZING OR SCRIBING; BEARS S 77° E, 21 1/2 FEET DISTANT (RECORD S 75° E, 21 1/2 FEET)

1962 RENEWAL BEARING TREE PROBABLY FOUND (CAN NOT OPEN TO VERIFY DUE TO LEAN OF TRUNK BUT REMARK AS NEW B.T.; SEE BELOW).
10" B. OAK NOW A 20" BLACK OAK WITH NO VISIBLE SCARS; BEARS N 56 1/2° W, 12 1/2 FEET DISTANT (RECORD N 61° W, 13 1/2 FF).

RENEWAL

Monument Set (Procedure and Description)

MONUMENT DETAIL

MONUMENT ACCEPTED AS FOUND

N/A

New Accessories

(ON A DOUBLE BLAZE)

A 26 INCH DIA. MADRONE SCRIBED "SSE DLC 43" "CSBT" BEARS NO 8° E, 25 1/2 FEET DISTANT AN E-W RUNNING WIRE FENCE IS GROWN INTO THIS TREE.

AN 18 INCH DIA. MADRONE SCRIBED "SSE DLC 43 CS" "BT" ON A DOUBLE BLAZE; BEARS S 67 3/4° E, 19 1/2 FEET DISTANT.

A 14 INCH DIA. MADRONE SCRIBED "SSE DLC 43" "CSBT" ON A DOUBLE BLAZE; BEARS S 00 1/4° W, 24 1/2 FEET DISTANT.

A 20 INCH DIA. BLACK OAK (SEE 1962 RENEWAL B.T. ABOVE) SCRIBED "SSE DLC 43 CS" "BT" ON A DOUBLE BLAZE; BEARS N 56 1/2° W, 12 1/2 FEET DISTANT.

Sketch of Monument, Accessories, and General Area

Location & Comments

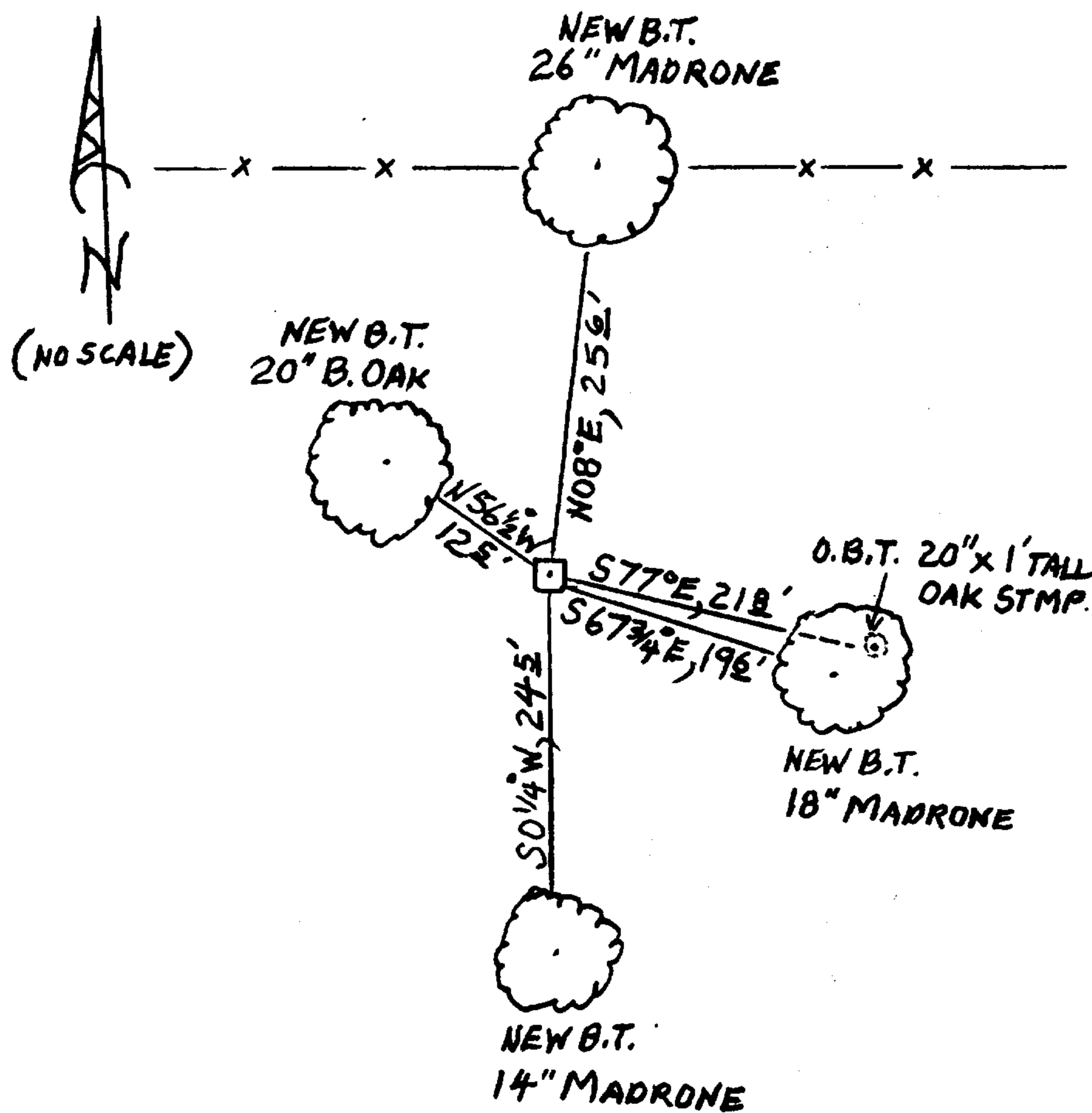

MONUMENT IS ON SOUTH EDGE OF BOTTOM OF SHALLOW WNW RUNNING DRAW. DRAW IS ON MODERATE WEST'LY SLOPE IN A MADRONE AND OAK WOODS. MONUMENT IS APPROX. 24 FEET SOUTH FROM AN OLD EAST-WEST RUNNING WIRE FENCE.

Comp. Decline. 15 1/4° E
Agency D.C.S.O.
Party Chief STEPHEN JOHN FLAUSE
Note keeper Stephen John Flause
Witnesses MIKE S. KOCH

Surveyor's Seal

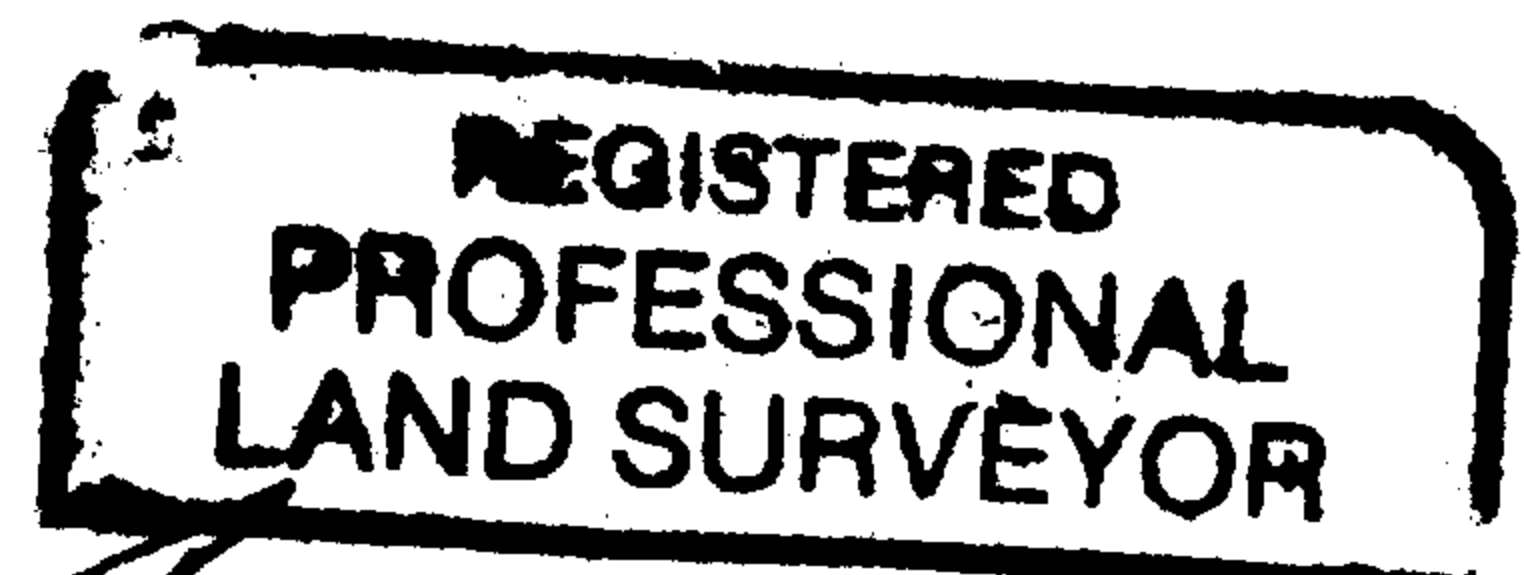

Randall W. Smith

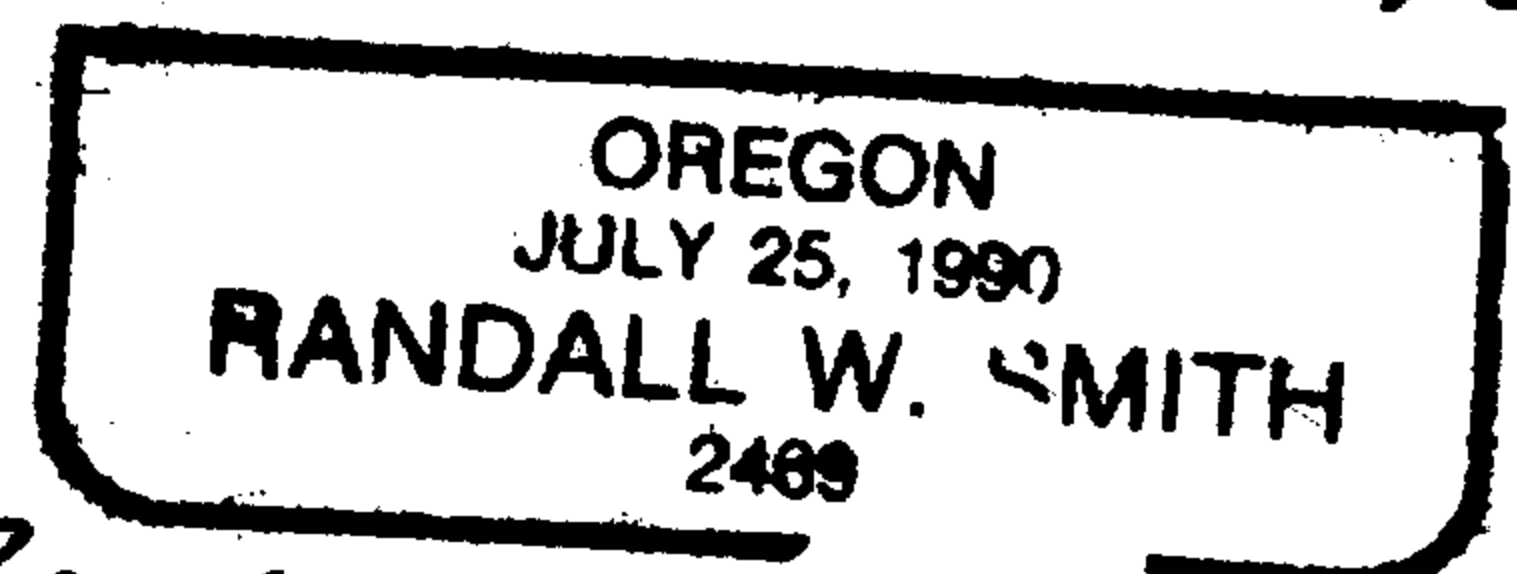

Renewal 6-30-2016