

GOVERNMENT CORNER RESTORATION FORM

FILED

TOWNSHIP 245 RANGE 04W SEC. 21 PLSS # 039060

Date: 1-28-2014 By: JC

This survey consists of:

DOUGLAS COUNTY OREGON

DATE JAN. 14, 2014

Map: \_\_\_\_\_

Narrative: \_\_\_\_\_

Corner Designation

Corner Rpt: CS 67/41-12

SE  
DLC 39

DOUGLAS COUNTY  
SURVEYOR

Previous Renewals 1945, 1956  
Monument(s) Found: \_\_\_\_\_ (Condition and Source)

- \_\_\_\_\_ Condition Report
- \_\_\_\_\_ Not Found
- Renewed
- \_\_\_\_\_ Unrecorded
- \_\_\_\_\_ Surveyed In
- \_\_\_\_\_ Referenced Out

A SEARCH WAS MADE (USING METAL DETECTOR) FOR THE 1945 I.P. MONUMENT. NO EVIDENCE FOUND.

MONUMENT DETAIL

FROM THE 1956 RENEWAL:  
A 2 1/2 INCH DIAMETER BRASS CAP (MARKED AS AT RIGHT) ON A 1 INCH I.D. IRON PIPE SET PROTRUDING 11 INCHES ABOVE GROUND.

COUNTY SURVEYOR'S  
T.24S. R.4W

S.E.  
COR.  
D.L.C. 39

1956  
OFFICE

Accessories Found

THE 1945 RENEWAL BEARING TREE (THIS COULD ALSO BE O.B.T., BUT WHEN TREE IS OPENED TO VERIFY SCRIBING, EVIDENCE IS FOUND AT THE 50 INCH TRUNK DIAM. ONLY; CENTER OF TREE IS COMPLETELY ROTTED AWAY AT DIAM. UNDER 30 INCHES).  
A 50" B. OAK NOW A 58 INCH DIAM., 10 FOOT TALL, ROTTED BLACK OAK SNAG WHICH WE OPEN TO FIND REMAINS OF REVERSE SCRIBING "CS CL38 SE B" (REVERSE SCRIBING FOUND AT 1945 DIAM.). THIS TREE BEARS S.5 1/2° E, 164.0 FEET DISTANT (RECORD S.5 1/2° E, 157.8).

THE 1956 RENEWAL BEARING TREE A 20" DIA. W. OAK (IDENTIFIED AS 12" DIA. IN 1963); NOW A 14 INCH DIAM. WHITE OAK WITH A FULLY HEALED DOUBLE BLAZE; BEARS N89° E, 22.0 FEET DISTANT (AS PER RECORD).

Monument Set (Procedure and Description)

MONUMENT DETAIL

N/A

N/A

New Accessories

THREE NEW B.T.'S:

A 14 INCH DIAM. WHITE OAK SCRIBED "SE DLC 39 CS" "BT" ON A DOUBLE BLAZE; BEARS S32 1/2° E, 12 2 FEET DISTANT.

A 29 INCH DIAM. DOUGLAS FIR SCRIBED "SE DLC 39 CS" "BT" ON A DOUBLE BLAZE; BEARS S73 1/2° W, 39 2 FEET DISTANT.

A 20 INCH DIAM. WHITE OAK SCRIBED "DLC BT" ON A LOW SINGLE BLAZE (FENCE WIRE IN TRUNK ABOVE BLAZE); BEARS N04° W, 11 6 FEET DISTANT.

Sketch of Monument, Accessories, and General Area

Location & Comments

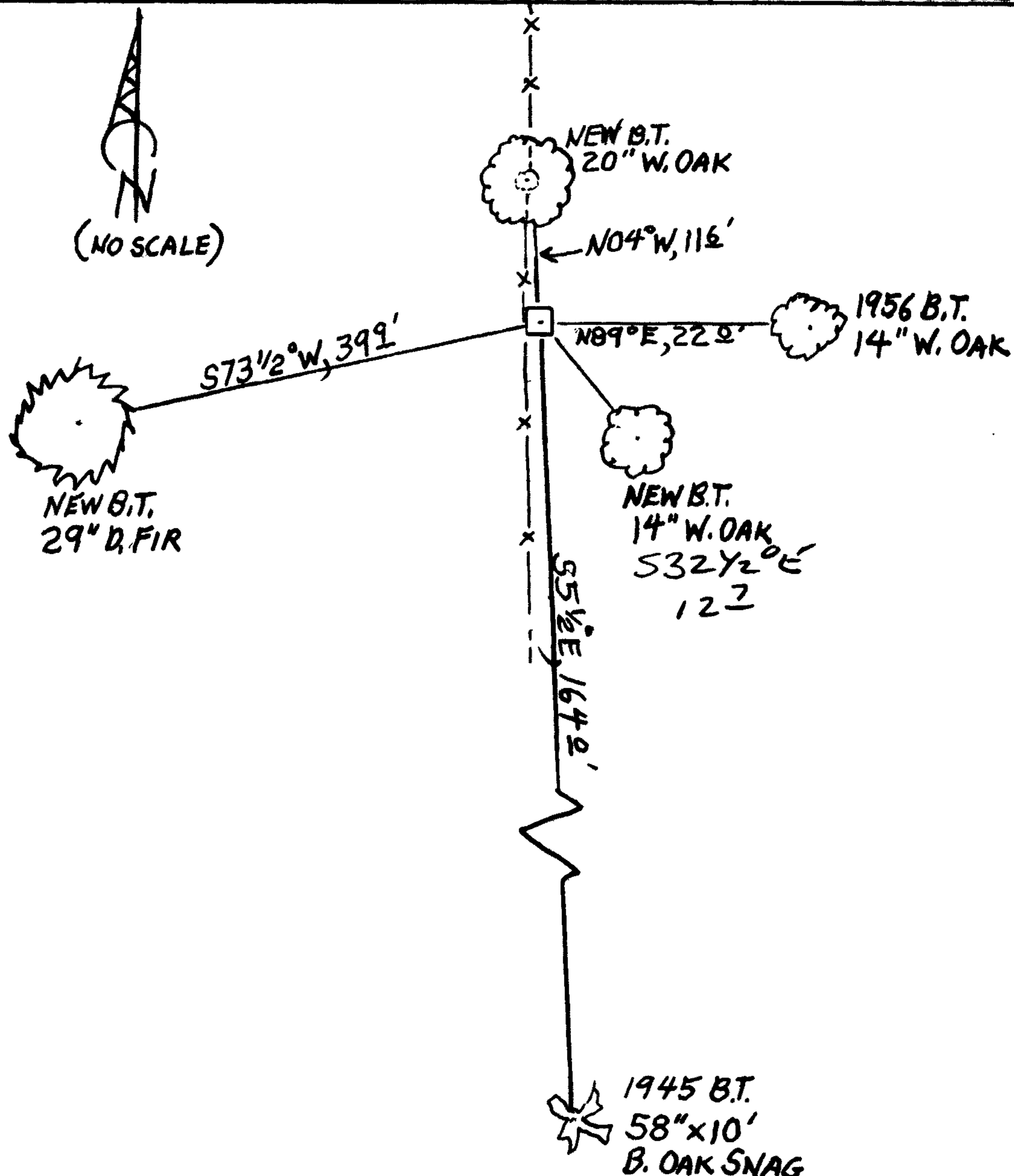

MONUMENT IS ON LARGE FLAT BENCH NEAR FOOT OF MODERATE NORTH SLOPE IN AN OLDER REPROD FOREST OF OAK AND FIR.

Comp. Decline. 15 1/2° E  
Agency D.C.S.D.  
Party Chief STEPHEN JOHN FRAUSE  
Note keeper Stephen John Frause  
Witnesses MIKE S. KOCH

Surveyor's Seal

REGISTERED PROFESSIONAL LAND SURVEYOR

*Handwritten signature of Randall W. Smith*

OREGON  
JULY 25, 1990  
RANDALL W. SMITH  
2488

Renewed 6-30-14