

GOVERNMENT CORNER RESTORATION FORM

FILED

TOWNSHIP 24S RANGE 4W SEC. 21 PLSS # 038030

Date: 1-13-2014 By: JC

This survey consists of:

DOUGLAS COUNTY OREGON

DATE JANUARY 10, 2014

Map: _____

Narrative: _____

Corner Rpt: CS 67/41-11

Corner Designation

SW
DLC 38

DOUGLAS COUNTY
SURVEYOR

Previous Renewals 1956
Monument(s) Found: (Condition and Source)

- Condition Report
- Not Found
- Renewed
- Unrecorded
- Surveyed In
- Referenced Out

FROM THE 1956 RENEWAL:
A 2 1/2 INCH DIAMETER BRASS CAP (MARKED AS AT RIGHT)
ON A 1 INCH I.D. IRON PIPE SET PROTRUDING 8
INCHES ABOVE GROUND.

MONUMENT DETAIL

COUNTY SURVEYOR'S

T. 24S. R. 4W.

S.W.
COR.
D.L.C. 38

1956

OFFICE

Accessories Found

EVIDENCE OF THE 2 ORIGINAL B.T.S.:
TWO LARGE, DEEP AND IRREGULAR ROOT-HOLES ARE FOUND AT THE RECORD BEARINGS AND
DISTANCES (EVIDENCE SUGGESTS FACE MEASUREMENT DISTANCES WERE USED TO SET B.T.C. MONUMENT).
THE ORIGINAL OAK, 36" DIA. IN THE NW QUADRANT IS NOW A FALLEN AND ROTTED 55 INCH DIAM.
BLACK OAK WITH A PREVIOUSLY OPENED BLAZE SHOWING REHEAL BURLING BUT WITH ALL BLAZE
AND SCRIBING EVIDENCE ROTTED AWAY. THIS TREE IS AT THE SOUTH EDGE OF ITS ROOT HOLE AND
LIES HEADING IN A SOUTHWARD DIRECTION.

THE TWO 1956 RENEWAL BEARING TREES:
A 9" W. OAK NOW A 13 INCH DIAM. WHITE OAK WITH A FULLY HEALED DOUBLE BLAZE; BEARS N14 1/2° E,
22° FEET DISTANT (RECORD N16° E, 22.0').
A 9" W. OAK NOW AN 11 INCH DIAM. WHITE OAK WITH A FULLY HEALED DOUBLE BLAZE; BEARS N78 1/2° E,
33° FEET DISTANT (RECORD N80° E, 33.9').

Monument Set (Procedure and Description)

MONUMENT DETAIL

N/A

N/A

New Accessories

A 13 INCH DIAM. INCENSE CEDAR SCRIBED "SW DLC 38CS" "BT" ON A DOUBLE BLAZE; BEARS S56 3/4° W, 42 1/2 FEET DISTANT.

A 28 INCH DIAM. DOUGLAS FIR SCRIBED "SW DLC 38CS" "BT" ON A DOUBLE BLAZE; BEARS N54 3/4° W, 42 1/2 FEET DISTANT.

Sketch of Monument, Accessories, and General Area

Location & Comments

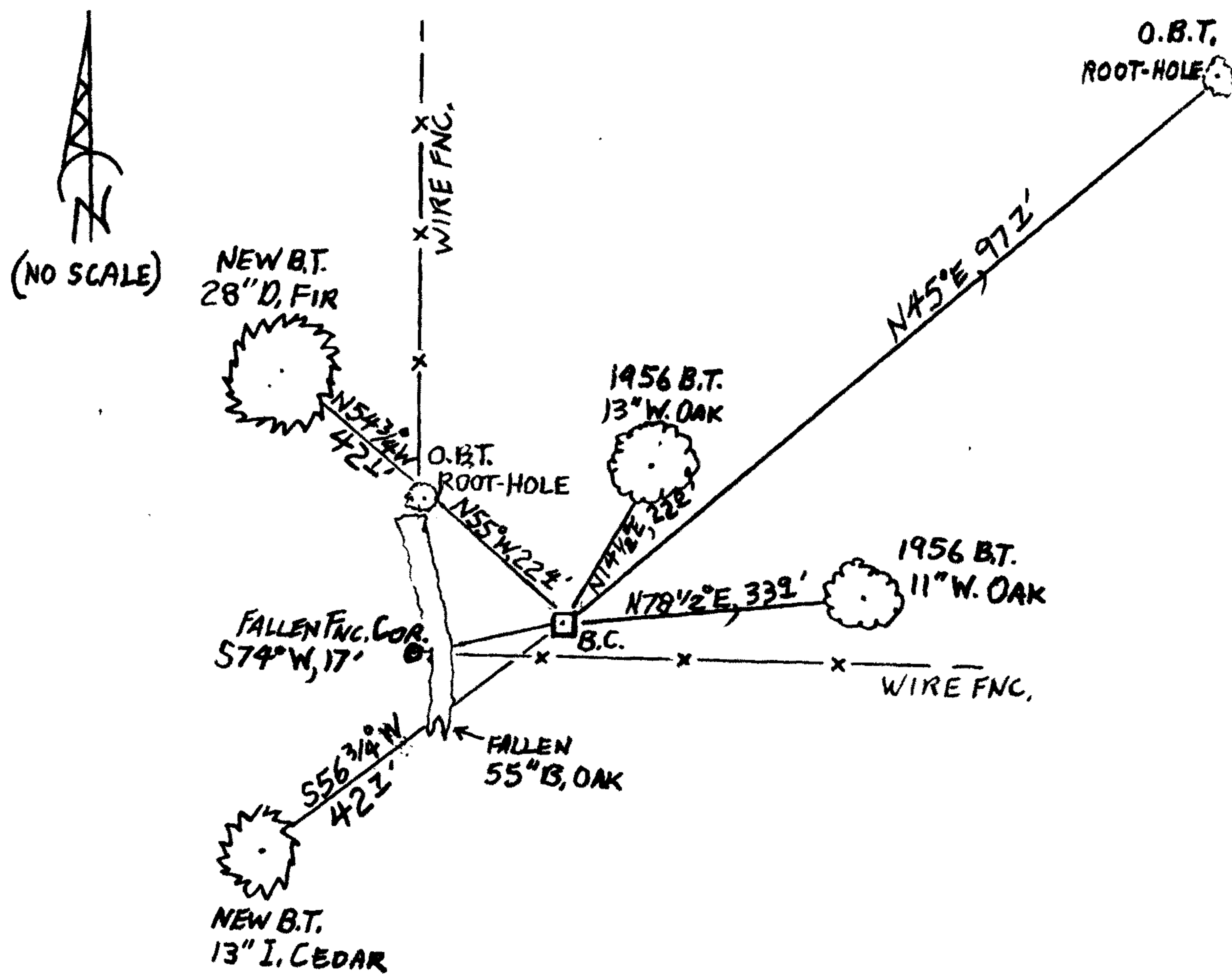

MONUMENT IS ON FLAT BENCH IN A GENTLE NORTH SLOPE AND IN AN OLDER FIR AND OAK FOREST.

Comp. Decline. 15 1/2° E
Agency D.C.S.O.
Party Chief STEPHEN JOHN FLAUSE
Note keeper Stephen John Flause
Witnesses MIKE S. KOCH

Surveyor's Seal

REGISTERED
PROFESSIONAL
LAND SURVEYOR

Randall W. Smith

OREGON
JULY 25, 1990
RANDALL W. SMITH
2468

London 6-30-2014