

GOVERNMENT CORNER RESTORATION FORM

FILED

TOWNSHIP 27 S RANGE 05 W SEC. 19 PLSS # 100372

Date: 11/14/2014 By: JC

This survey consists of:

DOUGLAS COUNTY OREGON

DATE Nov. 7, 2013

Map: \_\_\_\_\_

Narrative: \_\_\_\_\_

Corner Rpt: CS 67/40-20

Corner Designation

DOUGLAS COUNTY  
SURVEYOR

MC  
524 | 519

- \_\_\_\_\_ Condition Report
- \_\_\_\_\_ Not Found
- \_\_\_\_\_ Renewed
- \_\_\_\_\_ Unrecorded
- \_\_\_\_\_ Surveyed In
- \_\_\_\_\_ Referenced Out

Previous Renewals 1936, 1966, 1987, 2006, 2011  
Monument(s) Found: \_\_\_\_\_ (Condition and Source)

MONUMENT DETAIL

BRASS CAP / IRON PIPE MONUMENT AS DESCRIBED IN 1966 RENEWAL AND NOTED AS FOUND IN THE 1987 AND 2011 RENEWALS IS NOW WASHED OUT OF POSITION BY FLOODING. MONUMENT IS BURIED UNDER 2 FT. OF SILT, 10+ FEET NE FROM CORNER POSITION.

N/A

THE METAL WITNESS POST AND SIGN IS ALSO WASHED FROM ITS 2011 POSITION AND IS NOW BURIED UNDER SILT A FEW FEET FARTHER DOWN-STREAM FROM THE FOUND B.C. (SEE ABOVE).

Accessories Found

TWO 2011 BEARING TREES ARE WASHED OUT OF POSITION BY FLOODING AND TWO REMAIN STANDING.  
THE NW'LY 10" LOCUST AND NE'LY 15" LOCUST ARE FALLEN AND WASHED SEVERAL FEET DOWN-STREAM; THEIR ROOT-CROWN POSITIONS ARE BOTH ENTIRELY WASHED AWAY AND CAN NOT BE DETERMINED.  
THE NE 13" DBH MAPLE AND NW 14" DBH LOCUST ARE FOUND AS DESCRIBED.

MONUMENT POSITION IS IN UNSTABLE GROUND AND IS SUBJECT TO FUTURE FLOODING. MONUMENT COULD BE SET IN FUTURE IF EROSION UNCOVERS BEDROCK.

N/A

New Accessories

USING THE TWO FOUND B.T.'S A POSITION IS DETERMINED THAT WOULD BE 50 FEET NORTH FROM THE MEANDER CORNER LOCATION. THIS POSITION IS S 63°14' W, 17 1/2 FEET FROM THE 13" MAPLE B.T. AND N 88°14' E, 32 1/2 FEET FROM THE 14" LOCUST B.T. MEASURING A DISTANCE-DISTANCE INTERSECT FROM THE TWO FOUND B.T.'S THE POINT 50 FEET NORTH FROM THE MEANDER CORNER IS ESTABLISHED AND AT THIS POINT IS SET A 5/8 INCH X 5 FOOT LONG IRON ROD PROTRUDING 6 INCHES ABOVE GROUND.

A METAL WITNESS POST AND SIGN IS SET 1 FOOT SOUTH FROM THE SET 5/8 INCH IRON ROD.

Sketch of Monument, Accessories, and General Area

Location & Comments

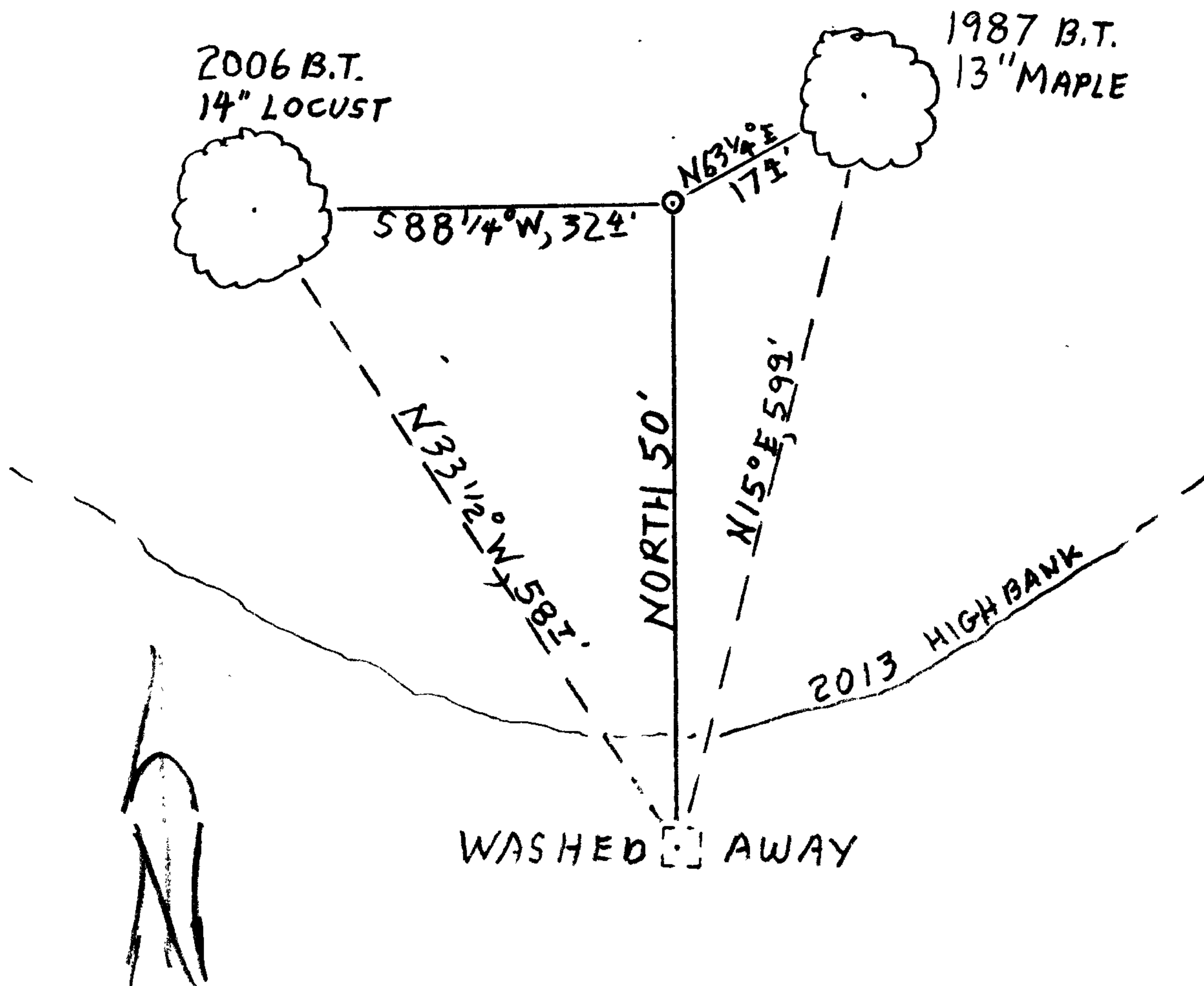

CORNER IS ON SOUTH END OF ELK ISLAND. EROSION CONTINUES.

Comp. Decline. 15 1/2° E  
Agency N.G.S.O.  
Party Chief STEPHEN JOHN FLAUSE  
Note keeper Stephen John Flause  
Witnesses MIKE S. KOCH

Surveyor's Seal

REGISTERED PROFESSIONAL LAND SURVEYOR

*Randall W. Smith*

OREGON JULY 25, 1990 RANDALL W. SMITH 2488

Renewal 6-30-2014