

GOVERNMENT CORNER RESTORATION FORM

FILED

TOWNSHIP 23 S RANGE 04 W SEC. 31 PLSS # 140100

Date: 11/14/2013 By: X
This survey consists of:

DOUGLAS COUNTY OREGON

DATE OCT. 22, 2013

Map: _____

Narrative: _____

Corner Rpt: CS 67/40-19

Corner Designation

DOUGLAS COUNTY
SURVEYOR

$\frac{1}{4} \frac{S31}{S6}$

- Condition Report
- Not Found
- Renewed
- Unrecorded
- Surveyed In
- Referenced Out

Previous Renewals 1963
Monument(s) Found: _____ (Condition and Source)

MONUMENT DETAIL

THE 1963 RENEWAL MONUMENT:
A 2 1/2 INCH DIAMETER BRASS CAP (MARKED
AS AT RIGHT) ON A 1 INCH I.D. IRON PIPE IS
FIRMLY SET AND PROTRUDES 14 INCHES
ABOVE GROUND.

COUNTY SURVEYORS OFFICE

T 23 S

$\frac{1}{4} \frac{S31}{S6}$ R
4
W

T 24 S

1963

Accessories Found

POSSIBLE EVIDENCE OF ONE O.B.T., NOTED AS FOUND ROTTEN LOG WITH
SCRIBING IN 1963, NOW A DISTINCT ROOT-HOLE BEARING S 40° E, 55 1/2 FEET
DISTANT (AS PER RECORD). THIS ROOT-HOLE NOW HAS A 12 INCH DIAM. OAK GROWING
FROM IT BUT ALL OF PREVIOUSLY FOUND O.B.T EVIDENCE IS GONE.

TWO 1963 RENEWAL BEARING TREES FOUND:
AN 11" D. FIR NOW A 14 INCH DIAM. 1/2 FOOT TALL VERY ROTTED DOUGLAS FIR
STUMP WITH NO BLAZE OR SCRIBING EVIDENCE REMAINING; BEARS N 31° W, 17 1/2
FEET DISTANT (RECORD N 29° W, 17 1/2 FT.).
A (?) D. FIR NOW A 29 INCH DIAM DOUGLAS FIR WITH A FULLY HEALED DOUBLE BLAZE;
BEARS S 11° W, 22 1/2 FEET DISTANT (AS PER RECORD).

RENEWAL

Monument Set (Procedure and Description)

MONUMENT DETAIL

N/A

N/A

New Accessories

A 9 INCH DIAM. INCENSE CEDAR SCRIBED "1/4 S31CS" "BT" ON A DOUBLE BLAZE;
BEARS N66 3/4°E, 31' FEET DISTANT.

A 9 INCH DIAM. WHITE OAK SCRIBED "1/4 S6CS" "BT" ON A DOUBLE BLAZE;
BEARS S58 1/2°E, 15' FEET DISTANT.

A 12 INCH DIAM. BLACK OAK SCRIBED "1/4 S31CS" "BT" ON A DOUBLE BLAZE;
BEARS N42 1/4°W, 23' FEET DISTANT

Sketch of Monument, Accessories, and General Area

Location & Comments

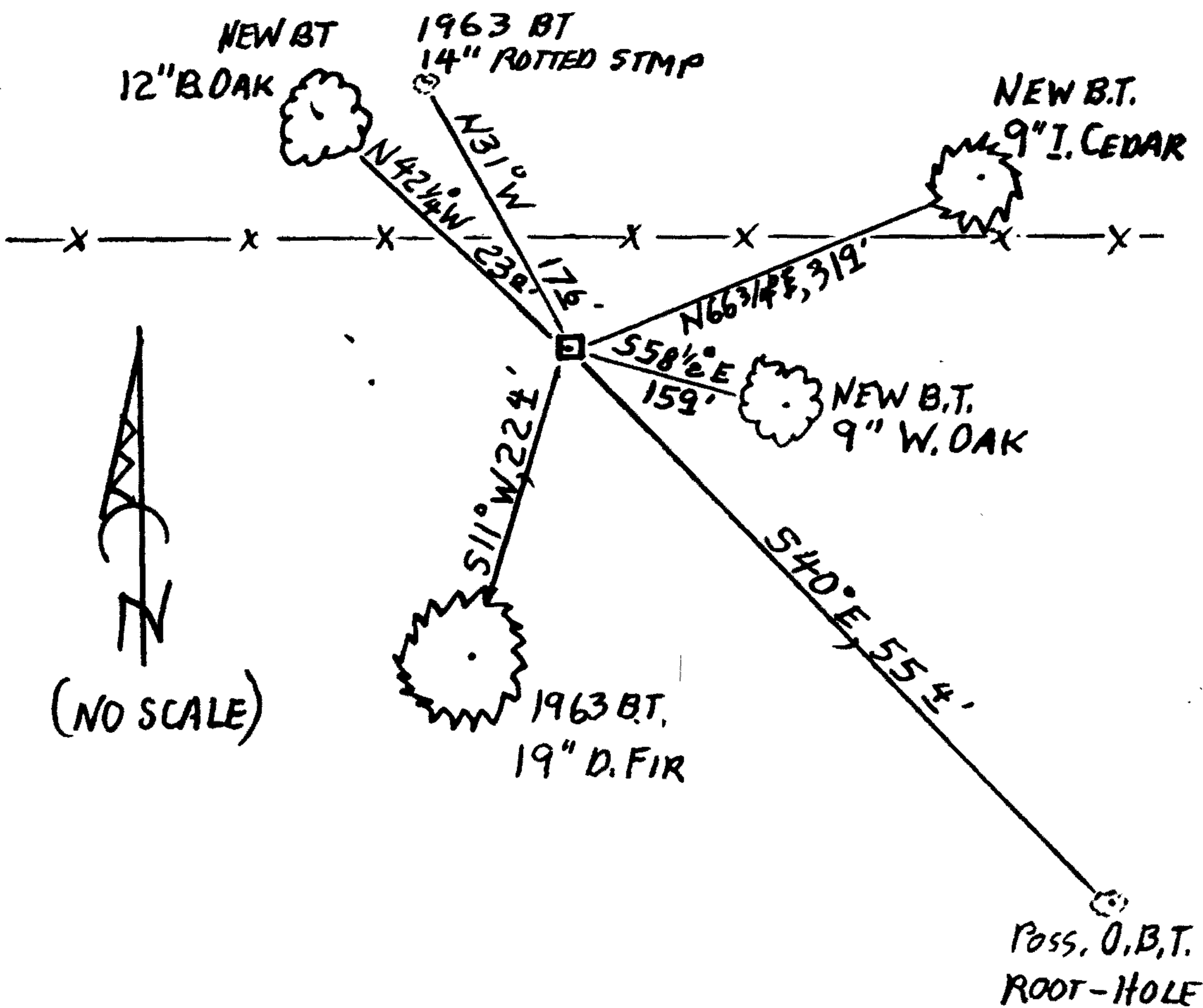

B.C. MONUMENT IS 8 FEET SOUTH OF AN E-W FENCELINE AND APPROX 350 FEET WEST OF ELKHEAD RD (CO. RD. #50). MONUMENT IS ON GENTLE NORTH SLOPE IN MIXED MEDIUM AGED FIR, OAK MAPLE MARRONE AND SOME CEDAR.

Comp. Decline. 15 1/2° E
Agency N.C.S.D.
Party Chief STEPHEN JOHN FLAUSE
Note keeper Stephen John Flause
Witnesses MIKE S. KOCH

Surveyor's Seal

REGISTERED PROFESSIONAL LAND SURVEYOR

OREGON
JULY 25, 1900
RANDALL W. SMITH
2400

RENEWAL 6-30-2014