

GOVERNMENT CORNER RESTORATION FORM

FILED

TOWNSHIP 24S RANGE 05W SEC. 11 PLSS # 600540

Date: 11/12/2013 By: X

This survey consists of:

DOUGLAS COUNTY OREGON

DATE Nov. 4, 2013

Map: \_\_\_\_\_

Narrative: \_\_\_\_\_

Corner Rpt: CSC 67/40-18

Corner Designation

DOUGLAS COUNTY  
SURVEYOR

1/4  
511 | 512

Previous Renewals 1975 RESURVEY  
Monument(s) Found: (Condition and Source)

- Condition Report
- Not Found
- Renewed
- Unrecorded
- Surveyed In
- Referenced Out

MONUMENT DETAIL

FROM THE 1975 RESURVEY A 3/4 INCH I.D.  
IRON PIPE IS FIRMLY SET PROTRUDING 4 INCHES  
ABOVE GROUND ON EAST EDGE OF A ROUND WOODEN  
CORNER POST OF A NEW WIRE FENCE RUNNING  
SOUTH AND WEST.

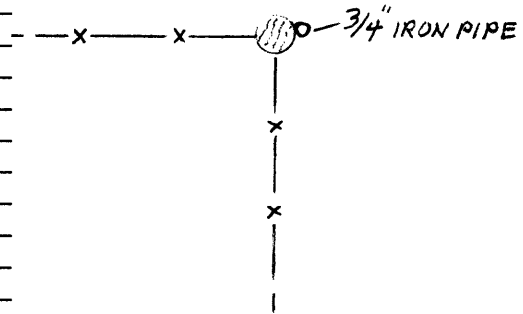

Accessories Found

A LARGE, VERY OLD ROOT-HOLE IS FOUND NEAR POSITION OF SOUTHEAST O.B.T BUT  
THERE IS NO OTHER CORROBORATING EVIDENCE.

TWO 1975 BEARING TREES.  
A 10\"/>

N/A

N/A

New Accessories

AN 11 INCH DIAM. DOUGLAS FIR SCRIBED "1/4 S12CS" "BT" ON A DOUBLE BLAZE; BEARS 569 1/2° E, 25° FEET DISTANT.

A 12 INCH DIAM. DOUGLAS FIR SCRIBED "1/4 S11" "CS BT" ON A DOUBLE BLAZE; BEARS 519 1/2° W, 30 1/2 FEET DISTANT.

Sketch of Monument, Accessories, and General Area

Location & Comments

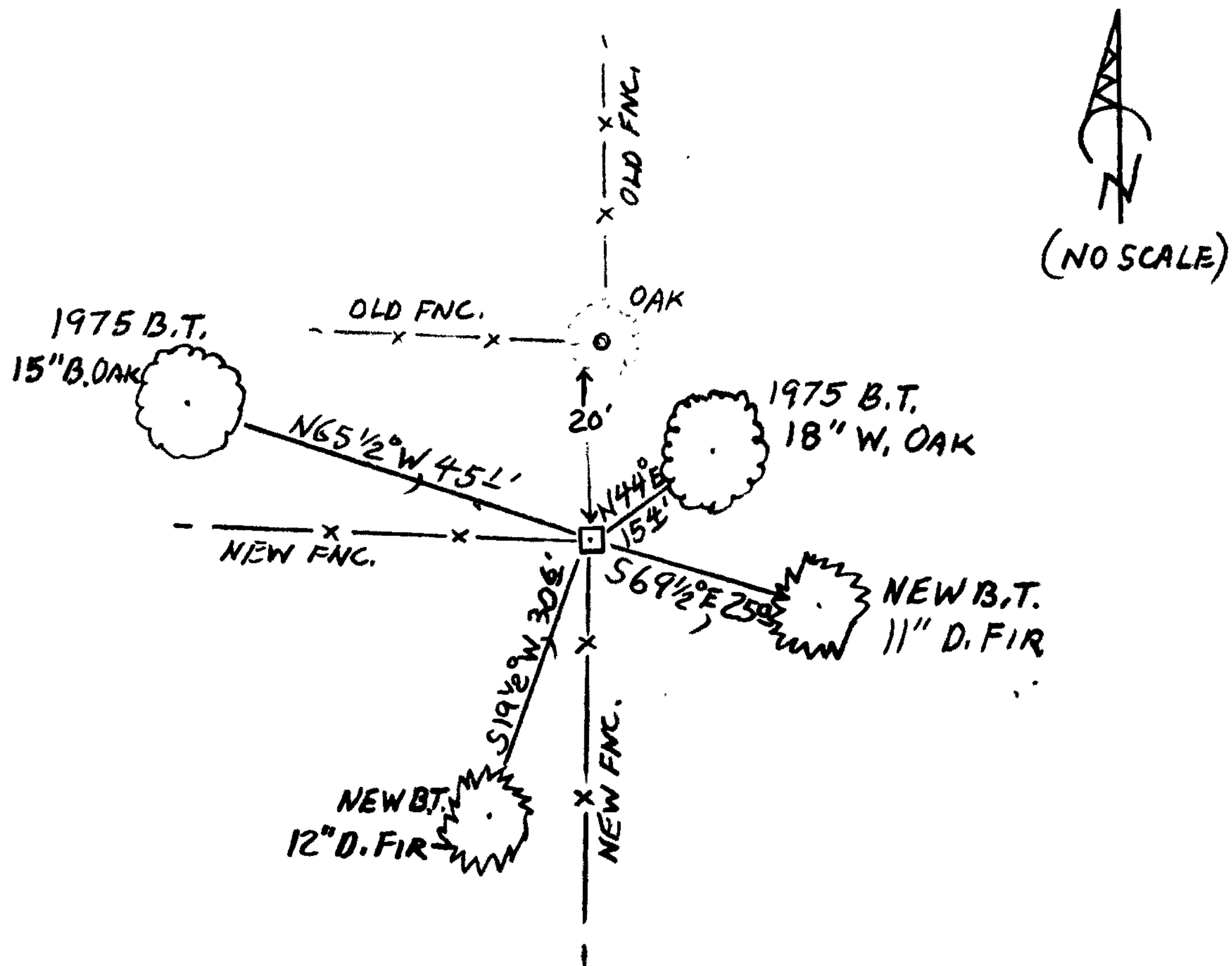

IRON PIPE MONUMENT IS ON A GENTLE EAST SLOPE IN AN OPEN YOUNG FOREST OF MIXED AGE FIR, OAK AND MARRONE.

Comp. Decline. 15 1/2° E  
Agency D.C.S.O.  
Party Chief STEPHEN JOHN FLAUSE  
Note keeper Stephen John Flause  
Witnesses MIKE S. KOCH

Surveyor's Seal

REGISTERED PROFESSIONAL LAND SURVEYOR

*Randall W. Smith*

OREGON  
JULY 25, 1990  
RANDALL W. SMITH  
2400

6-30-2014