

GOVERNMENT CORNER RESTORATION FORM

FILED

TOWNSHIP 21S RANGE 04W SEC. 18 PLSS # 140440

Date: 10/30/2013 By: DC  
This survey consists of:

DOUGLAS COUNTY OREGON

DATE OCTOBER 01, 2013

Map: \_\_\_\_\_

Narrative: \_\_\_\_\_

Corner Designation

Corner Rpt: CS 67/40-13

DOUGLAS COUNTY  
SURVEYOR

C<sup>1/4</sup> + S18

Previous Renewals ORIG. SET 1986  
Monument(s) Found: \_\_\_\_\_ (Condition and Source)

- \_\_\_\_\_ Condition Report
- \_\_\_\_\_ Not Found
- Renewed
- \_\_\_\_\_ Unrecorded
- \_\_\_\_\_ Surveyed In
- \_\_\_\_\_ Referenced Out

MONUMENT DETAIL

THE ORIGINAL MONUMENT A 1" X 36" IRON PIPE (ETC.)  
NOW A 1 INCH I.D. IRON PIPE WITH A YELLOW PLASTIC  
CAP (MARKED AS AT RIGHT) DRIVEN INTO ITS TOP IS  
FIRMLY SET PROTRUDING 8 INCHES ABOVE GROUND.

GUILE  
PLS 472

Accessories Found

ONE O.B.T.  
A 28" FIR NOW A 30 INCH DIAMETER, 3 FOOT TALL DOUGLAS FIR STUMP WITH A FULLY HEAL-  
ED DOUBLE BLAZE (NOTED "W" NAIL NOT FOUND); BEARS N 54 3/4° E, 48 2 FEET DISTANT (BEAR-  
ING AGREES WITH RECORD, ORIGINAL DISTANCE MAY HAVE BEEN TO "W" NAIL).

NO EVIDENCE OF SE ORIGINAL B.T.

N/A

N/A

New Accessories

A 15 INCH DIAMETER MADRONE SCRIBED "C 1/4 S18 CS" "BT" ON A DOUBLE BLAZE; BEARS N41°E, 36 3/4 FEET DISTANT.

A 9 INCH DIAM. DOUGLAS FIR SCRIBED "C 1/4 S18" "CSBT" ON A DOUBLE BLAZE; BEARS S43 1/2°E, 15 1/2 FEET DISTANT.

A 9 INCH DIAM. DOUGLAS FIR SCRIBED "C 1/4 S18 CS" "BT" ON A DOUBLE BLAZE; BEARS S63 1/2°W, 9 1/2 FEET DISTANT.

A 5 INCH DIAM DOUGLAS FIR SCRIBED "X" "CSBT" ON A HIGH-LOW BLAZE; BEARS N02 3/4°W, 18 1/2 FEET DISTANT.

Sketch of Monument, Accessories, and General Area

Location & Comments

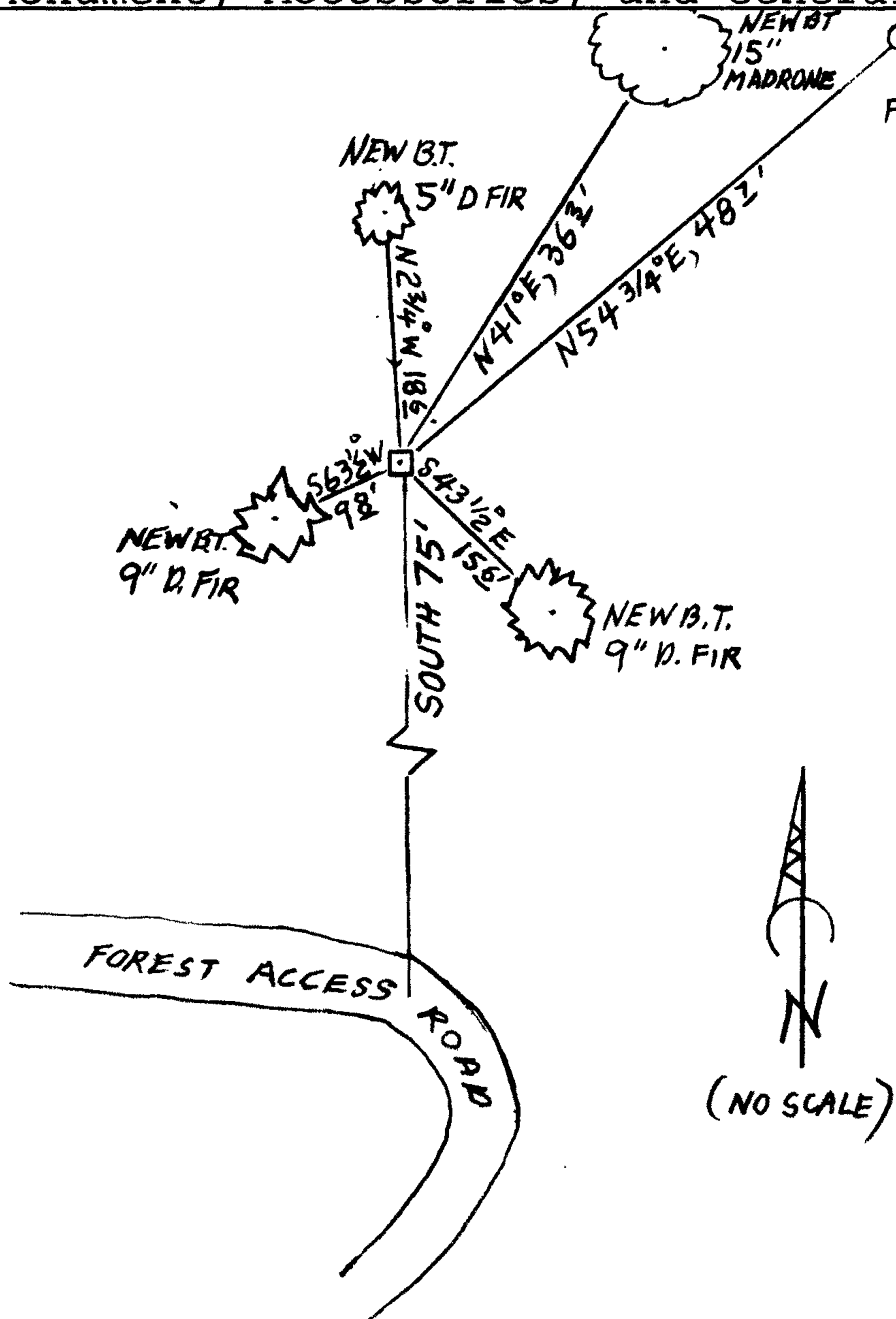

MONUMENT IS ON GENTLE SOUTH-EAST SLOPE IN FOREST OF OLDER REPROD. FIR WITH SOME MAPLE AND MADRONE.

Comp. Decline. 15 1/2°E

Agency P.C.S.O.

Party Chief STEPHEN JOHN FLAUSE

Note keeper Stephen John Flause

Witnesses MIKE S. KOCH

Surveyor's Seal

REGISTERED PROFESSIONAL LAND SURVEYOR

*Randall W. Smith*

OREGON JULY 25, 1990 RANDALL W. SMITH 2468