

GOVERNMENT CORNER RESTORATION FORM

FILED

TOWNSHIP 30S RANGE 05W SEC. 18 PLSS # 100440

Date: 10/16/2013 By: X
This survey consists of:

DOUGLAS COUNTY OREGON

DATE SEPT. 19, 2013

Map: _____

Corner Designation

Narrative: _____
Corner Rpt: CS 67/40-10

DOUGLAS COUNTY
SURVEYOR

R6W R5W

| 1/4 S18
ONLY

- _____ Condition Report
- _____ Not Found
- Renewed
- _____ Unrecorded
- _____ Surveyed In
- _____ Referenced Out

Previous Renewals 1923, 1946, 1948
Monument(s) Found: _____ (Condition and Source)

MONUMENT DETAIL

1948 CORNER MONUMENT
A 1 INCH DIAMETER AXLE SHAFT (PREVIOUSLY
DESCRIBED AS 5/8") SET PLUMB AND PROTRUDING
5 INCHES ABOVE GROUND.

N/A

Accessories Found

NO EVIDENCE REMAINS FROM ORIGINAL BEARING TREES.

TWO 1946 RENEWAL BEARING TREES.
A 6" W. OAK NOW A 10 INCH DIAM. WHITE OAK WITH A FULLY HEALED DOUBLE BLAZE (WE OPEN
AND FIND SCRIBED "1/4") FALLEN AND OUT OF POSITION BUT WITH A ROOT-HOLE
BEARING S87°46'W, 9 1/2 FEET DISTANT (AS PER RECORD).

A 6" W. OAK NOW A 12 INCH DIAM. WHITE OAK WITH A FULLY HEALED DOUBLE BLAZE; BEARS
S35°43'E, 14 1/2 FEET DISTANT (AS PER RECORD).

Monument Set (Procedure and Description)

MONUMENT DETAIL

N/A

N/A

New Accessories

3 NEW REFERENCES:

A WHITE OAK 17 INCH DIAM. WITH A FULLY HEALED SINGLE BLAZE FACING SW TO THE SE CORNER OF DLC 52 (THIS TREE IS SCRIBED IN REFERENCE TO DLC 52); BEARS S50°12'E, 30³ FEET DISTANT.

A 3/4 INCH I.D. IRON PIPE PROTRUDING 3 INCHES ABOVE GROUND, WHICH IS THE MONUMENT FOR THE SE CORNER OF D.L.C. 52; BEARS S0°14'E, 54⁹ FEET DISTANT.

A 14 INCH DIAM. BLACK OAK SCRIBED "1/4 S18CS" "BT" ON A DOUBLE BLAZE; BEARS S39°12'W, 29¹ FEET DISTANT.

Sketch of Monument, Accessories, and General Area

Location & Comments

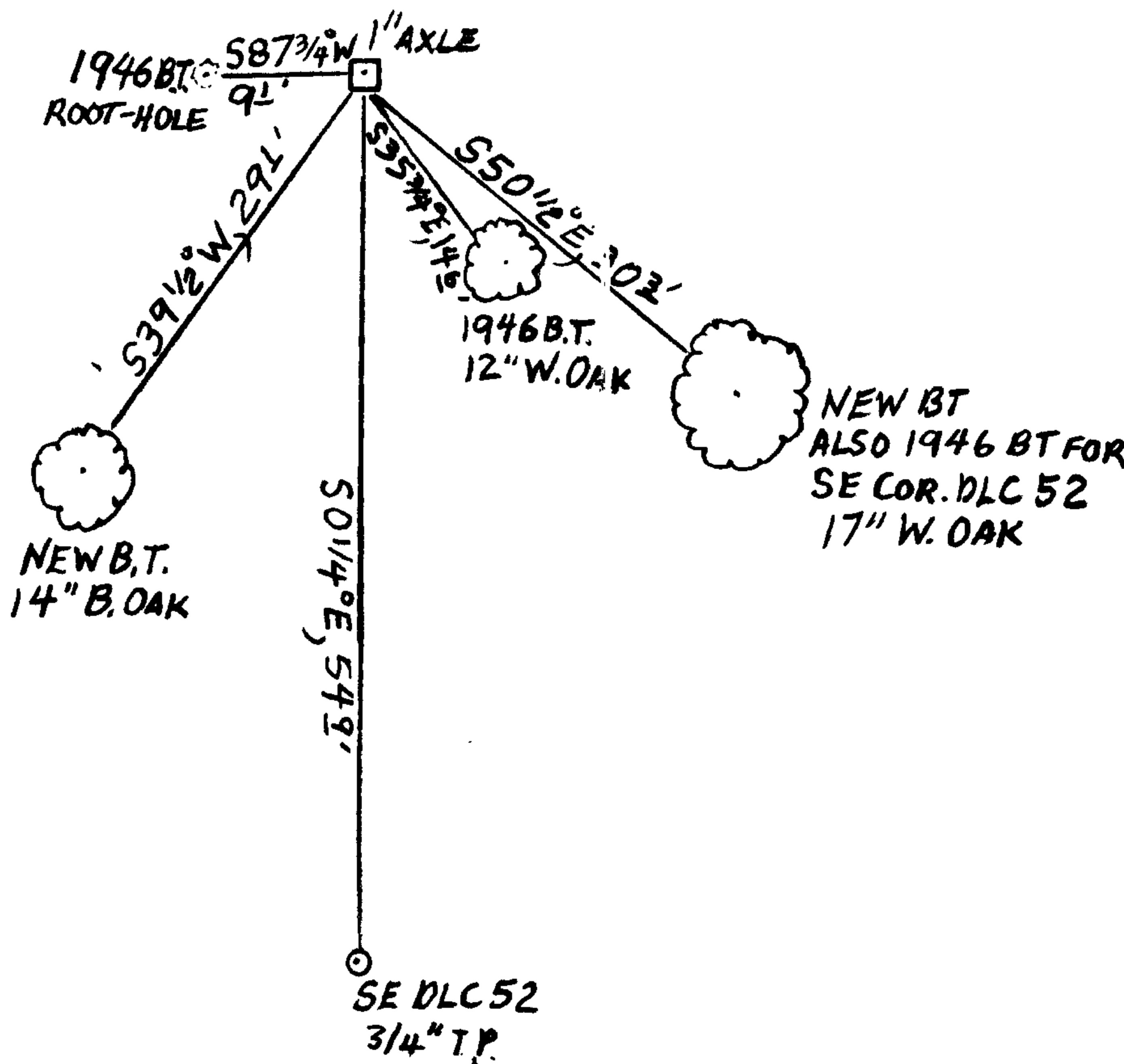
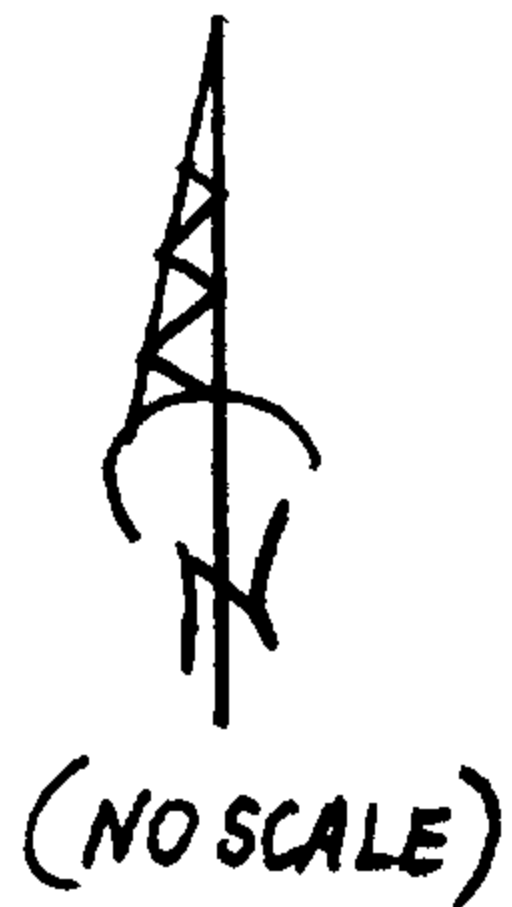

MONUMENT IS NEAR BOTTOM AND ON NORTH SIDE OF SMALL DRY NW RUNNING DRAW. DRAW IS ON MODERATE WEST SLOPE IN OPEN OAK AND MADRONE WOODLAND.

Comp. Decline. 15°12'E
Agency D.C.S.O.
Party Chief STEPHEN JOHN FLAUSE
Note keeper Stephen John Flause
Witnesses MIKE S. KOCH

Surveyor's Seal

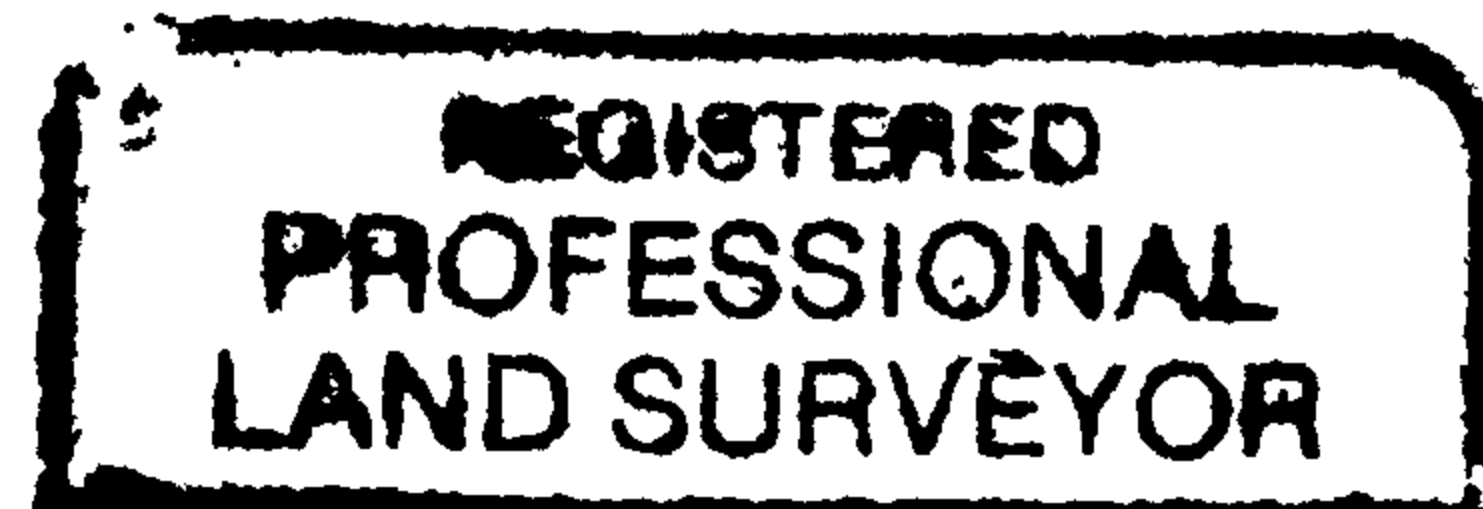

Renewed U first Renewal 6-30-2014

