

GOVERNMENT CORNER RESTORATION FORM

FILED

TOWNSHIP 30S RANGE 06W SEC. 13 PLSS # 052040

Date: 10-16-2013 By: JC

This survey consists of:

DOUGLAS COUNTY OREGON

DATE SEPT. 19, 2013

Map: \_\_\_\_\_

Narrative: \_\_\_\_\_

Corner Rpt: CS67/40-9

Corner Designation

DOUGLAS COUNTY  
SURVEYOR

SE  
DLC 52

- Condition Report
- Not Found
- Renewed
- Unrecorded
- Surveyed In
- Referenced Out

Previous Renewals 1946  
Monument(s) Found: \_\_\_\_\_ (Condition and Source)

MONUMENT DETAIL

THE 1946 DLC CORNER MONUMENT.

A 1/4" IRON PIPE (SIZE PROBABLY A TYPING ERROR)  
NOW A 3/4 INCH I.D. IRON PIPE SET PLUMB AND  
PROTRUDING 3 INCHES ABOVE GROUND

N/A

MONUMENT IS IN A N-S FENCE LINE 15 FEET SOUTH  
OF A FENCE CORNER WITH FENCES RUNNING SOUTH  
AND WEST (REMNANTS OF A FALLEN FENCE RUN EAST).

Accessories Found

NO EVIDENCE REMAINING FROM O.B.T.S.

TWO 1946 BEARING TREES:  
A 10" W. OAK NOW A 17 INCH DIAM. WHITE OAK WITH A FULLY HEALED SINGLE BLAZE; BEARS N33 1/4° E,  
42 2/3 FEET DISTANT (AS PER RECORD).  
AN 8" B. OAK NOW AN 11 INCH DIAM. BLACK OAK WITH A FULLY HEALED SINGLE BLAZE; BEARS S36 1/4° E,  
81 1/2 FEET DISTANT (AS PER RECORD).

N/A

N/A

New Accessories

THREE NEW REFERENCES:

A 12 INCH DIAM. WHITE OAK WITH A FULLY HEALED DOUBLE BLAZE FACING NW TO THE WEST 1/4 CORNER OF T30S, R5W, S18 (THIS TREE IS SCRIBED IN REFERENCE TO SECTION 18); BEARS N11°E, 43 1/2 FEET DISTANT

A 1/4 INCH DIAM. BLACK OAK WITH A NEW DOUBLE BLAZE FACING NE TO THE WEST 1/4 CORNER OF T30S, R5W, S18 (THIS TREE IS SCRIBED IN REFERENCE TO SECTION 18); BEARS N30°W, 37 1/2 FEET DISTANT

A 1 INCH DIAM. AXLE PROTRUDING 5 INCHES ABOVE GROUND, WHICH IS THE MONUMENT FOR THE WEST 1/4 CORNER OF T30S, R5W, SECTION 18; BEARS N0°4'W, 54 1/2 FEET DISTANT.

Sketch of Monument, Accessories, and General Area

Location & Comments

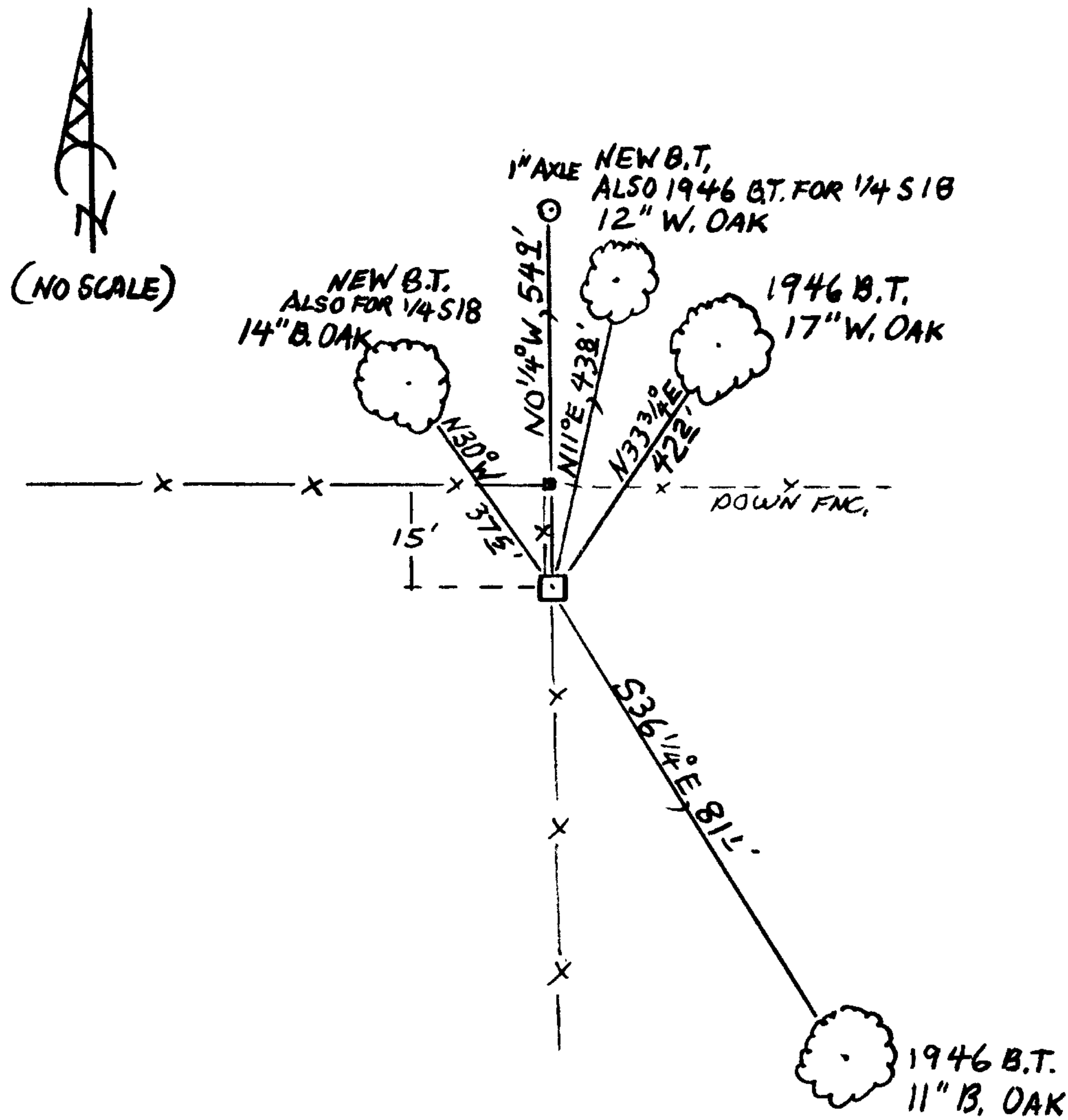

MONUMENT IS ON THE SOUTH SIDE OF, AND JUST OUT OF A SMALL, DRY, NW RUNNING DRAW. DRAW IS ON MODERATE WEST SLOPE IN OPEN OAK AND MARRONE WOODLAND.

Comp. Decline. 15 1/2°E  
Agency P.C.S.O.  
Party Chief STEPHEN JOHN FLAUSE  
Note keeper Stephen John Flause  
Witnesses MIKE S. KOCH

Surveyor's Seal

REGISTERED PROFESSIONAL LAND SURVEYOR

*Randall W. Smith*

OREGON  
JULY 25, 1990  
RANDALL W. SMITH  
2488

Renewed 6-30-2014