

GOVERNMENT CORNER RESTORATION FORM

TOWNSHIP 30 S RANGE 06 W SEC. 34 PLSS # 040010

DOUGLAS COUNTY OREGON

DATE SEPT. 12, 2013

FILED

Date: 9/23/2013 By: X

This survey consists of:

Map: _____

Narrative: _____

Corner Rpt: CS 67/40-5

Corner Designation

DOUGLAS COUNTY SURVEYOR

DLC
40

Previous Renewals 1919, 1964
Monument(s) Found: (Condition and Source)

- ___ Condition Report
- ___ Not Found
- Renewed
- ___ Unrecorded
- ___ Surveyed In
- ___ Referenced Out

DUE TO JUMBLED MOUND OF BROKEN CONCRETE AT BASE OF FOUND B.C. MONUMENT WE DO NOT SEARCH FOR THE 1919 STONE MONUMENT.

MONUMENT DETAIL

FROM THE 1964 RENEWAL A 2 1/2 INCH DIAM. BRASS CAP (MARKED AS AT RIGHT) ON A 1 INCH I.D. IRON PIPE IS FIRMLY SET LEANING WEST'LY 0 3 FEET AND PROTRUDING 12 INCHES ABOVE A ROUGH MOUND OF BROKEN CONCRETE.

COUNTY SURVEYORS OFFICE
T30S R6W

A 1 1/2 INCH I.D. IRON PIPE (POSSIBLY THE 1964 DESCRIBED ~~1 1/4" I.D.~~) IS 0 3 FEET SOUTH OF THE FOUND B.C. AND PROTRUDE 23 INCHES ABOVE THE DESCRIBED CONC. MOUND.

N.E.
D.L.C.
40
1964

Accessories Found

NO EVIDENCE OF O.B.T.'S.

NO EVIDENCE OF 1919 BEARING TREE.

EVIDENCE OF THE TWO 1964 RENEWAL B.T.'S.

A 16" TRIPLE CEDAR NOW A DEAD, BUT INTACT AND STANDING, TRIPLE TRUNK INCENSE CEDAR WITH A FULLY HEALED SINGLE BLAZE ON A NOW 19 INCH DIAM. TRUNK; BEARS S 21 1/2° E, 52° FEET DISTANT (THIS AGREES WITH 1964 DATED TAG FOUND ON TREE).

A 30" MAPLE NOW A 39 INCH DIAM. MAPLE NO LONGER SHOWING BLAZE EVIDENCE; BEARS N 70 1/2° W, 56 1/2 FEET DISTANT (RECORD N 73° W, 56 1/2 FT.).

N/A

FOUND MONUMENT AND MOUND OF CONCRETE ARE NOW INSIDE OF A HEAVY IRON RING WHICH 2 INCHES THICK, 24 INCHES TALL AND 40 INCHES IN DIAMETER

THE TOP OF THE FOUND B.C. MONUMENT IS APPROX. 0.5 FEET SOUTH FROM THE CENTER OF THE FOUND IRON RING AND 7 INCHES BELOW ITS TOP RIM.

New Accessories

TWO NEW BEARING TREES
A DOUBLE TRUNK MAPLE SCRIBED ON THE LARGER 14 INCH TRUNK "NE DL C 40 CS" "BT" ON A DOUBLE BLAZE; BEARS N43 1/2° E, 173 1/2 FEET DISTANT.
A 7 INCH DIAM. OSO BERRY SCRIBED "BT" ON A SMALL SINGLE BLAZE (CENTER 1 FOOT ABOVE GROUND); BEARS S 5 1/2° E, 57 1/2 FEET DISTANT.

Sketch of Monument, Accessories, and General Area

Location & Comments

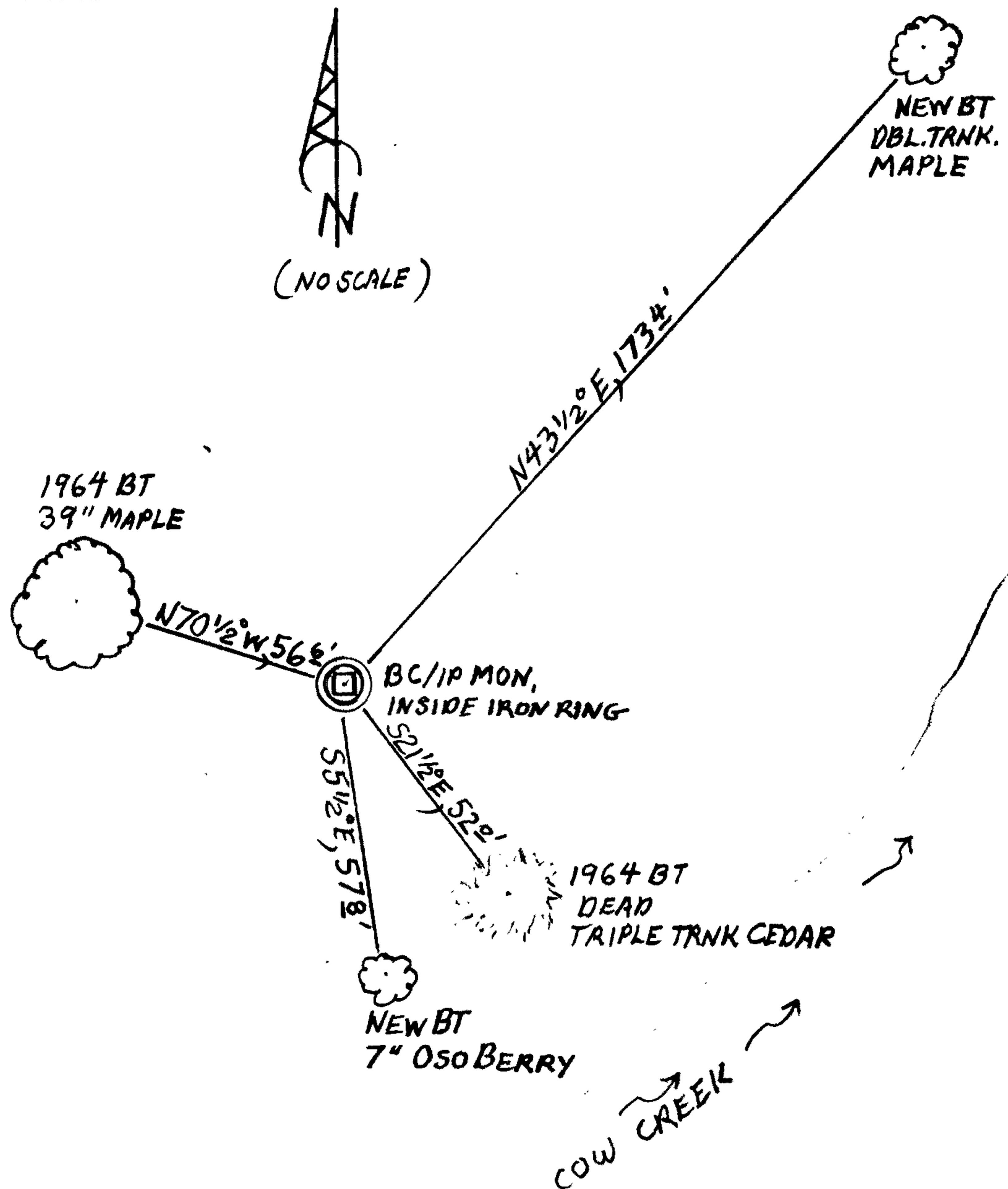

MONUMENT ON FLAT TOP OF LEVEL LIKE BANK ON THE NORTH SIDE (LEFT BANK) OF COW CREEK.

Comp. Decline. 15 1/2° E
Agency D.C.S.O.
Party Chief STEPHEN JOHN FLAUSE
Note keeper Stephen John Flause
Witnesses MIKE S. KOCH

Surveyor's Seal

REGISTERED PROFESSIONAL LAND SURVEYOR

Randall W. Smith

OREGON
JULY 25, 1990
RANDALL W. SMITH
2468

Renewed 6-30-2014