

GOVERNMENT CORNER RESTORATION FORM

FILED

TOWNSHIP 30 S RANGE 06 W SEC. 22 PLSS # 044040

Date: 9/23/2013 By: [Signature]
This survey consists of:

DOUGLAS COUNTY OREGON

DATE SEPT. 11, 2013

Map: _____

Narrative: _____

Corner Rpt: CS 67/40-4

Corner Designation

DOUGLAS COUNTY
SURVEYOR

- _____ Condition Report
- _____ Not Found
- Renewed
- _____ Unrecorded
- _____ Surveyed In
- _____ Referenced Out

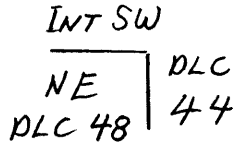

Previous Renewals 1950
Monument(s) Found: _____ (Condition and Source)

EVIDENCE OF MONUMENTS FOUND AND SET
IN THE 1950 RENEWAL. A 1" x 30" IRON PIPE
NOW A 1 INCH I.D. IRON PIPE SET PLUMB AND
PROTRUDING 7 INCHES ABOVE GROUND.
A 1/4" x 1" IRON BAR (OF UNKNOWN ORIGIN) IS
0.2 FEET NORTH FROM IRON PIPE MONUMENT AND
PROTRUDES 4 INCHES ABOVE GROUND.

N/A

MONUMENT DETAIL

Accessories Found

ACCESSORIES MEASURED FROM 1950 IRON PIPE MONUMENT.

EVIDENCE OF THE TWO O.B.T.'s.
A B. OAK 18" DIA. NOW 44 INCH DIAM. BLACK OAK WITH A PREVIOUSLY OPENED,
NOW ALMOST COMPLETELY REVEALED BLAZE (NO SCRIBING VISIBLE); BEARS S 56° W,
46.2 FEET DISTANT (RECORD S 55° W, 46.2 FT.)
A W. OAK 15" DIA. NOW A ROTTEN AND BROKEN OAK STUMP 2.1 INCHES IN DIAM.
AND APPROX. 2 FEET TALL WITH THE REMNANTS OF A PREVIOUSLY OPENED BLAZE SHOW
AXE MARKS AND A PARTIAL SCRIBE MARK; BEARS N 28° W, 38.5 FEET DISTANT (RECORD
N 32° W, 37.5 FEET (DIST. COULD BE 18.55 FACE MEASUREMENT)).

EVIDENCE OF THE 1950 RENEWAL B.T.
A 14" B. OAK NOW A DOUBLE TRUNK BLACK OAK (TWO TREES HAVE SINCE MADE ONE
NEW ROOTCROWN) THE 1950 SCRIBED TRUNK OF WHICH IS NOW 24 INCHES IN DIAM,
AND SHOWS A FULLY HEALED DOUBLE BLAZE. THE BASE OF THE SCRIBED TRUNK
BEARS N 2° E, 18° FEET DISTANT (AS PER RECORD) AND THE C.R.C. OF THE NOW DOUBLE
TRUNK BEARS N 5 1/2° E, 18° FEET DISTANT.

C.S. File 67/40-4

N/A

N/A

New Accessories

A TRIPLE TRUNK MADRONE SCRIBED ON THE 16 INCH DIAM. (LARGEST) TRUNK "INT SW DLC 44" "CSBT" ON A DOUBLE BLAZE; BEARS N80°14'E, 58³ FEET DISTANT.

AN 11 INCH DIAM. WHITE OAK SCRIBED "INT SW DLC 44 CS" "BT" ON A DOUBLE BLAZE; BEARS S25°12'E, 53⁵ FEET DISTANT.

Sketch of Monument, Accessories, and General Area

Location & Comments

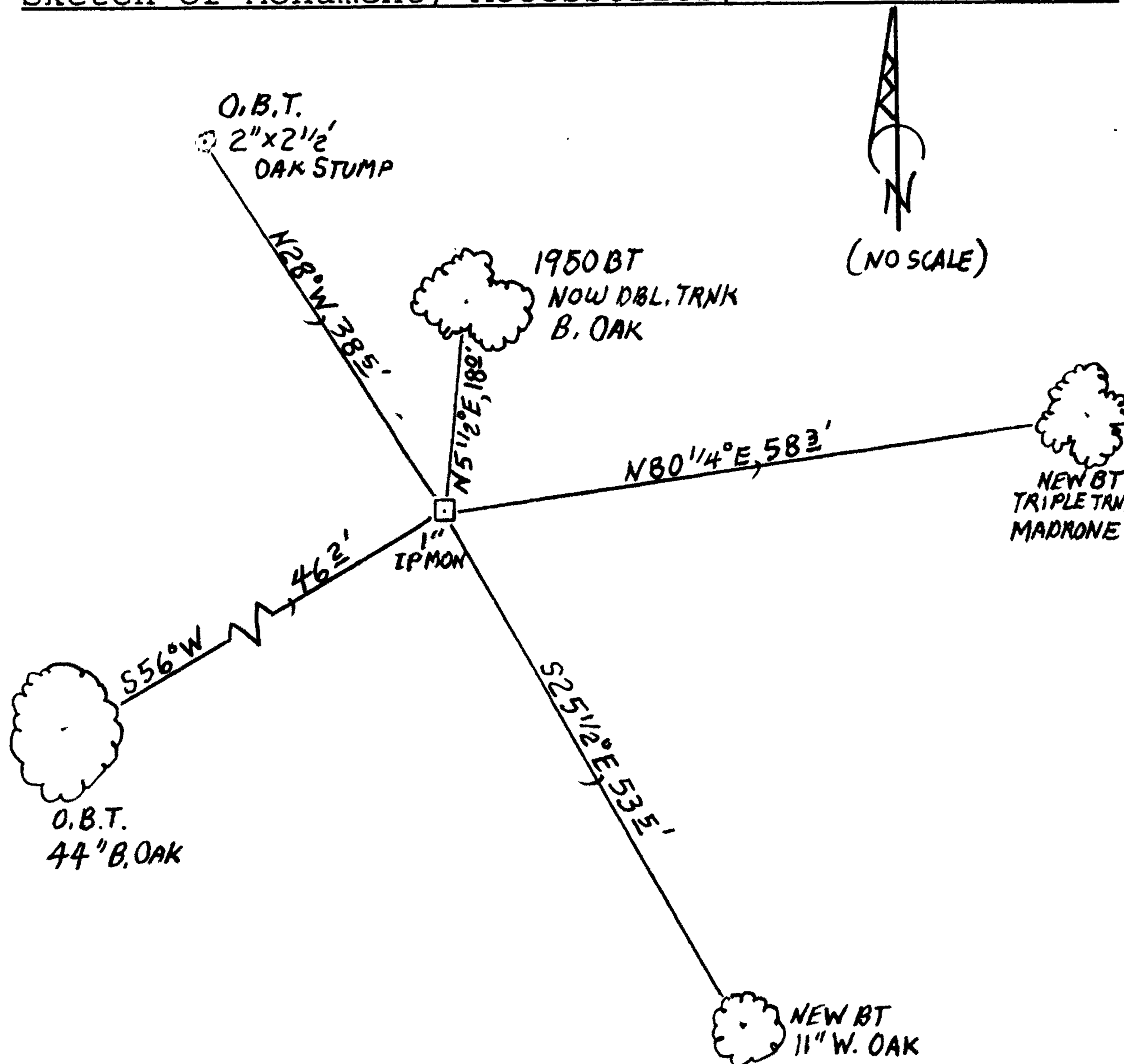

MONUMENT IS ON A MODERATELY STEEP SOUTHEAST SLOPE OF A TALL KNOB HILL. MONUMENT IS APPROX 75 FEET SOUTH OF THE KNOB SUMMIT IN AN OPEN OAK WOODLAND.

Comp. Decline. 15°12' E
 Agency DCSO
 Party Chief STEPHEN JOHN FRAUSE
 Note keeper Stephen John Frause
 Witnesses MIKE S. KOCH

Surveyor's Seal

REGISTERED
 PROFESSIONAL
 LAND SURVEYOR

Randall W. Smith

OREGON
 JULY 25, 1990
 RANDALL W. SMITH
 2488

RENEWAL 6-30-2014