

GOVERNMENT CORNER RESTORATION FORM

FILED

TOWNSHIP 25 S RANGE 06 W SEC. 5 PLSS # 240600

Date: 9/23/2013 By: X

This survey consists of:

DOUGLAS COUNTY OREGON

DATE SEPT. 10, 2013

Map: _____

Narrative: _____

Corner Rpt: CS 67/40-3

Corner Designation

DOUGLAS COUNTY SURVEYOR

1/4 $\frac{S5}{S8}$

Previous Renewals 1909, 1962
Monument(s) Found: _____ (Condition and Source)

- _____ Condition Report
- _____ Not Found
- Renewed
- _____ Unrecorded
- _____ Surveyed In
- _____ Referenced Out

MONUMENT DETAIL

A SANDSTONE FIRST FOUND IN 1909, AND DESCRIBED IN 1962 AS A 14"x14"x5" SAND-STONE ROCK, IS NOW AN UNMARKED SAND-STONE SHOWING A 3x5 INCH TOP FLUSH WITH GROUND AND SET 0 3/4 FEET SOUTH FROM THE 1962 CORNER MONUMENT.

COUNTY SURVEYORS OFFICE

T. 25 S.

S. 5

S. 8

R. 6 W.

1962

FROM THE 1962 RENEWAL A 2 1/2 INCH DIAM. BRASS CAP (MARKED AS AT RIGHT) ON A 1 INCH I.D. IRON PIPE SET PLUMB PROTRUDING 10 INCHES ABOVE GROUND. (1/4 DESIGNATION MISSING FROM STAMPING).

Accessories Found

NO EVIDENCE OF ORIGINAL BEARING TREES.

TWO 1962 RENEWAL BEARING TREES.

A 15" W. OAK NOW AN 18 INCH DIAM. WHITE OAK WITH A FULLY HEALED DOUBLE BLAZE; BEARS N 24 3/4° E, 46 3/8 FEET DISTANT (RECORD N 28° E, 46 3/8 FT.)

A 6" W. OAK NOW A 9 INCH DIAM WHITE OAK WITH A FULLY HEALED DOUBLE BLAZE; BEARS S 66 1/2° W, 114 3/8 FEET DISTANT (RECORD S 67 1/2° W, 114 3/8 FT.).

Monument Set (Procedure and Description)

MONUMENT DETAIL

N/A

N/A

New Accessories

A 10 INCH DIAM. WHITE OAK SCRIBED "X" "CSBT" ON A HIGH AND LOW BLAZE; BEARS S50 3/4° W, 51 2 FEET DISTANT.

A 12 INCH DIAM. BLACK OAK SCRIBED "CSBT" ON A SINGLE LOW BLAZE (REST OF TRUNK TO SCARRED TO BLAZE); BEARS N63 1/2° W, 54 5 FEET DISTANT.

Sketch of Monument, Accessories, and General Area

Location & Comments

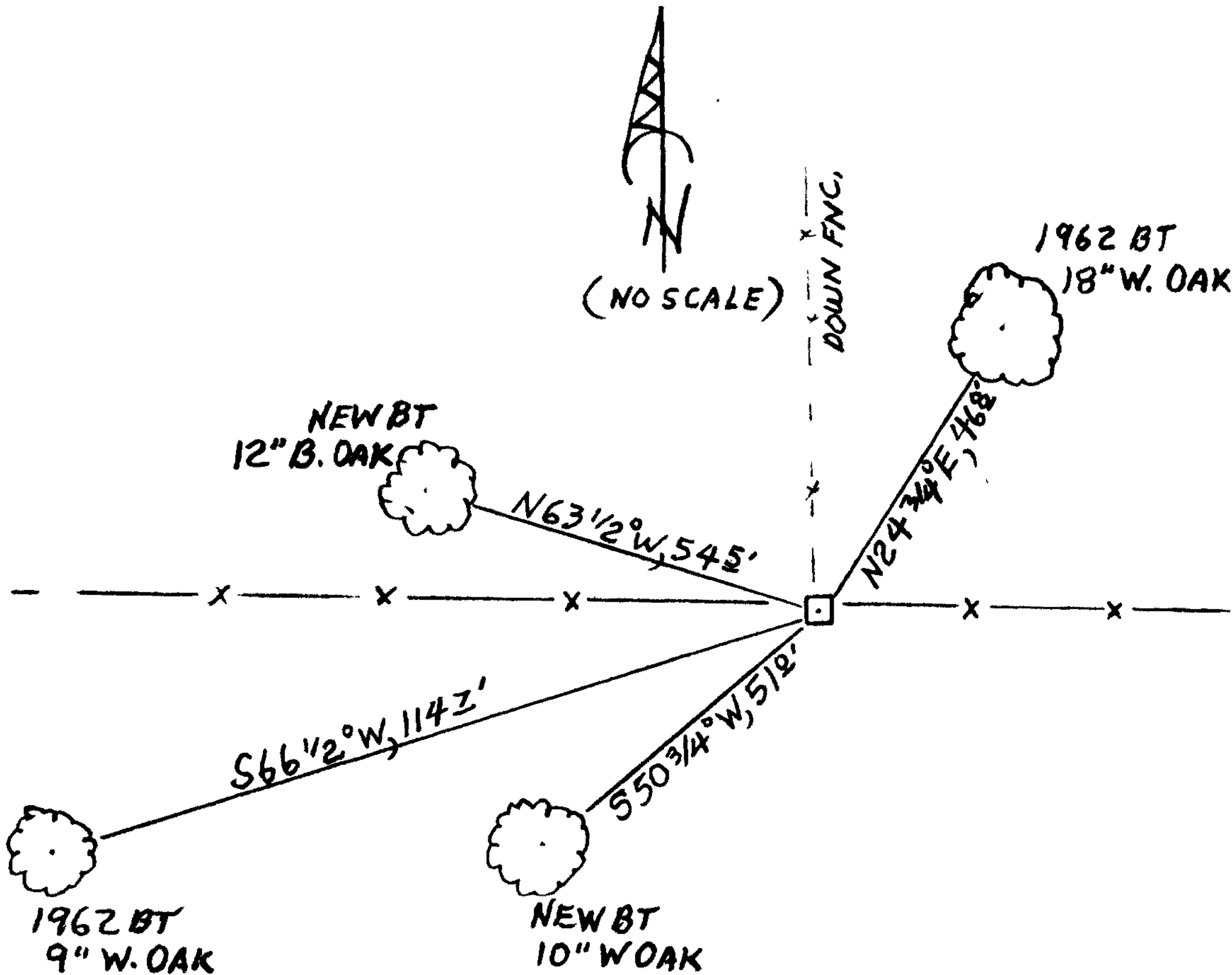

B.C. MONUMENT IS IN A E-W RUNNING WIRE FENCE JUST EAST OF A CORNER POST FOR A NOW DOWN FENCE RUNNING NORTH. THE C OF A N-S RUNNING POWERLINE IS WEST, 9 FEET. MONUMENT IS ON GENTLE SOUTH SLOPE IN OPEN OAK WOODLAND.

Comp. Decline. 15 1/2° E
Agency DCSO
Party Chief STEPHEN JOHN FLAUSE
Note keeper Stephen John Flause
Witnesses MIKE S. KOCH

Surveyor's Seal

REGISTERED PROFESSIONAL LAND SURVEYOR

Randall W. Smith

OREGON
JULY 25, 1990
RANDALL W. SMITH
2488

RENEWAL 6-30-2014