

GOVERNMENT CORNER RESTORATION FORM

FILED

TOWNSHIP 21S RANGE 04W SEC. 18 PLSS # 140400

Date: 9-23-2013 By: JC  
This survey consists of:

DOUGLAS COUNTY OREGON

DATE 8/26/13

Map: \_\_\_\_\_

Corner Designation

Narrative: \_\_\_\_\_  
Corner Rpt: CS 67/40-1

DOUGLAS COUNTY  
SURVEYOR

$\frac{1}{4} \frac{S18}{S19}$

- \_\_\_ Condition Report
- \_\_\_ Not Found
- Renewed
- \_\_\_ Unrecorded
- \_\_\_ Surveyed In
- \_\_\_ Referenced Out

Previous Renewals 1947, 1962  
Monument(s) Found: (Condition and Source)

FROM THE 1962 RENEWAL A 1 INCH I.D. ALUMINUM PIPE, SET PLUMB PROTRUDING 1 FOOT ABOVE GROUND. THE 3/4 INCH IRON PEG (FOUND IN 1962 BUT OF UNKNOWN ORIGIN) IS SET INSIDE OF AND WITH ITS TOP 9 INCHES LOWER THAN, THE ALUMINUM PIPE MONUMENT. N/A

MONUMENT DETAIL

Accessories Found

EVIDENCE OF ONE O.B.T.:  
A FIR 36" DIA. NOW A VERY ROTTEN 48 INCH DIAM. 3 FOOT TALL DOUGLAS FIR STUMP WITH NO FACE OR SCRIBING EVIDENCE FOUND; BEARS N30°E, 23 1/2 FEET DISTANT.

EVIDENCE OF THE TWO 1962 RENEWAL B.T.s.  
AN 11" D. FIR NOW A VERY ROTTEN 20 INCH DIAM. 5 1/2 FOOT TALL DOUGLAS FIR STUMP WITH THE AREA OF THE BLAZE AND SCRIBING NOW ROTTE AWAY; BEARS S 43 3/4° W, 50 5 FEET DISTANT (RECORD S 45° W, 50 5 FT.)  
A 12" D. FIR NOW A 25 INCH DIAM. 5 FOOT TALL DOUGLAS FIR STUMP SHOWING A FULLY HEALED DOUBLE BLAZE (ROTTEN BEHIND BARK, NO FACE OR SCRIBING EVIDENCE SEEN); BEARS N 72° E, 38 1/2 FEET DISTANT (1962 DISTANCE WOULD BE A FACE MEASUREMENT, BEARING AGREES WITH RECORD).

Monument Set (Procedure and Description)

MONUMENT DETAIL

N/A

N/A

New Accessories

A 5 INCH DIAM. DOUGLAS FIR SCRIBED "X" "CSBT" ON A HIGH AND LOW BLAZE; BEARS N23 1/2° E, 4 1/2 FEET DISTANT.

A 7 INCH DIAM. DOUGLAS FIR SCRIBED "1/4 S19 CS" "BT" ON A DOUBLE BLAZE; BEARS S08° E, 8 3/4 FEET DISTANT.

AN 8 INCH DIAM. DOUGLAS FIR SCRIBED "1/4 S19" "CSBT" ON A DOUBLE BLAZE; BEARS S63 1/4° W, 13 1/4 FEET DISTANT.

A 7 INCH DIAM. DOUGLAS FIR SCRIBED "1/4 S18 CS" "BT" ON A DOUBLE BLAZE; BEARS N16° W, 10 1/2 FEET DISTANT.

A GREEN AND WHITE PAINTED STEEL FENCE POST IS S.W. LY 0.5 FEET DISTANT FROM THE ALUMINUM PIPE MONUMENT AND PROTRUDES 4 1/2 FEET ABOVE GROUND.

Sketch of Monument, Accessories, and General Area

Location & Comments

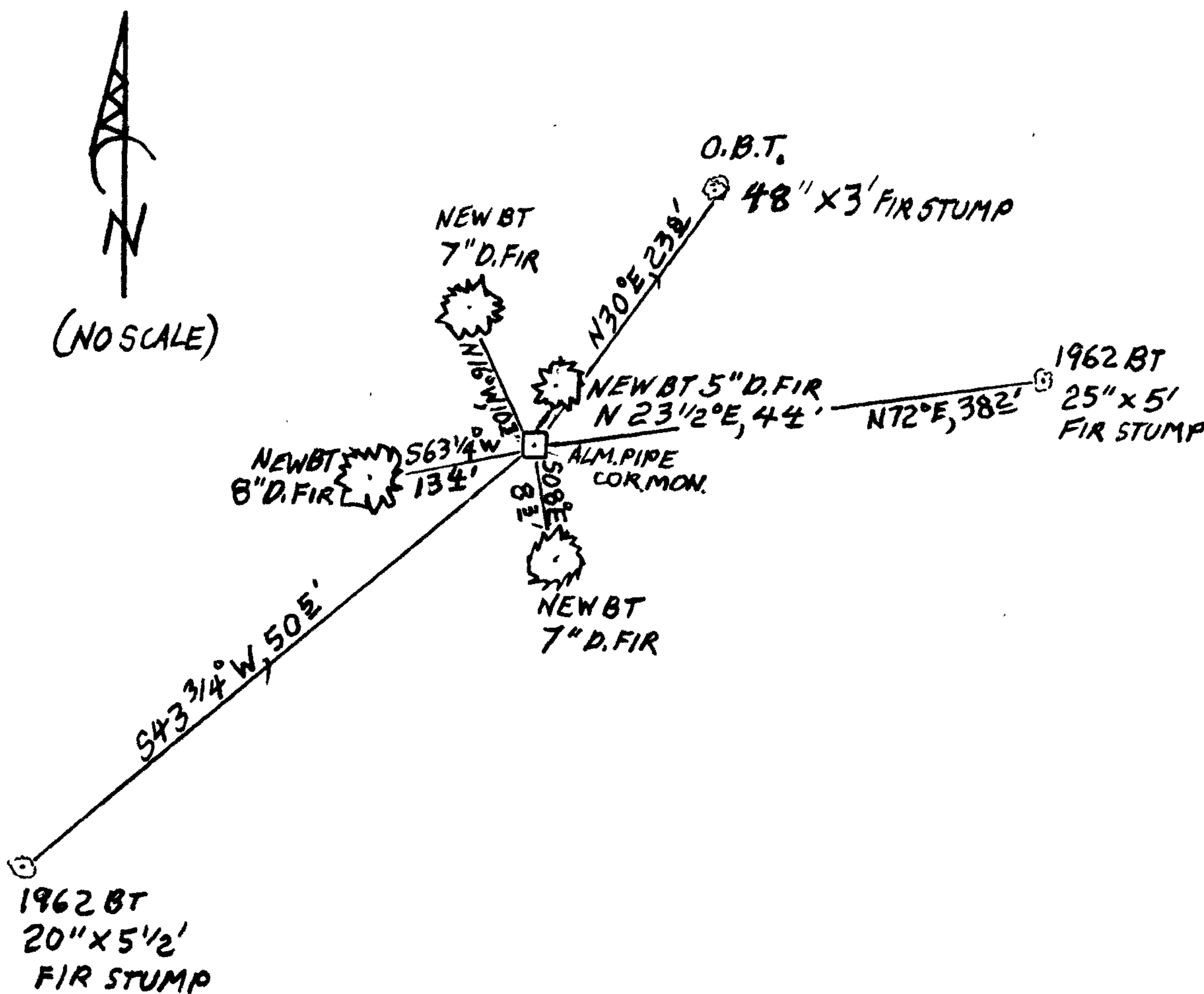

MONUMENT IS ON MODERATE EAST SLOPE FORESTED WITH YOUNG D. FIR REYRON AND SOME MAPLE.

Comp. Decline. 15 1/2° F

Agency P.C.S.O.

Party Chief STEPHEN JOHN FLAUSE

Note keeper Stephen John Flause

Witnesses MIKE S. KOCH

Surveyor's Seal

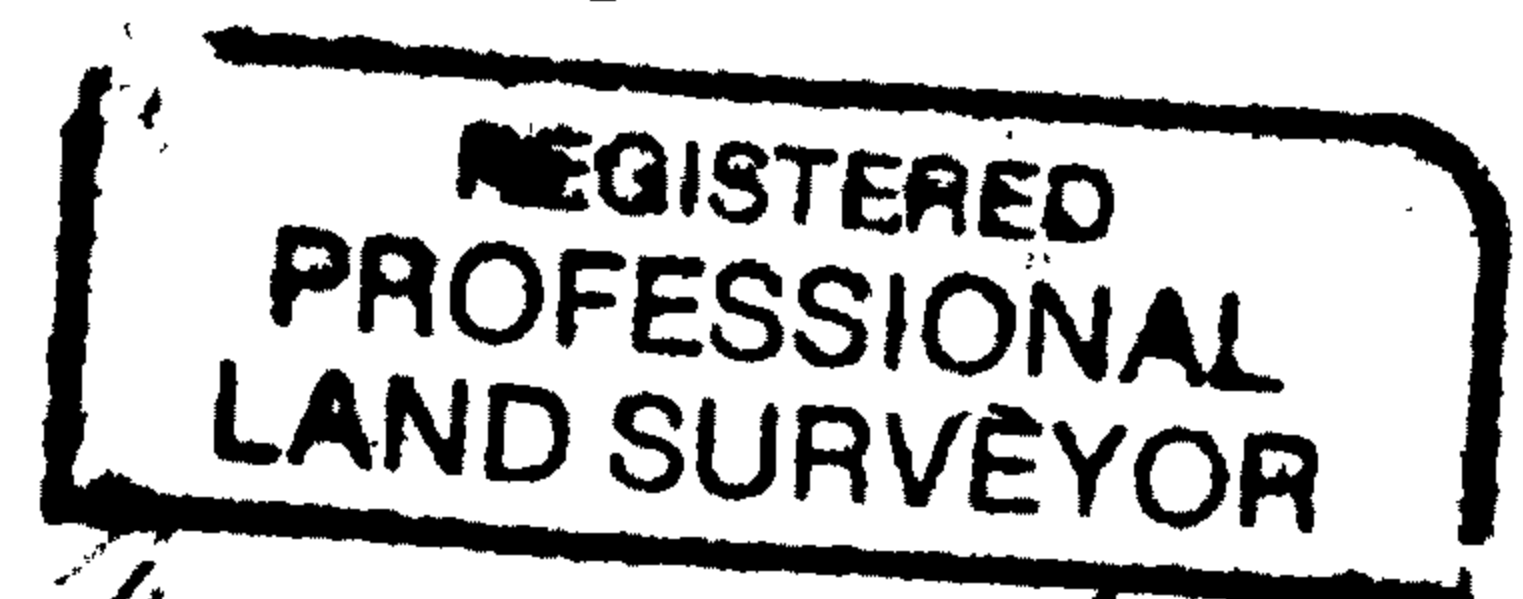

*Handwritten signature of Randall W. Smith*

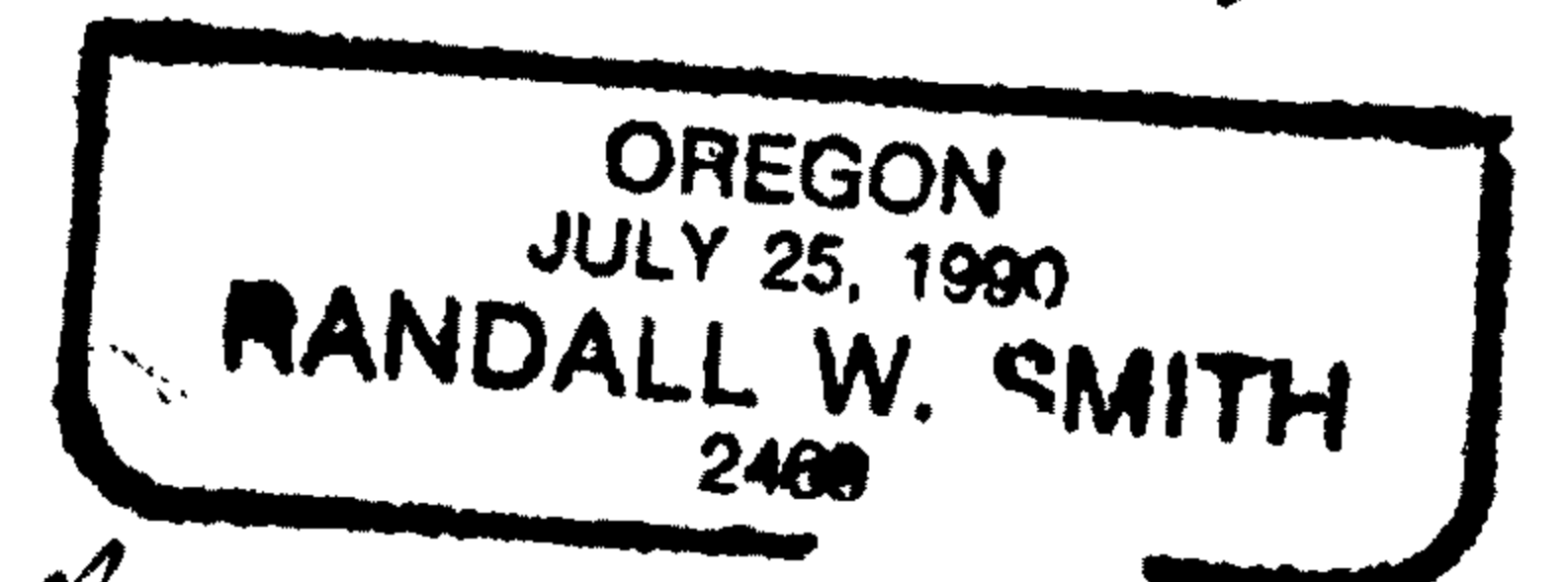

Renewal 6-30-2019