

~~FILED JUN 1 2013~~  
MC 526 T215 R12W  
535

7/30/13

FILED JUN 19 2013

8 INCH "X" IN SANDSTONE BLUFF FACE (IN ORANGE  
PAINT SQUARE) 5 FT. ABOVE AVERAGE LEVEL GROUND  
S 28 1/2° W, 42 30 FT

6 INCH "+" IN SANDSTONE BLUFF FACE (IN ORANGE  
PAINT CIRCLE) 4 FT. ABOVE AVERAGE LEVEL GROUND.  
N 88° W, 55 85 FT.

1/2 INCH ALUM CAP STAMP " DOUGLAS CO. "  
ON A 5/8 I. R. x 5"  
PROTRUDES 2"  
MC  
2013  
SURVEYOR

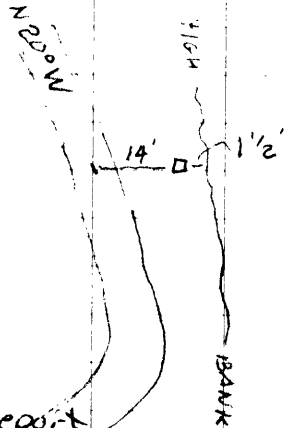

Corner Report  
Filed as CS 67/38-27

C.S. File No 67/39

FILED JUN 9 2013  
T215 R12W 1/4 26  
35

4/29/13

33" D. FIR "1/4 S35CS" BT S39 3/4 E, 260

10" POWER POLE "AE 263" S34 1/2 W, 70 8'  
24

24" D. FIR "1/4 S26CS" BT N89 1/4 W, 363'

8 1/2" POWER POLE "AE 263" N16 3/4 W, 12 1'  
23

DOUGLAS COUNTY SURVEYOR

T215  
R12W  
1/4  
526  
535

2013

PROTRUDES 4"

Corner Report C.S. File No 67/39-3  
Filed as CS 67/38-28