

GOVERNMENT CORNER RESTORATION FORM

FILED

TOWNSHIP 21S RANGE 04W SEC. 20 PLSS # 037020

Date: 7/29/2013 By: JC
This survey consists of:

DOUGLAS COUNTY OREGON

DATE JULY 24, 2013

Map: _____
Narrative: _____
Corner Rpt: CS 67/38-46

Corner Designation

DOUGLAS COUNTY
SURVEYOR

NNW
DLC 37

- _____ Condition Report
- _____ Not Found
- Renewed
- _____ Unrecorded
- _____ Surveyed In
- _____ Referenced Out

Previous Renewals 1901, 1948, 1964, 1968
Monument(s) Found: _____ (Condition and Source)

MONUMENT DETAIL

FROM THE 1968 RENEWAL
A 2 1/2 INCH DIAMETER BRASS CAP (STAMPED
AS AT RIGHT) ON A 1 INCH I.D. IRON PIPE FULLY
AND PLUMBLY SET PROTRUDING 12 INCHES ABOVE
GROUND.

COUNTY SURVEYORS OFFICE
T 21 S

FROM THE 1964 RENEWAL A 1 INCH I.D. IRON
PIPE WITH AN ALUMINUM SLEEVE (ORIGIN UN-
KNOWN) IS ~~BEING~~ LOOSELY SET, ~~FEATHERS~~
SLIGHTLY NW AND PROTRUDING 12 INCHES
ABOVE GROUND N 45° W, 1° FOOT DISTANT FROM
ABOVE FOUND MONUMENT.

N.W.
D.L.C. 37

R 4 W
1968

Accessories Found

EVIDENCE OF ONE ORIGINAL BEARING TREE. A CEDAR 15" DIA. NOW A MAXIMUM 30
INCH DIAMETER APPROX 3 FOOT TALL CEDAR STUMP WITH MOST OF WEST SIDE MISSING;
BEARS S 76° E, 13° FEET DISTANT (RECORD S 73° E, 14 1/2 FEET).
NO EVIDENCE OF NORTHEAST O.B.T. REMAINS.

EVIDENCE OF TWO 1964 RENEWAL BEARING TREES.
9" I. CEDAR NOW A 30 INCH DIAM. 3 FOOT TALL INCENSE CEDAR STUMP WITH NO BLAZE
EVIDENT. THIS STUMP IS OPENED ENOUGH TO SHOW A SOUND FACE AND THE SCRIBING "S".
THIS STUMP BEARS N 44 3/4° W, 71° FEET DISTANT (RECORD N 45 1/2° W, 71° FT.).
10" I. CEDAR NOW A 12 INCH DIAM. 1 FOOT TALL ROTTEN INCENSE CEDAR STUMP WITH A
ONCE HEALER ~~BLAZE~~ THE BLAZE IS MOSTLY ROTTED AWAY AND ALL FACE EVIDENCE IS GONE DUE TO
THIS STUMP BEARS S 64° W, 29° FEET DISTANT (AS PER RECORD).

FENCES CALLED OUT IN 1968 RENEWAL ARE DOWN, SOME EVIDENCE OF E-W FENCE REMAINS
SOUTH RUNNING FENCE IS GONE.

N/A

THE 1 INCH I.D. IRON PIPE WITH AN ALUMINUM SLEEVE IS REMOVED FROM GROUND (FOUND TO MEASURE 39 INCHES LONG) AND IS RESET ON NORTH EDGE OF FOUND B.C. MONUMENT PROTRUDING 11 INCHES ABOVE GROUND.

New Accessories

FOUR NEW B.T.S ARE ESTABLISHED.
A 9 INCH DIAMETER DOUGLAS FIR SCRIBED "NNW DLC 37 CS" "BT" ON A DOUBLE BLAZE; BEARS N40 1/2° E, 36 2 FEET DISTANT.
A 13 INCH DIAMETER INCENSE CEDAR SCRIBED "NNW DLC 37 CS" "BT" ON A DOUBLE BLAZE; BEARS S68 3/4° E, 37 2 FEET DISTANT.
A 10 INCH DIAMETER WHITE OAK SCRIBED "NNW DLC 37 CS" "BT" ON A DOUBLE BLAZE; BEARS S45 1/2° W, 7 2 FEET DISTANT.
A 19 INCH DIAMETER DOUGLAS FIR SCRIBED "NNW DLC 37" "CSBT" ON A DOUBLE BLAZE; BEARS N01° W, 2 2 FEET DISTANT.

Sketch of Monument, Accessories, and General Area

Location & Comments

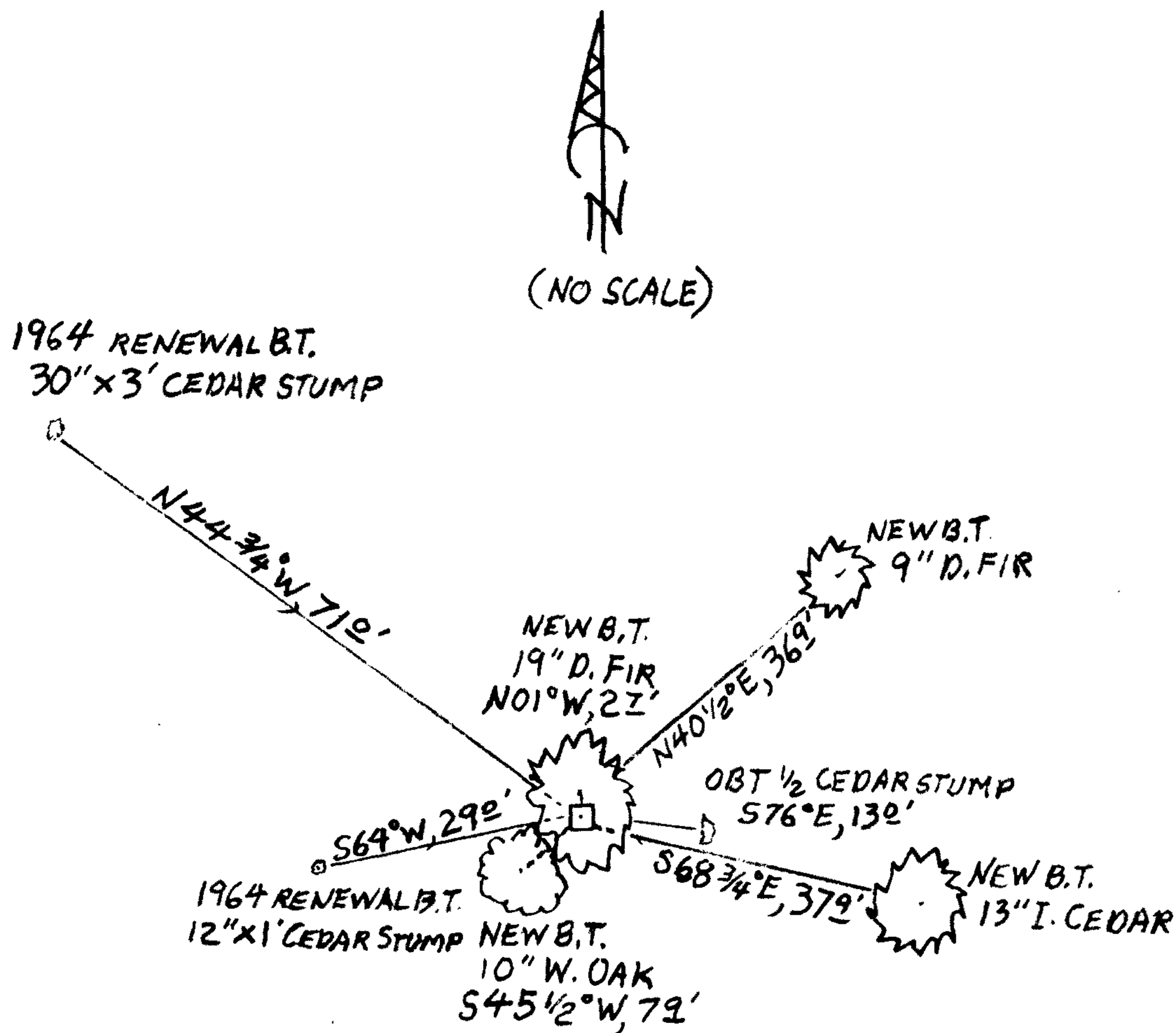

CORNER IS ON MILD EAST SLOPE IN MIXED AGE REPROD D. FIR FOREST WITH SOME CEDAR, OAK AND MAPLE.

Comp. Decline. 15 1/2° E
Agency DC SO
Party Chief STEPHEN JOHN FLAUSE
Note keeper Stephen John Flause
Witnesses MIKE S. KOCH

Surveyor's Seal

REGISTERED PROFESSIONAL LAND SURVEYOR

Handwritten signature of Randall W. Smith

OREGON JULY 25, 1990 RANDALL W. SMITH 2488

Handwritten date: 6-30-2014