

GOVERNMENT CORNER RESTORATION FORM

TOWNSHIP 22 S RANGE 05 W SEC. 33 PLSS # 340140

DOUGLAS COUNTY OREGON

DATE JULY 22, 2013

Corner Designation

C 1/4 533

Previous Renewals ESTB. BY HAINES (DATE ?), ESTB. BY BLM 1983
Monument(s) Found: (Condition and Source)

FILED
Date: 7/29/2013 By: JC
This survey consists of:
Map: _____
Narrative: _____
Corner Rpt: CS 67/38-44

DOUGLAS COUNTY
SURVEYOR

- Condition Report
- Not Found
- Renewed
- Unrecorded
- Surveyed In
- Referenced Out

FROM HAINES SURVEY A 3/4 INCH I.D., 39 INCH LONG, IRON PIPE LOOSE AND OUT OF POSITION LYING ON GROUND SURFACE APPROX 6 FEET WNW FROM BLM RECORD POSITION

A 3 1/4 INCH DIAM. ALUMINUM CAP (MARKED AS AT RIGHT) ON A 2 1/2 INCH I.D. ALUMINUM PIPE, ~~FIRMLY AND PLUMBLY SET~~, PROTRUDING 6 INCHES ABOVE GROUND.

MONUMENT DETAIL

U.S. DEPARTMENT OF INTERIOR
T22S R5W
C 1/4 S33
1983
CADASTRAL SURVEY
BUR. OF LAND MANAGEMENT

Accessories Found

THE 2 BLM ORIGINAL BEARING TREES FROM 1983.
A FIR 6" DIA. NOW A 20 INCH DIAM. DOUGLAS FIR WITH A FULLY HEALED SINGLE BLAZE; BEARS S79 1/2° E, 16 1/2 FEET DISTANT (RECORD S79 1/2° E, 17 1/2 FEET).
A FIR 8" DIA. NOW A 14 INCH DIAM, 15 FOOT TALL, ROTTEN DOUGLAS FIR SNAG WITH PARTIALLY HEALED SINGLE BLAZE SHOWING A ROTTED FACE WITH NO SCRIBING REMAINING; BEARS N16 3/4° W, 25 1/2 FEET DISTANT (AS PER RECORD).

~~THE HAINES MONUMENT IS AS DESCRIBED ABOVE.~~
HAINES'S NE BEARING TREE IS NOW A ROTTED LOW CUT STUMP AND THE SE BEARING TREE IS GONE (REMOVE DURING ROAD CONSTRUCTION).

Monument Set (Procedure and Description)

MONUMENT DETAIL

N/A

N/A

New Accessories

A 16 INCH DIAM. DOUGLAS FIR SCRIBED "C" 1/4 S33 "CSBT" ON A DOUBLE BLAZE; BEARS N34 1/2° E, 24' FEET DISTANT.

A 6 INCH DIAM. DOUGLAS FIR SCRIBED "X" "CSBT" ON A HIGH-LOW BLAZE; BEARS S31 1/2° W, 19' FEET DISTANT.

A 10 INCH DIAM. DOUGLAS FIR SCRIBED "C" 1/4 S33 CS "BT" ON A DOUBLE BLAZE; BEARS N47 3/4° W, 39' FEET DISTANT.

Sketch of Monument, Accessories, and General Area

Location & Comments

SKETCH SHOWS BLM B.T.S AND NEW B.T.S; HAINES ACCESSORIES NOT SHOWN

MONUMENT IS ON MOSTLY FLAT GROUND IN OLDER FIR REPROD FOREST WITH SOME MAPLE.

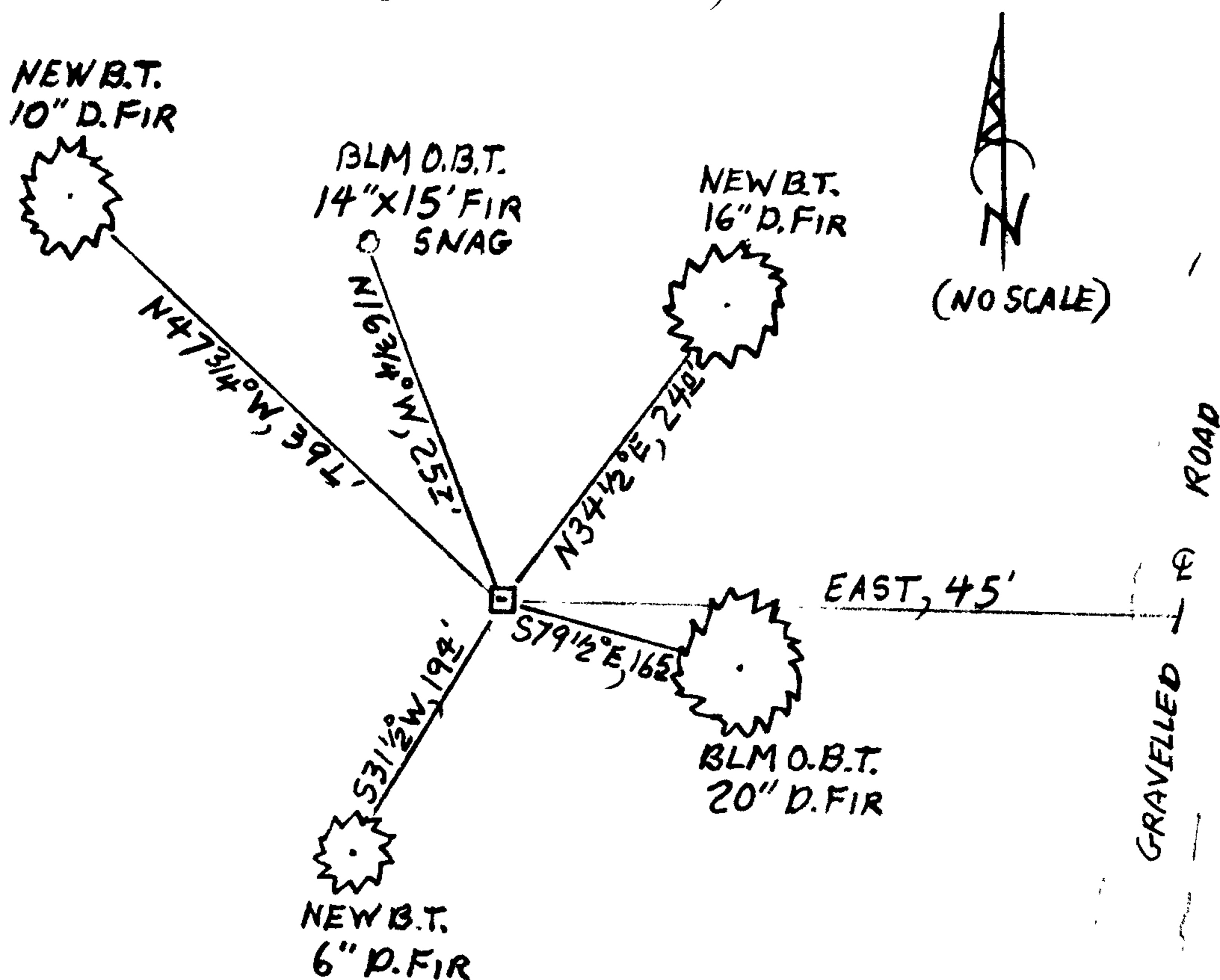

Comp. Decline. 15 1/2° E
Agency DCSO
Party Chief STEPHEN JOHN FLAUSE
Note keeper Stephen John Flause
Witnesses MIKE S. KOCH

Surveyor's Seal

REGISTERED PROFESSIONAL LAND SURVEYOR

Handwritten signature of Randall W. Smith

OREGON JULY 25, 1990 RANDALL W. SMITH 2489

Round 31-2014