

GOVERNMENT CORNER RESTORATION FORM

TOWNSHIP 21 S RANGE 04 W SEC. 17 PLSS # 240400

DOUGLAS COUNTY OREGON

DATE JULY 17, 2013

FILED

Date: 7/29/2013 By: JC  
This survey consists of:

Map: \_\_\_\_\_

Narrative: \_\_\_\_\_  
Corner Rpt: CS 67/38-41

Corner Designation

$\frac{1}{4} \frac{S17}{S20}$

DOUGLAS COUNTY  
SURVEYOR

Previous Renewals 1968, 1971 RESURVEY  
Monument(s) Found: (Condition and Source)

- \_\_\_\_\_ Condition Report
- \_\_\_\_\_ Not Found
- Renewed
- \_\_\_\_\_ Unrecorded
- \_\_\_\_\_ Surveyed In
- \_\_\_\_\_ Referenced Out

FROM THE 1972 RESURVEY A 3 1/4 INCH DIAM-  
ETER BRASS CAP (MARKED AS AT RIGHT) ON A 2 1/2  
INCH I. D. IRON PIPE ~~FURMLY AND PLUMBLY~~ SET 3 INCHES  
BELOW GROUND IN LOW STREAM BANK.

MONUMENT DETAIL

U.S. DEPT. OF THE INTERIOR

$\frac{1}{4} \frac{S17}{S20}$

T21S R4W

1971

BUR. OF LAND MANAGEMENT

Accessories Found

NO EVIDENCE OF O.B.T.S.

ONE 1971 RESURVEY BEARING TREE,  
AN ALDER 6" DIA. NOW AN 11 INCH DIAM. ALDER WITH A FULLY HEALED BLAZE (BASE OF  
TRUNK AND BLAZE ARE BURIED IN STREAM SILT); BEARS N27°W, 33<sup>2</sup> FEET DISTANT  
(AS PER RECORD, MEASURED TO BURIED C.R.C.).

POSSIBLE EVIDENCE OF OTHER 1971 B.T.: AN ALDER 10" DIA. NOW A FALLEN AND  
ROTTED 13 INCH DIA. ALDER WITH NO REMAINING BLAZE OR ~~RECORDING~~ EVIDENCE. THE  
UPROOTED BASE OF THIS TREE BEARS S84°W, 11 FEET DISTANT (RECORD S84°W, 7<sup>2</sup> FEET,  
14 FOOT DISTANCE CONSISTENT WITH WASHING DOWNSTREAM).  
~~CORNER MONUMENT SITUATION NEXT TO BASS CREEK IS AS DESCRIBED.~~

N/A

N/A

New Accessories

A 25 INCH DIAM. (MEASURED BELOW TRUNK LIMB FLARE) MAPLE, SCRIBED "1/4 S17CS" "BT" ON A DOUBLE BLAZE; BEARS N36°E, 76 1/2 FEET DISTANT.

A 20 INCH DIAM. ALDER SCRIBED "1/4 S20CS" "BT" ON A DOUBLE BLAZE; BEARS S71 1/2°E, 17 1/2 FEET DISTANT.

AN 11 INCH DIA. DOUGLAS FIR SCRIBED "1/4 S20CS" "BT" ON A DOUBLE BLAZE; BEARS S16°W, 74 1/2 FEET DISTANT.

A 5 FOOT LONG WHITE CARSONITE POST WITH AN ALUMINUM SURVEY MARKER SIGN ATTACHED IS SET 1 FOOT SOUTH OF THE B.C. MONUMENT AND IT PROTRUDES 3 FEET ABOVE GROUND.

Sketch of Monument, Accessories, and General Area

Location & Comments

SKETCH SHOWS LIVE TREES ONLY

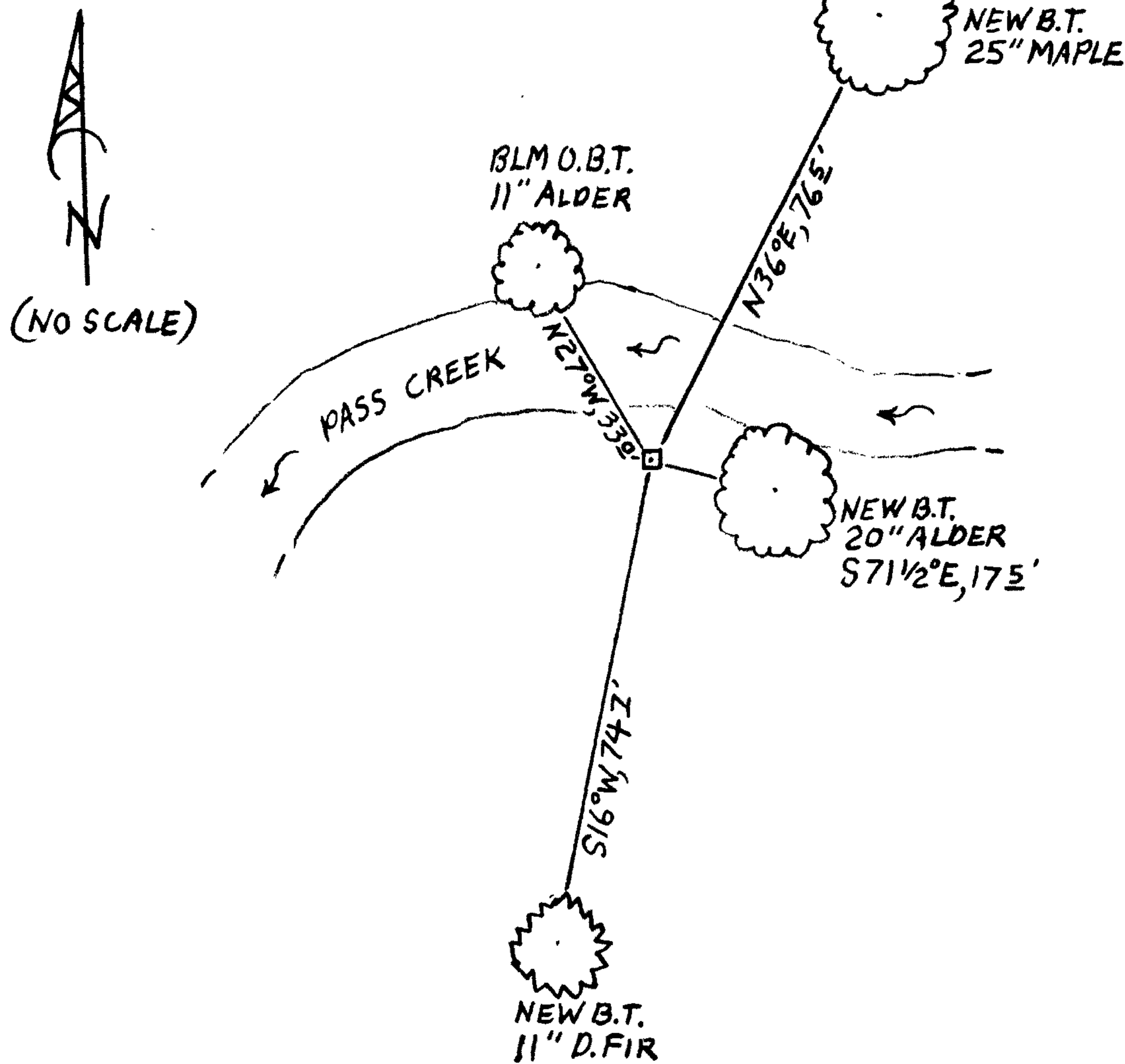

MONUMENT IN STREAM BOTTOM JUST ABOVE MEAN HIGH-WATER LEVEL (LOCATION FLOODED EVERY WINTER). AREA IS OPEN WOODLAND OF ALDER, MAPLE AND SOME FIR.

Comp. Decline. 15 1/2°E  
Agency D.C.S.O.  
Party Chief STEPHEN JOHN FLAUS  
Note keeper Stephen John Flaus  
Witnesses MIKE S. KOCH

Surveyor's Seal

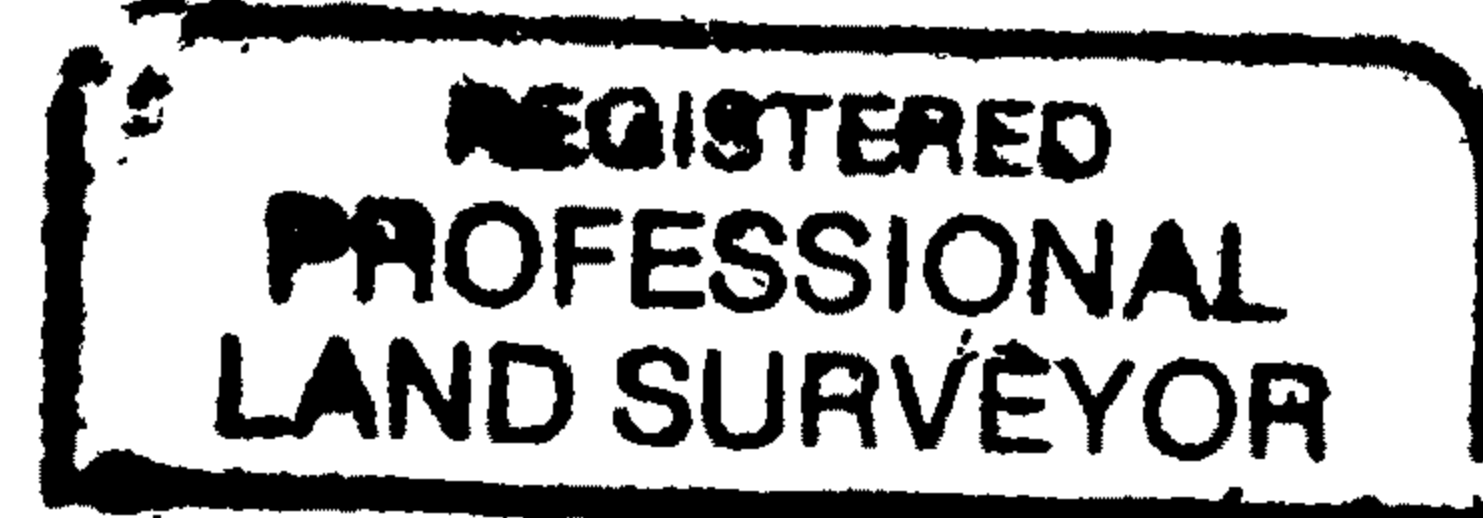

*Handwritten signature of Randall W. Smith*

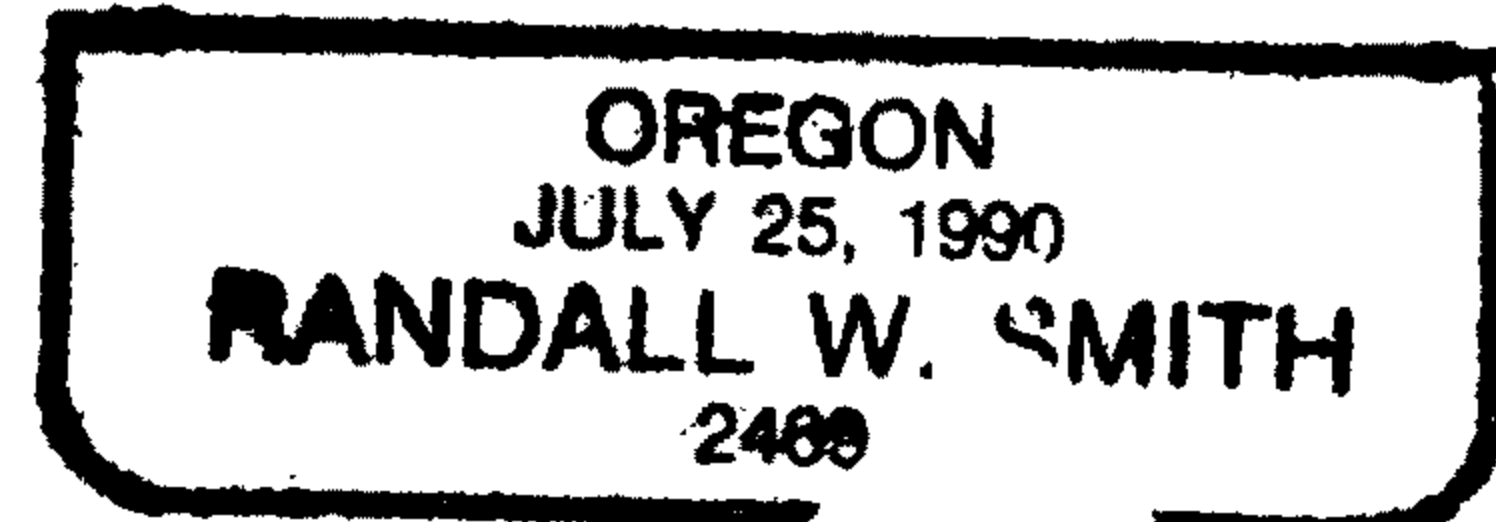

RENEWAL 6-30-2014