

GOVERNMENT CORNER RESTORATION FORM

FILED

TOWNSHIP 285 RANGE 03W SEC. 1 PLSS # 700600

Date: 7/29/2013 By: JC
This survey consists of:

DOUGLAS COUNTY OREGON

DATE JULY 15, 2013

Map: _____

Corner Designation

Narrative: _____

Corner Rpt: CS 67/38-39

DOUGLAS COUNTY
SURVEYOR

- _____ Condition Report
- _____ Not Found
- Renewed
- _____ Unrecorded
- _____ Surveyed In
- _____ Referenced Out

MONUMENT DETAIL

U. S. P. C. PROPERTY COR.

R3W T285

| | |
|-----|-----|
| S7 | S7 |
| S12 | R2W |

R. E. 14287

| | |
|-----|----|
| S1 | S7 |
| S12 | |

Previous Renewals 1908, 1962 (SHRUM), 1962 (DCSO), 1980
Monument(s) Found: (Condition and Source)

FROM THE 1962 (SHRUM) RENEWAL
A 2 1/2 INCH DIAMETER ALUMINUM CAP (MARKED AS
AT RIGHT) ON A 1 INCH O.D. IRON PIPE, FIRMET AND
PLUMBLY SET, PROTRUDING 8 INCHES ABOVE GROUND

Accessories Found

EVIDENCE OF THE FOUR ORIGINAL BEARING TREES. A FIR 24" DIA. NOW A 40 INCH DIAM. 4 FOOT TALL FIR STUMP WITH A PREVIOUSLY OPENED BLAZE (SCRIBING DESTROYED IN 1908); BEARS N25°E, 27[±] FEET DISTANT (BEARING AGREES WITH ORIG., ORIG. DISTANCE OF 25[±] FT. IS GOOD TO 1882 FACE).

A FIR 20" DIA. NOW A 25 INCH DIAM. 2 1/2 FOOT TALL FIR STUMP WITH A PREVIOUSLY OPENED, AND PARTLY REHEALED BUT NOW ROTTEN, FACE (SCRIBING DESTROYED IN 1908). BEARS S55°E, 14[±] FEET DISTANT (BEARING AGREES WITH ORIG., ORIG. DISTANCE OF 13[±] FT. IS GOOD TO 1882 FACE).

A FIR 30" DIA. NOW A 36 INCH DIAM. 2 FOOT TALL FIR STUMP WITH NO BLAZE OR SCRIBING EVIDENCE; BEARS S71 1/2°W, 30[±] FEET DISTANT (RECORD S70°W, 30[±] FEET).

A FIR 30" DIA. NOW A 40 INCH DIAM. 2 1/2 FOOT TALL FIR STUMP NO LONGER SHOWING BARK SCRIBING (DESCRIBED IN 1962 (DCSO) RENEWAL); BEARS N5°W, 39[±] FEET DISTANT (BEARING AGREES WITH ORIG., ORIG. DISTANCE OF 38[±] FT. IS GOOD TO 1882 FACE).

EVIDENCE OF THE THREE 1962 (SHRUM) RENEWAL B.T.s. AN 11" W. FIR NOW A ROTTEN LOW BASE OF A FIR STUMP; BEARS S14 1/2°W, 18[±] FEET DISTANT (AS PER RECORD).

A 13" W. FIR NOW A 16 INCH DIAM. 1 1/2 FOOT TALL FIR STUMP WITH REMNANTS OF A ROTTEN BLAZE SHOWING NO SCRIBING; BEAR S81°E, 17[±] FEET DISTANT (RECORD S83°E, 17 FT.).

AN 11" W. FIR NOW A 10 INCH DIAM. 1 FOOT TALL MOSTLY ROTTEN AWAY FIR STUMP WITH NO MARKS REMAINING; BEARS N15°W, 46[±] FEET DISTANT (AS PER RECORD).

EVIDENCE OF ONE 1980 RENEWAL B.T., A 14" PINE NOW A 34 INCH DIAM. SUGAR PINE WITH A FULLY HEALED SINGLE BLAZE (AND A 1980 ALUMINUM B.T. TAG); BEARS S86 1/2°W, 181[±] FEET DISTANT (RECORD N86°W, 184[±] FT.).

THE NW HEMLOCK POSITION NOW FALLS UNDER A PILE OF ROAD SPALLS WASTE

RENEWAL

Monument Set (Procedure and Description)

MONUMENT DETAIL

N/A

N/A

New Accessories

A 15 INCH DIAM. INCENSE CEDAR SCRIBED "T28S R2W S7CS" "BT" ON A DOUBLE BLAZE; BEARS S37°E, 12' FEET DISTANT.

A 14 INCH DIAM. DOUGLAS FIR SCRIBED "T28S R3W S12CS" "BT" ON A DOUBLE BLAZE; BEARS S67°W, 24' FEET DISTANT.

A 13 INCH DIAM. WHITE FIR SCRIBED "T28S R3W S1CS" "BT" ON A DOUBLE BLAZE; BEARS N42°12'W, 30' FEET DISTANT

ALSO (OF UNKNOWN ORIGIN) AN ORANGE CARSONITE POST PROTRUDING 4 FEET ABOVE GROUND WITH A MONUMENT LOCATION SIGN BEARS S75°W, 4 FEET DISTANT.

Sketch of Monument, Accessories, and General Area

Location & Comments

SKETCH SHOWS ONLY LIVE FOUND BT AND NEW BT.S

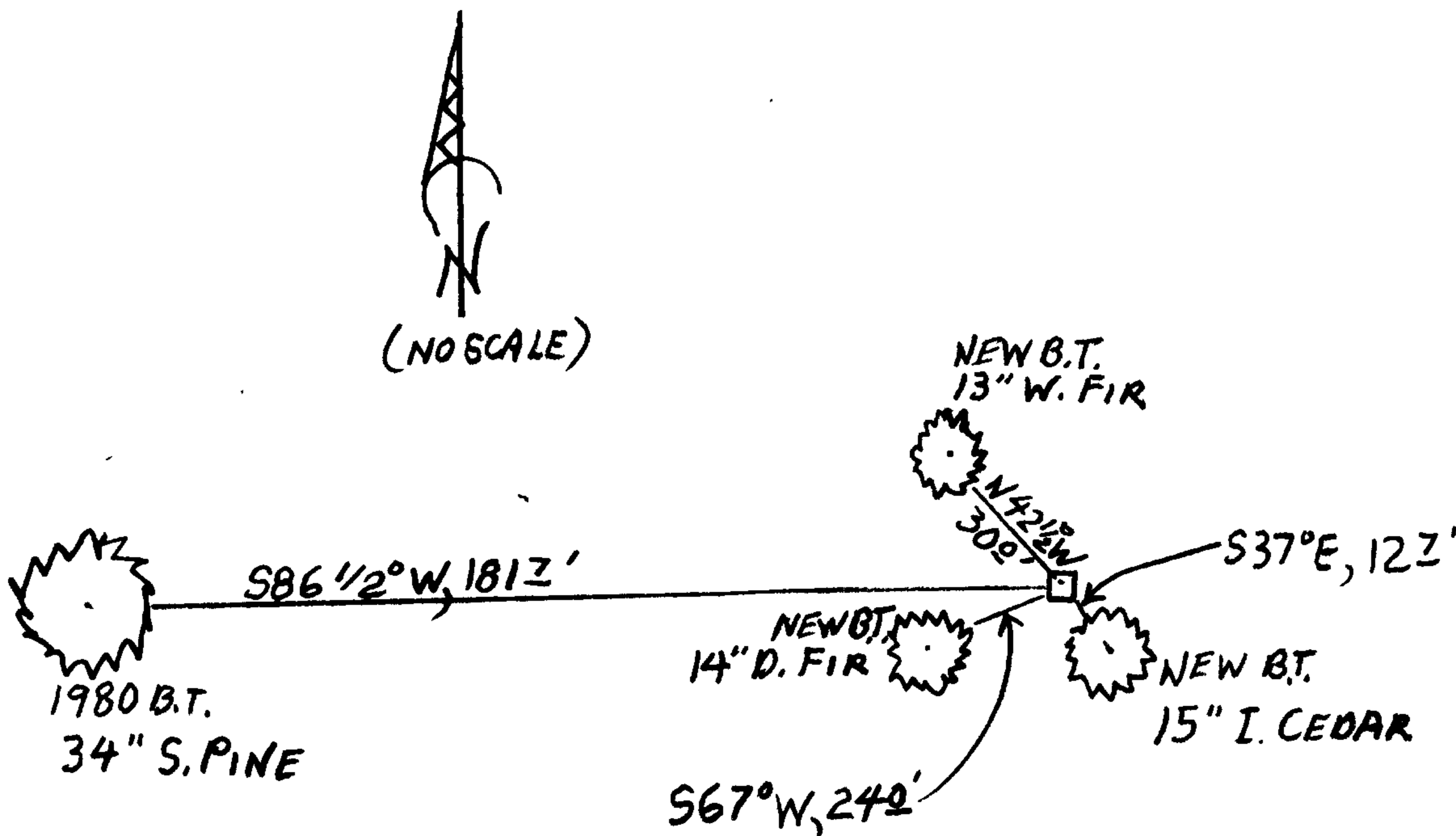

MONUMENT IS NEAR BOTTOM OF A MODERATELY STEEP WESTERLY SLOPE IN A 30+ YEAR OLD REPROD. FOREST OF DOUGLAS FIR AND WHITE FIR WITH SOME MAPLE AND PINE. MONUMENT IS APPROX 70 FEET EAST FROM AN OLD GRAVELLED FOREST ACCESS ROAD.

Comp. Decline. 15 1/2° E
Agency D.C.S.O.
Party Chief STEPHEN JOHN FLAUSE
Note keeper Stephen John Flause
Witnesses MIKE S. KOCH

Surveyor's Seal

REGISTERED PROFESSIONAL LAND SURVEYOR

Signature
RENEWAL 6-30-2014

OREGON
JULY 25, 1990
RANDALL W. SMITH
2468