

GOVERNMENT CORNER RESTORATION FORM

FILED

TOWNSHIP 27S RANGE 03W SEC. 34 PLSS # 500140

Date: 7/17/2013 By: X  
This survey consists of:

DOUGLAS COUNTY OREGON

DATE JULY 12, 2013

Map: \_\_\_\_\_

Narrative: \_\_\_\_\_  
Corner Rpt: CS67/38-38

Corner Designation

DOUGLAS COUNTY  
SURVEYOR

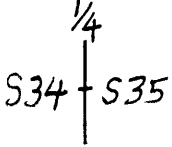

Previous Renewals 1985 BLM DEPENDENT RESURVEY  
Monument(s) Found: (Condition and Source)

- Condition Report
- Not Found
- Renewed
- Unrecorded
- Surveyed In
- Referenced Out

A WIDE SEARCH WAS MADE FOR THE 1985 MONUMENT. AREA IS A FREQUENTLY FLOODED CREEK BOTTOM; NO EVIDENCE WAS FOUND.

N/A

A 2 1/2 INCH WIDE X 5 1/2 FOOT LONG STEEL POST SET IN A SURVEY (FILED IN D.C.S.D. RECORDS AS M164-68) IS FIRMLY AND PLUMBLY SET PROTRUDING 4 1/2 FEET ABOVE GROUND.

MONUMENT DETAIL

Accessories Found

NO EVIDENCE OF O.B.T.S ; BOTH FALL IN WASHED GRAVEL-BAR OF CREEK FLOODPLAIN

TWO 1985 RESURVEY B.T.S.  
A CEDAR 20" DIA. NOW A 36 INCH DIAMETER RED CEDAR WITH A FULLY HEALED DOUBLE BLAZE BEARS S27 1/2° E, 99 1/2 FEET DISTANT (AS PER RECORD).  
A COTTONWOOD 15" DIA. NOW A 32 INCH DIAMETER COTTONWOOD WITH A NO LONGER EVIDENT BLAZE BUT HAVING A 1985 B.T. TAG; BEARS S89 1/2° W, 83 1/2 FEET DISTANT (RECORD S89 1/2° W, 85 1/2 FEET DISTANT).

RENEWAL

Monument Set (Procedure and Description)

MONUMENT DETAIL

POSITION OF FOUND STEEL POST IS REFERENCED-  
OUT AND POST IS REMOVED FROM GROUND; IN ITS  
PLACE IS SET A 1 1/2 INCH DIAM. ALUMINUM CAP  
(MARKED AS AT RIGHT) ON A 5/8 INCH DIAM. X 60 INCH  
LONG STEEL REBAR NOW PROTRUDING 6 INCHES  
ABOVE GROUND.

FOUND STEEL POST IS SET 1 FOOT NORTH OF  
AL. CAP/I.R. MONUMENT AND NOW PROTRUDES  
4 FEET ABOVE GROUND.

DOUGLAS CO.

1/4

2013

SURVEYOR

New Accessories

A 10 INCH DIAM. DOUGLAS FIR SCRIBED "1/4 S35CS" "BT" ON A DOUBLE BLAZE;  
BEARS S71 3/4°E, 1038 FEET DISTANT.

A DOUBLE TRUNK RED ALDER WITH ITS MOST EASTERLY 15 INCH DIAM. TRUNK  
SCRIBED "1/4 S34CS" "BT" ON A DOUBLE BLAZE; BEARS N40°W, 1273 FEET  
DISTANT.

Sketch of Monument, Accessories, and General Area

Location & Comments

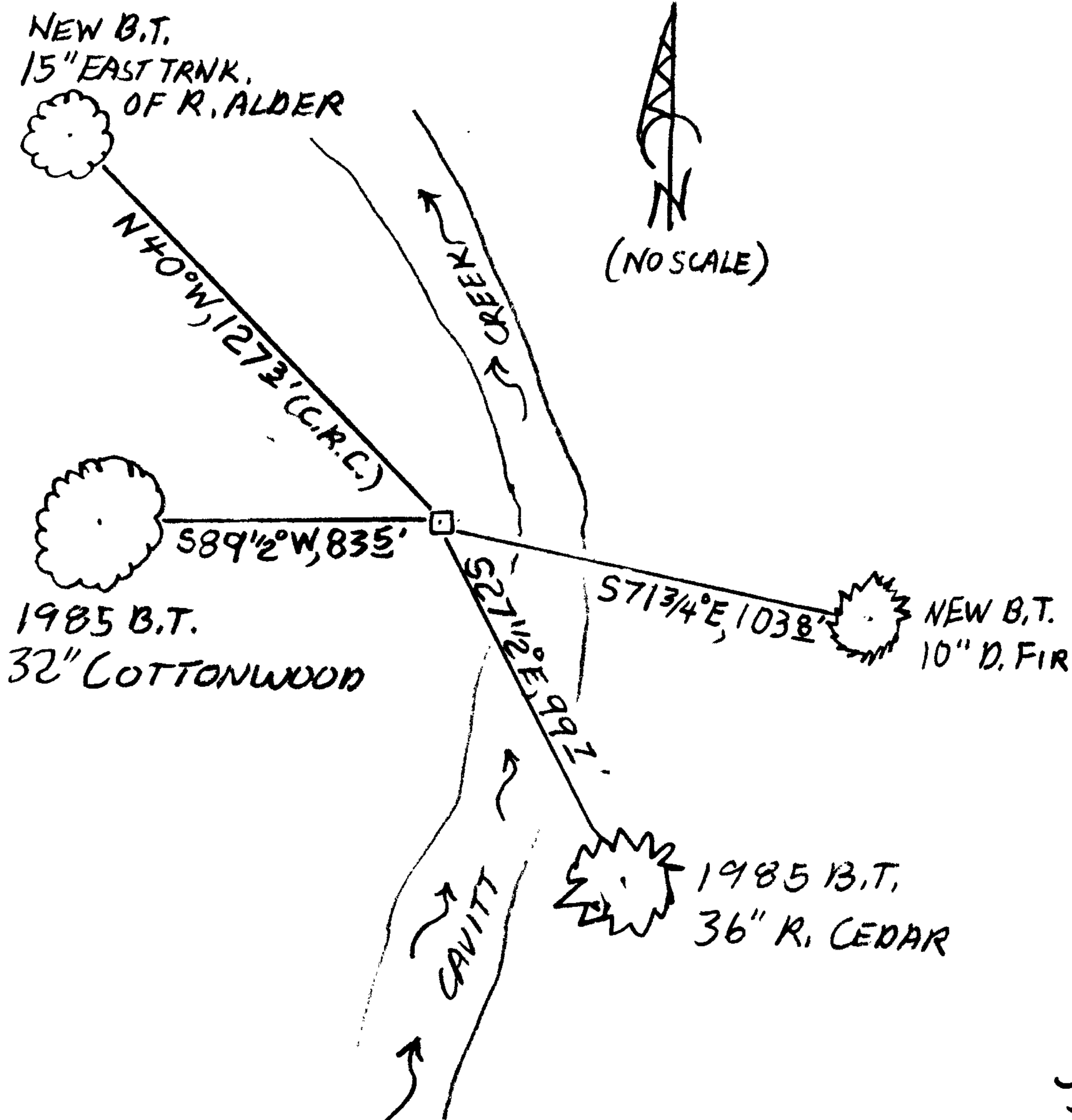

MONUMENT IS IN FLOOD  
PLAIN GRAVEL BAR APPROX.  
20 FEET WEST OF THE  
THREAD OF THE STREAM OF  
CAVITY CREEK.

Comp. Decline. 15 1/2°E  
Agency D.C.S.O.  
Party Chief STEPHEN JOHN FLAUSE  
Note keeper Stephen John Flause  
Witnesses MIKE S. KOCH

Surveyor's Seal

