

GOVERNMENT CORNER RESTORATION FORM

FILED

TOWNSHIP 21S RANGE 04W SEC. 7 PLSS # 200500

Date: 7/17/2013 By: X
This survey consists of:

DOUGLAS COUNTY OREGON

DATE JUNE 21, 2013

Map: _____

Narrative: _____
Corner Rpt: C567/38-35

Corner Designation

S7 | S8

S18 | S17

DOUGLAS COUNTY
SURVEYOR

Previous Renewals 1923, 1969, 1986
Monument(s) Found: _____ (Condition and Source)

- _____ Condition Report
- _____ Not Found
- _____ Renewed
- _____ Unrecorded
- _____ Surveyed In
- _____ Referenced Out

MONUMENT DETAIL

FROM THE 1969 RENEWAL A 2 1/2 INCH DIAMETER BRASS CAP (MARKED AS AT RIGHT) ON A 1 INCH I.D. IRON PIPE, FIRMLY AND PLUMBLY SET PROTRUDING 12 INCHES ABOVE GROUND.

COUNTY SURVEYORS OFFICE

T 21 S

S7 | S8

S18 | S17

R 4 W

1969

AN UNRECORDED IRON BOLT WITH 1 INCH X 1 INCH SQUARE TOP IS SET FLUSH WITH GROUND ON THE SOUTHWESTERLY EDGE OF THE B.C. MONUMENT.

Accessories Found

- EVIDENCE OF ONE O.B.T.
- A FIR 30" DIA, NOW A 50 INCH DIAMETER 8 FOOT TALL FIR STUMP WITH BLAZE NO LONGER DISCERNIBLE; BEARS S23°W, 13 3/4 FEET DISTANT (AGREES WITH 1986 RECORD).
- EVIDENCE OF ONE 1923 RENEWAL BEARING TREE
- A 48" FIR, NOW 48 INCH DIAM 4 FOOT TALL ROTTED FIR STUMP WITH NO FACE OR SCRIBING REMAINING; BEARS S67°12'E, 63° FEET DISTANT (AS PER RECORD).
- EVIDENCE OF THE FOUR 1969 RENEWAL BEARING TREES.
- A 10" D. FIR NOW A ROTTED NEARLY FLUSH WITH GROUND FIR STUMP; BEARS N44°E, 21° FEET DISTANT (AS PER RECORD).
- A 9" D. FIR, NOW A 13 INCH DIAM. 2 FOOT TALL DOUGLAS FIR STUMP WITH A PREVIOUSLY OPENED BLAZE SHOWING THE SCRIBING "B"; BEARS S34°E, 17 3/4 FEET DISTANT (AGREES WITH 1986 RECORD).
- AN 8" D. FIR, NOW AN 8 INCH DIAM. 1 1/2 FOOT TALL ROTTED FIR STUMP WITH POSSIBLE BLAZE EVIDENCE; BEARS S86°W, 78 FEET DISTANT (AGREES WITH 1986 RECORD).
- AN 8" D. FIR, NOW A 10 INCH DIAM. 2 FOOT TALL ROTTED FIR STUMP WITH POSSIBLE BLAZE EVIDENCE; BEARS N72°12'W, 96 FEET DISTANT (BEARING PER 1986 RECORD, DISTANCE PER 1969 RECORD).
- EVIDENCE OF THE ONE 1986 RENEWAL BEARING TREE.
- A 10" FIR, NOW A 14 INCH DIAM. 1 FOOT TALL ROTTED FIR STUMP WITH NO BLAZE OR SCRIBE MARKS BUT STILL HOLDING A "W" NAIL; BEARS N74°E, 28 3/4 FEET DISTANT (AS PER RECORD).

C.S. File 67/38-35

RENEWAL

Monument Set (Procedure and Description)

MONUMENT DETAIL.

N/A

N/A

New Accessories

AN 8 INCH DIAMETER WHITE FIR SCRIBED "T21SR4WS17CS" "BT" ON A DOUBLE BLAZE; BEARS S77 3/4°E, 46 1/2 FEET DISTANT.

A 14 INCH DIAMETER MAPLE SCRIBED "T21SR4WS17CS" "BT" ON A DOUBLE BLAZE; BEARS S07 1/2°E, 25 1/2 FEET DISTANT.

A DOUBLE TRUNKED MAPLE 7 INCHES IN DIAM. (THE LARGER AND MOST SOUTHERLY TRUNK) SCRIBED "T21SR4WS17CS" "BT" ON A DOUBLE BLAZE; BEARS N26 1/2°W, 52 1/2 FEET DISTANT.

Sketch of Monument, Accessories, and General Area
SKETCH SHOWS ONLY 2 LARGE FOUND STUMPS AND NEW B.T.S

Location & Comments

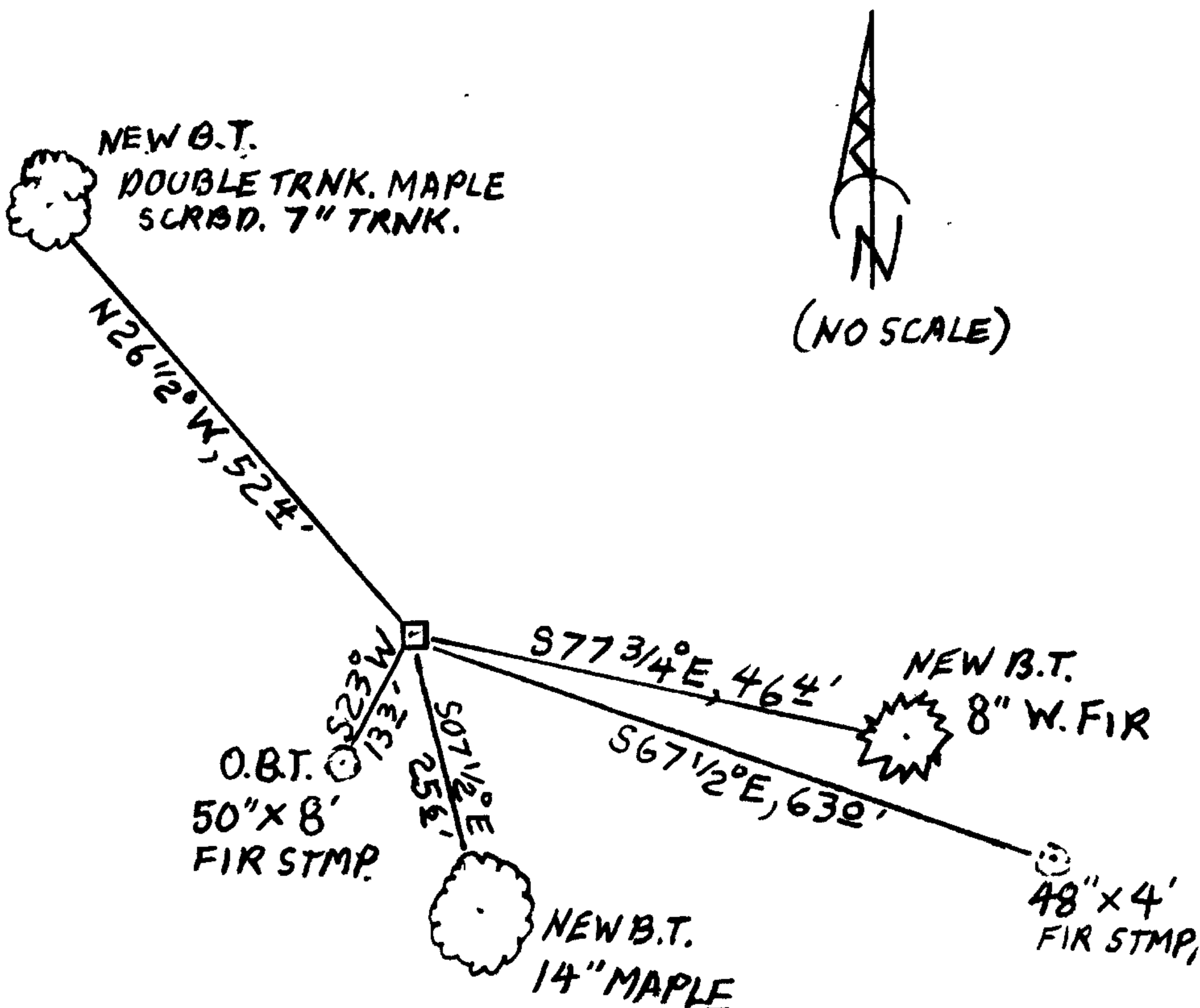

MONUMENT IS IN NORTHWEST CORNER OF OLDER CLEAR CUT ON EAST EDGE OF VERY OLD SECOND GROWTH FOREST OF FIR, MAPLE, AND DOGWOOD, MONUMENT IS APPROX. 65 FEET NORTH OF UNMAINTAINED SPUR ROAD AND APPROX. 130 FEET EAST OF GRAVELLED FOREST ACCESS ROAD.

Comp. Decline. 15 1/2°E
Agency D.C.S.O.
Party Chief STEPHEN JOHN FLAUSE
Note keeper Stephen John Flause
Witnesses MIKE S. KOCH

Surveyor's Seal

REGISTERED PROFESSIONAL LAND SURVEYOR

Signature
6-30-2014

OREGON
JULY 25, 1990
RANDALL W. SMITH
2469