

GOVERNMENT CORNER RESTORATION FORM

TOWNSHIP 21S RANGE 04W SEC. 7 PLSS # 140500

DOUGLAS COUNTY OREGON

DATE JUNE 20 2013

FILED

Date: 7/17/2013 By: JC  
This survey consists of:

Map: \_\_\_\_\_

Narrative: \_\_\_\_\_

Corner Rpt: 67/38-34

Corner Designation

DOUGLAS COUNTY  
SURVEYOR

$\frac{1}{4} \frac{57}{518}$

- \_\_\_ Condition Report
- \_\_\_ Not Found
- \_\_\_ Renewed
- \_\_\_ Unrecorded
- \_\_\_ Surveyed In
- \_\_\_ Referenced Out

Previous Renewals 1969, 1971 AND 1972  
Monument(s) Found: \_\_\_\_\_ (Condition and Source)

MONUMENT DETAIL

FROM THE 1971-72 BLM RESURVEY, A 3 1/4 INCH  
DIAM. BRASS CAP (MARKED AS AT RIGHT) ON A 2 1/2  
INCH O.D. IRON PIPE BURIED UNDER A FALLEN ROTTING  
FIR LOG PROTRUDING 12+ INCHES FROM GROUND SUR-  
FACE BUT LEANING APPROX 0.2 FEET E.S.E. FROM  
PLUMB.

U.S. DEPT. OF THE INTERIOR

$\frac{1}{4} \frac{57}{518}$

T21S R4W  
1971

BUR. OF LAND MANAGEMENT

(ACCESSORIES ARE MEASURED FROM PLUMB POS.)

Accessories Found

NO O.B.T.s OR THE CHINQUAPIN FROM 1969 REMAIN.

EVIDENCE OF THE TWO 1971-72 BLM RESURVEY B.T.s.  
A FIR 8" DIA. NOW AN 18 INCH DIAMETER FALLEN DOUGLAS FIR (MOST OF TRUNK BURIED  
UNDER WIND FALL TREES, BLAZE EVIDENCE NOT SEEN) THE ROOT-HOLE OF WHICH  
BEARS N15°E, 32<sup>3</sup> FEET DISTANT (AS PER RECORD).  
A FIR 10" DIA. NOW A 12 INCH DIAMETER 7 FOOT TALL DOUGLAS FIR STUMP WITH A  
FULLY HEALED SINGLE BLAZE (WE DO NOT OPEN); BEARS S21°W, 25<sup>2</sup> FEET DISTANT  
(AS PER RECORD).

C.S. File 67/38-34

RENEWAL

Monument Set (Procedure and Description)

MONUMENT DETAIL

WE REMOVE LOG FALLEN ON B.C. MONUMENT  
PLUMB POSITION OF FOUND BURIED AND TILTED  
B.C. MONUMENT IS REFERENCED OUT, MONUMENT IS  
REMOVED FROM GROUND (FOUND TO MEASURE 28 INCHES  
LONG). THE MONUMENT IS THEN REESTABLISHED AT THE  
REFERENCE OUT POSITION AND IS NOW FIRMLY AND PLUMBLY  
SET PROTRUDING 6 INCHES ABOVE THE GROUND.

N/A

New Accessories

- 4 NEW B.T.'S
- A 10 INCH DIAM. DOGWOOD SCRIBED "X" "CS BT" ON A HIGH-LOW BLAZE (LOW BLAZE IS 2 FT. ABOVE GROUND DUE TO PISTOL BUTT TRUNK); BEARS S85°12'E 10 3/4 FT DISTANT.
- A 6 INCH DIAM. DOUGLAS FIR SCRIBED "1/4 S18 CS" "BT" ON A DOUBLE BLAZE; BEARS S24°E, 18 1/2 FEET DISTANT.
- A 10 INCH DIAM. DOUGLAS FIR SCRIBED "1/4 S18 CS" "BT" ON A DOUBLE BLAZE; BEARS S40°1/2'W, 29 1/2 FEET DISTANT.
- A 5 INCH DIAM. DOUGLAS FIR SCRIBED "X" "CS BT" ON A HIGH-LOW BLAZE; BEARS N65°W, 14 3/4 FEET DISTANT.

Sketch of Monument, Accessories, and General Area

Location & Comments

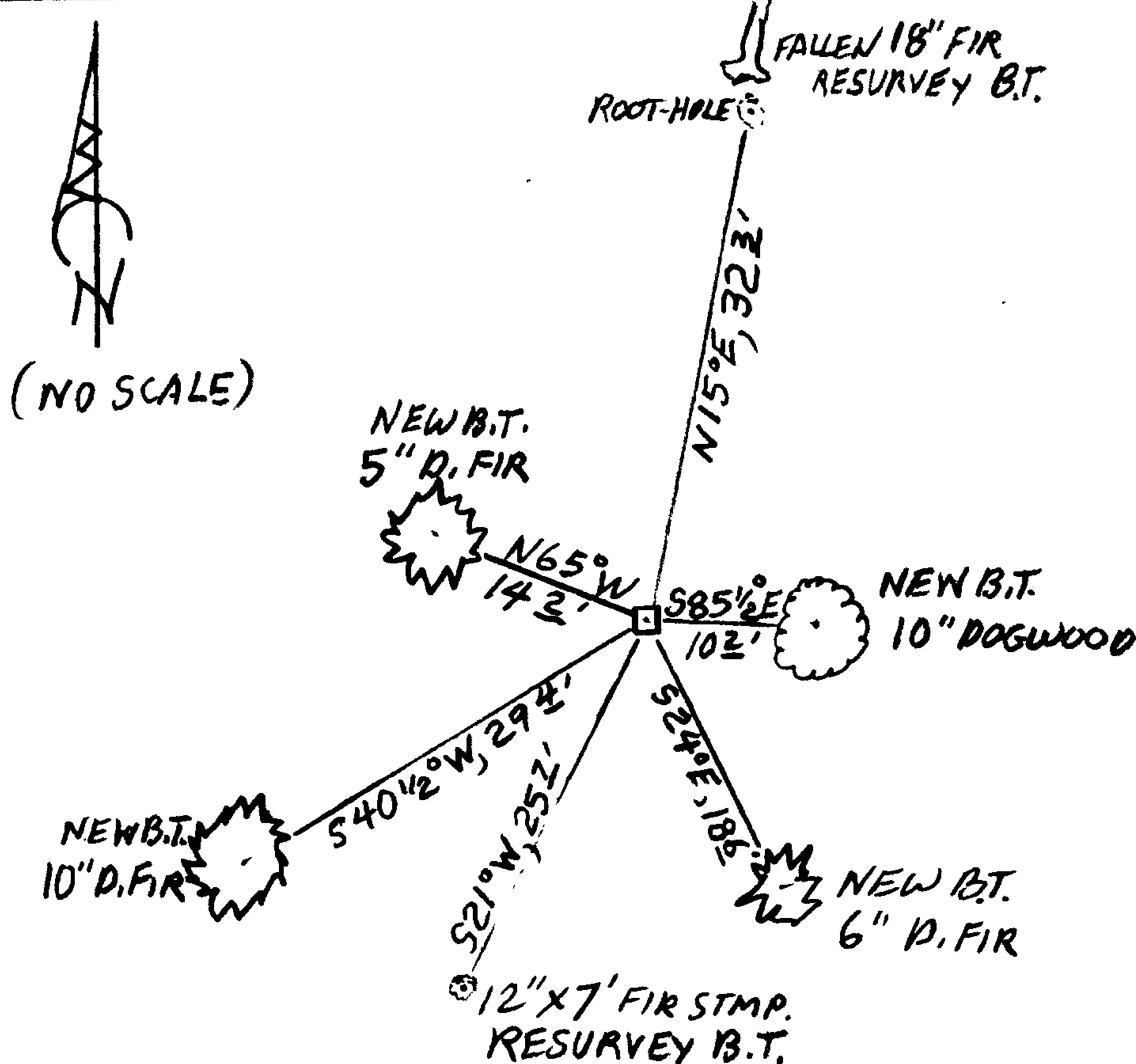

MONUMENT IS ON FLATTENED TOP OF LARGE HIGH RIDGE AT NORTH EDGE OF OLDER D. FIR RE-PROD AND ROUGHLY EAST-WEST RUNNING SOUTH EDGE OF OLD-GROWTH FIR FOREST WITH SOME MAPLE, CHINA, AND DOGWOOD UNDERSTORY.

Comp. Decline. 15°12'E  
Agency D.C.S.D.  
Party Chief STEPHEN JOHN FLAUSE  
Note keeper Stephen John Flause  
Witnesses MIKE S. KOCH

Surveyor's Seal

REGISTERED PROFESSIONAL LAND SURVEYOR

*Randall W. Smith*

OREGON  
JULY 25, 1990  
RANDALL W. SMITH  
2418

RENEWAL 6-30-2014