

GOVERNMENT CORNER RESTORATION FORM

FILED

TOWNSHIP 21S RANGE 04W SEC. 20 PLSS # 037030

Date: 7/17/2013 By: SC  
This survey consists of:

DOUGLAS COUNTY OREGON

DATE JUNE 19, 2013

Map: \_\_\_\_\_

Narrative: \_\_\_\_\_

Corner Rpt: CS 67/38-33

Corner Designation

DOUGLAS COUNTY  
SURVEYOR

INT. L  
DLC 37

- \_\_\_\_\_ Condition Report
- \_\_\_\_\_ Not Found
- Renewed
- \_\_\_\_\_ Unrecorded
- \_\_\_\_\_ Surveyed In
- \_\_\_\_\_ Referenced Out

Previous Renewals 1964  
Monument(s) Found: \_\_\_\_\_ (Condition and Source)

MONUMENT DETAIL

FROM THE 1964 RENEWAL; A 2 1/2 INCH DIAMETER BRASS CAP (MARKED AS AT RIGHT) ON A 1 INCH I. D. IRON PIPE, FIRMLY AND PLUMBLY SET, PROTRUDING 12 INCHES ABOVE GROUND.

COUNTY SURVEYORS OFFICE

T. 21S.

R. 4W.

INT. L.

D. L. C. 37

1964

Accessories Found

EVIDENCE OF ONE O.B.T. A LARGE ROOT HOLE WITH OAK ROOTS AND TREE FRAGMENTS (NO BLAZE OR SCRIBING EVIDENCE REMAINS) FITS CLOSE TO ORIGINAL BEARING AND DISTANCE OF S88°W, 82.5 FEET.

FROM THE 1964 RENEWAL EVIDENCE OF TWO RENEWAL BEARING OBJECTS. A 4" W. FIR NOW A ROTTED 1 1/2 INCH DIAM. 2 FOOT TALL FIR STUMP WITH POSSIBLE BLAZE EVIDENCE (NO SCRIBING FOUND); BEARS S70 1/2°W, 49.7 FEET DISTANT (AS PER RECORD).

A POWER POLE " 7-131" NOW A SAWN OFF BASE OF A POWER POLE 12 INCHES IN DIAM. AND 3 FEET TALL (LABELED PORTION OF UPPER POWER POLE LIES LOOSE ON GROUND DOWNHILL FROM FOUND BASE). SAWN BASE OF POWER POLE BEARS S45°E, 10.5 FEET DISTANT (AS PER RECORD).

OLD FENCES NO LONGER EVIDENT NEAR CORNER.

C.S. File 67/38-33

RENEWAL

Monument Set (Procedure and Description)

MONUMENT DETAIL

N/A

N/A

New Accessories

A DOUBLE TRUNK WHITE OAK. THE NORTHERLY TRUNK IS 9 INCHES IN DIAM. AND GROWS HORIZONTALLY FROM THE ROOT CROWN. THE SOUTHERLY TRUNK IS 5 INCHES IN DIAM. GROWING PERPENICULAR FROM ROOT CROWN AND IS SCRIBED "X CS" "BT" ON A HIGH-LOW BLAZE. THE CENTER OF THE ROOT-CROWN OF THIS TREE BEARS N13°E, 180 FEET DISTANT.

A PISTOL-BUTT 5 INCH DIAM. WHITE OAK SCRIBED "X" "CS BT" ON A HIGH-LOW BLAZE; BEARS N79½°W, 14½ FEET DISTANT.

NO OTHER SUITABLE TREES IN AREA.

Sketch of Monument, Accessories, and General Area

Location & Comments

MONUMENT IS ON MODERATELY STEEP S.E. SLOPE IN MIXED WOODS OF MAPLE, OAK AND FIR

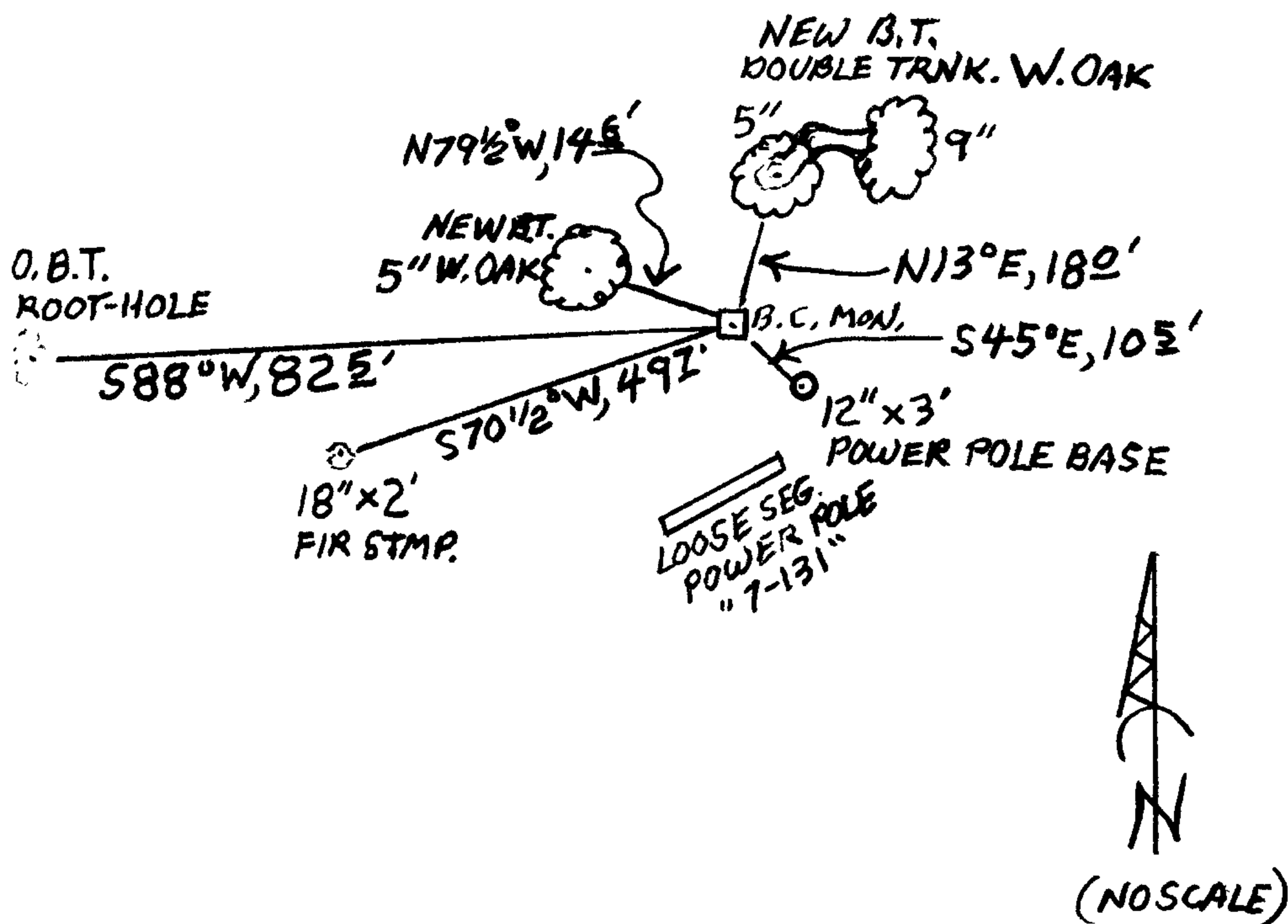

Comp. Decline. 15½°E  
Agency D.C.S.D.  
Party Chief STEPHEN JOHN FLAUSE  
Note keeper Stephen John Flause  
Witnesses MIKE S. KOCH

Surveyor's Seal

REGISTERED PROFESSIONAL LAND SURVEYOR

*Randall W. Smith*

OREGON  
JULY 25, 1990  
RANDALL W. SMITH  
2468

CONTRACT - G-30-2014