

GOVERNMENT CORNER RESTORATION FORM

FILED

TOWNSHIP 26S RANGE 05W SEC. 14 PLSS # 039090

Date: 5/6/2013 By: JC

This survey consists of:

DOUGLAS COUNTY OREGON

DATE APRIL 15, 2013

Map: _____

Narrative: _____

Corner Rpt: CS 67/38-25

Corner Designation

NE EXTL

DLC 39

DOUGLAS COUNTY SURVEYOR

Previous Renewals 1954
Monument(s) Found: _____ (Condition and Source)

- _____ Condition Report
- _____ Not Found
- Renewed
- _____ Unrecorded
- _____ Surveyed In
- _____ Referenced Out

NO EVIDENCE OF THE ORIGINAL MONUMENT.

FROM THE 1954 RENEWAL, A 2 1/2 INCH DIAM. BRASS CAP (MARKED AS AT RIGHT) ON A 1 INCH I. D. IRON PIPE IS FIRMLY SET PROTRUDING APPROX. 4 INCHES ABOVE GROUND (MONUMENT LEANS SLIGHTLY SOUTH; MEASUREMENTS ARE TO PLUMB POSITION).

MONUMENT DETAIL

COUNTY SURVEYORS

NE EXTL

CL 39 | COR

T26S R5W

1954

OFFICE

(ALL THE FOLLOWING MEASURED BEARINGS ARE TRUE AND ARE BASED ON RECORD (FROM DCSO MAP R.M. 1-14) BETWEEN NE INT. L AND NE EXT. L OF DLC 39.)

Accessories Found

TWO 1954 BEARING TREES.

A 14" W. OAK, NOW A DOUBLE TRUNK WHITE OAK THE SCRIBED TRUNK OF WHICH IS 24 INCHES IN DIAM. AND SHOWS A FULLY HEALED DOUBLE BLAZE. THE CENTER OF THE ROOT CROWN OF THE DOUBLE TRUNK BEARS S03/4° W, 312 FEET DISTANT (RECORD S01 1/2° W, 312 FT.; BEARING IS TO CENTER OF BLAZE ON 24 INCH DIAM. TRUNK).

AN 18" PEAR, NOW A DOUBLE TRUNK PEAR THE SCRIBED TRUNK OF WHICH IS 32 INCHES IN DIAM. AND SHOWS A PARTIALLY HEALED SINGLE BLAZE WITH ILLEGIBLE SCRIBING. THE CENTER OF THE ROOT CROWN OF THE DOUBLE TRUNK BEARS S32 1/4° W, 340 8 FEET DISTANT (RECORD S32 1/4° W, 339 9 FT.; DISTANCE IS TO SCRIBED FACE OF 32 INCH DIAM. TRUNK).

RENEWAL

Monument Set (Procedure and Description)

MONUMENT DETAIL

PLUMB POSITION OF FOUND B.C. MONUMENT IS REFERENCED OUT AND MONUMENT IS REMOVED FROM GROUND (LINK DIAM. I.P. IS FOUND TO MEASURE 32 INCHES LONG). BRASS CAP MONUMENT IS REPLACED IN REFERENCED POSITION AND IS NOW APPROX. 9 INCHES BELOW GROUND SURFACE.

N/A

New Accessories

A 5/8 INCH DIAM. IRON ROD PROTRUDING 6 INCHES ABOVE GROUND, FIRMLY SET BUT WITH TOP LEANING SOUTHEASTERLY; THE PLUMB POSITION OF WHICH BEARS S76°06'30"E, 97²⁵ FEET DISTANT. THIS IRON ROD IS SET AT CORNER OF FENCES RUNNING NORTH-SOUTH AND WEST.

AN 11 INCH DIAM. WHITE OAK SCRIBED "NE EXT L DLC 39 CS" "BT" ON A DOUBLE BLAZE; BEARS S73 3/4° E, 82¹ FEET DISTANT. A 3/4 INCH DIAMETER, 1 FOOT LONG IRON BAR IS EMBEDDED HORIZONTALLY 2 FEET ABOVE GROUND ON THE NORTH SIDE OF THE TRUNK.

A 13 INCH DIAM. OREGON ASH SCRIBED "NE EXT L DLC 39 CS" "BT" ON A DOUBLE BLAZE; BEARS S77 1/2° W, 131⁹ FEET DISTANT.

Sketch of Monument, Accessories, and General Area

Location & Comments



HORSE PASTURE

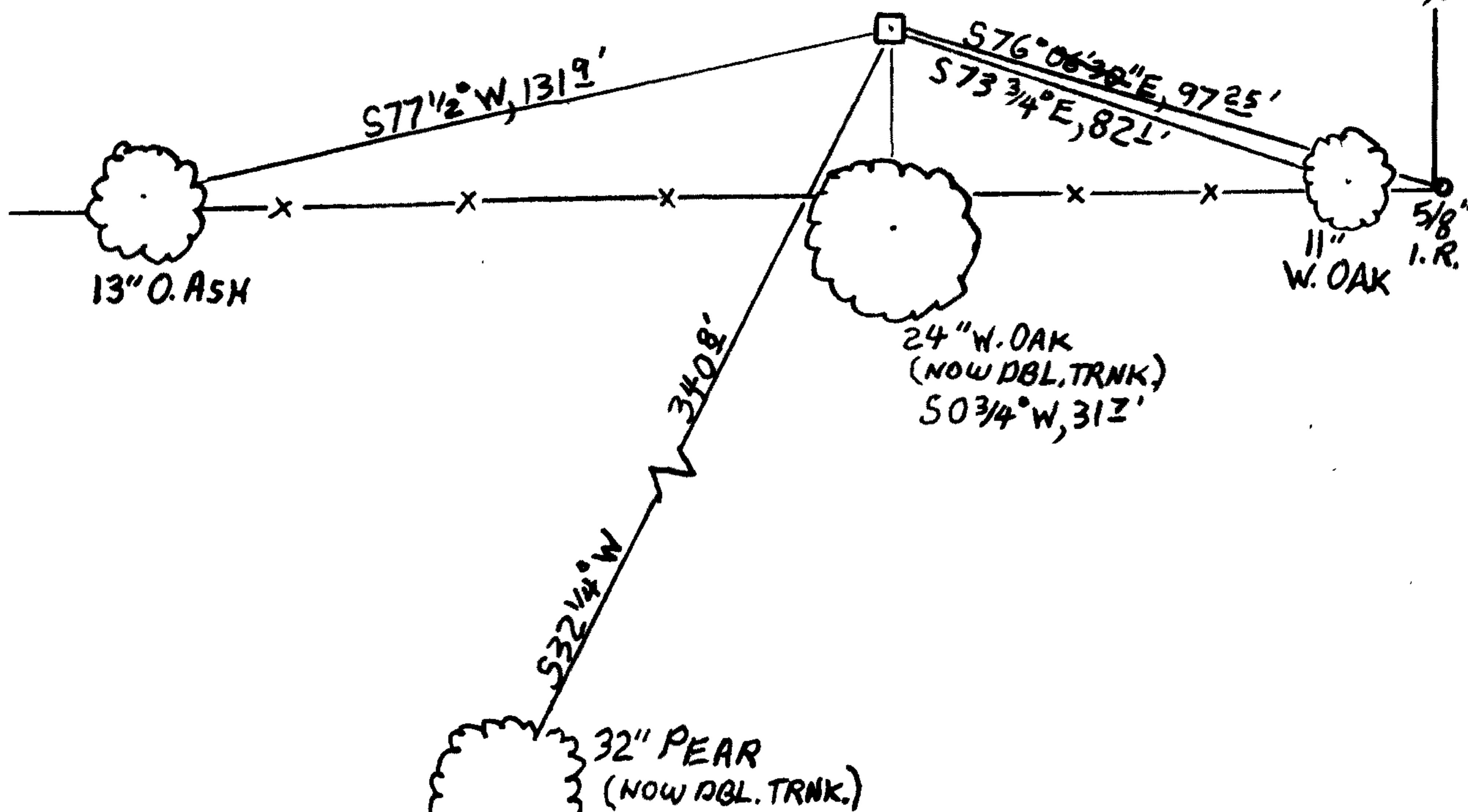

MONUMENT IS IN A GRASS DENuded HORSE PASTURE ON THE NORTH SIDE OF A SHALLOW WEST-ERLY RUNNING SWALE. MONU-MENT IS APPROX. 230 FT. FROM A LARGE AND SMALL BARN PAIR.

Comp. Decline. 15 1/2° E
Agency DECO
Party Chief STEPHEN JOHN FLAISE
Note keeper Stephen John Flaise
Witnesses MIKE S. KOCH

Surveyor's Seal

REGISTERED PROFESSIONAL LAND SURVEYOR

Handwritten signature of Randall W. Smith

OREGON
JULY 25, 1990
RANDALL W. SMITH
2400

RENEWAL 6-30-2014